

CASH
BOOK

1939 - Bk. I
P. Negros Orig.
Phot. Catalogue
(172 of 3)

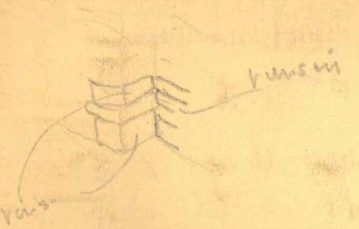

HERALD
SQUARE
Account Book
No. 1079

RULINGS CARRIED IN STOCK

CASH

DAY

JOURNAL

RECORD

SINGLE ENTRY LEDGER

DOUBLE ENTRY LEDGER

Made Expressly for F. W. Woolworth Co.

WIRE-O BINDING
PAT. PENDING

MADE IN U. S. A.

ϕ = Number transp. to
work sheet

1939 ✓

First roll of season, badly under: no
notes at times:

- $\frac{1}{4}$ ④ - Pyr. hejno excavated (left side
from trend?)
- $\frac{1}{2}$ ⑦ " " - music covering
- $\frac{3}{4}$ ⑨ - Pumps
- $\frac{7}{8}$ ⑩ - (Pond / know what?)

L.S.

Time	SKY	Site
1 Sec.	7:30 Misty	K-5
2 (4) $\frac{1}{8}$ sec OK	11:15 Bright	K-5

15
3 (5) $\frac{1}{50}$ @ 8
OK

2:30 Bright K-5 15

1. Left side, Rod ^{up to} used of K-5-2nd Bay working on K-5-2nd terrace just below the door. Mass of K-5-1 fill is in view of him. M.S. @ 1.00 on debris on fill. Godfrey's foot behind out side.

2. Cross-section through fill of K-5-2nd rear left. Whisk broom on interior edge of K-5-3rd. Shovel outside edge of K-5-2nd terrace. Meter stick (10.5 cm) on cross-section of fill. Level rod on position of outside left rear corner of K-5-3rd. On left is falling K-5-3rd wall. Note pure rock fill at center and right, with layer of crushed stone at top.

Right side; toward front, loose stone removed; side of building platform + wheel terrace partly cleared toward front; clearing trees.

NS = Field No.

✓ ✓

Nov 16 / K-5-22 Bright Sun 9:00 K-5-2nd
 4 (b) OK

3/17.7 / sec F-22 Bright 8:30 K-5-2nd

3/17 No 8 1/2 Sec. F-22 Bright 8:30 K-5-2nd

Cut Section - abnormally undisturbed fill.
 1.30 forward of left hand corner of K-5-3d
 building. Bars stand at that corner.
 Mastic @ 1.00, stands about at level of
 K-5-3d plinth.

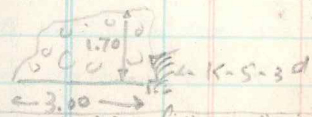

Meter stick on probable fill wall 4.15
 left of left wall of K-5-3d runs down
 from K-5-3d building platform level
 which should appear further back in
 trench. See sketch L.S. March 17 under
 K-5-2nd.

Cut section of fill in line with left
 wall of K-5-3d which shows at right.
 L.S. standing at front outset of K-5-2nd
 [the outset which showed in 1937 without
 excavation]. Meter stick on face of cut,
 (20.50 cm). Bars standing at corner of
 K-5-3d building period B, Benjamin
 indicating plinth of building period A

Veranda wall
7/ *OK*
3/17 (No 9) 1/5 F: 22. Bright 11.30 K-5-1st

8/ *OK*
3/18 (N) 1 Sec 22 Bright 2.30 K-5-2nd
(-1st + 3rd)

*Examined found -
nothing under
wall*
3/18 9/ (10) 1/5 of 8. " " K-5

Right front corner of K-5-1st. Meter stick (100 cm) on lowest of 2 steps to the left of the picture, whisk-broom projecting from behind plinth corner of K-5-1st building period ^(original) B, Benjamin indicating with his machete the plinth corner of K-5-1st building period A. W. S. G. standing in front of standing portion of right anta.

Rear terrace from tower, 1.50 left of *4.50* outset of terrace wall. (probably 2nd from bottom and rear). Rod on K-5-3rd mosaic, probably on plinth, which is dropping to lower corner. W. S. G. (left) on subposed K-5-2nd building floor; Ben Victor on working level, cut section in foreground, with apparent fill wall at base.

Pump - looking forward from tower in same position as no 8.

10 [2]

11 (2) ^{ok}

12 (3)

13 (11) 1 Sec @ 22 2.00 Pk. B right

14 (10) " " " "

K-5

K-5-2nd

K-5-2nd

K-5-1st

Victor + Benjamin in K-5-3rd Landaon
ancus

Mound after bushing; small amount of
excavation on K-5-2 Tenues; ~~left~~ masks
under protective poles. Stela 38 center
foreground.

Front left terracing, beginning to
clear. W.S.G. with rod at base of outsid
on top terrace, knees behind outsid.

Suphand outsid, 2.20⁺ left of left Bldg.
wall of K-5-3rd, base is about K-5-3rd plinth
level.

→ Swung rear corner of Bldg, m.s. @ .50 leans
against it; handiwork on horizon aft end of
secondary plinth. Note mod. penofill in end
section below. W.S.G. with rod in the
latest indentation of Bld. Platform.

✓
15 (11)

3/20 16 ^{OK} [3] 2 Sec @ 32 US.
in [8] by mistake

^{Party member}
3/21 17 (12) 1/2 @ 22 (hu wsg)

3/21 18 ^{over} 1/2 @ 22 (wsg 1/2)

^{OK}
3/21 19 (19) 1/2 Sec @ 22

3/21 29 (12)

K-5-1/50

Sun 3:30 K-5-2/10

Sun 9:00 K-5-1/20

Sun 3:00 K-5-2/20

Misty 9:00
K-5-2/20

" 11:15 "

Pehis (of cut section), from surviving
rear corner, toward rear. m.s. @ .50.

Cut section - K-5-3^d Bld. flood wall at
left, rod on floor at its base. Small piece
on floor at top of pour fill, which ogained
cut through this. No new fill behind
cuts by tight hollow wall. See wsg
Sketch of this section (Mar 20)

Supposed fill wall, rear, running out from
-2nd tenor, rear of -3^d Bldg. Base somewhat
above -3^d plinth level.

Cut out of fill - base at level of base of K-5-2/20
plinth at side - cut in line with left of
side of Bld. plinth.

Left rear tenor. Rod on board (to be located)
at base. m.s. folded

Same wall, same time. Rod left out

✓
✓
(1) - blank.

30 (2) 1 blank $\frac{1}{2}$ @ 22 (wsg) cloud 3.15 K-S-30
same K4).

31 (3) $\frac{1}{5}$ @ 22 sun " " " " " , near hand, ob angle.

32 (4) $\frac{1}{5}$ @ 22 bright 3.00 K-S-12

Perfect - per
wsg meter.

33 [5] 32 wa @ 1 sec 3.00 S K-S-12

34 [6] 22 @ 1 sec " S

left side wall, from hand.

From front left corner of K-S looking toward stairway. On right are cleared terraces of K-S-2. To left are protective posts over K-S-1 masks. Crossing center of picture is stairway mound before clearing. Manuel standing in front of K-S-2 terrace F on a temporary working floor. Behind him is K-S-1 fill. Meter stick (open to 1.00) is standing against supposed K-S-2 stairway side-wall, at level of K-S-2 terrace D.

Bld. Plitden. (w. ob. Angl). Branch marks:

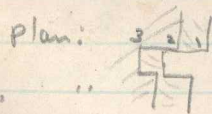

1 = br ush
2 = total
3 = selected m.s.

✓✓✓
35 [7] 22 @ $\frac{1}{2}$ 3.45 bright k-5
wide angle

([] skipped)

OK

36 [9] 22 @ $\frac{1}{2}$ ordinary lens

37 (2) $\frac{1}{5}$ @ 8 (Byju Mar 14)

38 (5) $\frac{1}{5}$ @ 22 10.30 Sun R-5-12

39 (6) $\frac{1}{2}$ @ 22 11.00 " K-5-2nd
+ 153

Stairway mound of K-5-1st; hemlet & friend:

Front elevation, K-5-2 terraces cleared on right,
masks protected by poles. W.S.G. standing
at base of K-5-1 fill wall under stair,
Manuel standing near 1937 lower trench,
near former location of Lintel 7 (he
is looking for more pieces)

Same subject, ordinary lens; K-5-2nd terrace shows
only a little to upper right.

Same terrain front.

Various stones (esp. cornic(?) - came down from
above (p.o.m. slope)

Top of K-5-2nd St wy., center. W.S.G. holding
3rd frag. of Lintel 7 in approx position of 1st.
Whisk on surveying level fragments - note
small ferns fill below it - this breaks down toward
center, but so does K-5-2nd steps there.
MS judds on surveying finishing plaster.
W.S.G. stands on solid stones above on
center line - probably fill. to be
investigated.

40 (7) $\frac{1}{2}$ @ 22 (WSS $\frac{1}{5}$) 11.20 Sun K-5-18
9

ms. on blinths of building extension (found
outside partition)

41 (6) " " " " "

Pllo, near hard - ms. on blinths.

42 (9) $\frac{1}{2}$ @ 22 2 PM Sun K-5-2

Rear wall of terrace c. Anasolio holding rod
at left, meter stick (folded) on face in center.

43 10 1 @ 22

2 PM Sun covered by clouds

K-5-2

Same from angle to right. Valentine standing
on top of wall.

44 III $\frac{1}{5}$ @ 22 - WSG $\frac{1}{15}$ 3.05 Sun K-5-3

Inside of rear building wall; face of bench.
Wsg holds rod on floor near left & rear corner.

45 II $\frac{1}{2}$ @ 22 WSG $\frac{1}{15}$ Sec 3.10 " "

Left inside wall of building. 1932.
Wsg near bench; ~~at~~ rear corner of left
anta has fallen into pit.

46 (11) 1 cc @ 22 8.15 Sun & "

Gen view from right doorway to K-5-18
ms & added; rod at bench end. WSG & Wsg

46½ (12)

47 (1) ½ @ 22 (WSG)

2.00 Sun K-5-2nd



Missing - had
Torrans

48 (1)

48½ (2) - Similar to next one.

49 (3) 1 Sec @ 22

2.20

Sun K-5-1

working out near wall of K-5-2nd. Boys
at lower level removing K-5-2nd
fill again at K-5-2nd.

loading into room from K-5-10 of center - not a lot
near corner of left pier.

Rear terrace "C" (upper) - showing building wall
(or a later phase terrace) rising from its top.
Pier at left portion m.s. c. 50 at right
portion, covered by fell stones a bit out
of line (see WSG plan to-day's date). Fall
wall of K-5-1st juts out to right of m.s.;
supported building wall running to
greater height to right. Road about on
level of base of terrace B.

Looking down and along above features,
from K-5-1st level.

(Probably)

Bld. Plnd from near -



brush on sec, side of
near of m.s.
m.s. folded

50 (4) / Sec @ 22

K-5-152

m.s. clust to rear corner of building; crayon on secondary flint, broken off in 1937; back at approx. position of rear corner of secondary side outset (destroyed by road & removed, 1937). Topo case on highest surviving stone of original side outset, rear corner of same.

51 (5)

End Sec. of debris just E of right rear corner. ^{of 13 ft.} m.s. @ 1.00, at about floor level.

52

Handwritten note: "Handwritten note" and a box containing "Handwritten note".

3.00 S. K-5-152

Left side

- Loose stone worked off. The head of pyramid is at right.

53

Handwritten note: "OK" and a circle.

K-5

General view of mound, before Mar 14. (Musk camera)

54

Handwritten note: "OK" and a circle.

K-5 (?)

Check up - probably Kld. outset, then rear.

✓✓✓✓✓
max 10m

Photo	Pr.	Notes	Bldg.
	54 1/2	① - Subject?	
3/27 (Min)	55	④ ✓	K-5
	56	⑥ ✓	
	57	② ✓	
	58		
3/28	59	① 1/2 @ 22 (Weston reading) wide angle	K-5
"	60	② 1 sec @ 22 (L.S. estimate) normal lens	Same
"	61	③ ✓	K-5
"	62	④ ✓	"

General view from far end of ball court.
Most of K-5-1 stony fill visible;
2nd steps hardly cleared at top.

General view of front of pyramid. Manuel, with level rod, standing holding rod on layer of chieos above which lintel 7 probably sat. (See W.S.G. 3/29 under K-5-2) Aristeo working at cleaning K-5-2 terrace D, Vicente - Rufino cleaning K-5-2 terrace E. Fill above K-5-2 stairway still in position on the right side of stair (high) and nearly full width below (i.e. to fill wall); steps of K-5-2 visible on left side of stairway down to K-5-1 masks, now covered with poles. Lump of stone in terrace D is subterranean wall facing to pyramid's left.

Gen. front view - topographic lens - rod on floor below probable lintel 7 block, as before.

Same, neg. 35m lens.

3/28 ✓
63 (6) 1/2 @ 22 (Weston) 11 AM Bright K-5-2
Wide Angle

3/28 64 (7) 1 Sec @ 22

M. 10.30 K-5-2

3/30 65 (8) 1/5 @ 22

" 9.30 11-5

11 66 (9) 1/5 @ 28

" 10.00 5-1

11 67 (10) " "

" " "

Rear wall of so-called K-5-2 building at highest standing point. Meter stick (folded) on face of wall. Whisk broom on face of wall at left of picture. Pick standing at base of wall at right of picture. In foreground, marked by scale rule, are 3 stones, formerly on end of possible fill wall, (removed) which may be part of K-5-1 terrace (not elsewhere found on back of pyramid).

Subphase of rear wall of -2m. v. h/dy (cod + d/d)
Fill of terrace C (near) + rear entrance of
K-5-2 h/d, covered at left.

Gen. view - tower beyond ^{just} Ball Court (same place as before).

Gen. view from tower (same place) - Post corner in foreground. Sixto in distance working on stela klinto.

Looking more broadly down Court, same place as tower.

✓
✓
✓
3/30 68 (10) 1/2 @ 22.

Sun (C) 10.45 K-5-2

Plaster falling off terrace F, left side. Road beyond is cut out; pencil among plaster cracks.

" 69 (11) 1/50 @ 8

Sun " K-5

Get Big terrace near left corner of K-5-2nd.

" 70 [5] " @ 5.6

" K-5

Gen view from left side - ord. lens
Rud at K-5-1 w/o music track; cut section of K-5-2nd fill behind it (to right in photo - Bay window behind till wall on Terrace C (subter) of K-5-2nd. See beyond ~~terrace~~ ^{terrace} ~~and~~ ^{and} ~~section~~ in section of Stannifell (cut up, the median till wall for).

71 [6] wide angle
wide open @
5.5

Sun K-5

Gen view same position but looking at side cuts, dumps etc.

3/30 72 (11) 1/2 Sec @ 22 Br. Sun 2.00 PM K-5-15

72 1/2 (12) 1/2 " " " " " "

3/30 73 (17) 1 Sec @ 22

3/30 73 1/2 (18) ?

74 (19) " " " "

75 (20) 1/2 @ 22 Br. Sun 2.15 K-5-30

NB This is in line of
front (left) of
the one which
later down

Top of center fill wall main story (m.s. against
it); farther down, fill which was behind
another in foreground, fallen; this shows
farther down (boy with rod to mark it).
See sketch plan, L.S., this date.

Base of fill wall on terrace "C", against "B"; the
highest K-5-2nd terrace m.s. @ .50. A good
fill wall. Shows K-5-1st terrace
this high. (not good enough for a
well?)

good view from beyond left rear corner (in dump).
Rod at K-5-2nd terrace - 3rd 3/4 wall
beyond ~~the~~ behind, in cut to right.
- same features from tower on rising ground
behind pyramid.

Face of story fill wall (W) on L.S. sketch,
except at top where (X) survives.
m.s. on step 15 (counting from top) 2

NB No change in nos 75 - since no 73.

Rear wall, outside - Masonry. fill wall runs out
left to K-5-2nd terrace C, cut here. This is
+10 m on plan Point 25

3/31/76 (3) 1/2 Sec 22

K-5-2nd
+ 3d

Block of fill against K-5-3d. Note brush as level of small fine fill (white) about .15 thick, over fine rock fill (medium large here).

Red is against K-5-3d wall which looks off rather regular, just to its left; fill wall just to its right + under brush (which is in same position as in No 75).

7/31 77 (4) " " "

No 4000
No 4000

Same block from further left + almost over butt of K-5-2nd + 3rd. Brush in same position as in 76, red stained slightly to left. The S. @ indicates approximate location of broken plaster. Plaster appears in two of these stones. Evidently from center to left there was bad settling, the plaster crumbling and the wall settling at rear. From point shown, wall stones of K-5-3d rear wall were all out of place, mangled with fill, but toward the bottom, one or two would show up in semi-position; but no broken plaster was

3/30 75 (5)

3/30 78 (5) 1/3 sec @ 22

" 79 (6) 1 Sec

(discarded)

80 1/50 @ 16

81 ②

82 ③ - OK

④ to ⑥ =

(6) 3 Sec @ 16 (herometer?)

(7) 5

(8) see after 11R

L. chud 3.00 K-5

See 200. 5/1

51

stela

mes

wsg.

been found yet.

The fill was under bush is 1.10 rd. of
Wsg found 25, that sham has 1.12 m
left of same point giving a block
1.22 x depth of fence.

The left fill wall of No 77 - eastern end of
K-5. 3rd near face of rear wall to left of
rod; m. 0.20 against the fill wall
brush replaced in same pos. 1 cm as in
others. Still note small hummock at
top under K-5 - 2nd of look.

Preparing to turn stela (for moving)

Bit of wall of podium, to left of stela as
found. Upper stone with panel may
come out. a certain wall.

mes

82 1/2 (2) ✓

Finished V. 410 & Roll + 5x7 Apr 1 in camp

4/3 83 (1) 1/50 @ 5 Br. Sun 1045. K-5-3
Cut off - can use #1

84 (2) 1/50 @ 11 " " " "

11 85 (1) 1/50 @ 22 " " 1105 K-5-1
2 - blank.

Rt. Pump, from Pys.

Fill wall against left side of terrace A.

Left rear corner of terrace A - falling to rear. Rod end base of terrace C of K-5-2nd, cut off to point 3.90 right of this - 3rd corner. Note that K-5-3rd terrace bends \pm and under it - see sketch, L.S. this date (Apr 3).

Cut section - Rod in angle of fill walls rising ^{at rear,} from K-5-2nd floor - pick against \pm of these, which runs out (apparently) in \pm lower bend to outside corner - if so, only below the good hollow wall seen in section marked by meter stick (2.80). Brush is on the longitudinal wall we thought was building wall. See notes at top, falling slab debris from K-5-1st building.

✓ ✓
4/4 86 [] 1/2 @ 22 3.00 PM Sun K-5-
(near)

Gen view from tower just rear of
terrace "C", in line with left hand door
of K-5-34. Rod at left rear corner of
upper terrace; Gaze on bench at left rear
inner corner of temple. Brush (if it
shows) on terrace "C" butt, and back
by trench along rear of K-5-34 upper
terrace, which leans in recess as it
runs toward tower.

4/4 87. ^{OK} (3) 1/50 @ 8 " " K-5-152
+ 2nd

Same features as in 85, from tower
in above position pick in same
position, other markers missing.
Trench supports plant over supposed
corner of fill block.

4/5- 88 [2] 1/50 @ 5.6. 10.00 Sun K-5-

a little thin but OK
sharp enough

Gen view from ground - center of alley,
6.00 in from far end of K-6 Ball Court.
Note Pancho's stumps: upper mask cover removed.
sticks covering right mask covered by
dud in front of stumps.

4/5 89 [3] 1/50 @ 8 10.15 Pro Sun K-5

OK LIGHT
STRUCTURE END

" 90 [4] 10.30 " " "

91 (4) 1/50 @ 8 " " "
92 (5) " " " " "
93 (6) " " " " "

4/5 { 94 - left rear dump (7) (8) (9)
95 " side " (10) (11)
96 " " " 2.30 " K-5
97 " " " (trunk and front)
98 Right forward dump
99 " side "

3/ 100 (4) Toltec after 52, same day 5-1
30 101 (5) " " "
102 (6) " " "
103 (7) " " "
4/2 104 (8) " " "
" 105 (9) " " "
" 106 (10) " " "
" 107 (11) " " "
" 108 (12) " " "

general. from angle oblique part (as over dump). Note Panchos stump. Lower to ground standing in a stark. sidewalk from top.

AD side, from side. Boy with rod over position of other music slabs. Note trunk, line W to E of K-5. 7 not behind it.

Panchos Trunk (AD side of Pyro main stony. " " " (after falling).

all but the extreme right dumps, from stump near K-5-1 middle doorway.

many stela 1 } Many Stela
Camp ruins }
" }
" }
" }

✓
4/2-109 [9] } Per Wsg
" 110 [10] } meter.

" 111 [11]
[12] - Blank.

4/2-112 (7) - memo
(8)

113 (9)

114 (10)

115 (11)

116 (12)

4/10

117 [3]
[4]²

Per Wsg
meter.

old
Pock

Personal

"

Penning-
Sitting room.

M.C.S.

Wsg.

Penning-
Sitting
room.

Same

By chimney
tree.

K-5-3d

Staff + zenite: Godfrey + one
man missing.

- Same, with Satterthwaite missing.

M.C.S. + W.S.G.

ad dense in laboratory

ad drawing boxes in porch.

Staff address. Post cards?

Staff with Pen Vector.

- Post cards?

Fill wall in side trench: 1.65 out from
poker pen. + eraser - basic at level of
floor at its base + if wall runs
down from here.

✓
[5] K-5-31
un do other @ 1 Sec. No good

[6] - short d.
[7] - ?

[8] } no good.
[9]

10/11/19 OK
[8] - 1/3 @ 32 11.00 Pn. Sec K-5-30
+ 2nd

10/11/19 OK (1/2 h. 10/11/19)
[9] 1/10 @ 32 11.20 "

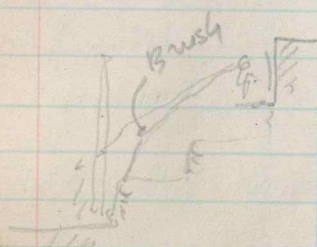

Mulle ab cones

Angle 5/100 @ 2.10
against 2d roller
Grove, base 00
+ low level

Roll ab dump level,
against till wall

(which may not reach thro' low)

Brush on ^{cut} edge of new fill - P. 1/2 against
cut to it (stand 1' soft yellow earth -
- from tower on

Scant out over from tower on left dump

Apr 12 16 $\frac{1}{2}$ @ 16 on wide
angle

120
OK

Sun 10.00 K-5

① to ④, ⑤ below
⑥ + ⑦ - caryacis - See Nos 141 to

121
OK

12 $\frac{1}{50}$ @ 11

L.C. 10.16 K-5

122

① $\frac{1}{50}$ @ 8 *and off*

Sun " "

123

② " "

" " "

124

11 $\frac{1}{2}$ @ 16 (?)

10.30 K-5

Genl view from W/D + front (on lower dumps
Red at apparent lower K-5-1 step.

Cut section of fill behind masses has been
faced with our own rough ~~stone~~ wall.
Terrace A of K-5-32 is largely exhausted -
coming forward into fill wall at level
dump level, below + level of it.

Similar view (front part only, not not
to position -
Same.

Cuts on W/D side - K-5-32 + 2 red

Genl - from W/D front (same ^{of some things} ~~view~~, near
turkhanin). Manned going in front K-5-2 and
staying at plaza level. Chisel at K-5-1
lower steps, at side. Note slab 32
forward of slab terrace.

Apr 12	125	△ (7) (OK)	1/2 @ 8	Sun 11:00	K-5	Same tower position - K-5-2nd terrace
"	126	△ (8) (OK)	" "	" "	" "	- Looking down on stela terrace + plaza. Note low (now) walls coming out at plaza level. Bad conclusion of K-5-1 stela staircase.
"	127	△ (9) (OK)	" "	" "	" "	RO head of stela terrace. From same tower station.
"	128	□ (12) (OK)	1/2 @ 22 (50m)	Sun 11:15	K-5	Gen'l view from front. Same features.
Apr 12	129	△ (17) (OK)	1/2 @ 32 wide angle.	Sun 1:30	K-5	Gen'l view of right hand of stela terrace; central stairway to right.
"	130	△ (10) (OK)	1/5 @ 22	" 2:10	K-5-1	Stela 39 - m.s. @ 1:00 in corner of projecting wall. Camera at plaza level. Note bed rock.
"	131	△ (11) (OK)	1 Sec @ 22	cloud 2:15	K-5-1	Corrie + travel slots from the top.

Apr 12. 12 ✓ *OK* 1 Sec @ 22 cloud 2.30 K-5-1
+2

132

Apr 13. *OK* 3 1/2 Sec @ 32 (w. a. g. h. Sun 11.00 K-5

133

" 134 3 *OK* 1/2 @ 5.8 Sun 11.15 K-5

" 135 4 *OK*

" 136 5 *OK*

" 137 6 *OK*

" 138 7 *OK*

Miller

" 139 4 1/2 @ 32 (wat) L.C. 11.30 K-5-1

" 140 8 1/2 @ 8 L.C. " K-5

4/5 140 1/2 *OK* 11 + 12 Pulling and stumps in central doorway location of K-5-1 - from rear

From stela lens 0 5 paces out from music lens 0, 2 left of music - M. stick on Wsg found
D for K-5-2nd stairway (hobstrait) against K-5-1st fill. Note 2 steps of K-5-1st stairway being followed to right (away from camera). Manuel's trench in foreground.

Gen view from right front. Panzer coming from side of K-5-2nd stairway. Benj. following lower K-5-1 steps. Gen view - from just beyond Bull tower, on tower
Gen view same round of view as 133

Gen - rt side. From half piced over arch and base where lowest tower wall has been followed.

RD near corner of Rys. One hand thrown some stone over it. - same found on tower

141 ①

142

143

144

145

146 ⑦ - Personal

4/7 147 ⑤
Exposed face - Personal.

Caynes

Champion

K-5-1
+ 2.

94

4/7 148 ⑩ 1/50 @ 8 11.00 am Sun 4

⑪ " " " " 4

" 149 ⑥ 1/2 @ 32 wide eye. " " K-5-2
+ 2

" 150 ⑫ 1/50 @ 8 " " " "

quad view, tower beyond
right hand corner
of pyramid.

terrace
F. of
K-5-2

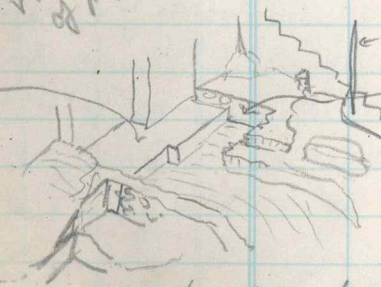

with terrace,
K-5-15'
extended to
4.00.

Bayhouts to which found
molded stucco.

Ben. coming in on Lot 5 cut; trends
beyond (Lot 4).

views from same tower station.

Falling at front corner of terrace E; note line of
stones, rounding under whic boom; coming
from outside, with beginning of apron masonry
there. Note terrace F round corner below, +
K-5-15' wall running toward.
same features.

✓
4/8 155/8 1/2 @ 32 (w.a.b.)

K-5

4/8 156 ① 1/2 @ 22/ L.C. 1.95

K-5-1

general view, tower at right hand (junction of trails, front of stela 39. (Same general location as previous similar views.

Basal Terrace, W side, m.s. @ .85 shows where wall seems to hook off; but base course seems to turn & run in. From here to about .70 (where big stone of wall might be a corner, is picked in about 60 (+.30) through dense soft earth & fallen mud & small stones.

Plan:

See later photos

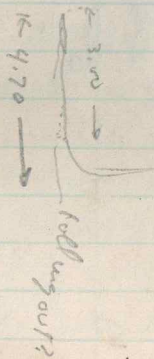

✓
1/8 157  1/2 @ 22 3.15 Sun K-5-Misk.

" 158  " " " " "

1/9 159  1 Sec @ 22 1/2 clouds K-5
10.30

1/9 160  " " " "

161  1/50 wide open (3.5) mod. clouds

Same view
telephoto

same view

CoD to dim of mosaic debris - side of 'K'
cent. 1.30 right of vt side wall, K-5-1st
story. Brush on stones ridg and from
mosaic or wall behind it.
Note block earth and base.

Same, from road. Post subject's mark

Pic added to inner
stair corner.

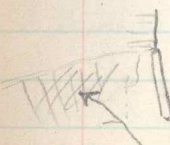

Block earth rises

Gen. view, beyond Bull Court station

Road at side of K-5-2nd floor col. altar -

K-5-1 niche just to its right (left of observer).

vt half of mosaic debris still in place, but

isolated. K-5-1 lantern now chains to

left of it. K-5-2nd story & int. terraces
rise behind

Same view

ok
1/9 162 2 1/2 @ 16 (w. ang). L.C. 11.00 K-5

ok
" 163 3 1/5 @ 8. Sun " K-5

ok
" 164 4 " " " " K-5-1
+ 2

ok
" 165 5 " " " " K-5-1

ok
" 166 6 " " " " K-5

ok
" 169 8 1/5 @ 22 2.15 Sun K-5-1 + 2.

ok
" 170 11 1/2 @ 32 wa. " " "

Gen view from casita station (of *united*).
Rod at side of K-5-2nd altar.

Left side basal terrace, from same tower
position. Steps picking up terrace
in pit while reaches ^{K-5-1} basal terrace opposite
steps; Anacua following base of basal
terrace toward center.

Left corner of K-5-1 basal terrace; working
and dulla of K-5-2nd behind it.

Stela 39 + its base, from same
found on tower.

Gen view - same position as 162.

M.S. fuddled on K-5-2nd altar; mark
indicates cut off step 'E' of stela this date.
Rod against full wall in 1937 trench. From left
same, from further front + little higher.

4/19 171 \square 1/2 @ 15 w.a. 3.00 Sun K-5

" 172 \odot 1/5 @ 8 " " "

" 173 \odot " " " K-5-2^w

4/19 174 \triangle 1 Sec @ 22 3.15 L.C. K-5-1 + 2

4/20 175 \triangle 1 Sec @ 16 (was 9 1/4 Sec) 7.20 Pull clouds. K-5-1

4/20 176 \triangle " " " "

Looney dam on basal terrace, left of st way, from base end to of K-5-1 stack fill. Similar vein to right of st way. 1/2 of mosaic debris remains.

Stone apparently embedded in floor of outer outside of terrace (bottom), left side. few w.s.g. notes.

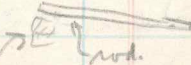
m.s. @ .50 bush, at ends of suppressed "pin base" "d" on sketch of this date. Rod on hobble fill wall (nd end) - left end on stones of "e" 

Cut section through addition to Basal terrace. m.s. on fill @ 20; had in apparent fill wall not on ledge at base of front wall (had good stone coming toward center (found wall behind these later).

Raising stela 38. Had 1 Rod in same places of stela base terrace beyond cut.

✓
✓
4/20 177 (12) 1 Sec @ 16

R-5-1
2

Left end of Basal Terrace, from side.
Pool at base, pond, near rounded corner.
Wall survives to height of brush. M.S.
@ rests against a hem of K-5-2nd,
base at base of apron, in line with K-5-1
side wall.

4/20 178 (1) 1/5 @ 22

Sum. II. n

Mosaic debris from rt; Pool at stair curb m=0.50

179 (2) 1/5 @ 16

L.C. II. n

indicates inner K-5-1. out 2nd (good only at bulk)
Same, from front (on plaza). Cuts A & B have
been made.

180 (3) " @ 22

S. II.

Mosaic debris
Left side of cut C. (I.P. cut B has been made.
m.s. @ 50 indicates done with line.
Brush shows position of ~~stone~~ 2nd basal
terrace top.

4/20 180 (4) 1/5 @ 16

S. II. K-5-1

trans. m.s. at inner corner of fill wall, ~~brush~~ ^{pick up outer} ~~brush~~ ^{exposed}
looked like a well in face of terrace, stepping here.
Brush indicates main fill wall (brush for
m.s.)

✓
✓
181 \triangle 5 $\frac{1}{2}$ P 22 S. 11.15 K-5-2
a 1

182 \triangle 5 $\frac{1}{2}$ P 16 L.C. " "

183 \triangle 6 ? K-5

184 \triangle 5 $\frac{1}{2}$ P 16. Sun. K-5-1
Basal
Removal

Tramul inserted behind K-5-2 front alter.
fill w/ wool straddle & runs back
m.s. @ 1.00 along its base, front end
at K-5-2 plinth. Branch indicates
covering plaster (top of plinth),
settled badly.

Same from front 184. m.s. shelled
along top of K-5-2 ~~at~~ ^{- broad} step
(thought it a plinth at first)
looking down on plaza, right hand front.

Cut section. 5 1/2 hours left of K-5-2nd story wall.
Not pierced of small fill under m.s. @ 1.00

187 1/2 (12)

1/24 188 (12) 1 sec @ 2.1

Same

K-5-1
Basal
Trench.

Right more upward, from front. rod lies on end
in center of central slots running in; m.s. old
beside main of rt. "pier" (fallen as it turned over).

See note of this date (L.S.). M.S. old 50; then were
corner looking stone here, higher up. Note wall
(f. 11?) behind.

" 189 (12) 1/50 @ 5.6

Same

"

Same from left: m.s. moved to
the forward broader edge.

1/25 190 (12) 1/2 @ .32 (w.o.)

Same

K-5-1 +
2nd
(+dp)

Rod on Pip. floor, at junction of center K-5-1
fill wall, which rises ^{K-5-2nd plinth +} over Col. altar
toward front. Ax head indicates base of
K-5-1 front plinth lens w. leans against
cut section of steps. Brush on mottled
plinth stone (.10 ~~high~~ thick) one layer higher
than layer of wsg's level point. Note that
pier runs down behind the plinth wall.

M.S. old 2 folds of angle of sill & end wall
of K-5-1 temple. To right, cut section of
sill near wall, boys hand on its rear
face stones. Note that corner face runs down
below floor level (near face of sill do not).

same, 2nd lens - (both from same
on dumped material)

191 (12) " similar

✓
✓
1/25 192 \triangle $\frac{1}{5}$ @22 Sam 10.00 H-5-1

" 193 \triangle " " " " " "

✓
✓
194 \triangle $\frac{1}{50}$ @5.6 " " W.S.G.

195 \circ

✓
✓
1/25 195 \circ $\frac{1}{50}$ @8 Sam 11.00 K-5

195 $\frac{1}{2}$ \circ notes going by H-5

✓
✓
" 196 \square $\frac{1}{2}$ @32 (w.d.) " " K-5

" 197 \square

(12) - shanked (cut off)

Right pier from room near rd wall m.s. @ 80 is horizontal, its butt end about on W.S.G. blintz point (for level ??) - in line with side of pier. Note base curve below, horizontal.

Sam, from out side, to right. m.s. in same position. Note possible remains of no more curve on blintz. (This shows in pictures from tower also.)

Wandering most fragments: photo graphs on basal terrace; benches along K-5 and basal terrace.

→ stela 38 on edge; H-5 and terrace etc.

gent view from beyond Bull (low) (on ground). Red samphos. as in 190, 191,

gent view from tower (cos it a station) - right hand

" " " " " " - left hand.

✓
✓
4/25 199 \triangle 1/2 @ 22

Sun 11.15 K-S-1

4/25 199 \triangle 1/25 @ 22

Bright Sun 2 PM K-S-1

4/25 200 \triangle 1/5 @ 22

Sun 2.30

K-S-1

4/25 201 \triangle " "

" 3.00

K-S-1

Junction of Basal terrace left side, wall
with K-S-2. MS @ 100 on base level of
corn. (higher than as found), 90 below
bottom of apron, which ~~is~~ hovers off as
shams, white wall below runs on.

Right lowest mask. Meter stick follows curve of
the chin, badly broken on the left of the picture.
Paint brush rests on largest piece of upper nose
slab. 2 broken pieces of this slab lie in front
of mask on terrace. Whisk broom lies across
crest of K-S-2 Terrace G.

Trace of right pair (as is summary -
see sketches)

Wish on K-S-2 in center line, upper steps of
Basal terrace; MS, 2 lengths, on same line against
Inobob steps, on another rod as found lower
step on same line Cado Pod, center, 22 rd. of
this line, in horizon (paint brush behind it).

4/27 ✓ 209 12 1/2 p22 Sun 1.30 K-5-2nd (K1).

" ✓ 210 11 1/2 p22 " " K-5-1

" ✓ 211 12 " " 3.50 "

212 ✓ 212 } many stela 2 units (type) no good

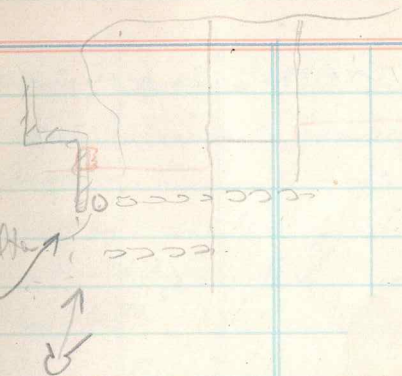

Friend of Tenoo on K-5-2nd - "in the to right. Trends at 6/0 to fill wall (of 1937)

Some, showing full wall of niches (intermittent) by a transversal fill wall, showing the better stone of the rear of niches as in continuous wall

39-211) same as ~~211~~, from left hand.

4/28 ✓
 (3) 1 Coc @ 22 Sun just K-5-1
 lightning
 tree tops (7.00)

213 ^{rk} $\frac{1}{2}$ @ 4
 " 214 (10) ^{blanks} 50 @ 3.8. 8.00
 215 ^{rk} (5) $\frac{1}{2}$ @ 32 w.a. 10.15 (K-5-2
 " " " " " "
 216 ^{rk} (11) $\frac{1}{2}$ @ 80 " " " "
 217 ^{rk} (12) " " " "

Fragments of cluser on loose group of 10/0
 reboxed in approximate position indicated
 by Anuelio. Triangular groups on top
 indicated by 3 pencils in position, piece on
 top indicated by knife in approximate
 position (both of later examined by L.S.
 Section of letter (like big piece to 10/0) is
 See sketch this date.

 genl view - tower of Casita station. Bays on
 center axis
 Wanderer's nose -

genl view - casita tower station.
 3 bays on center axis; plaza, basal
 cluser + (with rod) behind K-5-2 2nd
 altar -

Saw - bays coming down.

Same stat. - looking down on end of
 basal cluser.

✓
✓
4/20 ^{ok} ⑥ 1/2 @ 32 w.a. Sun 11.00 K-5

218

219 ^{ok} ⑤ 1/5 @ 22 ^{Point 6?}

220 ① 1/5 @ 8

221 ② 1/2 @ 32

222 ③ 1/5 @ 22

223 ④ " "

" 11.30 K-5
201

1.20 K-5
most

117

Gen View - same Sta on left hand dump
(same as others. Bays on center axis
at Plaza, base of K-5-1 main stony,
behind altar of K-5-2nd (with rod);
near front corner of K-5-3 building; again
before its ~~plaza~~ upper terraces;
front of left side wall of K-5-1
basal terrace.

Same station & view, ordinary lens, ~~small~~
Vaughan lens.

Same gen. view, small camera.

Gen view from ground, just beyond
Ball Court.

From near base of K-5-2nd story, looking
up (it was never seen thus).



Gen view, below " " " "

4/28 ✓
224)  Joseph D.

K-5-ny

old Amalgam from Plaze.

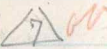
m stacks @ 1.00.

225)   OK

K-5-2 ny
+ 1.

Red in hand edge K-5-7 and pyramid. Pick's stone
under base of 2 K-5-1 stacks. MS @ 5 folds
against flint (or other stone). Pencil on bed of
fracturing plaster not done (black) east (same)
flint, from MS. this may also (probably in the
plaster). We've indicated another fill wall (horizontally)
- looking further to rear. Brushed double MS

226)  spoiled



K-11

hard of and on sill of (ample K-5-1.
others same eroded on second steps

C.P. flint (horizontal)

227)  OK

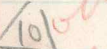
Same as ~~225~~ ²²⁵ objects in same place +
bay moving fill wall corner as rear
(see other photos + notes of this).

228)  OK
229)  OK

Plaza
(K-5)

from top stamp in K-5-1.

- right

- left

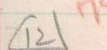
230)  OK

K-5-1

cut section - object same place as 30-225
+ corner in K-5-3 room, on same fill.

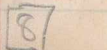
231)  OK

Bldg

K-5-1 +
2

Same position - object same - good margin
near fill wall corner

✓
429 ^{OK} Δ 1022 Sun 9.50 AM "Tigo"

232

233 ^{OK} ⊙ 1/2 @ 22 " 9.00 K-5

234

^{OK} ⊙ (9 to 0 cm) " " K-5
1/2 @ 16 w. d.

235

^{over} Δ 1/2 @ 22 9.45 K-5

236

^{OK} ⊙ 1/2 @ 32 10.00 S. K-5

237

⑤ - shown

238

⑥ ^{OK}
⑦ ^{OK}

K-5

"

gen view - tower left of left corner of
K-5-1 basal lens (at the corner)
30y on center axis (down to base)

" 2 boys on center axis

gen view - from ground, 3 1/2 m. inside
R. Com Valley (near end) retail

gen view, tower 1 m behind above
basin. Rod behind K-5-2 altar; many
hole on calcareous K-5-2nd axis, plaza
level. Shovel (held by boy) on board
right hand to be axis by meas. from
rt side of stony at base

same position.

"

4/29
239

11

2 loc @ 22 Sun 9.45 K-5

(lephoto)

Gen view same tower base - white

240

12

1/2 @ 22 " 10.15 "

" " - from sta. just beyond Ball Court. Tread (white band) on center line of court comes 20 ft to S of Ball Court axis. Post range hole on N-S 2nd story axis acc to Wsg early drawing.

241

4

1/5 @ 22 S. 10.30 K-5

Gen view. On play 3 meters beyond steps of theg. stairway, 1/2 hour end of lowest steps.

242

5

" " " " K-5

" from lower S + terrace, ground level of Sblat - loosely across Ball Court at angle.

243

11

1/2 @ 32 W S 10.45 K-5

Gen view, station near 7 mps at right dump entrance.

✓
✓
✓

PK

OK

OK

OK
Rat @ 45
Stair
Stair

4/29
~~244~~ 5 ?

245 6 ^{247 to} 5 @ 22 S. 1.30 K-5

246 7 " " "

247 8 " " "

248 9 " " "

249 10 " " "

~~250~~ 11 - spotted.

~~251~~ 12 K-5-2nd

252 8

4/29 253 9 ^{Pair in kitchen?}

253 10

~~254~~ 11

12 } Resend.

255 10-11; ①-⑤ Resend. Main house

256 2 " "

257 3 Main group

shove (Ret mean 0277)

gen view - front elev. from plaza - left side

clashes

gen view, from l/d - on basal terrace level

view - l/d pond, Terrace F (on basal terr.)

gen view, tower beyond ball court
" " " ad pond right. Pinet
indicating.

" " same point (height in view)
ad Mosa

ad Mosa

May 1

258 \triangle 1/2 @ 22 Si 8.20 K-S-1 +
Basal
Tenuus

few tams looking to NW + near ward.
rod ± continues line of K-S-1 basal addition
this side of hook (± of subhoriz outcrop)
ms. @ 1.00

259 \triangle " " 8.30 K-S-1
Stela
38 base

same band on tams.

260 \square 1/2 @ 16 w. ay 8.45 K-S-1
ditto

Looking down from tower in front
misty indicates level corner. Rod at
base of inner stairway, brush in
position of cache.

261 \square " " 9.00 K-S-1

Open view, same tower position looking
to pyr's right. ms @ 1.00 on ledge of tower
indicates level corner of original stairway,
vert ms @ 1.00 against basal tams
Very doubtful Stela 39 base wall
beyond it. Rod at final st. outside
of K-S-1 pip. tams, formed against
original ~~stela~~ end.

262 \circ 1/50 @ 5.6 " " +
Godfrey

More of WS9 from same tower
horiz.

① + ② @ 1/50
③ or ④

May

263 [4] 1/2 @ 32 w.a S, 9.45 K-5-1

St. 30
38-39
Mura
at.

Oblongs same bloc, plus piece on blazes
indicates more extension of front wall
(at low level there).

264 (7) 1/5 @ 38 S. 10.00 K-5-1

Stela 38
base

No other subjoining walls in sight.
Plaza Stung. From same tower station

265 (8) " " " " K-5-1

main
stwy

same tower station.

266 (9) " " " " " " " "

" " " " " " " "

267 (10) (11) P. 0.00 (12) W. 0.00

" " " " " " " " Stung, but must be

268 (11) 1/5 @ 22 S. 10.30 K-5-1

From back end of St 5-1, behind
Stela 8. Looking across Ball Court

269 (12) " " " " " " " "

From center of Ball Court structure,
40 ft behind panel position

270 (13) - Personal (Pm Eugenio Vela
& Condepin Acopad)

x (14) - moved west

271 (15) - should be 271-272
described.

K-5
Stela

gen view from tower - right of Stela 39.

✓ ✓
 272. $\square 7$ $\frac{1}{2} @ 32$ w.p. K-S-1
Pencil 3m @ 75° - or - cause
stand a little less +2.2
 " 273 $\triangle 3$ K-S-1
 273 1/2 $\circledast 1$ K-S-1 $\triangle + \triangle$ Kensal
subject not noted
 " 274 $\circledast 2$ K-S-1 out of focus discarded.
 " 275 $\circledast 3$ K-S-1
 276 $\circledast 4$ K-S-1 $\frac{1}{4} @ 22$ K-S-1
 277 $\triangle 8$ K-S-2 +1- how many
luck.
 278 $\triangle 9$ K-S-1 10-12 of how many
Kensal Mages.
had slightly over
 279 $\triangle 4$ K-S-2 $1 \text{ Sec} @ 22$ S. 8.00

Same as $\square 57$
 Same view with 9×12
 Same tower heating
 " "
 " "
 Scuto shows baselign of cene walls.
 view to main, top side, from plaza - pass
 with 246 + 247.
 Found el. view from tower
 plaza level.
 m.s. @ 150 on steps + main + low. "Pact
 hab" indicated by travel. Note K-S-1
 fill stones directly on blocks, and
 boran condites which results.
 also block areas, apparently pr

✓
Mar 30 Progress

- 1 Gen view - 9x12 - front
- 2 Retail - " - plaster Ter. F.
- 3 K.S. - 3d Mos. " (Top rear)
- 4 Gen view - side - same on / on dump. 5x7 (roll on 9x12)
- 5 " " " " " " " (roll on 9x12)
- 6 " " " " " " " (roll on 9x12)
- 7 " " " " " " " (roll on 9x12)
- 8 " " " " " " " (roll on 9x12)
- 9 " " - dump side " " " (roll on 9x12)
- 10 " " " " " " " (roll on 9x12)
- 11? - angle shot
- 12 - vault slab on top (hang two together).

9/3
25/5 9/17
1/2 @ 22 S. 8:30. K.S. - 2nd.
from floor
after removing full stones, f.p. found
clean directly under all of them. Note block
areas. M.S. @ 1.00 + 1.00 + 1.00 on center
axis, travel indicates pass hole.

Cont on rd in BK 2.

V. S. ...
ten C.
← 2.50 →
hassell
fill wood

