

Field Photo Catalog
Nos. 1-280 (L.S.)
1937

36
37

1937
nos 1-235
(L.S. complete)

LEDGER

36)
1-23
Pal.

36)
24-27
various
places

36)
28/280

37-
/235

1937 for R-IP, a m.

Comer atkin - double + into it more
the beam is utility, reading is fairly
clean.

V. Chrom - double one, ditto, to be sure.
a test double + into is one,
using beam OK.

Scott ent h want

1936.

E
F
G
H
I
J
K
L
M
ME
N
O
P
Q
R
S
T
U
V
W
Y
Z

36
1-23
Pal.
36
24-27
Various
Places
36
28/280
37
1/235

136 2
137 3

Photo Round - L.S.S. - 1936

Film No.

12 1 ✓
5 2 ✓
7 3 ✓
9 4 ✓
8 5 ✓

Palenque

Church.

Alt

Alt

Alt

Alt

Palace.

3 6 }
4 7 ✓
5 8 ✓
6 9 ✓
7 10 ✓

N-3

N-4

N-5

N-6

Palace

NB F. CRESOZA USES 36-301 and up.

3

Plague.

Tobasco swamps, en route Oregan - Pal.

" " " "

Palenque village from the air.

Stucco panels & restored stairway on north face of substructure. One panel slightly restored.

Key to North Range Designations:

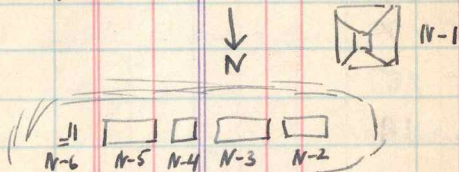

N-3 Mod. Wall Masonry.

N-4 + end of No. 3.

N-5

N-6

Folks Section of wall (nothing else remains visible).

From North group.

36
24-27
VARIOUS
PLACES

36
28/200

37
1/235

8 11 ✓

9 12 ✓

10 13 ✓

11 14 ✓

12 15 ✓

1 16 ✓

~~4 17~~

4 17 ✓

5 18 ✓

6 19 ✓

~~7 20~~

7 20 ✓

8 21 ✓

10 22 ✓

11 23 ✓

~~12 24~~ }
→

Polengue, 1936.

N-2

Facade + niched wall masonry (w/ arched
tobelo); stepped vaulting.

N-1

Pier Masonry.

N. group

From court below.

N-1

" " " (out of focus)

Temple

Group from NE corner of place, at base.

~~N-3~~~~Niched wall masonry.~~

Tower

- Dais at S. base, but to be altered by
Mexicans on court floor in pond.

South

Range

Full section of vaulting (out of focus).

Inscription

from N. range - out of focus

Temple

Group - from north range, at good middle,
roof level.

House H

South side of niched wall + vaulting,
from roof level of north range.

Tower

+ Pais, looking down from W end of House H

North

Group - from roof of House D.

Temple

Group " " " " - House C

+ Tower in foreground.

36
24-27
Various
Places36
28/28037-
1/235

12 24 ✓
 1 25 ✓
 6 26 ✓
 4 27 ✓

^{air}
 Boca Val Ceno from air - post.
 Key West - docks, winter station &c. via ship.
 Tobacco lakes, streams &c. - Ok. - Polengue, by air.
 Food w. g. Mahogany, Al. Oregon.

Pt d

36
 28/80

375
 1/335

Piedros Negros - 1936

7 25 ✓

~~7 28~~
8 29 ✓

9 30 } ✓

} see page 12

Lacandon Ramon LORENCO - Lacandon Indian,
 about 18 years old (young man), in visit
 from Xotol, inland from Pesempico.
 Same, with Mrs. Sattenthwaite.
 Same, with Bernard de Calmont (19/10)
 + Francois Godfrey-Pochaux.

37-

1/335

37-
1/335

Page #
 1934
 5 top
 Time
 Bound.
 Time of Day.
 Sun

4/3/36 9 30 ✓

4/4/36 10 31 ✓ 22 8 8 1.30 o. cut.

11 32 ✓

4/17/36 12 33 ✓

- 1 34 ✓ out of focus
 2 35 ✓ Embroidery - OK
 3 36 ✓ out of focus (Pan Leon)
 4 37 ✓ Setting out after turn - OK.

5 38 ✓ 11 1/25 (174) Pan - 21 mins 2 Tolon (17)°
 OK but slightly over 2.

J-29

Rt. side wall, outside of point. Not chipping; is there a crack just behind water sticks?
 Blocks of slabs with slab chipping.

J-29

End of front right wall, after wall at rt angle to it had fallen away. Note irregular end. The bottom stone huttly is early period, & is in line with another bound to rear plinth (See sketch).

J-29

Same, from angle. Note that pieces of nos. 2 is at angle to base (shown by stick; No 3 is red very smooth, though in line; that No 4 is 7 or 8 cm back (see ruler) lies on it;

J-29

Rt end wall passing over rear sill, against which + against rear wall, it abuts. Rt wall shows ad left (l.p. at. jamb of N. doorway.

Cayuco of Pan Leon leaving for Philadelphia with the Frenchmen Colman & Geoffroy-Pichon. Patron, partly negro, speaks a little English, smokes a pipe (Joachim Mani).

Test picture for bank development - studio - OK.

P/O F. No. Num. Stop Time Basin Hour Sun. Str. No.

Oct. 26 ~~37~~ 22 1/50 11 S Jonuta
 7 ~~39~~ 40 22 1/5 11 S "

Oct. 27 8 41 22 1" 2" 10.30 S J-11

" 9 42 22 8" 15" 3.30 S under trees J-9

10 43 22 1/2" 1/2 2.00 S J-11
 11 44 22 2" 2" 2.00 S.C. J-11

Remarks

Figure than drawing. Baldy under
 " " " OK.

At noon, found trench near left end, in shadow from
 roof only, placed for maximum light possible. 
 Developed in tank @ 78° degrees, 13 1/2 mins.
 appears o.k. (2 Tubes in tank full (48 oz).

Panels bound to breaks in floor 4. Meter sticks
 lies on floor 5, another stands on probable
 continuation of floor 6. Knife stands on
 concrete which is continuous with floor 3.
 Left metal doorway showing broken &
 falling due to stone luted on step-over joints.

Floor Complex Pick lies in Floor 1; tube extends
 few cms to rear of rear back of Floor 5 to
 point where it turns rear; then right to bend
 to trench. Fan pencil points to the edge here.
 This does not work in for side of trench due
 probably to ancient destruction, floor 1
 taking its place at this level. Plumb bob
 from shows corner of front back,
 string running along it for a while.
 See is behind pipe & rear doorway.

375

1/235

Put Floor No St. Time Base Hr. Sun. Str.

✓ 12 45

✓ 1 46

✓ 2 47

✓ 3 48

✓ 4 shored

✓ 5 49 22 ~~1/2~~ 1/2 9:30 Sun J-29

Finds of this near, + rt. to line running forward of plumb-bob, f.p. gives way to rough concrete surface of same floor. - a removed part wall?

Could explain the rear base yet.

Floor six is on bottom of shallow rear pit Baystands as lowest here f. ll level in deep part trench.

Same, from farther to front. 7c

Floor 5 in relation to plinth - not same, 7c stones below etc.

Floors 2 and 3 (plinth at left); 3 (crayon); 5/10
7 (same as 5?) (fountain pen); 6 (lowest pencil)
Same.

Inside of right end wall which rises over sill, about rear wall. Knife shows plaster on later running behind; brush is on sill plaster which turns up to side wall; to left of standing meter stick, sill plaster runs behind end wall (q.v.); also stands on remnant of plaster of floor 1. Pick head lies on

375

1/235

Date - F. No. / /
 Munkes / /
 Stab / /
 Tins / /
 Beans / /
 Hours / /
 Sun Str. / /

Apr 30	50	22 2" 2"	10.00	S	J-29
	51	22 4" 4"	3.00	S	J-29
	52	22 4" 4"		S	J-29
	53	22 4" 4"		S	J-29
	54	22 4"		S	J-29
	55	22 8" 8"		LC	J-29
	56	22 4" 4"		LC	J-29
	57	22 8" 8"		LC	J-29
	50	22 1" 1"	9.30	S	J-29
	58	22 1" 1"	9.30	S	J-29

good surface of floor 2, which appears to
 turn up to sill, & which runs under and under
 Flood ditch is on floor 1, no surface there.
 Same as no 49, from below back of right
 pier, camera just forward of rear wall.
 (Museum lens). Fogged over

Rear wall & blinth, general view of top, from R. rear
 RT Facade, early period.
 " " - front end
 From tower at rt. rear - the perforated stone
 comes from debris at the other side of building
 From tower and rd rear - view showing rear
 From level of bottom of "steps", 2 m from - rd end
 From tower, head of rt corner looking down
 Same as 50
 From same position as 50, wide angle.

37-
 1/235

Sky in
 foreground
 visible

OK

OK

OK

OK

OK

OK

Photo Film No. Room Stop Time Base Hour Sec Photo Str.

May 2 5 69 22 8" 4" 8.25 S 5-29

May 2 6 70 22 2" 9.00 VLC 5-29

" 7 71 22 15" Left (changed) VLC 5-29

to do c's beyond which 23 ✓

causes you to lose way

Left facade from same, wide angle.
Bay stands behind near second
any terrace, much reduced, just
left (at in photo) of its junction
with original near better
terrace wall or "plinth".

Soil on of rear fill, hematite site. Note the
beginning of slab work at top, apparently lying
in a layer of small fine rubble; this on way
large stones, these are ^{a another layer} ~~of~~
small rubble, which lies in large stones
mixed with small, with earth, or
mortar (yellow). More or less the same
thing occurs in central pit - slabs in
mortar on layer of small rubble on layer
of large stone, the next layer of small
stone is not so clear now, but more or
less apparent.

Rt side: small meter stick indicates
break in plinth masonry thought
cross. by to equal ^{width} ~~width~~ of room. OK

37-
1/235

8 Photo Flasher
 Num. Stop Time Base Hours Sec. Photo. 8+r.

6 72 22 2" 2" 9.20 LC J-29

over-m. lens.

6 73 22 2" 2.30 L.C. J-29

Museum
 July 12

9 7 74 22 4" 4" 2.40 LC J-29

8 75 22 4" 4" 2.50 LC J-29

11 76 22 4" 4" 3.00 LC J-29

13 77 22 4" 4" 3.10 LC J-29

Break in higher near plinth travel. Shows stick used in stone and right angles which passes front of plinth stone at level of tunnel (from plinth level, 1 of next small stone, under large one above. This stone under stick is much thicker than the lower stone in the latest side wall, on the same of which is the room. The region under stick had probably settled when latest wall was built. See sketch.

general view from left hand corner of pyramid. The floor to right in picture is an early one. ~~at left~~ also left doorway mass of earliest floor material remains. Note that pier goes down to earlier floor, on which they were built.

Same, wide angle.

Same. " " , from front.

" " " " from, at right

Same as 76, regular lens.

37-

1/335

May 4 1 85 ✓ 22 4" x LC NE J-9

2 86 ✓ 22 4" 4" LC NW J-9

May 4 3 87 ✓ 22 1/5 1/5 S NW S 29

hump 1/2
" " " "

4 88 ✓ 22 1/5 + S J 29

left rear end of rear partition
medial wall of J-12

Filled up left rear doorway. should
overlap with partition.

Method of protecting floor & sill during removal
of parts of rear + side walls (dirt covered
with burlap on floor, holes on sill)

375
1/235

Rt rear corner: Stone 1 in rear wall runs over .12

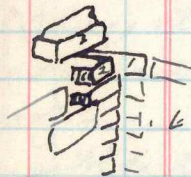

behind line of side wall. Stone
2 abutts it as expected
Stone 3 lies on 2, but
.12 is at (inside of side

wall face (as indicated by pencil), but it
runs behind plane of rear wall, beyond
hump (.20 or more behind. But it is
not square. - plan: 3 rear wall
this height was 2 either here,
or cont. with side wall. or stone 3
belongs with center wall.

5 89 22 8" 8" 1.30 S

J 29

Same cover as No 88, later. New system of numbers, has sketch to scale:
 Saw brush on sill; pencil to bed of this points to remains of plaster on inner face of late end wall. Note plaster on a wall running behind this. Red pencil was supposed to be in place if we indicate this. Yellow pencil (left points to remains of yellow plaster, probably s.p. now showing on inner face of stone 7, on which it lies. Which lies on top of large stone which is apparently in place as last stone but one on outer face of original end wall. This looks from outside, N. side of Bldg:

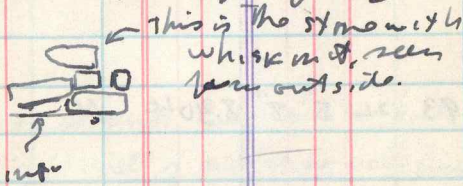

This is the stone with
 which in it, seen
 from outside.

6 90

J 29

Similar view, from farther away. OK

375
1/235

May 6 7 91 22 1/2" 1/2" 9.30 S N S-29

" 7 92 22 2" x 10.0 S S-29

May 8 81 93 22 8" 8" 8.30 LC N S-29

(9) \square (retaken - with addition of stadia rod on floor 3 just behind turn-up supports to belong to floor 1 as the other things in same places would not meter stick would placed as stated -

Broken-off end of early right side wall of chamber. Meter stick is on a stone of this which was under first floor near wall. (stick is on stone # 3 of sketches of Mays). See South with on sill; travel on lead & lower stone of outer side of this early wall points to T.P.'s point. Whose is on the outside "plumb," above level of top of sill.

Looking down on same, travel which meter stick in same places. Cord marks line of inside of latest side wall of which one stone remains was sill, many to full height to front with a house between. Cord runs angle about 10 forward of base of sill.

Found steps, all levels. Early - note the partially remained side wall of early steps, seen from front - the line is slightly left of lower travel, which marks bottom of hard lower corner stone. The floor top of this dead in front, turning up to it, also passes beyond. Therefore best dates earliest

37-
1/235

Period. (Floor 3?); the front tread has f.p. on
 head edge, marked by pencil ~~in next picture~~. In
 the trends all tread lowest course is torn out.
 Hand piece points to top stone of next riser,
 one course being removed in trends. Where
 on other side shows base of "bolustide" on
 this level. Yellow color shows the same.
 Vertical meter stick stands on f.p. of this
 tread, near its rear. Note the possibly that
 main plumb, in hand of cuts, was added
 late, to bottom member above ~~second~~^{steel brash}
 whisks. Heavy gray f.p. in place below
 root. See sketch of May 6 for f.p. position
 - it does not show very well.

May 8 9 94 same NW J 29

Same, from hand of ^{left} right pier Pencil is added to
 show hand yellow thick f.p. on edge of earliest
 lower step.

" 10 95 " " " NE J 29

S cemo

37-

1/235

cuts, which pass across end of this old wall base at this level (probably there are no more of late wall below). Trammel shows floors 2 and 3 which end against the old base. With scrub brush is on a remaining stone of latest ~~use~~ side wall, the others being removed from sill to the beams - verso rules. Note that floor 2 at 6 had to pass under them to reach this old base, inside.

May 3

103 ²/_{4.5} ~~7/10~~
104 ²/_{4.5} ²/₁₀₀

L.C. 130 P. 22.

230

Cayuco

Cayuco (small) of San Casimiro at round of ~~etc~~
Pedros RegusRem of Mrs. S. shooting P.N. round. ~~etc.~~

May 11

7

105 22 2" 2"

LC 10.00 Fred

S 29

Filled up nicho Lower panel across pieces of broken lintel which apparently can clear across to right (interior) side of old niche. The stone above this & below the other panel ~~to~~ runs over left side of old niche. So does corner stone on the side of the 3 pieces fit, as they almost surely do. therefore, filled

37-

1/335

Date	40 no. on film	Field Cat. No.	stop	Time given	Meter Time	Time of Day	sky	Direction from	STC or operation	Description + Notes on what is taken	41 Film satisfactory or not?
Nov 11	11	106 ✓	22	1"	1"	10:15 LC		NW	S-29	up wooden lumber space & else would Yarn down RD pier auto, front corner	OK
	12	107 ✓	22	1"	1"	10:20 LC		NE	S-29	Same pier.	OK
	1	108 ✓	"	"	"	10:30 LC		NW	S-29	Left Pier	OK
Blank	2	109 ✓	"	"	"	10:35 LC		NW	S-29	Same Pier	
	3	110 ✓	"	"	"	10:45 LC		SW	S-29	Rt pier, l/s rear corner	OK
	4	111 ✓	"	"	"	11:00 LC		SE	S-29	Lf pier, at rear corner	OK
	5	112 ✓	"	"	"	11:15 LC		S	S-29	At feet of rt doorway, side wall torn out except at bottom. 2' 0" meter stick on floor; at rt, met. stick is in line with rear face of auto, showing projecting stones in front of it which had in to side wall.	OK
	6	113 ✓	4	4"	4"	11:25 LC			S-29	Rear auto (side wall torn out except at bot) rear (at side)	OK

37-
1/335

7 ✓ 114 22 4" 4" 11.45 C

J 29

Rt side from rd near corner.

May 13

8 ✓ 115 22 2" 1" 8.45 C

N.E.

J 29

Rod against left side wall of early niche, bays hand over left near corner. Stick in later niche.

9 ✓ 116 22 1" x 7.00 $\frac{1}{2}$ "

NE

J 29

Left end of Chamber, from tower. Rod is on sill. The floor is #2, the end wall the latest. OK

10 ✓ 117 22 1" v 9.10 $\frac{1}{2}$ "

NW

J 29

Looking down from tower on the stub of Period 2 at end wall, the inside of the later end wall being marked by remnants of sill & on floor (floor 2). Stick is in the stub, rod at near corner of part "blunk".

11 ✓ 118 22 2" 2" 9.30 "

J-29

Turns berries, rt corner, looking down OK

12 ✓ 119 -- 1" x 9.45

J 29

Rt end of room. Floor is #2 - shows bit of old end wall, later shows as left + remnants on floor & sill. OK

375
1/235

May 19 126⁸ 22 4' 4.1 3.00 LC NW 5-29
 126⁸ 22 4' 4' " LC

May 20 [2] 127 22 4" 9.00 v.l.c. SW J-29
 " 128 22 2" 9.05 " " " J-29

NO pair of Pseud & over sum of Pseud 3i. Stevie
 & brush on earlier level (floor not clear
 here - probably lower. Behind & above brush
 & floor 2. on floor of P. 3. Early pair has
 settled - stick & brush are .05 to 10 below
 floor 3 - & note include of plinth slabs
 so found. See then the ~~floor~~ level white
 plaster, presumably of floor 2, despite of this
 indication. Shanty settling occurred before
 Pseud 2.

Cache bowl at end with broken cover -
 bowl, in position before moving. Extends
 into bed on floor 5, its shadow on floor
 3. Knife & pencil indicate limits of floor 3,
 where it was broken to bury bed from above.
 Note contains cemented rubble rising from
 below to above floor 3 level, between these
 points, & forming (near center) a hollow
 dome (rough case of the cover bowl.)
 Note contains surfaces of floors 2
 over bowl (we have broken this a
 little in looking for various layers.

12 129 ✓

③ 130 ✓ 22 2" 2"

1 131 ✓

1 132 ✓

5-29

"

Photo taken up of floor 3 against sill - & the same for floor 2 further from camera. Same - But pencil is moved on left side of cut to show correct limit of floor 3 wrongly shown before. Same from above - markers in same places.

Saw pen above, later. Not how the floor 2 b (dark base) goes way to pen white of later floors 2a. Only 2 surfaces of 2a noted above bed. There is a pen white plug roughly 2-a, over the bed, which cuts off the floor 2-b. A piece of this went on to north (in picture) to mid edge of floor 3 (see earlier photos. A piece near the photo pencil was taken out by workmen in discovering the bed. I have chewed off some from the left side - i.e. although the hole for bed may extend under 2-b, it was probably hollowed out a little from same side I am working.

375
1/335

1 May 21 3 ~~129~~ 22 4° 4' 8.15 L.C.
133

7
4 ~~130~~ 22 2 8.30 '5
134

5-29

Revisited aula, from room. Pencil points to Period 3 corner, underneath Period 1. Pencil & article are on P. 3 plaster floor. Note that P. 3 aula has been torn out, back to the rear corner stone - but f.p. still appears under the later stones, all the way to front. The head stone being mostly ~~cut~~ - very dark but always a little mottled. I'd say grey ~~too~~ in this bldg. like the supposed floor stuff. Note lean up of floor 200 front. Pushed right on floor 2 ~~st~~.

5-29

Left pair & left aula - see Period 3 ~~room~~ corners, about .10 in front of Period 1. This is true of all rear corners - no head. ~~to~~ left corners of pairs .03 to .04 in, others on line. 20 aula corner missing, left in line.

375

1/335

cur

✓ 137 7

Missing

May 25 ⁹ 138 ✓⁰ 139 ✓16 ⁵ 140 ✓

16 141 ✓

17 142 ✓

18 143 ✓

19 144 ✓

curved cast. These are just under the
slanting slot in the base in center of
space, 40 up ~~on~~ to base floor. This is
same stuff as the last piece with cast
Same from debris over at rear pier ✓

J-11

R 3

Looking down in 600 near corner of substructure

R 3

" " " " 600 side at center to rear of same

R 3

Substructure - left side from 600 & rear.

R 3

Wide angle - beginning of inset 600 rear corner.

R 3

Left side from R-4. Before removing secondary
stones blanking in left corner

Q 3

" after.

R 3

Reins ^{left} ~~Reins~~ ^{at} rear ~~Reins~~ ^{at} point
() (at top). This stone has been pushed out
somewhat, with other stones at this level in

37-

1/235

May 27 145

May 27 146 22 2' ?

S.

~~May 27~~ 147 22 2"

June 16 ② 148 22 1" $\frac{1}{2}$ " 9 am LC NW

" ③ 149 22 $\frac{1}{2}$ " $\frac{1}{2}$ "

SW

529

Panel

511

Rear Room Throm & debris in time. Thin slots under knife were replaced by in wood case of reaction. Photo thin slots associated with orange & light yellow mortar. One hole with head of concave jaw  is seen under slot lower large slot. No water still below it (0.05 to 12 cms.)

513

Mid A. Army

513

General view. Brush is in top of doorway "negative steps". Note cornice & upper zone of extreme net.

513

Rear room from roof at ends Brushing before.

37-
1/335

⑤ 150 ✓ 2" 2" 9.30 r L C

3-12 NE end from, from roof of J-13.

④ 151 ✓ 1" 1/2" 9.5 C

J-11 Masonry near outer wall from roof of J-13
w. Mn 1/2 lens - turn double for full half rock

⑥ 152 ✓ 1" 1" 10.10 LC

J-4 Left rear corner of substructure. Small
meter stick runs under high, presumably
used corner mounding. Note lower
base for central mounding. The wall which
fills corner the used corner. Protrusion
round. road at 10 is parallel to
this wall on left side.

⑦ 153 ✓ 2" 2" 10.95 LC

J-4 Subst. at side of masonry. Small brick is on
broken secondary wall supposed to corner
used corner. Stick on floor at turn out, which
is without much question bound to original
side wall, forward of this. Floor has is clear.
Note fill below + (5 wall).

⑧ 154 " " 10.45

J-4 Same has side. No clear ~~corner~~ corner for
used, filled up. Large block in original
masonry - small one, table in latter.

9 155 $\frac{1}{8}$ " $\frac{1}{8}$ " 22 S

10 156 1" $\frac{1}{2}$ " 22 S

2 Blank (no exposed - stuck)

Jan 20 3 156 $\frac{1}{2}$ " $\frac{1}{2}$ " 22 LC 10.30 NW 5-14

~~Murphy~~

5-11 Ran from thru. saw ally taking into door joint.

5 11 Ran from outside and crawling. Meter stick on floor of lentil pocket.
 $\frac{1}{2}$ lens - turned over.

Left 20 side wall (very much frosted & wide outset, badly ruined. Stick at top is on high plinth or terrace top level. Stick at bottom is on ruin of outset which goes down to plinth level. The two heavy stones at top are in front of 2 mas. with a chunk in place and are surely in approx. position as final side of building. But they are about 20' short of corner; the lower one is not a squared corner stone, unless broken since -

375

1/235

Films numbered as shifts - including
Print

158	genl	N	5-4
159	genl	NW	3-4
with 175 160	Petrol.	E	5-9
161	Petrol.	NW	5-9
162	"	Same	
163	"	NW	5-9
164	genl.	NW	5-9
165	D.	NW	5-9
166	D	SE	5-9
167	D	W	5-9
168	D	W	5-9

Jan Program, of L.S.

Left near corner of Substratum, after ~~has~~
drawing part of secondary wall away.

Remains of rear wall

Left end doorway - inscribed joints.

~~Med.~~ Left med. wall doorway - vaulting.

Same.

Med. wall masonry & vaulting, left end of
main rear gallery.

RT end ^{of rear} from rear and above.

RT end room - SE end, ^{with} wall with vaulting.

" " NW " " wall.

" " - corner & filled-up doorway,
vaulting.

Same

375

1/235

168

P

S

J-9

Transverse wall masonry - filled up doorway
at NW end.

170

P

N

J-9

Left door jamb, from inside.

171

P

E

J-9

" " " "

172

P

SW

J-9

End wall at jamb - note joint line.

173

P

SW

J-9

Transverse wall masonry & raveling -
wide angle.

174

~~blip~~

E

J-9

Close-up of sculptured jamb-stone.
(MS919)

175

P

E

J-9

~~General~~ General mass of same.

176

Sub

NW

J-9

Substrat at $\frac{1}{2}$ corbel trench showing
beneath substrat masonry.

177

Jamb

NE

J-10

Rear wall & niches, at half.

178

"

"

J-10

" " " , at half. Note the
3rd niche (2nd from right in this section, not
cleared.375
1/235

179

D

N

S 10

Close-up of central of the three niches.

180

D

N

S 10

Pier.

(35) on J. A. M. program.

181

D

N

S 10

Pier (same pier? - (36) on Jan. program)

182

g

NE

S 11

Left rear corner, alley

183

D

N

S 11

Secondary wall at left end, outside.

184

g

E

S 11

Left hand ~~at rear part~~ corner, end wall,
secondary outside construction.

185

g

NE

S 11

~~Right~~ rear, looking down alley x o
terrace & steps system - from alley.

186

g

NE

S 11

- Same from above

187

g.

NE

S 11

Transverse + rear wall vaulting; terrace
system beyond - at rear of building.
+ throne room

188

D.

SW

S 11

Secondary partition, hobble window,
+ throne room.

375

1/235

mid 191
w/191
+191

189 g NE. S II

Throne Room - has w.c. well, doorway &c.

190 g E S II

Looking down in front of throne-room
out a doorway.

191 g NE S II

Throne Room - vaulted doorway to
end room.

✓

192 d. SE Terrace
behind
S-II.

Terrace behind S-II Throne Room.

193 g W S II

Looking down in it near corner; stairway &c.

194 g W S II

Sculpture, very poor.

195 g E Terrace
system
behind
S-II.

196 g SE "

show's high ballast wall behind S-II

197 g NE. S II

Throne room vaulting; T.A.P.

198 g N S II

Throne, seen above & to right.

375
1/235

199 P S S 11

RD near corner - junction with stairway
which it overrides; bld with rounded
pilasters which ends against it.

200 g NW S 11

Thru, from its front & above.

201 g SE S 11

RD end rock - niches in rear (NW)
wall

202 g SE S 11

RD med. driveway, vaulted

203 g N ^{and 2} S 11
stuy.

From bld & above

204 g NW "

" " " "

205 g NW "

" " " (lower).

206 P S S 12

Pier.

207 P N S 12

Same pier

208 g NW S 12

Secondary wall, bld end of front (outer)
room.

209	P		S 12
210	P	SE	S 12
211		NW	S 12
212	g	SE	S 12
213	g	SE	S 12
214	g	NE	S 12
215	g.	E	S 12
216	g.	W	S 12
217	P	NW	S 13
218	P	NW.	S 13
219	g	N	S 13
220	P	W	S 13

Room in
217

with
219

- Same as 208.
- Med. wall, same room.
Wall of end room.
- Outer pier mas., filled up doorway.
- Outer (hand) wall - at rt. end. - subst. r.
- Front end - substituted secondary construction.
- Joint at rt. end doorway
- There is rt. end - cut out. through "screen" showing front wall behind it.
- Med. wall masonry, through SW doorway.
- Outer wall, between doorways
- Med. wall, filled up med doorway. 2 1/2'
- Transverse - med. wall junction, n.e. end.

37-

1/235

Revised
masonry

221 p. E. J 13

" 222 g. N J 12

223 g. SE J 12

Revised
film

224 g. E J 12

" 225 g. NE J 12

" 226 g. N J 12

227 g. SW J 18
+
J 21

228 g. SW J 21

229 g. W J 21

Arta, from inside - corner masonry.

Mid wall & filled-up doorway - more
higher up than 219

Outer wall masonry.

Outside - junction with lincing - upper
zone. metal stick on slab of upper masonry

End wall (terrace end) - part of mod. doorway.

Outside - junction with lincing - mod masonry,
joint masonry.

Secondary wall at bottom near end of J-18

Thru room - doorway, ^{partly} filled up doorway,
sill of "window" in secondary partition.
No stone bending old piece to filler.

Similar to above - shows window,
wall closing first doorway.

37-
1/235

230 g. NE S 21

Throne, mod. ^{wall} doorway as its left.
 Not smooth plaster on throne seat,
 top of screen. From above.

231 g. S J 21

Final doorway, from floor of throne room.

232 g. N J 21

Throne - wide angle close up, from corner.

233 g. SE S 21

Left end of throne room, niche. from floor.

234-a g. SE J 21

Free end of building - doorway

~~234-b~~ g. NW J 21

→ throne + rt. end of room, window, from above.

235 g. SE J 21

→ free end of building - SW corner, secondary wall beyond.

236 g. S J 21

→ throne room - left front corner, niche, from above.

237 g. E J 21

throne, niche in vaulting

238 g. E J 21

throne, from above & to its right

375

1/235

239
~~240~~ P. W J 21

Left pier of Sci facade.

240 P W J 21

Mod + Transverse wall junction. They are bonded.

241 P E J 21

Left pier - inside same pier as 239.

242 P S J 21

"close up" of niche.

243 g NW J 21

Part, trans window, thru room, thru floor

244 g E J-21
J-22

General view of junction # of J-22 ins. No.

245 g E "

close up of same, outside.

246 g NE "

Looking into the connecting doorway.

247 g E

Similar to 245

248 P. J-22b (?)

Probably seen at corner, running down well below floor.

249

Fine

~~249~~

J-29

RD bend corner of Rowd III substructure,
with one side of panel.

250

R-3

Stones of row wall, abutted, seen in
section - probably not a complete
cross section however.

251

Court 2
Card
2

gen view from J-4

252

Pneilo.

253

P.N.
Figueras

Top, L to R - full face: E-1-168, E-1-169;
E-1-175; E-1-180; E-1-181; E-1-207

Bot - Same, same order, profile.

254

3

"

Top, L to R NE-4-42; NE-4-41; ~~NE-4-32~~ NE-4-40;
NE-4-32 - full face.

Bot. - Same, same order, profile.

255

"

Top, L to R, full face: NE-4-43; NE-4-78; NE-4-77;
NE-4-80; NE-4-66; NE-4-65.

Bot. Same, same order, profile.

375

1/235

256

PN
Figures

Top, L to R, full face: NE-4-105; W-16-30; NE-4-81;
NE-4-169.

Bot. Same, same order, profile.

257

"

Top, L to R, full face: NE-4-44; NE-4-33; NE-4-29;
NE-4-45

Bot. Same, same order, profile.

258

"

Top, L to R, full face: NE-4-51; NE-4-57;
NE-4-89; NE-4-169; ? ;

Bot. same, same order, profile.

259

"

Top, L to R: NE-4-54; NE-4-46; NE-4-47; NE-4-35

Bot. Same, profile.

260

"

Top, L to R: NE-4-79; NE-4-56; NE-4-64; NE-4-48; NE-4-67

Bot. Same, same order.

261

"

Top, L to R: W-31-60; no catalogued site at camp;

M-35-2; M-35-1; M-34-1.

373

1/335

262

5-29

263

264

265

Stucco

w-16-23	E-1-196	E-1-194
w-16-21	w-16-24 ²⁵	
E-1-185	S-17-13	

Cashed Pat with conventional ϕ & ϕ ps.
Col. No. _____

Same

Same.

these must be read
it to left to
agree with plate +
drawings.

E-1-196	w-16-19	w-16-19
?	E-1-194	partially E-1-196 w-16-21
?		w-16-24

375
1/235

266

D.M.
stones
Objects.

L to R (notes on left).

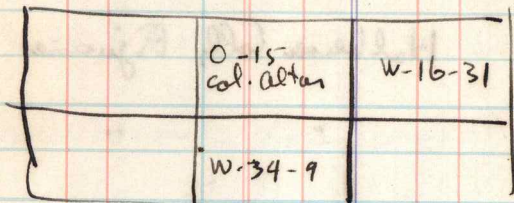

S-11-2 ← horizon line →

267

O-13

M. S. S. #180 - in sun, ~~photo~~ scratched.

268

O-13

" " - best negative. - ok.

269

Metates

gathered at camp.

270

"

" " "

271

F. gurnee. Nersayo Callo & curi.

L to R, both rows - 1, 2 & 4.

272

- same views (duplicate film).

273

LFR - 6, 10, 9, 8 (full face, lower scot.)

274

Same, same view, full face & profile.

37-
1/235

275

~~New~~ New Coll. Fig. 1.

276

Halberson Coll, Fig. 1.

277

" "

278

" "

279

" "

280

329

L to R

Nos. 7, 11, 3, 5. (both rows same order)

Nos (L to R) 1, 2, 5, 3, 4, both rows.

No 6 (Thru) - front view.

" " - Top + Bottom.

" " Side view (plus
Fig. 1 NE-4-51 (Pan P. 10) +
carved shed W-8-46.

Drawing of Penid 3 (KAP)

37-
1/235

1937

F.

March 30 1 3
 Mar 30 ③ 1 22 1/8 ? 11.8 E 1 S-2

④ blank

Apr. 28 ⑤ 2 22 4" 4" 9.00 R-10

W to
 new pucks

1937

Praxis - before removing fallen stones. ^{out} sticks on stone ①; pencil on ③, bush on ^{focus} ⑤ of sketch.

Left corner, lowest terrace. Trench cuts ^{of} secondary basal platform. Note stones on corner, about 30 000 over buried portion of wall. This was more like this, further out, opp. nearest sticks leaning against wall. present wall below. This "overhang" base all based on same level - secondary fill up of inset corner? Or good line of cleavage at bottom of chise, which is at this level. This condition goes to middle of round corner, & applies to worked curved stones there - if a fill up, the corner was rounded.

May 10 ① 3 ✓ 22 4" 4" 1.20

R-1

2 4 (spoiled).
3 - pulled - blank ✓

Right hand, 1st hyp. terrace. ~~BACK~~

Travel program points to stucco ornament
(over small slot on floor.



Pend. points to remnant of high relief stucco on basal ledge. (See sketch sheet). Banded trowel lies on mass of broken stucco. Note thin small slots between. They occurred to doubt this height over most of area shown.

Rear roller points to stucco ornament (FF) + other evidence on another, below & in front of it.

Fair stucco on good floor, which runs under panel & the pyramid. Banded brush on hand concrete & plaster indicating some secondary feature here, which we missed, or stucco design on this part of basal ledge.

Note big squarish block masonry
Note thin slots piled up on ledge near center (left by us from masonry).

Same from front.

+ over, ok.

May 15 (6) 7 ✓ 22 2" 2" 90.30 S. U-3

" 8 ✓ " " " 10 S U-3

May 17 (8) 9 ✓ 22 1" 1" 10.15 S U-3

" 10 ✓ 22 2" 2" 10.20 LC. U-3

(10) (bulbs)

(11) 11 ✓

(12) 12 ✓

U-3

U-3

lused, right side of substructure.
Hole falling out to rear, but good at

~~corner inset~~



OK
1 sq. under for
deep shadows

- RD front corner of ~~foundation~~ (comp) plants from side & looking @ slight angle toward front (x from below)

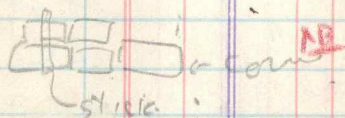

Piece at front corner of stuy; horizontal m. sticks on f.p. floor which runs under front wall; other sticks against basal ledge of inset corner.

From same setup - elevation view of front of inset corner. Hole m sticks on basal ledge, which is much settled. Note long tubular masonry.

- Rt. front corner of Bldg. Platform, with its basal ledge, from side.

Same.

① 13 22 4" 4" 3 30 S.

U-3
1st
SecondSlide on basal ledge; horizontal stick on high "basal ledge" OK

Note approx. vert. cut better.

Thick plaster (in section) vertical cut-off. Note line of later floor on above vert. in stick, below floor.

② 14 " " "

U-3

Masonry, rear part of closed corner, approx. level. OK

3 15 " 8"

" 2C

U-3

-12'

Max. rear of inset. Note little chunking, large tubular blocks. OK

4 16-a 11 " "

C

U-3

Same position, looking farther toward angle. RB. in stick is OBTAP point. Is there a filled up corner here? Second sketches along bottom corner, in good line.

5 16-X 22 4" 2"

v2c rear

R-9

Plaza Col. altar scuche. Markers indicate OK

6 17-a "

side R-9

rings hard. Note long thin D box kerf shoes stick in stone running under altar. Same - horizontal ruler shows after plaza surface level 25 above base of R-9 step. OK

May 20 7 17-22 8' 8" S 3.00 R-9

Union with platform of St. 25. *Under*
 Red m. sticks against steps, piece
 against lower of upper pair of "steps"
 Heavy slide lies along west side of
 St. platform, heavily ruined. Several
 slides falling from it, now removed.
 Not in fair condition over steps
 & ~~to~~ near. End of slide ~~is~~
 reaches about to front plane of St. platform
 badly holed & crumpled.

May 20 6 15 224" 4"

R-9

Temple + Plinth. *Fair - OK*

7 19

R-9

Looking down on lower Bld. Plnt. corner. *OK*

8 20

R-9

Bld. Plnt. Mosary- *Retake*

9 21

R-9

Py. Temple Mas. *Retake*

May 22 17 22 ✓

22/15 15

R9

Plinth terrace masonry.

17 23 ✓

Blank

R9

discovered

⑧ 24 ✓

Platform niche, lld, no side g. OK

⑨ 25 ✓

R9

Same lld side. No overhanging OK
slot as top.

⑩ 26 ✓

R9

Side wall set, Platform (plinth terrace). OK

⑪ 27 ✓

R-9

Left pier from left. Note its length - we have cut up
chewed it off - also that there is a cover OK
5-stone high near corner (forward of m. strip)

⑫ 29 ✓

Lower terrace of Bldg. Plot, near lld, OK
hearing off.

May 22 [1] 29 ✓

[2] 30 ✓

[3] 31 ✓

[4] 32 ✓

[5] 33 ✓

[6] 34 Blank

[7] 35 ✓

R-10

R-10

R-10

R-10

R-10

R-10

R-9

Gen man from left dump - Retake" - Survey at an angle RetakeRt side of stony, secondary construction OKStony side wall + terrace under hand OKGen man from front, under Retake

Blank?

Unim with Stelo 25 platform. Pencil Un
 at approx corner of the ~~stelo~~ stelo unit. Note
 falling stone, as if a secondary pillar
 was in front. Boy behind Stelo 25 which
 lies overhalls over same steps, loud out,
~~back~~ ^{back} toward camera, surely plain.

May 24 ① 36 ✓ 22 4' 4" 3.0 S.

R-9

Platform, center so of cut.
 Cal. altar butt toward camera on floor ^{OK}
~~floor~~, forward original position in st. in regard
 axis of lower of each pair of high steps.
 May be lowest excavated slope of broad
 stairway to hind final step, which is
 cut 120 by stone to his left, in this step

27 ② 37 ✓

R-9

Center section, front. ^{lower of lots}
^{when to air of steps}

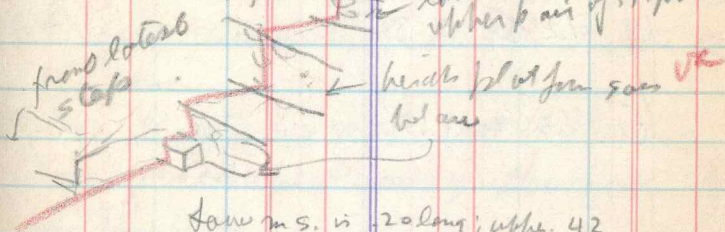

Saw m.s. is 20 long; wth. 42
 Being on 7th (from top) complete tread of
 earlier stairway

3 38 ✓
38

R-9

Plain stone. No signs of plaster probably from
 floor + wall. This is perhaps to be the back
 wall was out, when sign has toward center
 axis of Rdg. ✓

May 28 (4) 39 ✓ 22' 8" 8" LC R-9

⑤ 40 ✓ 22' 8" 8" 10.30 rLC R-9
-11.30

⑥ 41 ✓ " " " " R-9

⑦ 42 ✓ 22' 8" 8" " " R-9

⑧ 43 ✓ 22' 8" 30" R-9

↳ B. Blank or missing

⑧ 44 ✓ 22' 15" 30" LC R-9

⑨ 45 ✓ " " " LC R-10

9 46 ✓ 22' 8" 8" 3.00 LC R-9

9 47 ✓ 22' " " " " R-9

B. Blank

Center Section behind stairway; top sitting in background. in sticks at 22 cm. - long. on top of remains of upper steps found, vent. again on head of lowest found.

Col. altar at base of hyp. stairway. OK

Same, from left side. OK

Stairway side wall, left. in sticks @ 22 cms. OK

Same. Note terrace wall runs behind. Total stones predom. low chun, more than slots.

Gen view, strong angle, tower. Under will be

Upper terraces from side & at angle. 15' x 7' + tower + tower. will be

Plain slot from upper with Stab 25. Also OK
(Photograph part)

" - etc probably right side.

Retake

	Per				
⑩	48	22 4" 4"	3.00	V.L.C.	R-9 B
⑪	49	22 ? 8"	11	"	R-7 t
May 29	⑫	50	22 12" 8"	8.45	Pull.
⑬	51	22 30" 8"	9.00	"	R-10
⑭	52	-a 8" 8"			"
⑮	52	-k 8" 8"	9.15	(Clearing a little)	R-10
⑯	53	22 15" 8"	9.15	"	R-10
⑰	54	22 15" ?	9.45	Pull	R-10
△	55	22 15" 8"	10.00	LC	R-10
△	56	" 15"			R-10
□	57	15"			R-10

R-9 B	thick sand, white face.	OK
R-7 t	" low face, badly eroded in eroding plane. Note toothed edge.	OK
R-10	Pp. Mps. laminar, left side of stung in stucco @ 22 cm. Brush on basal foundation ledge, temp against the same.	OK
R-10	Stung side wall, left. in st @ .22.	Shower OK
R-10	Stung angle in stucco @ 42	OK
R-10	left corner, from 1/2 rd inset	OK
R-10	left side - brush at 17" outset.	OK
R-10	Looking down on left hand facade, tower	
R-10	gen view, starting + monuments	OK
R-10	gen v. of upper terrace	Retake? Under

3 ✓ 58 22 15' 8"

LC

R-1

Genl view. in 2 @ 62 is an "obelisk" of
 mosaic complex, Boy stands about
 1.50 mt. (left in picture) of end of the
 mosaic panel - i.e. of the visit. Area
 around time with corresponding "palustris"
 is clear, but would show its
 projection in the photo. Note thick
 tubular & block masonry
 chimneys are not particularly interesting
 OK, but sketch

5 ✓ 59

R-1

Stela east of fallen stela. Note large
 col. altar which has not been moved.
 round end of stela forward & down
 squared end behind, higher
 middle piece higher behind these in
 picture: Mosaic block beyond the
 stela - note the "lintel" beyond stela
 not moved by us.

OK

Red above
with
stela

4 ✓ 60 22 30" 8"

R-1

Mosaic panel - 1/2 lens. -
 (double exp. time -

OK

Jun 3 ⑥ 61 22 15 8" 10.15 S.

R-9

⑦ 62 " " " 10.30 S

R-9

⑧ 63 " " " " " "

R-9

⑨ 64 " " " 10.45 S

R-9

Moson - 19' tower. Wall is buckling; but OK
notice irregularity of masonry stones; many of the
open spaces contained irregular chinking stones.
Only the base course is fairly well
matched for height of stones; above this
 coursing is very haphazard. Flat thin
 slab chinking not observed anywhere
after looking over into wall.

This last is true of string & rib wall
also, in fair condition; there there is fairly
good stone coursing, stones being slabs,
thin tabular, thick tabular, or a two
small blocks - ~~or~~ stone there in count
smaller than in pyramid.

m. stiches @ 23

Same, as slight angle showing m. of wall OK

Inserting of corner, OK

Round corner, left - bricks off to side OK on
after just above masonry the corner. Note better
 coursing here; the long tabular in hand corner has been
given a chamfered face. slightly over

⑩ 65 22 8" 8" 11.00 S R-9

file
the
clearly

Bld. Plat. lower terrace + bed of stony wall
from front.

OK

⑪ 66 22 15" 8" 11.10 S R-9

Left hand corner of Bldg. platform, lower
terrace. Stone indicate outer corner.

OK

⑫ 67 22 15" 8" 11.20 S R-9

(possibly
clear)

Shard stone @ 22 at base of side stony wall.

R-9 (D)

Bld. Plinth + mortar off front face of
left pier. Note well some small tubular
plinth wall, no large stones (in doubt).

OVER

⑬ 68 22 15" 8" 11.30 S R-9

Bld. Plat. - NO micks in plinth terrace,
begins bed (in photo) of bricks. At other end
wall. In situ many fine, bottom of outer
corner to side which seems still in
place, but probably measuring height of the
micks. Heavy stone runs in to
interior rear wall of micks.

OK

2 69 22 15" 8" 12.00 S R-9

Left face of left pier. Probably entrance to
pass as indicated by hor. micks.
Note some near corner.

OK

③ 70 22 15 8 12.10 S R-9

looking
down

④ 71 22 5" 8" (level shot) R-9
⑤ 72 22 5" 15" 12.30 S R-9

Looking down on left pier. Note broken ^{over} ~~to~~ ^{to} ~~to~~ face - 2 parallel hand lines rob. by bottom stone only. For the further part, solid hand corner is missing. For middle one, a stone in center is missing. There was an level below hand layer near corner stone at this face: but further in a solid stone occurs - i.e. the hand part of pier was at the low level, as on right pier - & this is below probable plinth level.

While the slab beyond (a) would be thrown by as leaning up into b & c, this

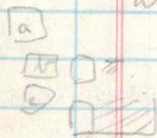

does not work well. As a whole plinth slumps back but app. pier it is slop

and if b & c were plinth stones they have moved back 40 from the corner below them, dropping a little after this

Same as well as ↓

R-9 pier, same situation, no pier corner missing. OK
Out of 4 stones at the end of left corner, 2 show front and hand faces at an acute angle. OK

④ 73-022 15 8 12 30 S R-9

⑦ 73 ~~1/2~~ R-9

8 73 ^{3c} 12 46 S R-9

9 74 ✓ " " " 1.00 R-9

^{right} left brick masonry (old side) OK

R-9 R-9 ... old near corner. OK

inside of yard wall. Note there is no
cut; hor. masonry on stone masonry
horizontal bond face, in conformity with
rd. piers (see above). The stone used
is brick is mag. & below base of wall to
near, which reduces it, & it is modern
lime. The square stone (top, above brick)
would be a good corner stone, but there are
no others to go with it in field face.
Not mod. tabular masonry. Irregular
chunks too, no really thin slab chunks
that note at base of wall level. (We
have any below it)

RD side of rd piers; Note broken-off "face"
Thru 2 forward stones are good corner + face
stones respectively; that there are 2 thick stones
forward & rear, between them the forward are
vertical. No corner base stones missing.
Round Piers are up toward-center corner of
each pier. Note this pier has some broken

OK
level, when this is two piers in and

- ⑤ 81 ✓ 22 4" 7" S. R-5
- ⑥ 82 ✓ 22 4" 4" S R-5
- ⑦ 83 ✓ 22 5 5 S R-5
- ⑧ 84 ✓ 22 " " " K-5
- ⑨ 85 ✓ " " " R-5
- ⑩ 86 ✓ 22 15 15 S U3

- Stwy on "block wall" around house. ^{OK}
^{or maybe in wall}
- Subhead faint. rusted, 3 d tenon.
 wall hangs on either side but to bld in
 picture fell after ~~the~~ slight excavation
 I thought this was a wall then when I
 saw it, reset. ^{OK}
- Bldg Plod - niche in rd. side of tenon.
 when long. in stone protruding stones ^{OK}
 as if corner (two down match for thickness)
- Sam, long view brush at corner of
 corner of niche. note how it has ^{OK}
 split. hors. ms in projecting line of stones
- near same niche. Points to
 face of stones near toward side. - see ^{OK}
 sketch; hors. ms as in 85.
- near wall of rear room. db if is falling out
 Note very large tablets & blocks ^{OK}

⑪ - blank ✓

⑫ ✓ 87 16 15" 15" 10.50 S

U-3

Pd end of rear room + rear of mod. wall.

① ✓ 88 16 " " 10.50 S

U-3

Sill, mod wall joint. Placed near corner of latter, ms at 22.

② ✓ 89 16 8" 8" 10.15 S

U-3

rear of st. pair, from an angle. Long stone in 3^d course is .60, long corner stone .50 long.

③ ✓ 90 16 8" 8" 10.45 S

U-3

Mod wall masonry. Str. lines of rods indicate sill stone from out, at angle - stone of lower wall course masonry, from corner to l. in facture, 45, 48, 45, 47; respectively 23, 21, 18-21, 21 in length. The long block at top of corner is 58 x 15 x 22 deep. (cf. 2 seen in rear of rear wall (see notes).

④ ✓ 91 16 8" ? S

U-3

Pd anta + end wall. Note lack of long heavy tablets or blocks. Continued use of tablets with long face in wall face.

5 92 22 8" 8" 12.30 S

U-3

Pd end of hand room. Rod points to top which handle bears sill.

12 ✓ 78 22 4" 1.50 LC U-3

△ 6 99 ✓ 22 8" 4.25 2.50 LC U-3

△ 100 ✓ " " " " U-3

△ 101 ✓ 22 1 1/2" 1" 3.00 S. R-4

△ 102 ✓ " " " " R-4

RD from front of U-3; Plinth OK

Gen view from U-3 platform OK

Note U-3 - 2nd ad. left - cornice slab

land out to side; strong wall, tubular.

May have rod of his broken corner of central block, his foot on step rising in front of it

Gen view, nearer center, front. Pray in rear room, U-3; red same position. OK

Lower terrace - view of mosaic panel ad U-3 in plan. Very wide red, a base level at left corner. Small red ms @ 22 in mosaic recess. ✓

Gen view from tower, angle - U-3 side of pyramid; mosaic panel etc; from front. ✓

June 6 ~~103~~ 103

R-4

June 11 ① 104-22 2" 2" 10.45 S

R-5

② 104-22 3" ? " "

R-5

③ 105-22 1" 1" 10.45 S

R-5

④ 106-22 4" 4" 11.00 S

R-5

⑪ 107-22 8" 8" 11.00 LC

R-2

~~108~~

⑫ 109-22 6" ? 11.20 V.LC

R-2

⑬ 110 " " " "

gent man of same, looking down from tower, not placed to hand + left.

upper terrace wall to rd side to Fair show, 2nd west.

Same level, from in hand + to side of

no trace of plaster masonry frame terrace is so on the same level just below

Rear wall of Bldg Platform

M.S. adjoined end of left side wall (vertical) + on lower + mid level. Stones in hand are displaced by excavation. Red rd left rear corner of Bldg wall. Note used corner with thick basal ledge. Mochlo cover indicates corner of stairway + wall.

Stony, looking down from side m.s. ok no inside of upper floor or balcony another on ledge of left used corner.

111 22 7" 7" 2.10 V.L.C. R-2

Left near corner in street on Plot. Plinth of Bldg plinth - with masonry slots projecting; blocks. Parthenon present top of Bldg wall. OK

112 " " " " " " R-2

Moss of rear Bldg Plinth wall, no center, & top of center. OK.

113 22 8" 8" 3.10 V.L.C. R-2

Corner of rear wall projection, pt side. OK
V. rules based on front wall - just fails to rise to top of basal molding - lower wall rises, used on this to full height minus upper molding. Bald. traces in middle of back wall head of basal molding - after corner only, falling stones.

Jan 16 114 22 15" 8" 11.00 Bull. R-4

The SE Panel for side & front, lower down cut Red pencil indicates rough face of filler. Horizontal course on main wall, except this is flush + of large stone. The back-seo filler is short slots (not very thin, though) - a good deal of mortar came from here + signs of stones (not certain). OK

5 115 22 15 8" 11.15 Pull R-4

6 116 26 15 15 11.30 Pull R-9

Laminated - cover of hard thin sides
holding sawtooth up. Sticks on base
molding & immediately under upon
molding

Rt - Sela 29 Tense (around found) Let O get
as follows. Pick at base of latest lower O
step, cut for section. Brush around top
of equities step on second ledge of low.
Behind & above in stick in frames stone
(pt. 1) of around wing of "Ball Court" of Plate
Five behind stone, on S. or dully of
Plate in front of "Ball Court" of Plate
in stick in partly in wing, running
in between batter & lateral platform.
Just beneath. Vest in st on molding
behind wing @ 82. To its right the cut
section of S. O. solid fill in of low
which formerly ran across passage to
level of top of wing.

⑥ 119. 22 30 30 12.30 P.W.

R-9

"Ball Court" etc from Stela 25 Plat. looks
over. M² adopted as usual, including
near corner of second plot. in wall
in front of better wall. M² stair used
left shows forward remnant stone
of this - now, same of ~~earliest~~ Ball
Court. Shows an ~~early~~ plan of base of
early stela wall.

⑦ 120 22 8 5 1.50 P.W.

R-9

Supposed at side of early plain stela
built to right in picture. Plaster
in front from wall of "Ball Court".

⑧ 121 22 30 15 2.20 P.W.

R-9

Plain stela, supposed left side, built
left in picture

⑨ 122 22 15 15 2.30 "

R-9

Same Stela to show taller top. Not the
wedged form at side.

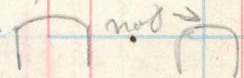

⑩ 123 22 -? 2.40 LC

R-9

Remnant of lower "Stela" Plot from level. in S ad
right on lower of 2nd pair late stela. Height
in "plaster" of lower & 87 ways, so wall - lower.
This in so could "masonry" or earlier stela

⑪ 123-6 ✓

Jan 17 (P) 124 16 15" 15" 8" 11:30 Pull

R-7-6

R-5

Side of "Megalithic Stwy"; platform terrace. ✓

Trunc. of S. l. terrace central stwy
with right "wing". Red stucco on
front of later. Note possibly third
wing covered steps. Red + blackish
frits in step + side wall. stucco
as back (clearly plain) of S. l. —

⑩ 125 ✓ 11 17 17 17

R-4

Stwy sidewall. Note dumped block
brush is an irregularity in form
on side of summer panel. Is this redwood?

⑥

⑪ 126 22 4 4 1.15 v.l.c R-2

⑫ 127

~~⑬~~

⑬ 128 22 4 4 1.55 v.l.c R-4

⑭ 129 22 30 30 2.30 R-4
R-3

⑮ 130 22 8 4 2.40 R-4

Strongly a Balustrade or block; used corner beyond.

R-3 Plain stela, ends middle fragment, roughly side, from rt. side of R-3. The piece with eroded depression is on right - the lobes only fit (never suggest).

Corner of stela. ms p. 20 (old one, never used before, I think). No blocks; long shaped tablet at corner followed by another long thin tablet.

Lower corner & part of upper molding. Plain stela of R-3, left side, fallen in front (from A. Meunier's position).

Reverse columnar, from platform debris at top - looping back & down.

4) 131 22 15 15 2.45 - LC R-2

5) 132 16 15 15 3.15 Pull R-7-6

6) 133-a same

7) 133-16 " " " " R-7-6

8) 134 16 " " " " R-7-6

9) 135 22 8 4 11.00 LC R-5

Front of "platform" at top. The
west side is about 1.00 m (1:00
in picture) of our line of sight from
bottom - ∴ close to center
of pyramid which means 60 height
is 9 m, ~~not~~ not tabular blocks.

2 pieces of 10 end of 1000 Count
row (facing east) - end of
mod. wall may show a right.
Not tablets & blocks.

Logs of stone.

100 found come, plinth + wall -
falling mod. wall beyond; there left
seeded up. The hump is a dump.

100 near corner of Bldg. Plinth showing used
latter, probably after terrace (or plinth?) this
was covered over stones in my hand. This is the
wall which may (?) have been the Bldg. itself.

10 136 ✓ 22 15 8 11.30 LC

R-5

Bldg Plot. - Indication from photo side

11 137 ✓ 22 15 8 11.45 LC

R-5

See Notes. 11 from rear side. See notes.

12 138 ✓ 22 22 15 8 1.00 VLS

R-5

Upper level, hand - out side of m stick. Noticed off below by, using rd right. Beyond is the first found to hand out side. Note archway (or ruin?) of third wall, running about 1.00 behind later on rd base, about .60, 1.50 above base - i.e. the inner wall was really westward. The later out side is about 1.00 to 1.0 (toward center) of the early one which we located - 1 about in line with stone side wall. Can identify wall going on as inset.

13 139 ✓ 22 15 4 2.00 pm S

R-5

Angle showing. extends up to flight of stone lence. Side wall of rt. projection wrong. ms @ .42.

14 140 ✓

R-5

No hand corner of irregular stepped mng.

③ 141 ✓ 22 4" 2 3.00 L.C.

R-1

RO side wall of stony "block"
as left.

Red area
sh
(1st
line)

① 142 ✓ 16 3/8" 15" 3.00

R-1

From Playa Sand Pick at corner of "block."

Note that it ~~is~~ runs to Plaza. Possibility of ~~it~~

plaster or 14 corner stones — from corner.

Column altar, end on floor, leaning back

Bay in side east. m.s. in wall right

(old in picture) of stairs @ 22. Note

both squared base around top of

slab headed this way; middle piece

far to right.

③ 143 ✓ " " " "

R-1

Slab cut at stone panel in brooding ~~of~~

found by us. Note beginning of horizontal

to cut — narrow stone or tombed at

center & on right.

④ 144 " " " 3.15

B-6

Round chiseled corner, m.s. on right. @ 22, is on

corners (austed stone, very small) plaster: Bay

points to some more, survival of which under

huge of in slab, suggests bottom of column.

④ 145 ✓ same

⑤² 146 ✓ 22 4" 4"

⑥² 147 ✓ 22 1" 4"

⑦ 148 ✓ 22 1" 4"

⑧ 149 ✓ 22 1" 2"

R-1.

Subhand Carved panel. Brushed for
leaves moss in hollows. Note
apparent boarder along near long
edge. over
Retain

R-9

Sub altar cache - all flints - S-21-20-^{over}a

R-7

except one which was omitted - see drawings OK

Total 17, 2 more pieces of iron.

R-9

Rest of cache - obsidianis - S-21-20-b OK

Jades S-21-20-e; shell (dtd) S-21-20-d

Laws rps - S-21-21 (2 shells

below pot).

R-9

Contents of cache base of altar, Playa - OK

S-21-27 - upper NW obsidian - OK

upper right, flints - a

Lower right - g-jades; ^c lower

NW shell - d.

← 1 Flint d/d or d - see drawings

[3] 156 22 4" 8" 3.45 S. A-1

[4] 157 22 4" 8" 3.45 S R-1

[5] 158 " " " 4.00 S R-S

Stucco - S-17-22

(10)

(11)

(12?)

(12)

(12)

(12)

Stucco - all are S-17-14

Stucco. ^{S-17-15} left - finished surface
left, seen in section as laid on stone
slab (.05 to .06 thick) with
vertical chink mark.

Center - surface left - note concrete
interior running down in section to
a slab shell, .04 thick.

Lower right - the corner of a
fragment - note concrete body.
This concrete is yellow, like the
developed delta found in
quantity at base of panel.

✓ 159 22 4" 8" 4.10 S R-1

✓ 160 22 2" 4" 4.25 S R-1

R-1

R-

R-4

✓ 161 22 8" 15" 4.40 LC J-4

162 22 15" 30" 4.55 C J-4

163 " " " " " " " "

✓ 164 22 8" 15" 3.30 S Fig. ^{ok}

✓ 165 22 30 15" " " Same Plate ⁱⁿ

✓ 166 22 15 15 " " Same Plate ⁱⁿ

Stucco 9-17-17 ✓

S-17-18 S-17-18 S-5-10 S-5-12

S-16-9 S-16-9 S-16-11 S-16-11 ✓

Stucco W-16-32 (also 162-3) ✓

Stucco W-16-32 (other fragments) ✓

L & R. y. 10.

Top row. M-36-1 ²/₃ 2nd Row SE+13-4

M37-1 (double whistle) W-2-66

M38-1 ²/₃ W-8-55

M39-1 ²/₃ -69

M39-1 -2 90

NE-6-13 138

W-12-76 169

-95 174

W-16-37

over

No 164-186 cont.

- 4 167 22 15" 4" S (alley
 under
 trees).
 5 168 22 8" 4"
 6 169 22 15" 8" just by
 sun under
 under.

Fig.
Some for

3^d Row: W-30-19
 - W-31-62
 84
 94
 W-33-16
 17
 25

Model fragments:

Both (4th) Row M-40-1

W-8-68

82

W-8-57

85

W-12-91

W-33-14

13 W-31-97 } omitted,
 W-31-98 }
 - would show
 anything in a
 photo.

Clay objects → W-2-73

S-13-2 (am. head) + 2 hoodoo birds (W-8-174)
 above + models collectively
 W-8-174 (bolt cont)

OK.

7 170 22 4" 8" (74) 4.55 - Sun. R-1

Jan 24 ① 171 22 4" 8" 2.50 L.C. some
objects

2 172 22 4" 8" 3.00 L.C. some
shell

② 173 22 4" 8" 3.25 L.C. Fg
③ 174 *

Stucco - Same as 151 -

lots. ① ①

③

S-16-6 S-22-33 S-22-34 S-22-35

S-22-52

W-8-53

W-8-60

S-22-46

Top Row

S-20-11 S-21-28 S-21-40 S-21-48, S-22-3
(ecc. obs.)

Left Lamin Group:

W-8-142 W-8-147 W-31-73; W-31-80, W-33-31

W-8-184 milled

(sharp piece of
force knife)

Center - shell boxes ②

Right - shell-heavy bivalves

W-8-184 (2 head band) - top & front. JK

Top

8 175 22 15 15 4-30 LC
 9 176 " 60 15 " "
 10 177 22 30 15 4-40 "
 (white background).

ok
 clean
 ok

Top Row:

S-11-9; S-11-10; S-11-11; S-11-12; S-11-14; S-11-15
 S-17-24; S-20-17; S-21-3; S-21-11

2nd Row:

S-21-36
 -38
 -47
 -54
 -59
 S-22-13
 -20
 -25
 -26
 -27
~~28~~

Third Row:

S-22-28
 -29
 -30
 -31
 -45
 Modeled Fragments
 S-16-8 (S-5-9 omitted)
 S-20-13 (mostly)
 S-20-15
 -19 (3 groups close
 together)

4th Row (modeled fragments)

S-21-4
 -6
 -13
 -30
 -37
 S-22-12
 -19 (S-22-22 omitted (missing))
 -32
 S-25-4
 S-25-8

11 178 22 2" 2" 5.00. V.L.C.
in open
light.
- i.e. filtered
sunshine.

discised
stones

12 179 22 15" 15" 5.05

Metate.

See above

Hatche Cross hatched "squares" on
slabs from J-9 + J-11. (see marks
on stones) See Cross in notes.

See L.S. notes - turned up in
excavations. I think it was U-3,
but not sure without looking up
notes. The light type. (2nd one found).
Probably from U-3, possibly R-1. South
Group sure.

180 ✓

181 ✓

182 ✓

183 ✓

184 ✓

185 ✓

Cord 1.

J-6

Cord 1

"

"

J-6^{1st}J-6-2nd

See above

Section of J-7-506-2 platform.

Stair & landing

Looking up J-7-506-2 "

Similar view to 181.

View of large pit & surrounding stairs.

Behind platform of - looking down

lands through stairway.

④ 186 22 15" 8" 9.30 S. 14-5

From tower on place. Extended in st. 14
 @ 1.02 is an laminated early stony way, slop
 uncaused. Pick on opposite face of
 last period stony side wall on
 addition thro to - but not left of m. st. 14
 running up over early stony the fill
 wall of latest period. "Boston" indicate
 level of first terrace floor on which masonry
 is based (or its base goes down to
 m. st. 14 @ 22 on outside of 2nd mass,
 above described but - not the date.
 Upper left, on st. at 22, for vertical on a line
 line of receding stones, supposed to be
 second early side wall of stony.
 Upper vert. m. st. against base of 3rd
 terrace. Note that 2nd terrace
 built against side stony wall (early).
 Base for upper left stands on level of supposed
 top of 14.5 - 2nd, running in.

⑤ 187 22 8" 8" 9.45 S. Same

① 188 22 1" 8" 10.00 S.

K-5 Mosks - 1/2 lens.

② 189 22 15" ? 10.10 S.

K-5

Footering down 19' mastic lens. mastic ad
22 (hung at @ 42 (wind indicator into
stony side wall or addition; 2 mastic @
1.02 indicate full wall riding over early
stony which has a little ^{1/10} hollow &
other right (as should have.)

③ 190 22 15" 10.20 LC

K-5

Sticks in some places. Into earlier lower
tenuo wall; early stony side wall
remains behind of mastic tenuo.

④ 191 22 15" 10.30 LC

K-5

Footering along buried lower tenuo.
Excavated only to depth 5'.

⑤ 192 22 15" 15" 11.10 S.

K-5

mst @ 22 again top of K-5-2nd top
tenuo - m @ 2.00 vs fill wall
behind top K-5-1st lens; its base
on f.p. of K-5-2nd.

⑥ ~~193~~

OK

OK

OK

OK

OK

⑩ 193 22 1" 1" 1.45 S.

K-5-15

Small tubular secondary addition to original side, from west. Orig. corner of temple to left in picture - some wall showed show, under root. Note plinth on the secondary stuff, dropping about 10 or 15 turns with the side outward. It follows this, badly settling as it goes forward, to (apparently) found corner, & back with original plinth. This stuff is based on bottom same level as temple wall at body, and seems to have been so throughout, settling accordingly for the diff in levels.

⑩ 194 22 1" ?

1.50 S

K-5-15

Same from further to west. In situ, indicates main orig. temple wall.

⑨ 195 22 8" 8"

2.25 LC. I 2

Left end. In situ, on base of these.

① 196 28 8" ?

LC

I 2-23

platform etc.

- ① 197 22 1" 1" Sun 230 J-2
 ② 198 22 2" 1" Sun, 230 J-2
 △ 199 22 1" ? Same. Cond
 ③ 22 1" 1" J-12 +
 J-13
 5027 ① 200 22 8" 8" 9.50 - S. Mud-Obj.

② 201 22 8" 8" 10.50 R S

Upper half: L to R - (W-8-184)
 Omitted pieces: S-12-20-a; S-21-30;
 S-22-14; S-22-15 (2 objects, grouped
 together); S-22-17; S-22-37 (2
 beads, grouped).

Lower half - 2 pieces of lid used
 as bowl, S-21-18; rt. hand of bowl +
 extreme right of lid, S-21-25 + 26
 respectively. Mis numbered in photo -
 corrected later.

① 202 - 2 pieces outside Mummy + bowl, R
 W-42-2; left. aban bowl, W-8-72

③ 202 22 8" 4" 10.30 S. Pottery
Slots.

④ 203 22 4" 11.00 S. Same "

⑤ 204 *partly blank (missing)*

⑥ 205 22 8" 11.30 S. 1937 Joints

⑦ 206 " " " Same

⑧ 207 " " 8" ~~W-33-12~~
12.00

⑨ 208 22 4" 12.00 S. Joints

overhead
Top row: W-8-118, W-8-161,
- 171

W-12-94, W-13-93; W-33-12,
W-33-12, W-33-151

note Plaster both surfaces & edges
of W-33-12 pieces - white traces on
fine smooth surface; W-33-151 shows
broken up "flanges" & unfinished
surface of an inside. The others are
smooth & finished both sides.
In some cases smoothed.

Top W-30-30, W-31-67, -75; 91, *OK*
Base W-31-68

Pottery *Over-taken*

Looking down *OK*

W-33-12 (1936) pottery *OK*

~~same~~,
1937 photo - bottom *OK*

⑩ 209 ✓

Jmota
1937
Figs

⑪ 210 22 1/8" 8" 2.00 LC

Jmota
1936
Figs

⑫ 211 ✓

Jmota
1936

Figs + Pottery

⑬ 212 22 1/2 level teaspoon
Flask powder @ 2 1/2 ft

J-9 graffiti stone,

⑭ 213 " " " " " " " " " " " "

J-9 Tamb Stone glyphs.

~~Not used~~

⑮ 214 22

Jmota
Pots

⑯ 215 ✓

Jmota
Figs.

(London theme) 1937 - re-head ✓

⑰ 216 ✓

more

ditto. ✓

⑱ 217 ✓

Jmota

1936 Figs. ✓

⑲ 218 22. " " " " " " " " " " " "

0-13

Graffiti of 1936 - see above notes ✓

averaged - Retaken

Figures. Pottery - retaken

OK

OK

OK

OK

OK

OK

OK

△ 219 [✓]
out of place.

⑧? 220

⑨? ~~221~~

○ 222 [✓]
out of place.

223

224

225

226

227

228

229

230

231

S-11 +
S-12

J-6-

J-6-2nd
2-

Between J-12 and
J-13

Janitor

R-10

R-16

R-16

R-16

Count 3

TAP

FC Jr

Children in Tenon

Cut through plinths & floors bet ween
these Wdgs - see notes. OK

next to right (SW) pier, R in 3

End wall, plinth, step tenon below
R in 3 floor.

Trench showing buried constr. - see
notes. OK

Platē

Temple

Red temple wall

Bldg Plat, niche

Pys. - buried corner

Pat. altar

✓

232

fenestra

- side view of large pelote

233

2

R-7-a

End wall from inside. M. stick against longitudinal "wall" near center. (Note from film. Dec, 1937)

234

R-7-a

Looking at hump between this and R-7-b. M. stick on side of shallow trench. (Note from film, Dec, 1937).

235

R-7-b

Two piers on ball bond side, near R-7-a end.

