

R-16
Traced from
Purris Map
(full scale)

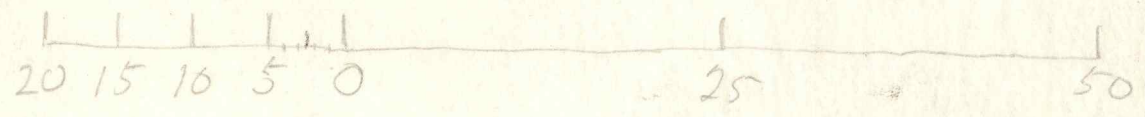

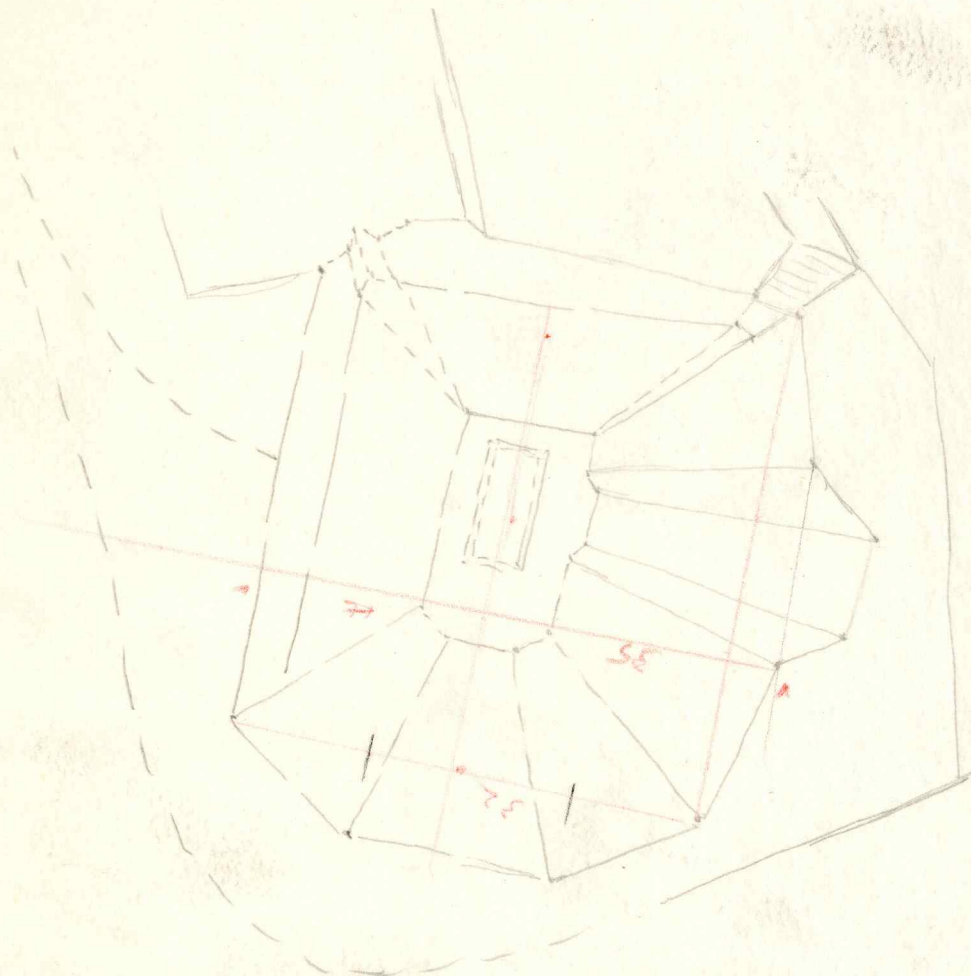
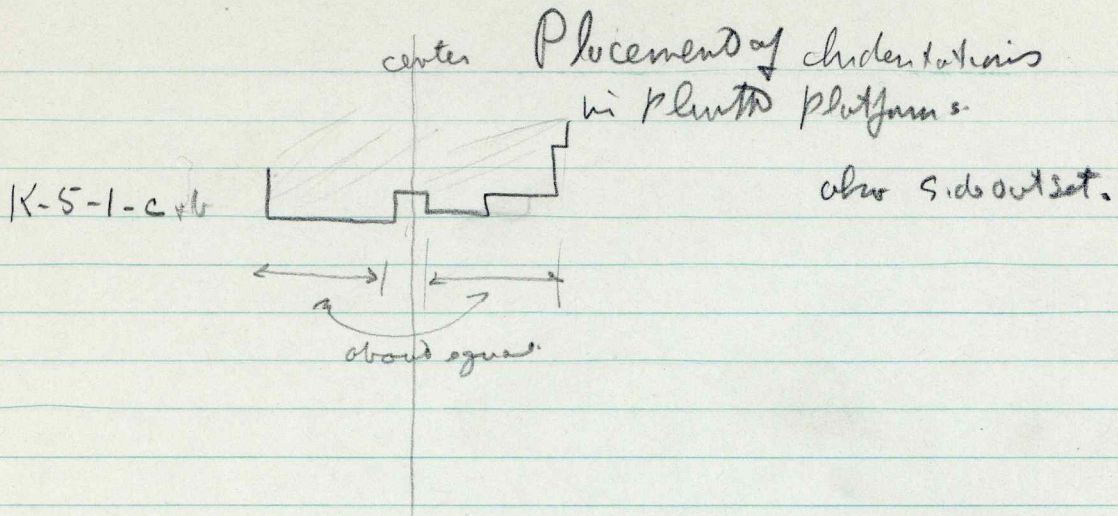

S-29 Same (or very close)

O-13 appears same (little to rear) if plinth was found.
if not, same or to the front.

R-5 Slightly to front as reconstructed (with base wall
known as rear.)
about .75 front if consider plinth as front of platform.

R-1 Reconstructed on basis of above

Temple Bldgs: Side offset.

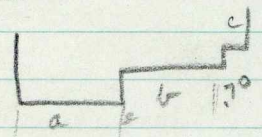
K-5-6  = about .35 forward of center (no rear mass.)

side offset

J-29

1.24 1.30 1.50

about 2.00 forward of center

$$\frac{24}{36} = \frac{2}{3}$$

O-13 slightly, then much to rear of center (if plinth always used)

R-9 about 1.00 forward of center (reconstructing w/o rear mass.)

J-4

$a = b$ (2.58 \pm - c only about .25, vs a 1.30(?) side offset)

Placement side outlets - cont'd

K-5-1-a.

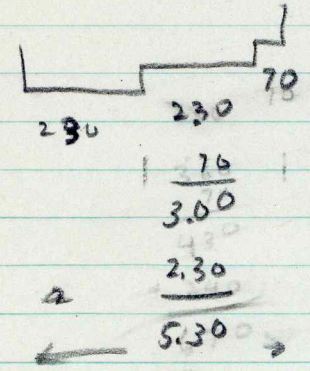

$$\begin{array}{r} 5.30 \ 2.300 \\ \underline{2.120} \\ 3.180 \\ \underline{1.590} \\ 1.590 \end{array}$$

$$\left| \begin{array}{r} 43 \frac{1}{2}\% \\ \hline \text{(Side outlet)} \end{array} \right.$$

$$\begin{array}{r} 43 \frac{1}{2} - \text{side outlets} \\ 43 \frac{1}{2} - \text{near corner} \\ 13 - \text{near outlet face} \\ \hline 100 \end{array}$$

I-29

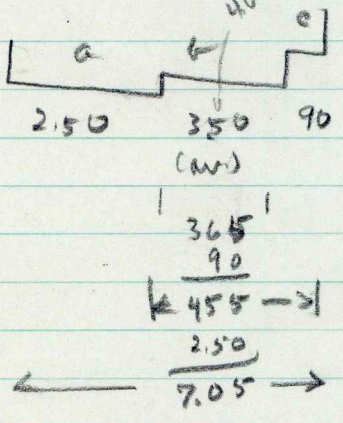

As rest area
I-29 side lines
are about
1/3, with on 1/2 + 10% of
distance to track.

$$\begin{array}{r} 7.05 \ 2.500 \\ \underline{2.115} \\ 3.858 \\ \underline{3.525} \\ 333 \end{array}$$

$$\left| \begin{array}{r} 35 \frac{1}{2}\% \\ \hline \text{as rest area} \end{array} \right.$$

$$\begin{array}{r} 7.10 \ 2.200 \\ \underline{2.130} \\ 700 \\ \hline 7.10 \ 4.050 \\ \underline{3.550} \\ 5000 \\ \underline{4970} \\ 120 \end{array}$$

$$\begin{array}{r} 7.05 \ 3.500 \\ \underline{3.525} \\ 3525 \end{array}$$

$$\left| \begin{array}{r} 35 \frac{1}{2} a \\ 50 b \\ \hline 14 \frac{1}{2} c \\ \hline 100 \end{array} \right.$$

R-16: on basis of K-5 - will have inclinations very close to near - a very unidically secondary modification.
 - could squeeze in the suppressed corner.
 - will introduce thin wall to near + side both

on I-29 basis: $a = 2.00 \pm (\text{hard to constrain}) = 35.5\%$ of total.

$$\begin{array}{r} 35.5 \ 2.000 \\ \underline{1.795} \\ 2.250 \\ \underline{2.130} \end{array}$$

$$\left| \begin{array}{r} 56 \text{ cm. total} = 560 \\ \hline b = 50\% = 280 \end{array} \right.$$

1939

~~add Census?~~
~~add usg note sheets? (p. 34)~~

See also - Parris map + map data
W.S. Godfrey Plan + Section
(Large sheet, 1939).

1939 - L.S. 56. ³⁹ 37-1 to 11
usg. 12 to 14

1937 - 37-1, 2.

1936 F.S.C. Jr. 36-1
-2

1935 " 35-1 to 3

1933 L.S. 51. 33-1

Dim 11,

No downy levels at top

45 (at angle - chievs run under plants & male)

Pyramid - Levels, Bldg. Platform superseded by W.S.G. (see his drawing). (From elevation)

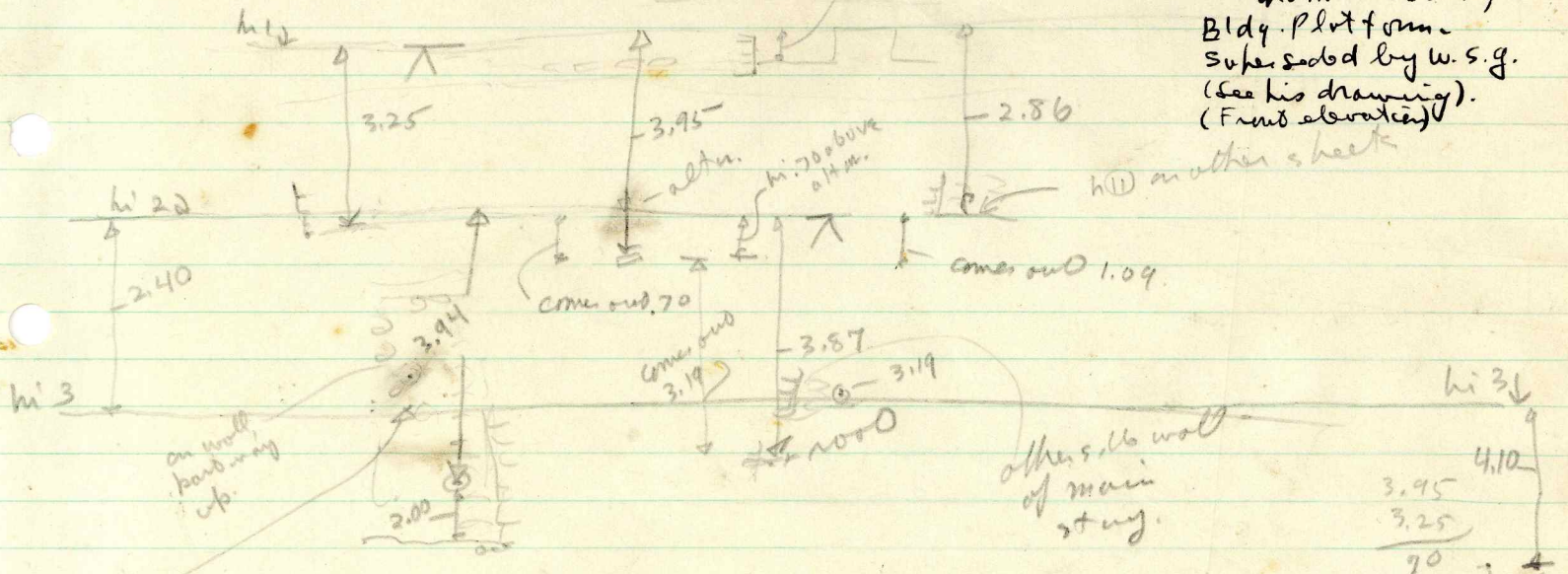

on wall, banding up.

terrace wall seems downy 3.30 high to a possible top.

other side wall of main stuy.

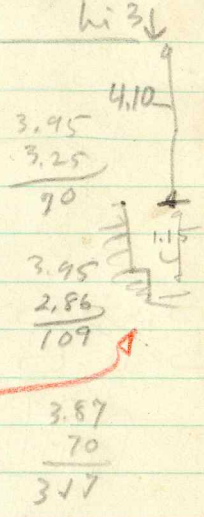

Oct, 1939: Menny clear - this is basal molding on inside corner of 2nd (from bottom) terrace, left hand.

3.94
2.00
<hr/>
5.94

Oct, 1939

$$\frac{2.86 + .45}{2.41} = \text{max height of supplementary terrace}$$

 900 2.38 first time W.S.G.

R-16

LS

Scale 1:100

Front Elevation

forward

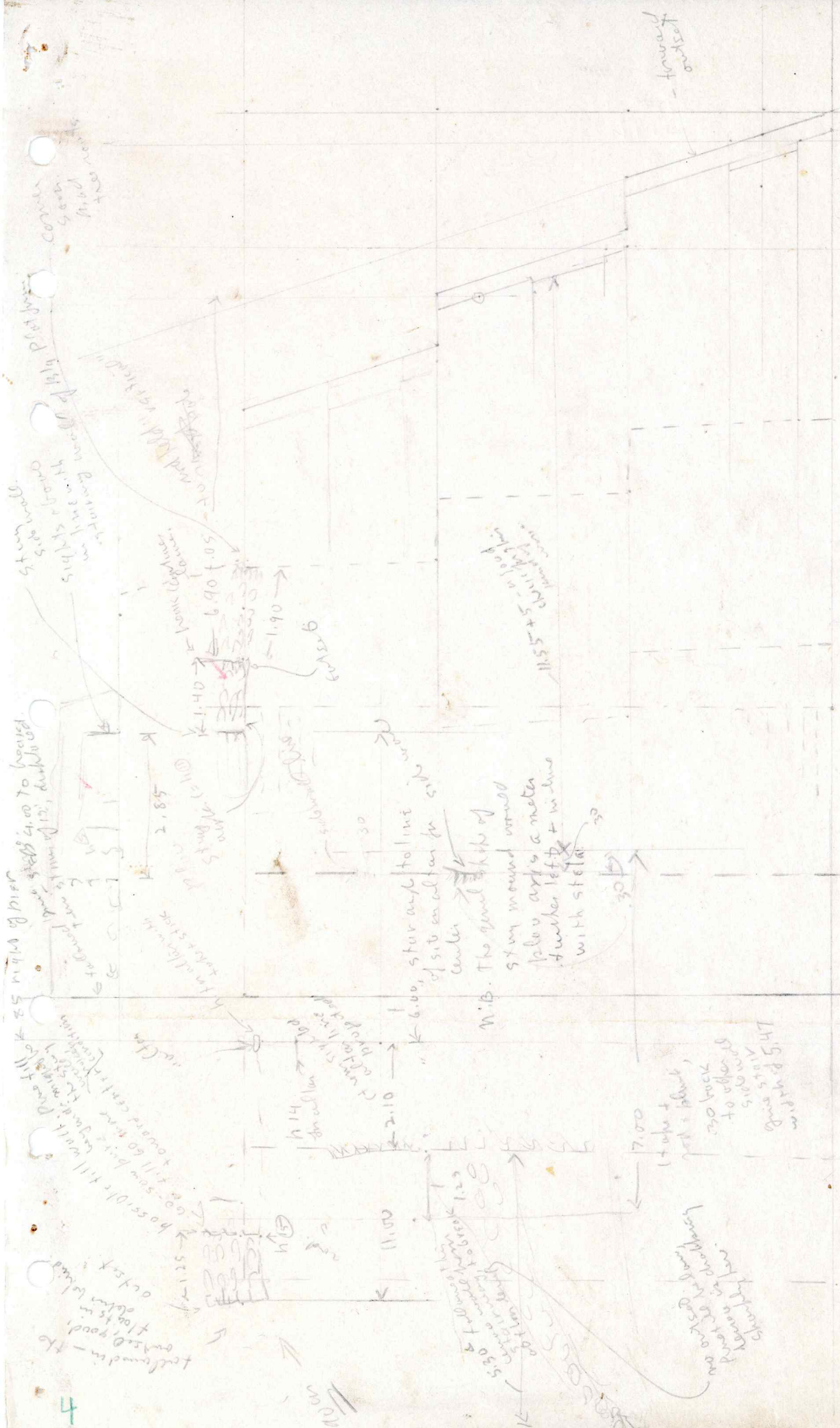

N.B. Sit facing SS view of left pier of building, sit right way in room on the "old day". Line runs to right side of stela as it now lies.

Being cleared in front

Re-do the 3rd wall across from bottom up, along side.

80
97
157

LS

Details 2nd Terrace, left front outset.

Left 2nd terrace.

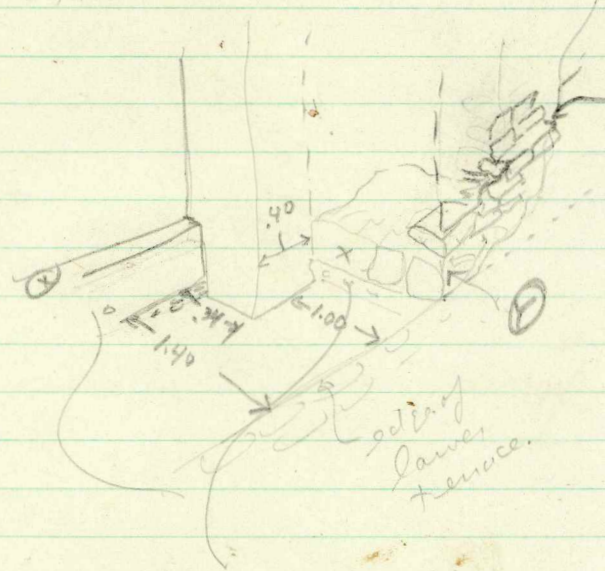

about height of
the basal masonry
2 stones project, 1.7 to .10 above
like top of a basal
masonry bed this does not extend
sliding stones may
short evidence
either way

R-16
Jan 12
1939

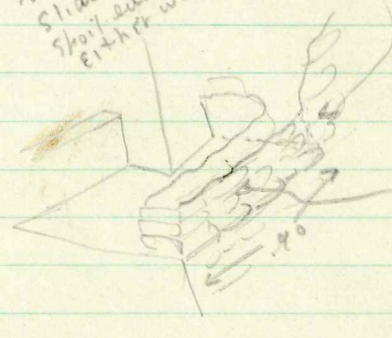

clear
remnants of
a forward
extension of
deep outset
⊕ Survey
90 forward

wide ⊗ + basal masonry.
next in chain 10 of + low chain,
outset going this much lower.
x is a deep secondary outset
Survey to about a meter
it was later extended forward an
unseen distance - lower comes survey .30 beyond the
outset.

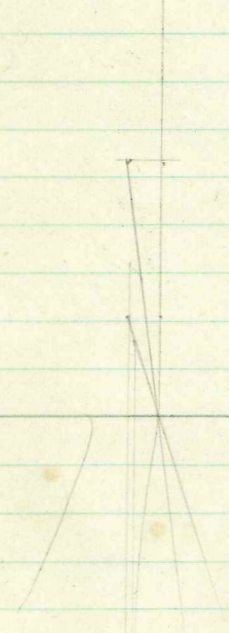

R-16
June 22

R-16
LS

The tertiary construction
is an extension of this,
starting .90 forward +
about .25 high (2 courses).

Surveys 1.00
top in house
sketches. See
other sketch for
very doubtful
total masonry
@ .40.

Reconstruction in
field of secondary
changes, side of
lower terrace,
left front outset.

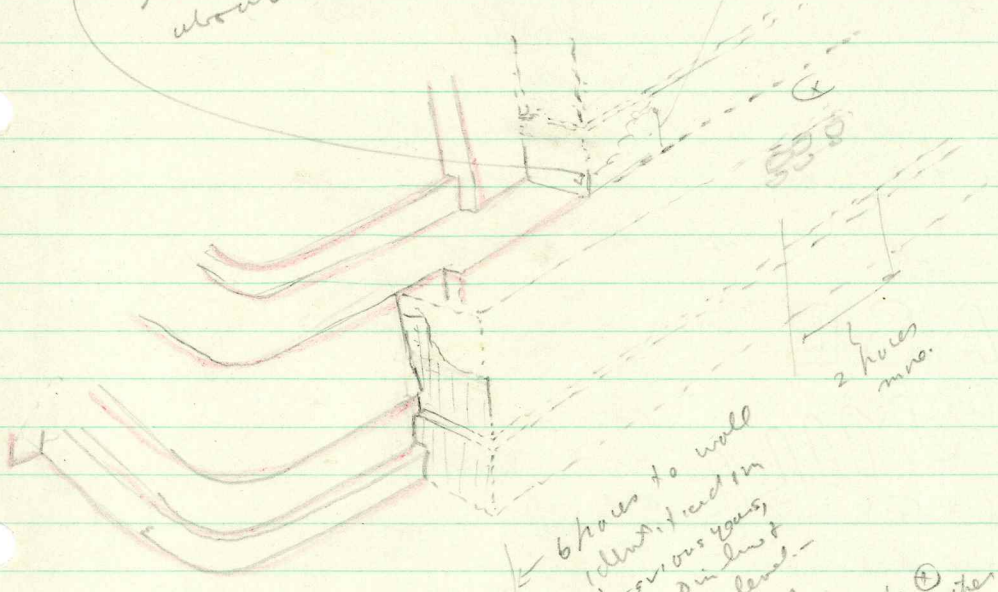

Red = orig.
Block secondary.

6 holes to wall
identified in
previous years,
about in line +
around level -
could say if
outlets
undermined; but the
remains lower in neither
than out - probably not.

along.
 Section, L B w/g front terrace comes, trend to west.
 Col. Altus Frag., position etc.

R-16
 June 22
 Trend

L.S

top of this fill about
 30 above chosen bottom

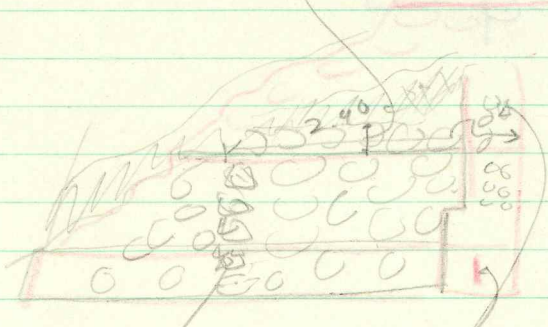

fill wall.

--> The general level of the top of
 kiln from adjoin seen about
 1.40 above chosen level.

this wall is above about the sec. basal modern top
 level, where we went in. It looked like a
 good wall, but without plaster, probably
 something earlier or later than my hyp. of earlier
 it interfered with the design, being forward
 of the out set

The fill does not have the secondary out set wall
 full height: but we cut above here previous years +
 level of wall nearer center indicates it did.

Top terrace + Bl. pond standing - June 22.

Baby altar
 - refused
 standing by
 Ref - he
 know it
 back
 in this
 position

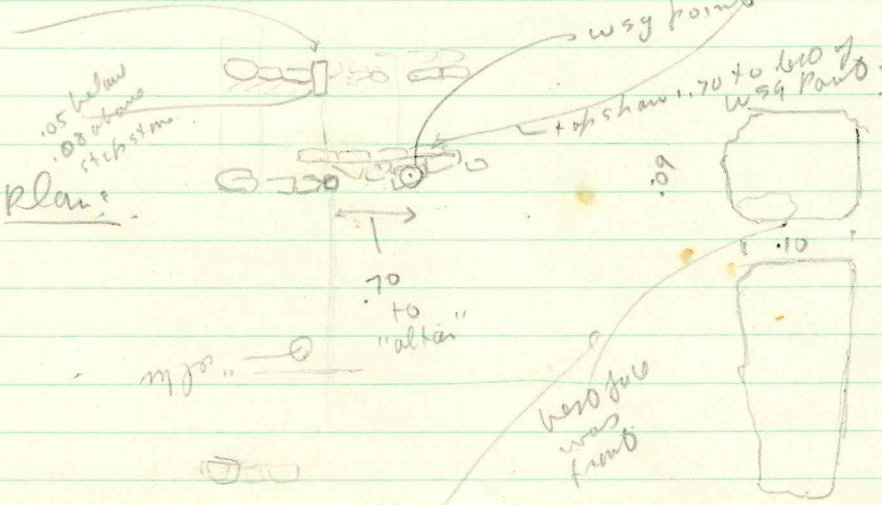

Plan

.05 below
 .02 above
 sitch stn.

Section: NB from horizon, this may
 be within with flight
 above.
 good steps or
 bluish.
 wsg pond
 35
 10
 15
 1.70 to left of
 wsg pond + 1.40 (bad also)
 to right.
 very crude
 no sure
 footing
 Probably as
 a secondary
 step.
 Lots of chices
 a second
 + low rubble.

Miniature altar

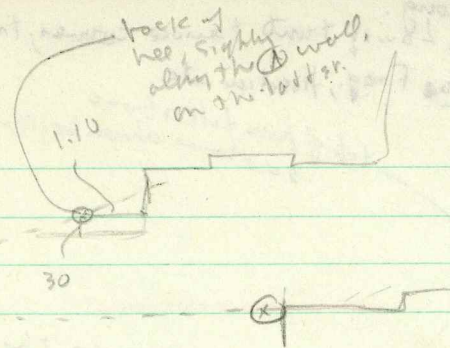

R 16

Sighted on
 v. y. 40 side,
 lower line
 of 13/9. Plot
 Sighting roughly

from ① - 11 with st. sh. st. on 4,
 this sighted notes downward
 very sharply - as much as
 4 meters - sighting along
 the nose certain st. sh. ②,
 it comes out a minimum
 distance from ①.

Eliminate possibility of basal molding, 1st secondary 2nd level? - washed check-up sheet R-16

8.9. where is top of 2nd level, right? ✓

go in behind right outsid, Bld. Plat - see if there is a stair angle or abutment behind it. ✓ - not for 145 in (fill)

8.9 - go in back of altar - to fill or steps ✓

8.9 Fall left side hand out on dam into trench. - see slope of outsid etc? - hatched top of wall a & b

8.9 Check (re-do) all heights at top. ✓ See W 59 also

8.9 - get 1st terrace width at right? ✓ no - too much work

The altar Above no top of standard size Col. Altar.

* 8.9 Check stair debris depth (hard to pyramid). & meas. to stela. - how was it placed? Drop level on it.

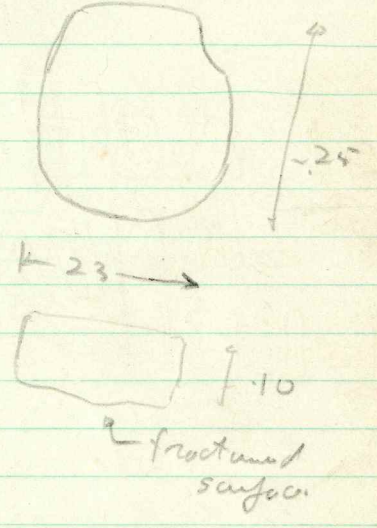

Better measure altar: - look for cache? ✓

* check drains - run under stony in 2nd terrace? ✓

meas see stuff left 2nd level (see descriptive sheet.)

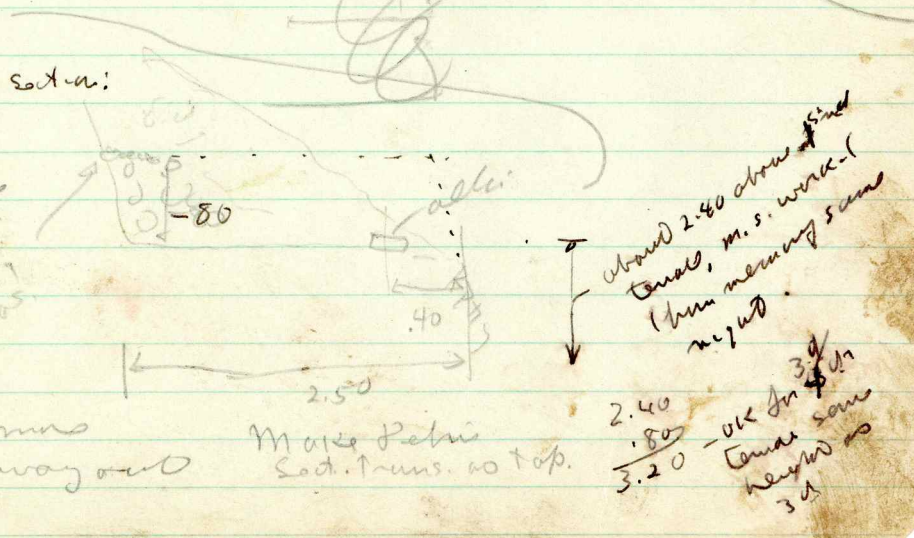
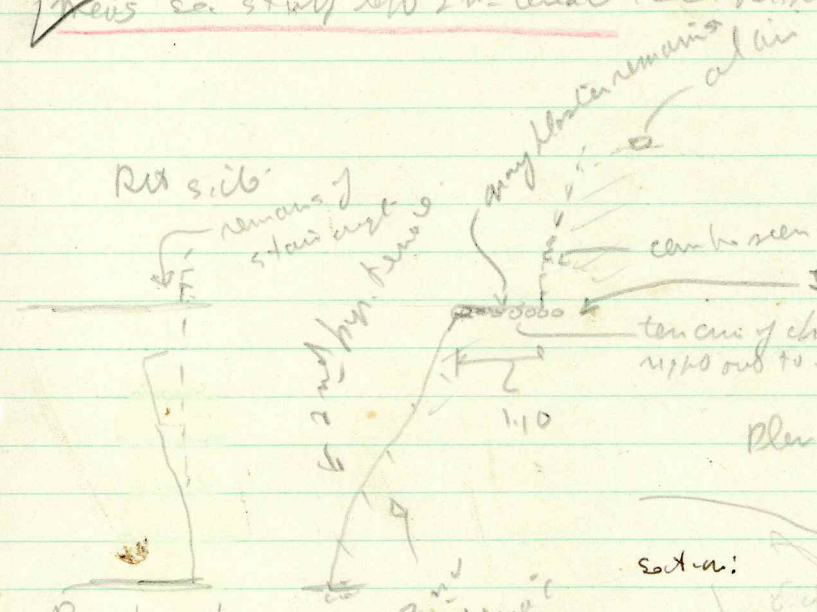

Pig in 3d doorway → falls off 2nd level to voidly to give much holes - no trees

Pig for sec. hand wall in front of rt outsid of Bld. Plat same terrace - falling chics.

Pig for altar 1.00 on the side of Pomb (wsg 16 1/2) then 1.00 runs to right - clean all the way out in front of this area.

R 16
 Jan 24 1930

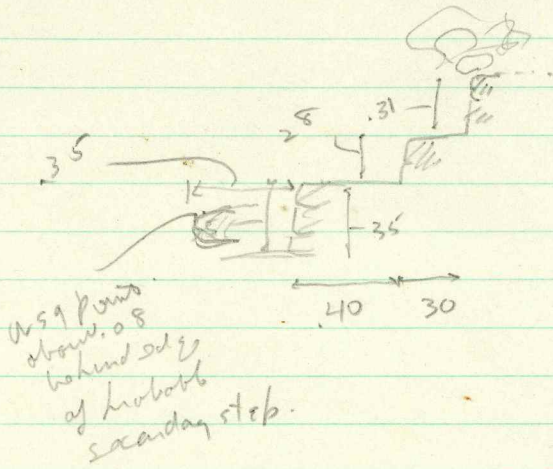

Ald. Pluv steps, lower lens, -
 back of "altar".
 Very good shape.

Nothing below "altar" back, to depth 7.30

R-16 "olin"

← .23 →

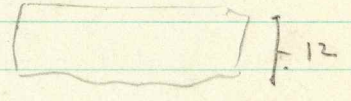

7
bump on
bottom

Sec. 07 = (6)

.25

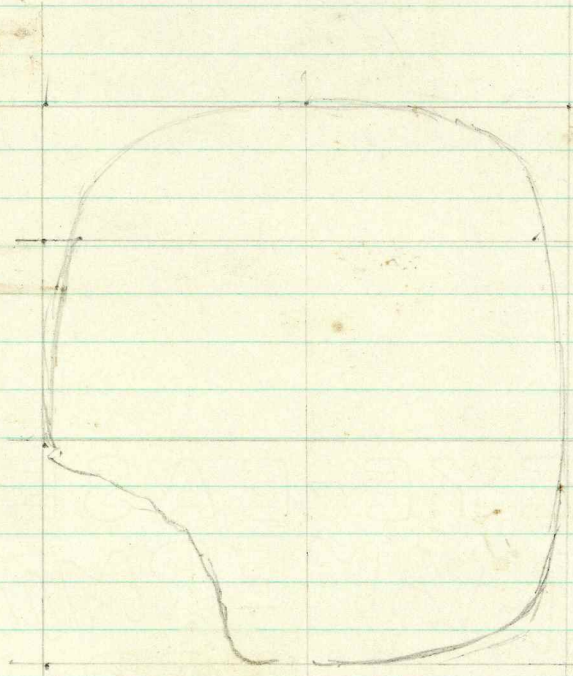

1936
(Cresson)

Francis Point (cont)

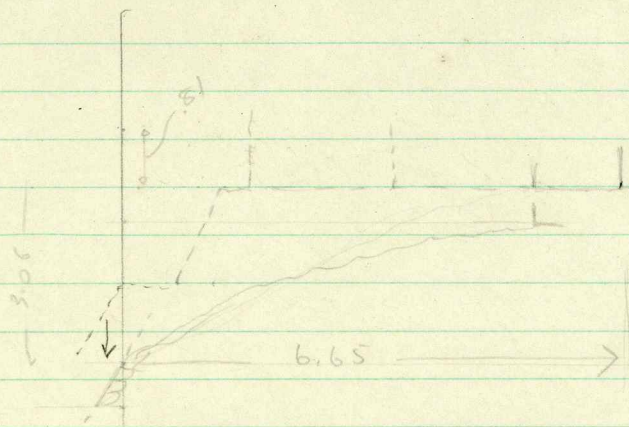

M(1929) - Cressin's wall
is level should be subpl. platform,
& it is in about the
correct position. Cannot find the
note, but this was seen on left
by LS, about a meter or so from
Plinth platform. On this side
it almost connects, in construction -
The latter is loose enough to allow this:
~~But~~ it may be something earlier (cf K-5-1)

306
117
189

2.15
188
173
172

Indention - left side of Bldg. Plot; plants toward
Section & being indented.

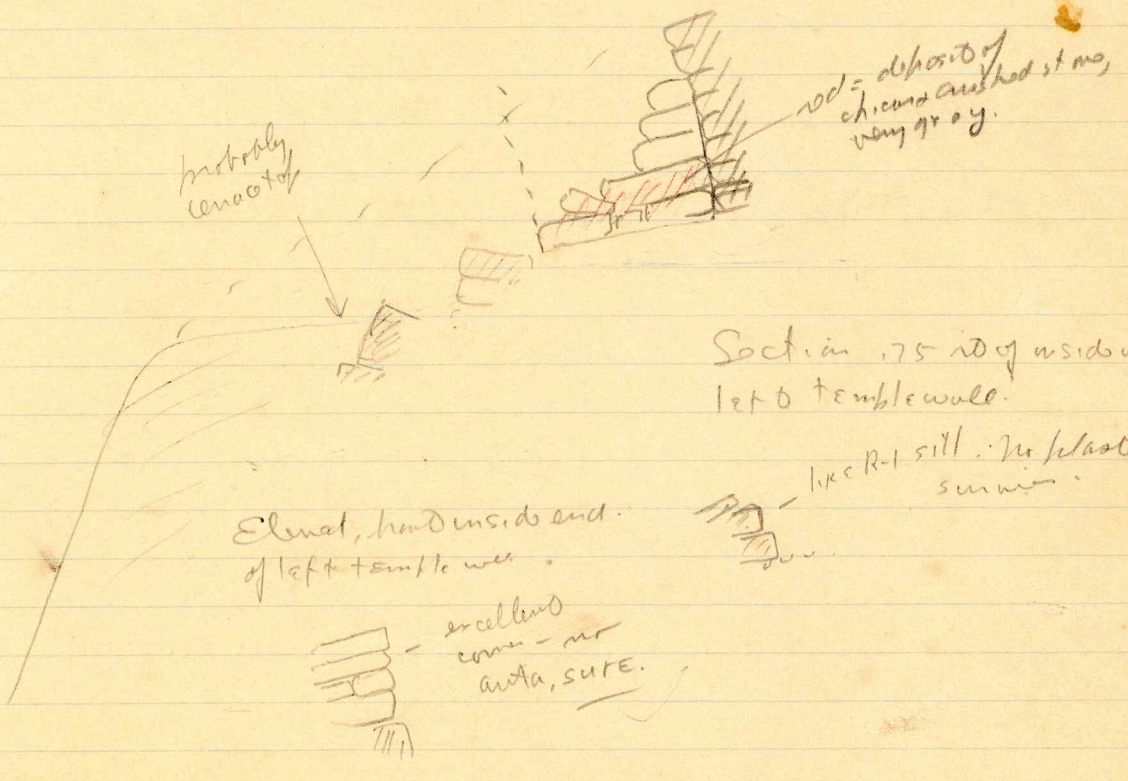
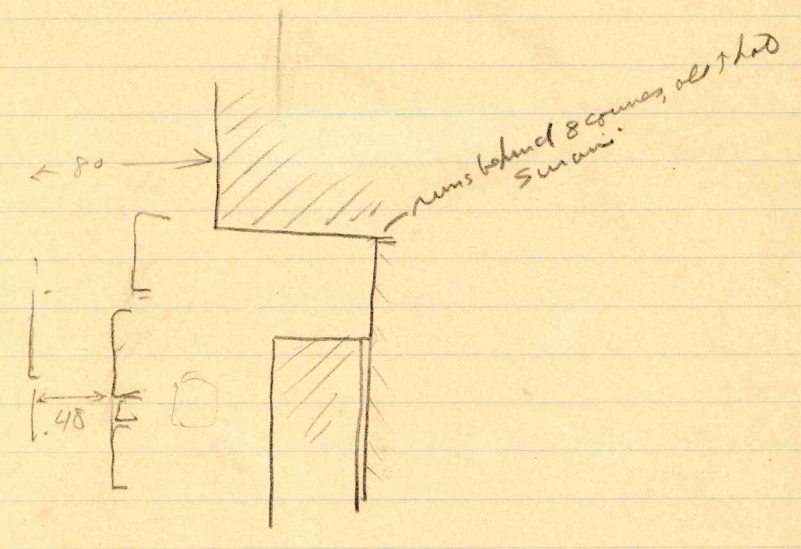

From 1936 notes

Scale 1:100
Partly rectified

hi = .81 above floor material
at left rear corner
of left pier.

SECTION and
ELEVATION A-B

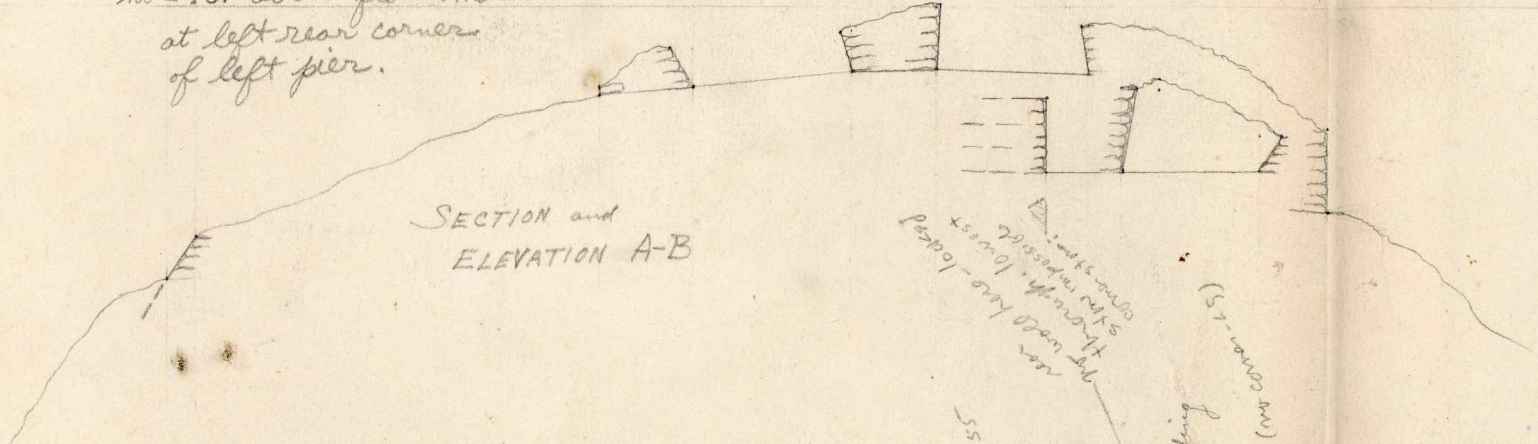

Some concrete
steps on left
side
not here - look
at top of
stone

SS - some part - or some on left

(S) - corner according
to ass. -
rectifying (M) - corner
to ass.

rear wall
very doubtful

5.5

3.18

3.85 ± 5

prob. not to be
used
to bottom

58 - 0.00 ± 0.1

B

2 - 5.0
3 - 5.2

SECTION C-D
including rear terrace wall.

hi = .81 above
same spot

A -

about
4 steps

of you they
look
like 6 or 7 steps.
No absolutely sure.

D -

3.18
3.85 ± 5

R-16

FC
1936

1935
(Cresson)

(total of 3)

33-1
R-16

5/21/35

Cross

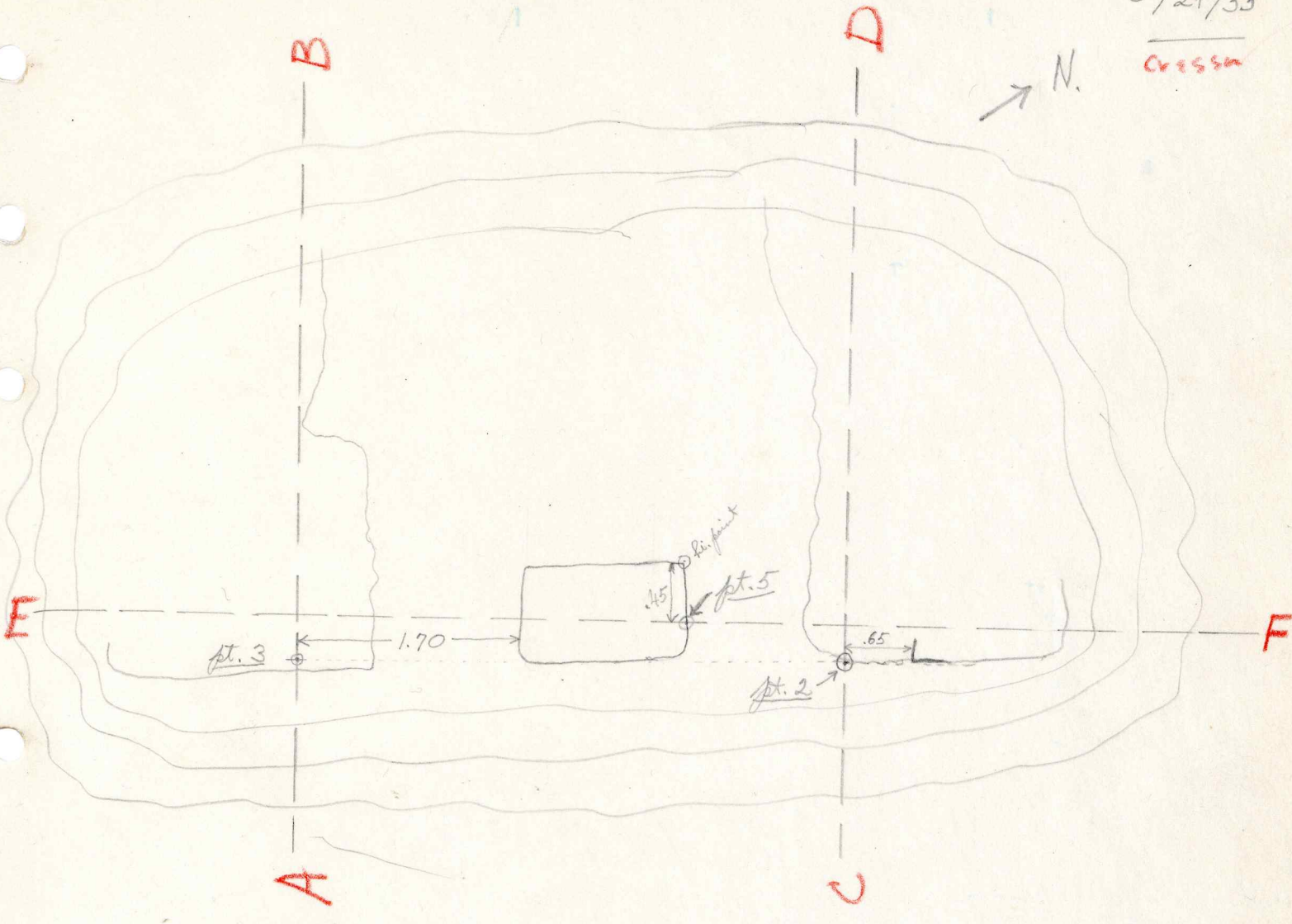
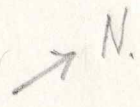

probably a wall or pier in this corner

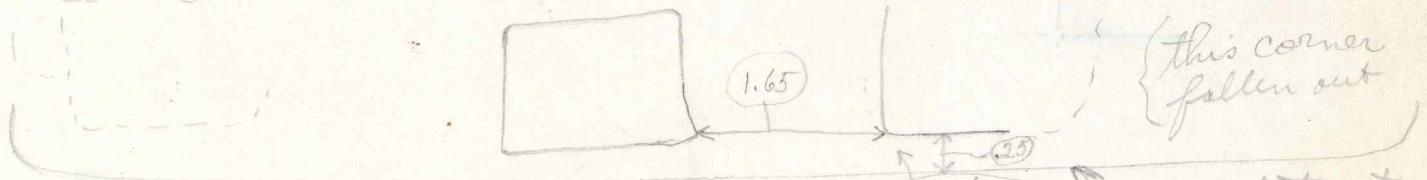

substructure stones falling out to side + down.

substructure stones falling down + out.

also incline to rear, possibly because it was battered

1 (total of 3)

5/21/35

CLASS

A
Horizontal

1	.00
2	2.40
3	3.17
4	5.20
5	8.00
6	9.75

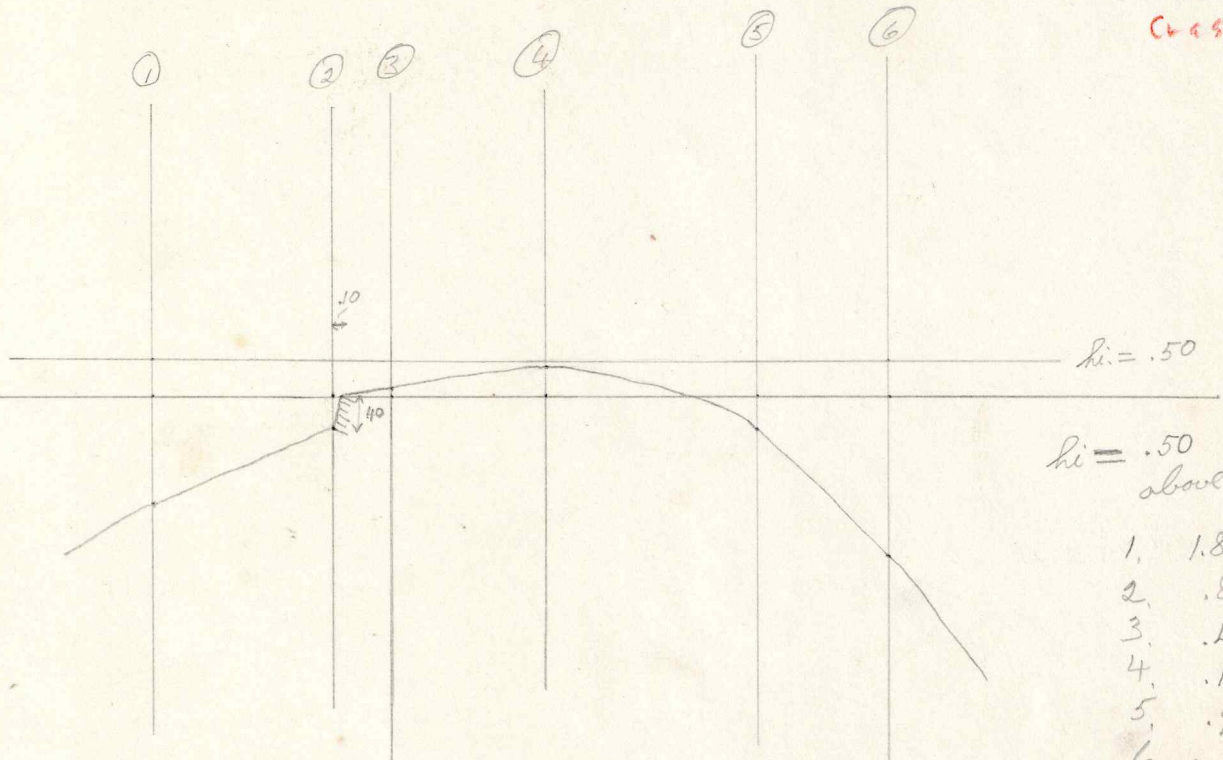

B
 $h_i = .50$
above floor

1	1.89
2	.89
3	.40
4	.10
5	.90
6	2.58

h_i = height above bottom of pier at left rear corner.

C
Horizontal

1	.00
2	2.35
3	4.10
4	5.50
5	8.08

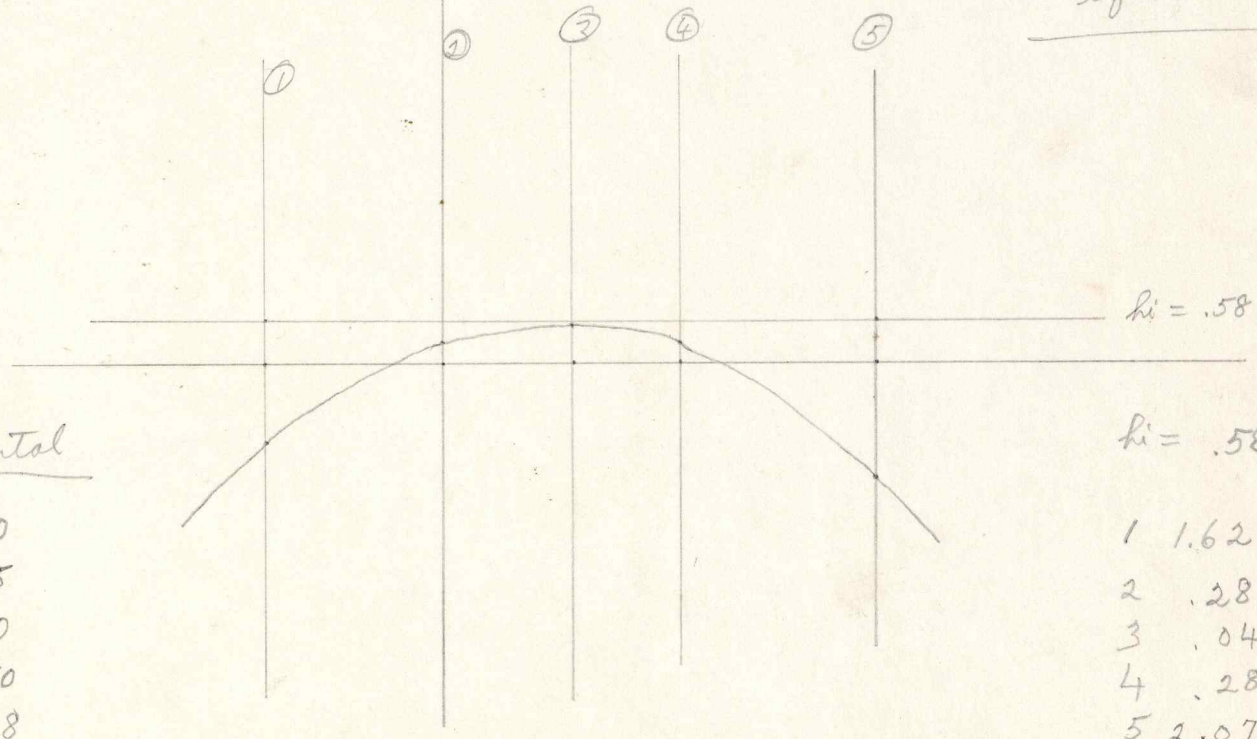

D
 $h_i = .58$

1	1.62
2	.28
3	.04
4	.28
5	2.07

R-16

5/22/35

CROSSM

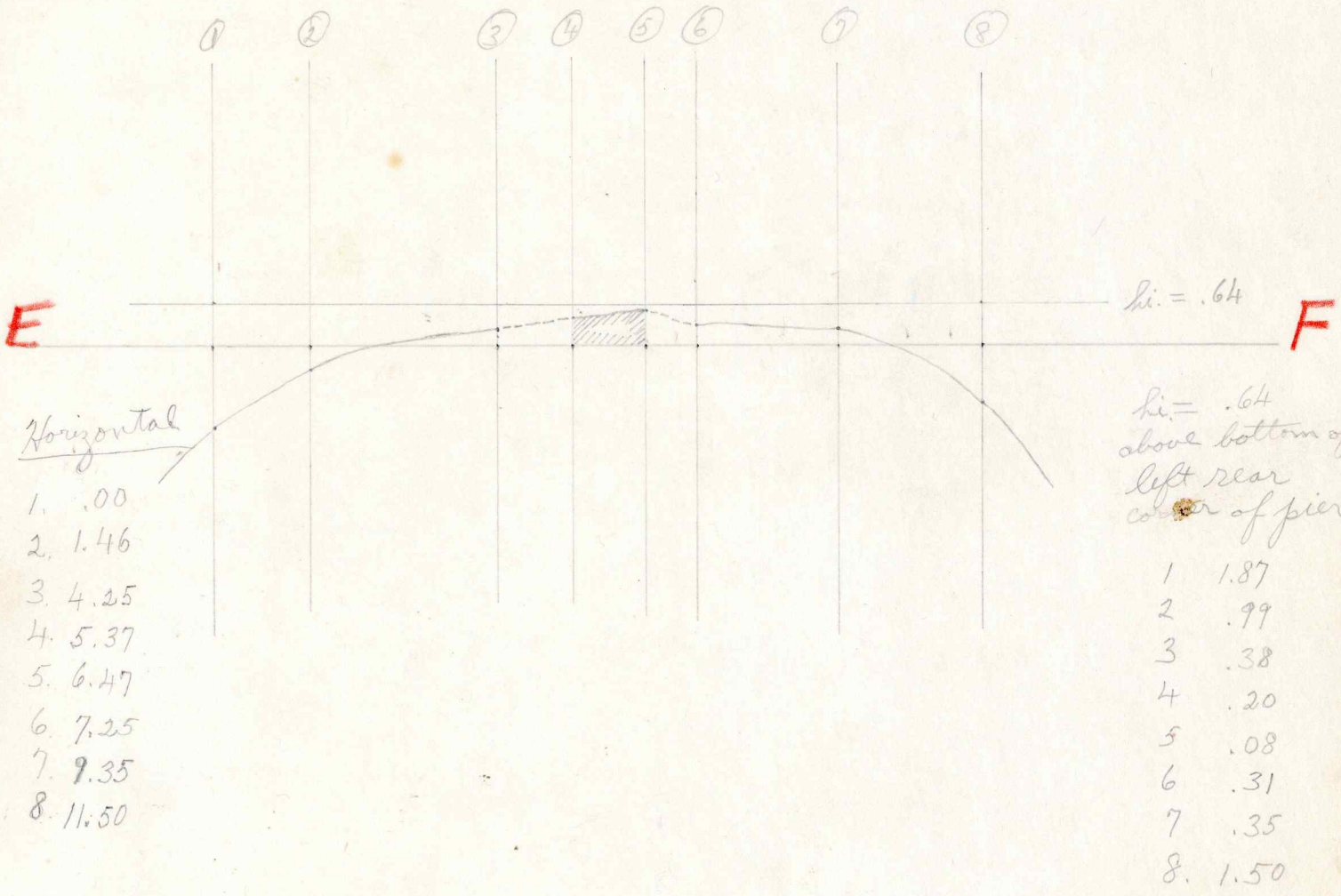

Horizontal

$h_i = .64$
above bottom of
left rear
corner of pier.

1933
(LS)

LS Sr, 1933

Structure of base 1 a 7
 in .01 to .02 of diameter
 with little bit small
 stone of the mnt (i.e. concrete)

Heavy stone block mounts .50 x .30 x .10 s.g.
 Common stones fairly well rough worked -
 not "tooled"

No finishing plaster left.

the face has facial
 broken, but filter is
 shannon m. broken
 top

Stone
column

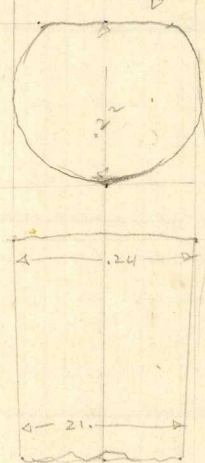

sides (except
 "back" - see above)
 nicely "tooled"
 top. but no top cut
 was smooth.

not finished in
 bottom

cuts. -
 See catalogue.
 was undoubtly
 under column,
 which fell
 back & dam (see plan
 + section)

No shreds evident
 of cuts but

3 new days.

3.50
 5.40
 3.00 - .160
 5.10 - .140
 2
 54
 5. - .80
 30 - .40
 7 - .140

with 65 x

Sta R-16 - 1933
sub. 02 21.00

$$\begin{array}{r} 8.5 \\ 1.68 \\ \hline 3.50 \\ 5.40 \end{array} \begin{array}{l} 3.00 - .60 \\ 5.50 - 1.90 \end{array}$$

$$\begin{array}{r} 2.90 \\ 5.40 \\ \hline 2.50 \\ 5.80 \\ 7 - 1.40 \end{array}$$

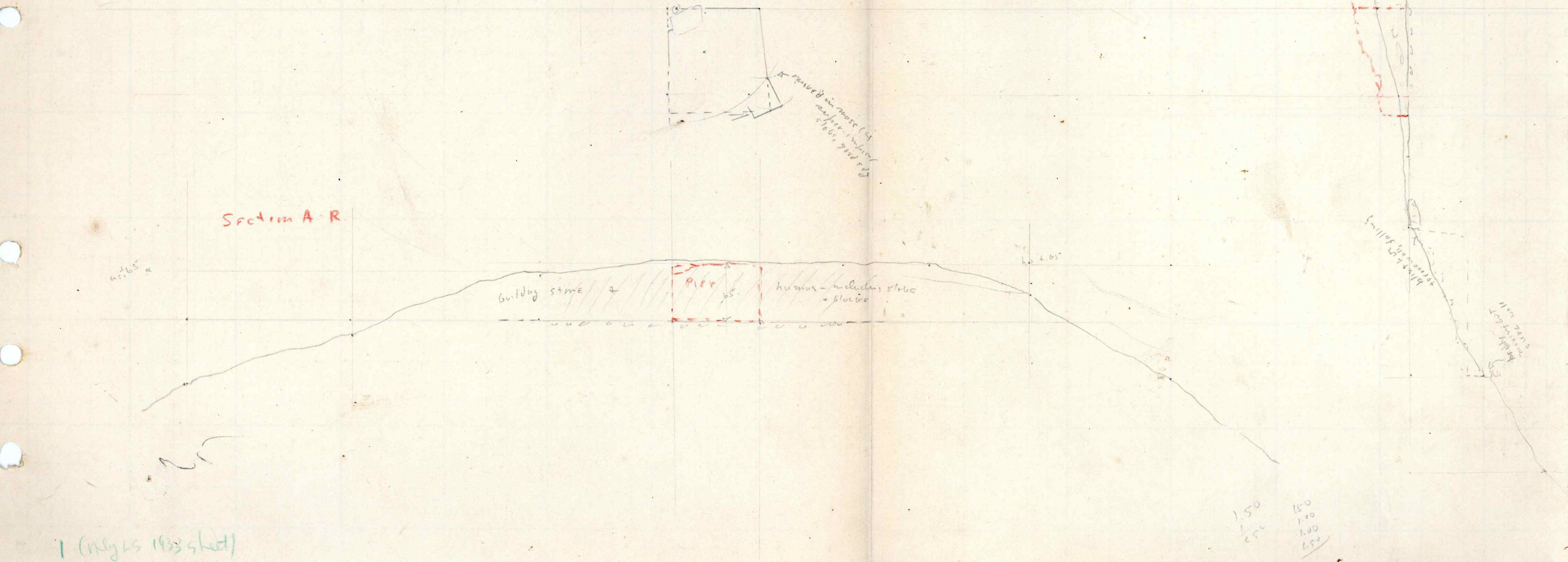

Section A-R

building stone
 pier
 humus - including stone
 + blocks

1 (Mg. 15 1933 sheet)

$$\begin{array}{r} 1.50 \\ 1.40 \\ 1.40 \\ \hline 6.50 \end{array}$$

Sta. R-16