

R.10 recast.

From
Survey in
Sect in
in notes.
(level)

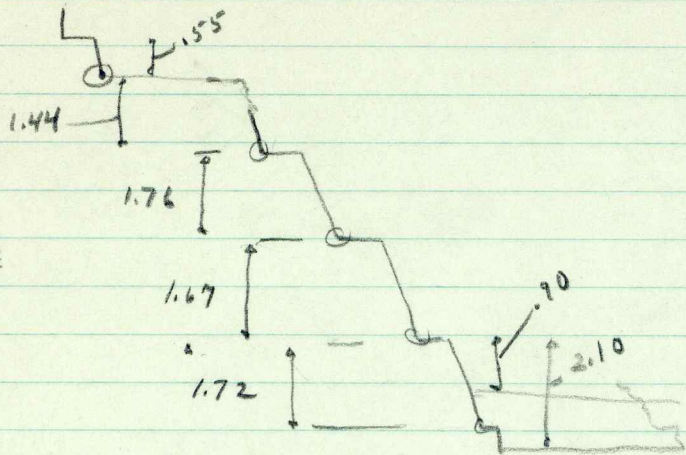

$$\begin{array}{r} 1.76 \\ 1.67 \\ 1.72 \\ \hline 3 \overline{) 5.15} \end{array}$$
 1.72 on 1.55 + 1.72

$$\begin{array}{r} 2.10 \\ 1.72 \\ \hline .38 \end{array}$$

Heights:	ave		
Plinth =	55	actual	55 55
Trenches	1.45		1.44 +
	1.72		1.76
	1.72		1.67
	1.72	16	<u>1.72</u> 6.59
Base	1.72		
	.38		38
	<u>7.55</u>		
	2		
	6.59		
	<u>58</u>		
	6.97		
	+ 55		
	<u>7.52</u>		

$$\begin{array}{r} 2.10 \\ 1.20 \\ \hline .90 \end{array}$$

5.39

$$\begin{array}{r} 2.24 \\ 1.44 \\ 1.76 \\ 1.67 \\ 90 \\ \hline 5.77 \\ + 55 \\ \hline 6.32 \end{array}$$
 7.07
-1.20
5.87

6.32 < on table

See other sheets for
best averages.

$$\begin{array}{r} 1.22 \\ .76 \\ \hline .46 \end{array}$$

$$\begin{array}{r} \textcircled{1} \text{ road } 1.22 \\ \textcircled{4} \text{ road } .15 \\ \hline 1.07 \\ + .39 \\ \hline 1.46 \end{array}$$

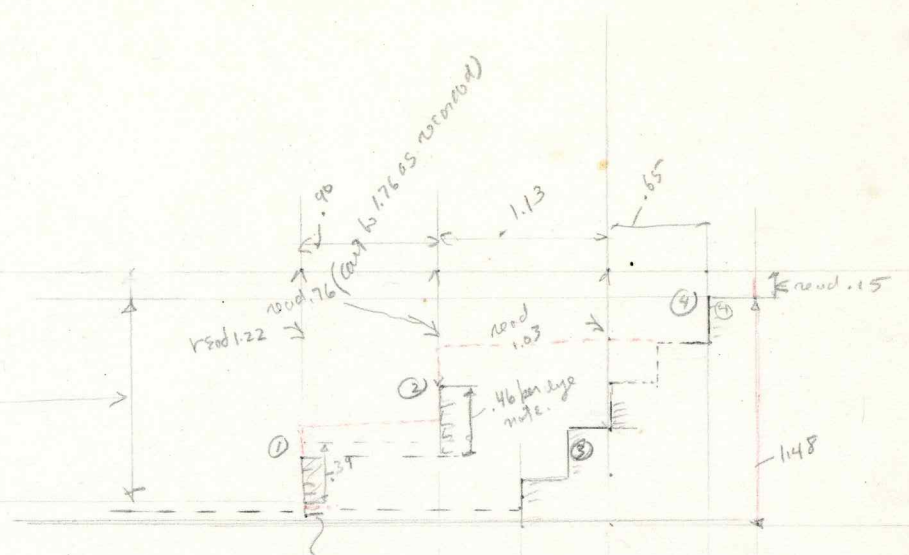

$h = 1.56$ above a floor
 of end of left canopy
 Early stuy, which is
 39.6 below ledge (at
 side).
 height 37.2

$$\begin{array}{r} 1.22 \\ .76 \\ \hline .46 \end{array}$$

Per p 37-5.
 $\textcircled{4} - \textcircled{7} = -6.19$
 $8 = -7.67$

$$\begin{array}{r} 767 \\ 619 \\ \hline 1.48 \text{ height of } 4 \\ \text{above early floor} \end{array}$$

$$\begin{array}{r} 5 \mid 1.48 \text{ to } 2.96 = .30 \\ \hline 18 \\ 48 \\ 45 \\ \hline 30 \end{array}$$

.02 leeway
 for early
 floor
 Settled - See
 location at right
 where base of Reno Step ① is only
 .14 below top of lowest early step
 and a floor was identified
 inside + against it, only .08 below
 the top. + slope between was
 indicated.

Rest no:

Check with TAP
 for height at extreme
 left. + it. - We don't have left
 - at right, toward step
 low bed

Best
restoration,

TAP found top of
 this step (top of
 next rather) .47
 above base of
 R-9 lower step.
 When 45 at right
 .39 @ center

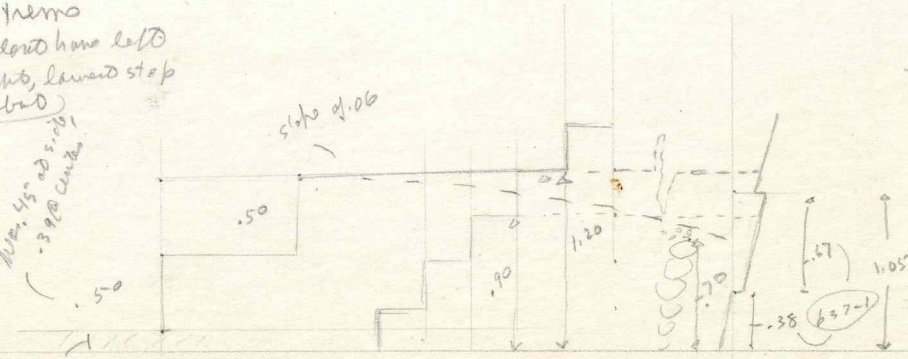

$$\begin{array}{r} 5 \mid 1.55 - 1.31 \text{ as } \textcircled{1} \text{ road } \\ \hline 15 \end{array}$$

$$\begin{array}{r} 1.78 \\ 1.10 \\ \hline .68 \end{array}$$

(120 shown)

$$\begin{array}{r} 67 \\ 38 \\ \hline 105 \\ 145 \\ 15 \\ \hline 163 \end{array}$$
 R-10

lower plaza floor = -7.67

From original sheet 37-6

R-10

Comp. Section just beyond rt end of stwy
 ↓ over end of same, 1:200.
 horizontal distances assumed from center section

$h_i = -5.67$
 $= 2.00$ above plaza floor

	$h_i = 2.00$	
① road	1.95	
	.05	1.02
② road	2.00	
	1.59	
	.41	
③ road	2.00	
	1.81	
	.19	
④	2.00	1.95
	1.87	
	.13	

Probably = floor N of R-9

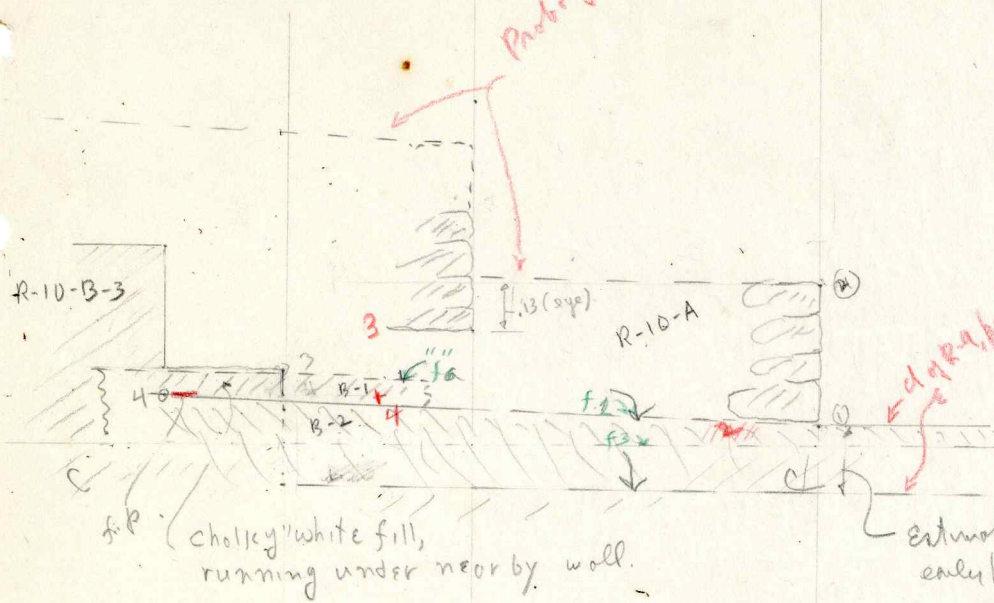

① 1.95
 ② 1.81
 .14 - Base of Sec step terrace below top of early steps
 1.95
 1.87
 .08 rise in early floor
 plaza floor at AB (lower)

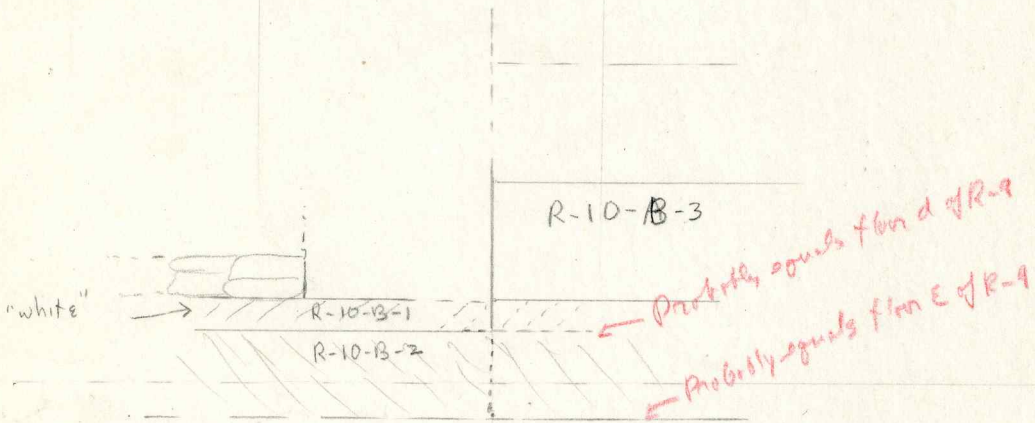

- 1 Bag Q
- 2 Bag R (2 above floor 3, 1 on it)
- 3 Bag S
- 4 Bag T (But G.D. says equivalent of B-2 or 3)

h = 3800 (1937)
 h = 3200 (1937)

1.40 5' railed 1937
 .128 (stone masonry) 1937
 'Crescent' 1935 hi
 1.5' 1937 1937
 2nd Army of hollow wall at masonry, 1933, no side of room

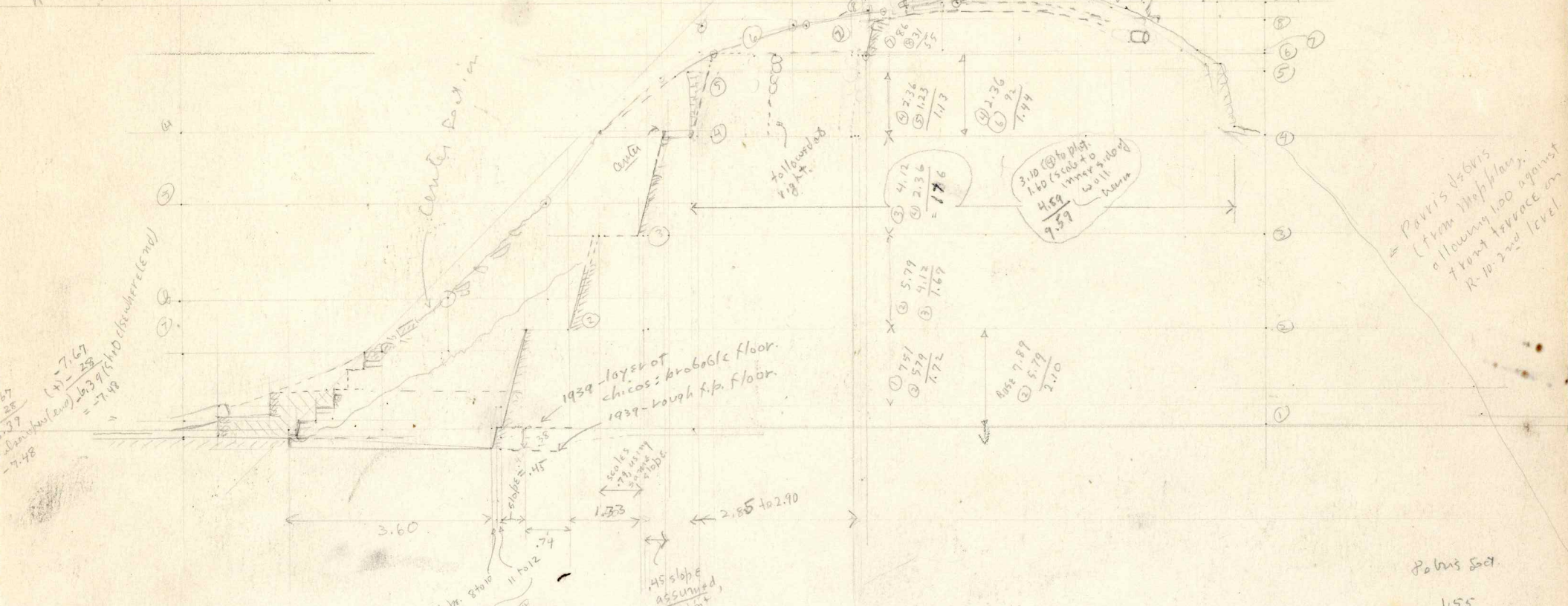

Comp Section AB

⑨ = 3200	⑩ road	2.89	38	-2.51
+ .38 (h1)				
④ road down		2.74	38	-2.36
⑤ road		1.61	38	-1.23
⑥		136	38	-92
⑦		124	38	-86
⑧		69	38	-31
⑨ = 0.00				

Now hi = .43 above Pt ②

		-5.79	+ .43	-5.36
① road		2.15		-5.36
				-7.51
Base of basal ledge		-7.51	-38	7.89

Center Section

hi = 1.11 above same zero.

① road down		2.00	1.11	-0.89
②		2.05	1.11	-0.94
③		3.38		-2.27
④ 1/2		1.11		
⑤ road		1.15	2.39	-3.54

⑥		-2.83	-2.39	-5.22
⑦		3.80	2.39	-6.19
⑧ road		2.00	5.67	-7.67
⑨		2.02	5.67	-7.69
⑩		1.83	5.67	-7.50
⑪				

Palms Sect.

	1.55
	1.19
	1.78
	2.60
	7.12
	-30
	6.82
	3.42
	10.24 (See 10.20)

3.42
-30
310 - Blk. Plat. Capes with 2.85 105 with .25 TAD Survey

7.50
+1.89
6.61 = base height

(Plaza uneven)

THIS IS THE CENTER SECTION
 NOT THE 50% SECTION

R-10
1939

R-10. LSSJ
NOTES

Jan 16 1939

Yelp stair angle:

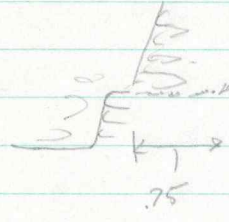

travels out as a fairly certain
floor level, but tacked to
find plaster (Est ca. 1.00
m. lot of stuy. Below the
"visual molding" indicates the pyra:
preat just kind of absolute
chees as if from floor

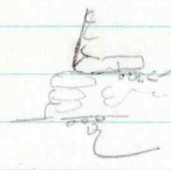

perfectly cut air
rough but trim finished plaster -

Instrument Baseline top; (56); (17); (5)

R-10 1937
 Second Plan Sheet
 Secondary Platform

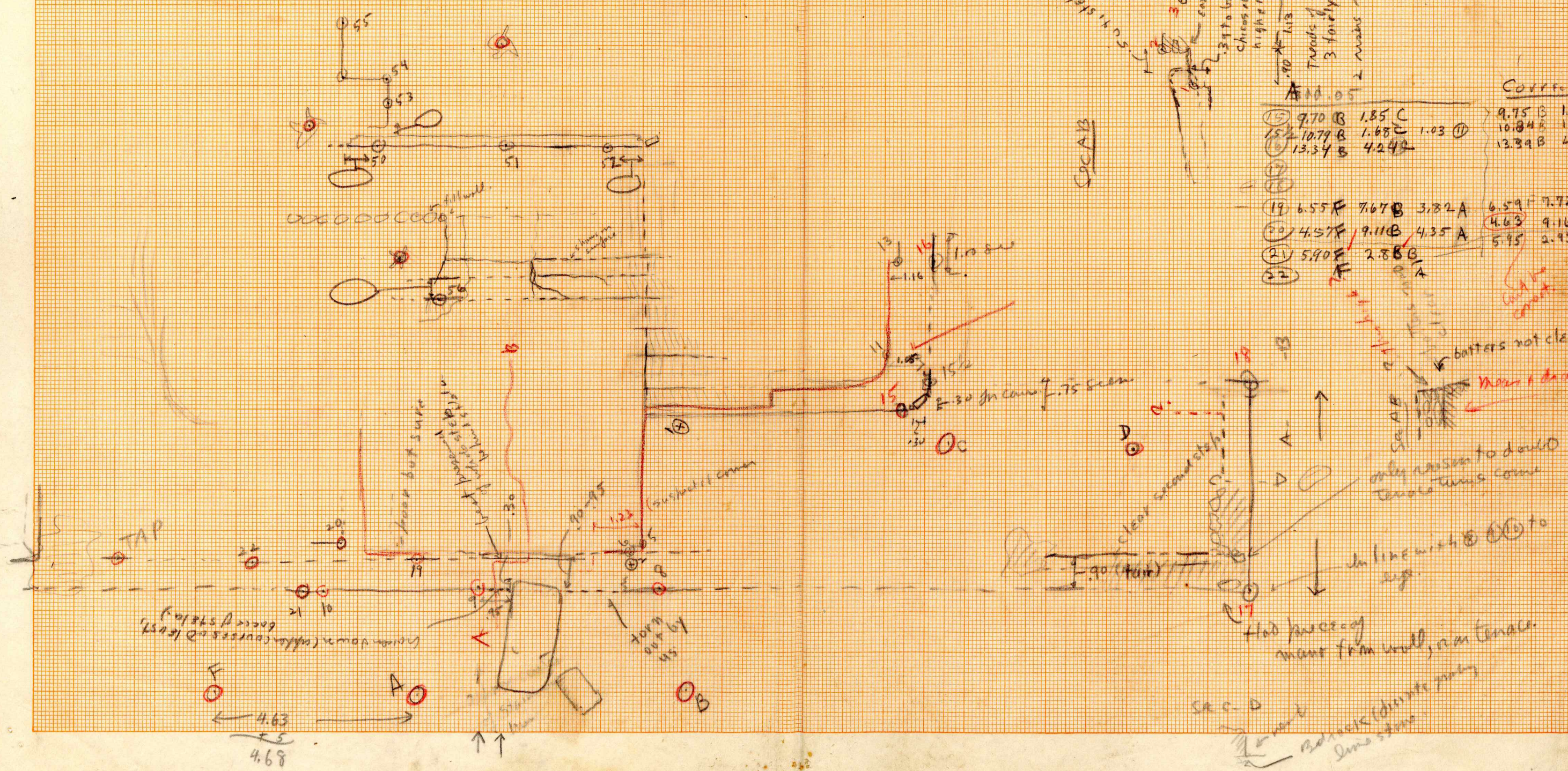

HI - 180 above floor
 20 @ 20 inches 29 below
 ledge. 54.5
 level 182.4
 176.1
 1.03
 1.15
 1.78 (at end of
 style
 (cutting?)

NEAREST ON THE
 STAIRS TO PLACING STAIRS
 (1) (2) (3) (4) (5)

capacity sum of
 1.34 to grade
 chairs about .05
 higher

Net weight up
 rises levelled

Treads of stairing main 91 to 35 in
 3 fairly good places
 2 main measures .29 + .30 (very
 tight)

			Corrected	
(15)	9.70 B	1.85 C	9.75 B	1.90 C
(16)	10.79 B	1.68 C	10.84 B	1.73 C
(17)	13.34 B	4.24 C	13.39 B	4.29 C
(18)				
(19)	6.55 F	7.67 B	3.82 A	6.59 F
(20)	4.57 F	9.11 B	4.35 A	4.63 F
(21)	5.90 F	2.88 B	A	5.95 F
(22)				2.98

KEUFFEL & ESSER CO., N. Y. NO. 809-141
 Millimeters

37-2

PIEDRAS NEGRAS *Cla-May* 1937 STR. R-10 R-10 1937

OP. No. _____ MUSEUM CAT. _____ L S Jr

SCALE 1:100 (rough) SEE PHOTO Nos. _____ P 37-2
Plan Sheet 2

REMARKS Plan Sheet #2 (+ sections)

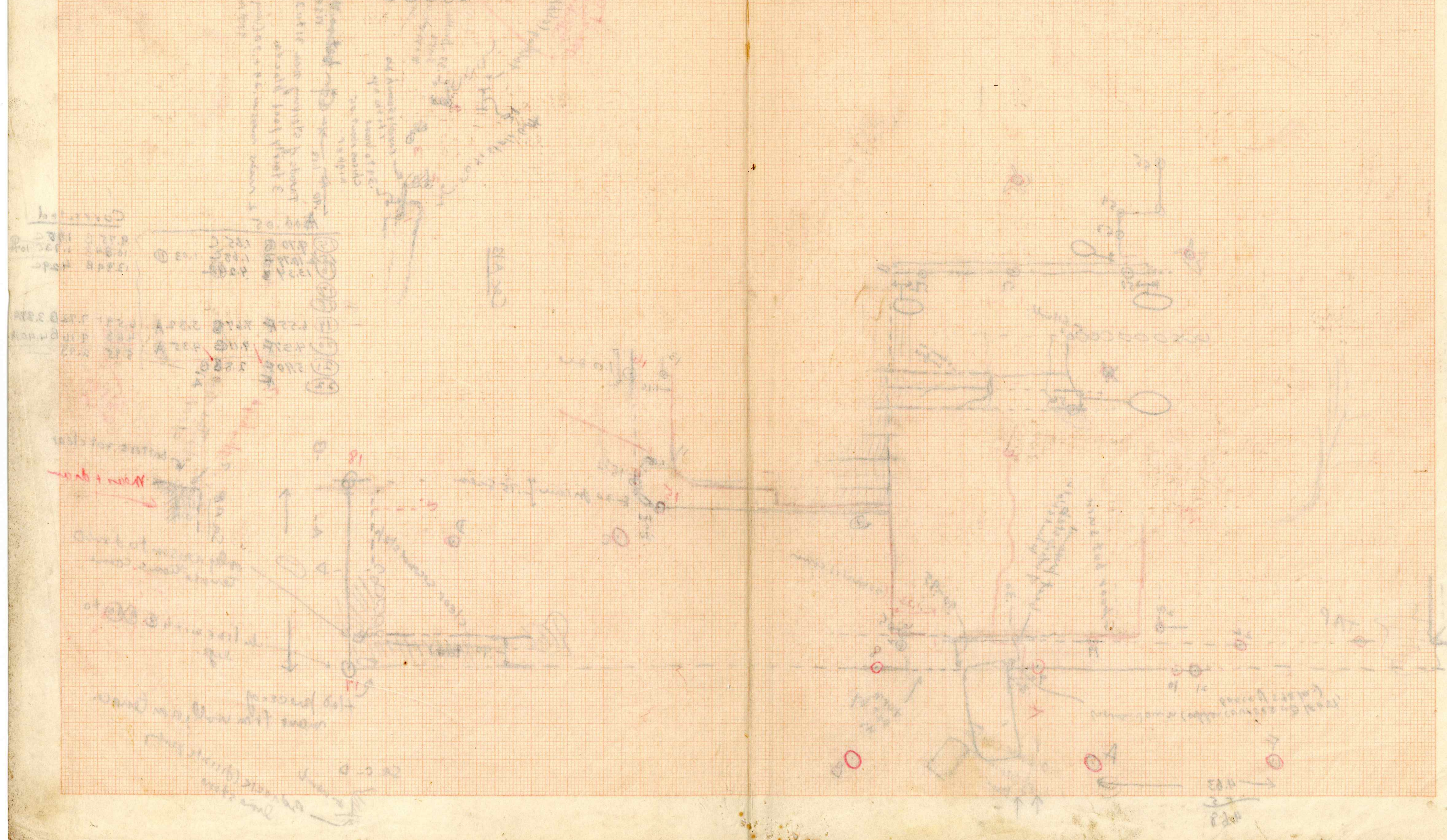

Apr 19
R-10

R-10 R-10
R-11 1937

LSSR

C.P. No. S-22

MUSEUM CAT.

37-3

SCALE SEE PHOTO Nos.

REMARKS

Preliminary sketch sheet - very poor guessing.

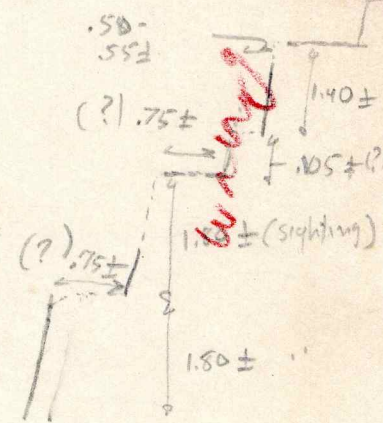
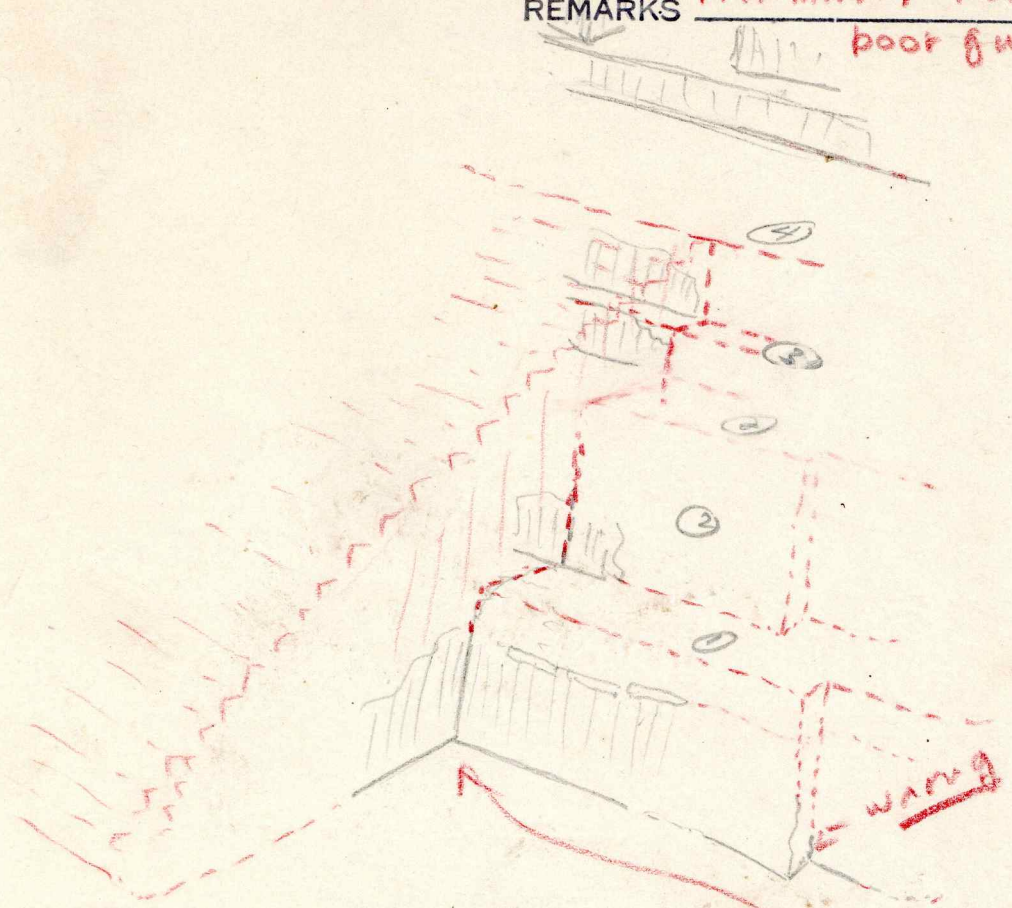

These slots
noted in sketch.
3' 0" x 4' 0" over hung
.40 from stair
Behave they as forced
out by roots of stump
behind + above + the over
by accident being caused
3 slots side by side
same level, making a
good plane of clearance.

Badly falling but certain
stairway side walls survive as
against terrace ① only.
walls of terraces ②-④ survive
only behind stairway (if it was
as wide at top as it bottom).

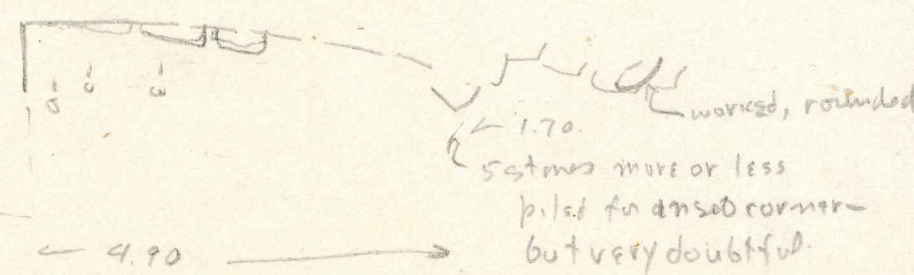

PIEDRAS NEGRAS April 1937 STR. R-10

OP. No. S-22 MUSEUM CAT. S-22 **Elevation Sheet**

SCALE 1/100 SEE PHOTO Nos. 37-4

REMARKS 1st reconstruction in field, with added notes

Red = elevation notes -
extent of surviving walls

✓ a very doubtful corner
check up

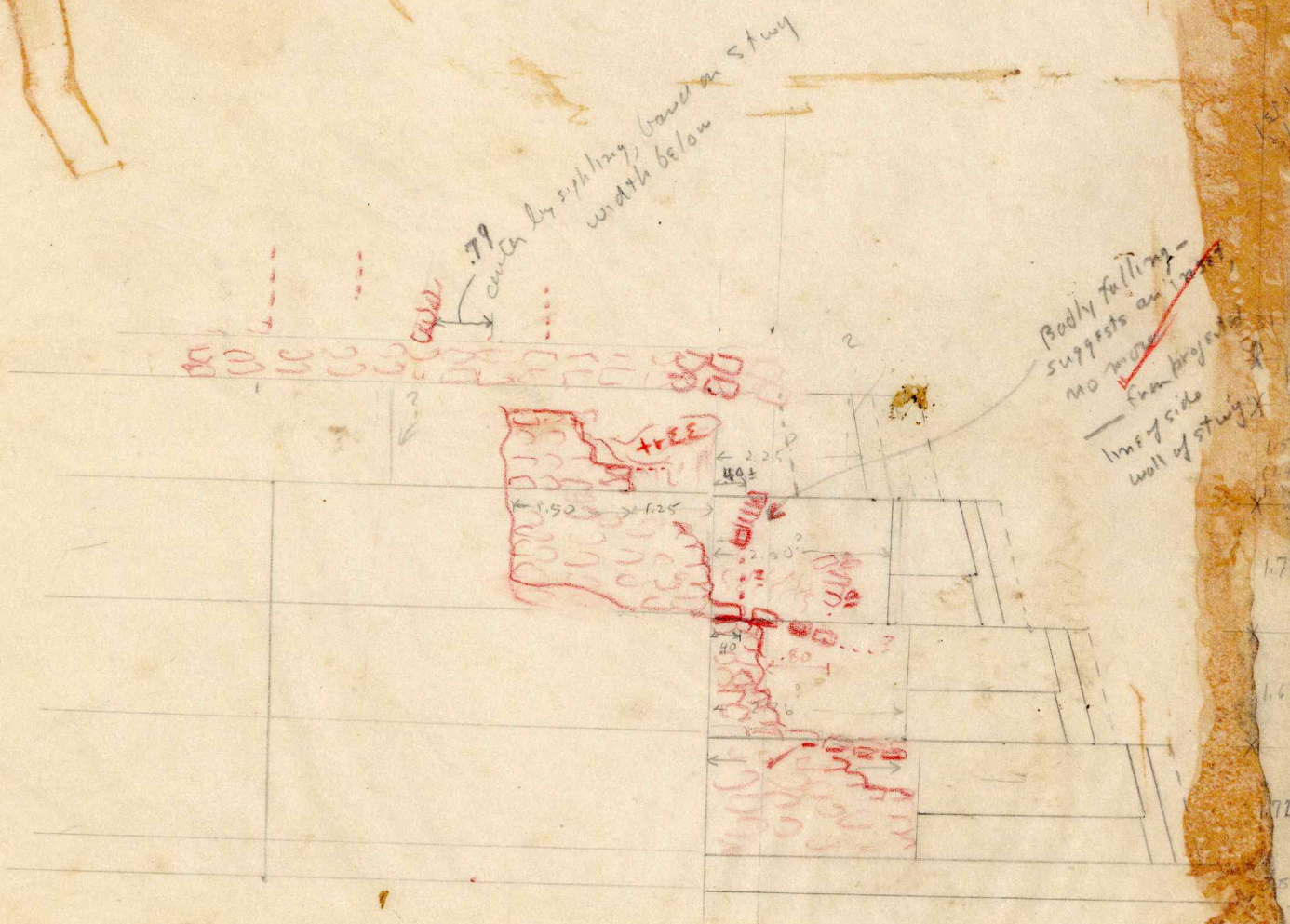

sighted with stakes
.80 from stony wall

Section about 700 ^{right} left of left side of stairway.

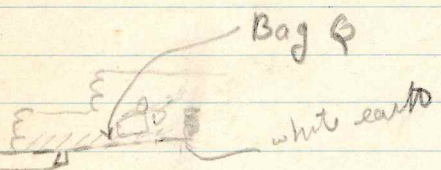

Loc. .75 right of stela 27.

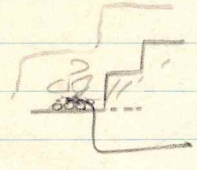

3 skid .05 above

Bag R on level of blaza floor which runs under stwy.

The same "surface"

Revised Section Secondary Terrace

Bag S

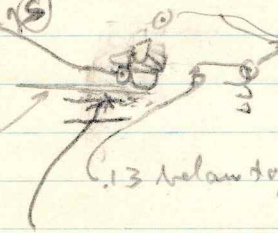

levelled on 1st section

was head of 100 - perhaps higher behind stela, or raised by stump

.13 below top of front steps

Bag S

Bag T

Sec A B

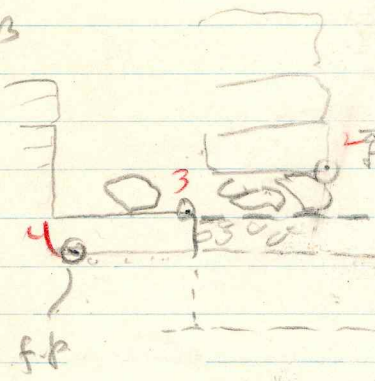

$h_i = -5.67$

① $\frac{1.95 \text{ diam}}{1.31} = 1.49$

③ 1.81

④ 1.87

② $\frac{1.59}{1.26} = 1.26$

$\bar{f} = .13$ (22 per levels)

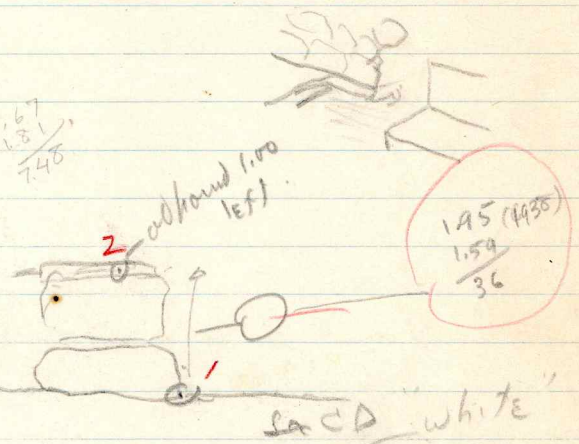

$\frac{1.95 (1435)}{1.59} = \frac{1435}{36}$

Sec CD "white"

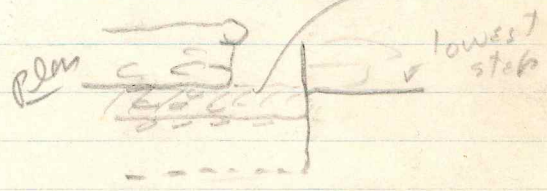

Plan



Plan (100) of step

Elevation

$\frac{1.95}{1.81} = 1.14$ means 1st step in with blaza floor

B

REMARKS Plan + Section notes - "Buttress, left side, first terrace."

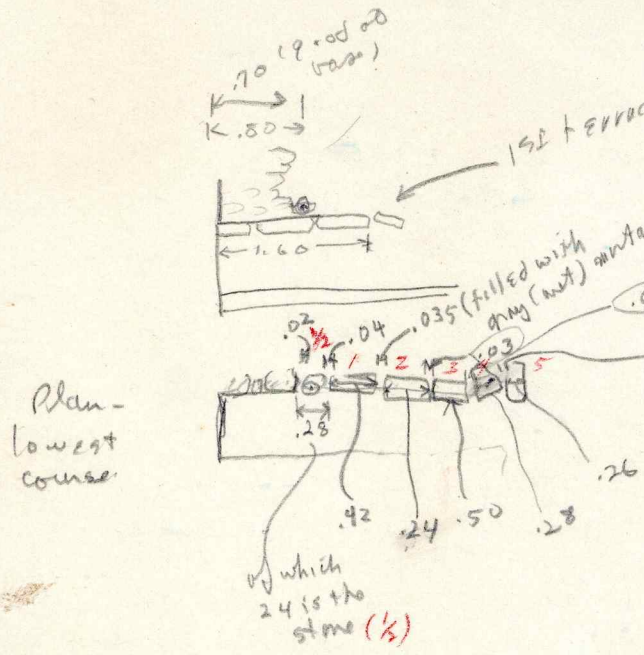

displaced by no. 06 (displaced) within .02 or .03 of 4.0 few cms higher like it, lower at front

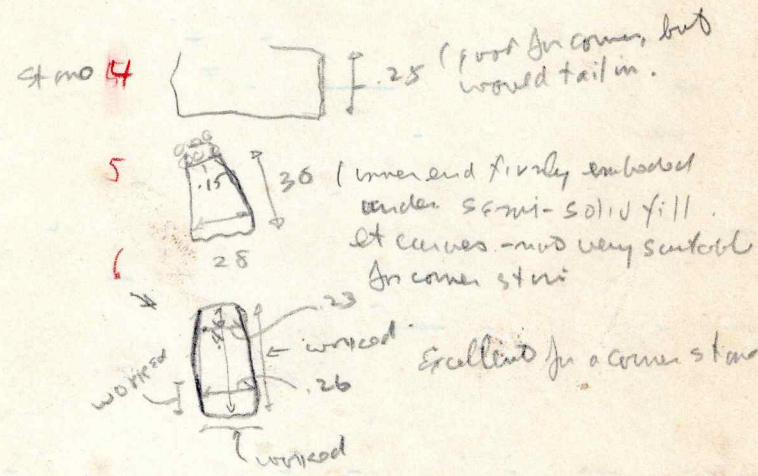

Figuring .02 to joint.

good wall	.70
stone 1/2	.02
"	.24
"	.02
"	.42
"	.02
"	.24
"	.02
"	.50
"	.02
"	.28
	<u>2.48</u> minimum
"	.02
"	.26
	<u>2.76</u> very probable.

24 - The line (base course) bends out very little, drops about .40 beginning with stone 1.

Joint of temple.

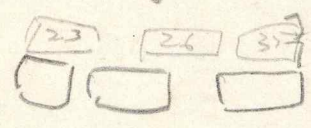

the sides may be wrong - wrote them in a box in rain (5 mis Best thickness ago)

23
2
26
2
35
<u>88</u>

R-10

1937

L25R

Query Sheet

37-8

[Faint, mostly illegible handwritten notes in red ink, possibly bleed-through from the reverse side of the page. Some words like 'Query Sheet' and '37-8' are visible.]

R-10

Pig

Pig out
completely?

Top Tenace Wall

- is it surely vertical?
" " vent beyond stairway

MEASURE.

- See Rod chocks.

Sub. stairway wall vs. do lower ones? (Mmo lets on right.)

locate possible outset on 3rd Tenace good enough - see rod elevation

Secondary Basal Platform.

- follow to ~~right~~ corner (?)
or left " (??) OK

Locate.

Locate

TAP

Basal ledge follow, left side. (Photo first)

Locate

Look for outset on second tenace.

Measure.

Locate
Mmo of subsidiary platform?

Look for R-10-2nd (nothing certain at top).
Plaza floor runs under org pyramid.

Locate (at ext. of rod) TAP

Measure line of stones - see news cut

Look for raising of plaza floor:
a- runs under sec. tenace? shows
& raised again with latter?

Draw sections (top tenace detail with brick) see news cut
Clock point (8) (plan)

Study all masonry
Ties.

OK Locate for 15

X Wdg line
out a little of wall of Pt. 20

Unen with R-9 plod. TAP

OK Locate TAP

See if final tenace is:
to sides of center.

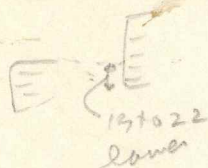

See other sheet

Center debris section
OK drawing loc. A,
first sheet.

Top Bldg

look for right side wall - should be about 1.00 to 1.20 thick - nothing left
- start of front.
- look for side outset of front curved

Does this show no sign of rear outset?
- Indentation no
- corner pilasters
- side foundation mass?

any hint of rear facade steps? (see below) no

Locals

any new points.
Measured draw
cross section -
Bldg, Bldg Plot +
dam near of Pyr.

Plinth Terrace

what does left line indicate?
- side outset?
- clean for section at end

Locate how on?
Too fallen to
yield any date.

Pyramid

- ✓ Trench in ad - 2.30 center rear to clean fill or 4th terrace wall. (M. at top of h. 5.50 rear of inside front wall of temple.) - Draw section.
 - ✓ Answer Sela's last questions.
 - ✓ Clean up at end of stuy - draw. - plan + section - periods.
- Draw Trench + Pit.

check drawing

✓ check Sela's terrace. E E plan?

~~clean + measure line of stones on 2nd terrace, in outset~~

check point 8.

Study all masonry.

- check all banding.

Draw sections

measure Sela's
"Cal. altar"

Stela. Question

Stela Question

37-10

Both ends are rounded.

The outside end is eroded, like top & sides.

The inside (toward pyramid) is very well preserved, showing tooling.

- if a butt could be rounded, must have been worked, though for no structural purpose.

∴ whatever the purpose, might call for good stone cutting.

The good preservation of butt end might be due to burial by wash from above.

- Moler has raised one side of stela only, about cm ✓
 - It has been down lower late 19th tenues to cm ✓ resting on it, + overlapping it about 30 cm.
 - The lower side is cm above lowest plaza floor on its low side.
- It is ✓ thick: Top is or is not as well (or better) preserved as bottom (or vice versa. ?) - I.P. ad built.

The upper level of stela tenues was about 1.30 wide, tending to stop wash there; there was very little (see d.b.s section). The raised position of the NEOR end would permit washing around it, which, with small roots, should have caused maximum erosion at this end.

Moler considered the stone fell backward; mentions only the face "buried in the earth" + says nothing of excavations.

- ∴ Near end was not buried deeply if at all;
- ∴ + was subject to max. erosion.

(The raised position of near end is what would lead him to suppose it stood in plaza, falling back on the tenues; plus, probably, the unincised & ∴ more obviously rounded end being there.

(Back side of stela) the wall of second lot "step" goes down .22 below top of the front one. Although we did not find this behind stela. Is it true farther on? If so, stela might date from raising of lowest step; but not before the tenues. This locality may be local - was not noticed behind stela. The second step of org. stuy does same thing ?

No evidence of stela end found: its survival had (on lowest step) would be unexpected.

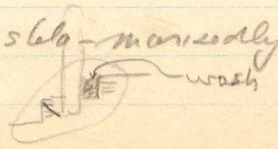
↘ The second step was best preserved behind stela - markedly so. ∴ perhaps supported long while by stela? 

Search

over

center line of stela

The stela lies slightly to left of center line, at near end, near at far end.
∴ far end was butt?

Locate accurately on plan

The "column altar" is now near far end

∴ far end was butt?

- But altar is well off center + has been moved by some agency,
or else was not placed before stela + ∴ need not be in front
of it.

If placed some distance to front, would not be under stela
falling from terrace; but might be in Mole's way when he
looked at far end.

∴ May have been placed, little less (or more) than stela
length from platform.

Look for it in place.

Stelae 25 + 26 appear to have fallen from terrace (higher one)

" 25 " " " " " " ; its altar also

See 37-56 (Fwd) - the 2 lower early steps are
intact (1 stone one) behind stela

R-10 From 1936 notes

Scale - 1:100

Rectified

hi = 1.28 above same point.

hi = 1.28 above floor plaster at right front corner of room.

SECTION and ELEVATION A-B.

SECTION C-D.

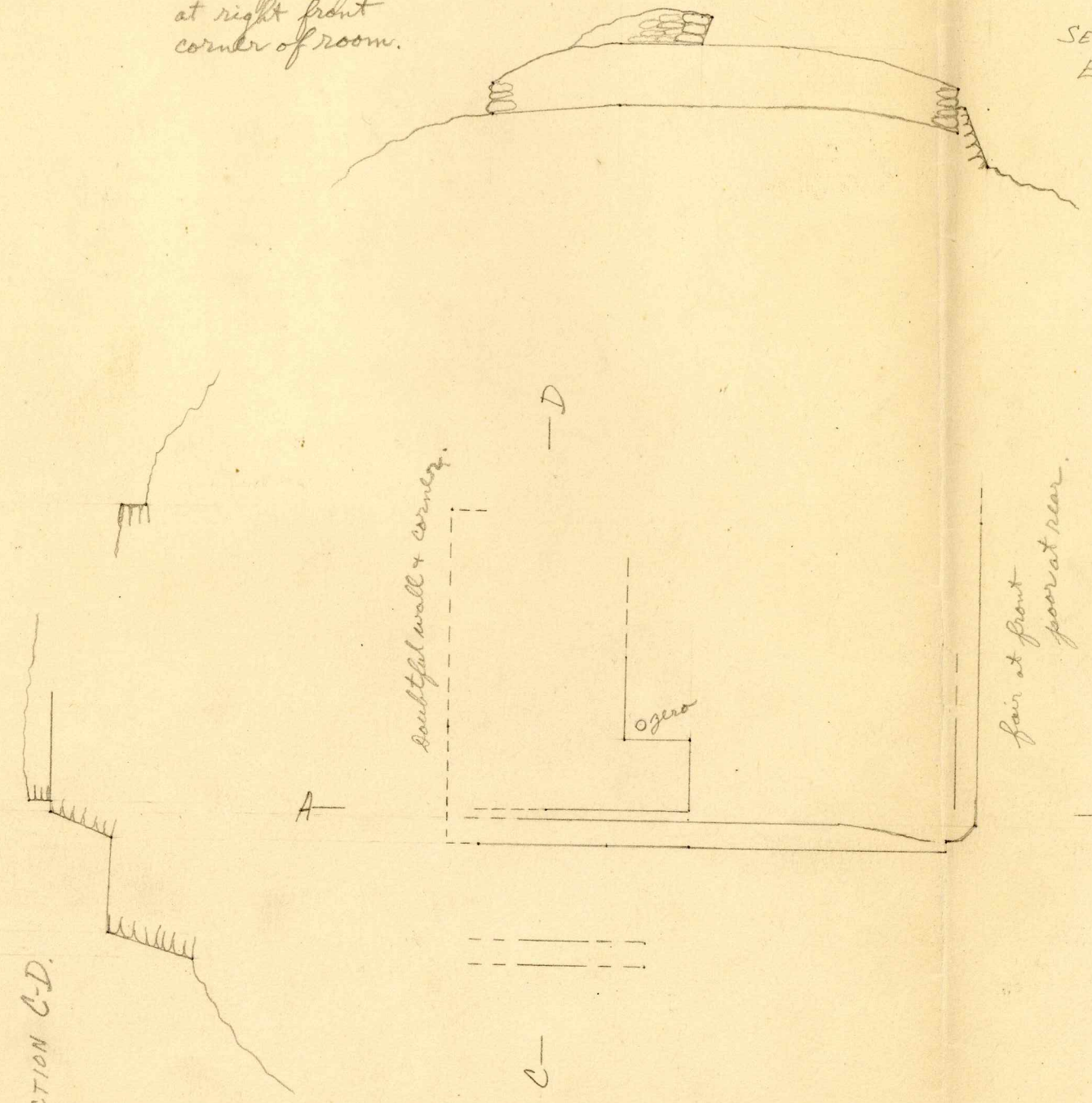

R-10

1936

F.C.C. 31

36-11

Hi. = height above floor plaster = 1.28
at bot. front corner of room.

Last year's
zero point
in doorway = 1.42

- 1. 2.11
- 2. 2.15 - used in both sections
- 3. 2.62
- 4. 2.33
- 5. 2.51
- 6. 3.05

Elevation
C-D

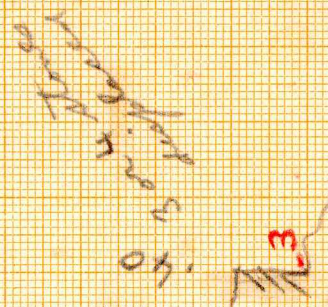
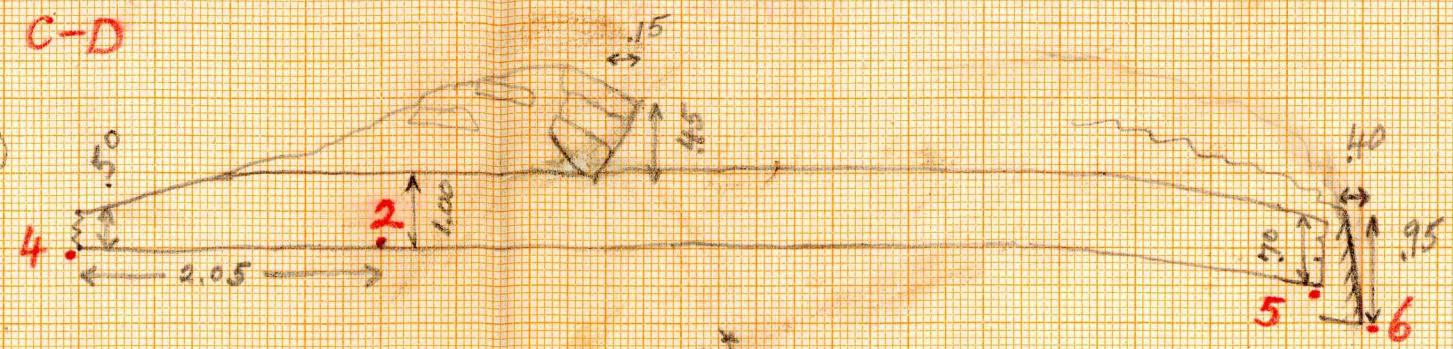

possible corner displaced

-B

possible terrace wall - very poor.

-C

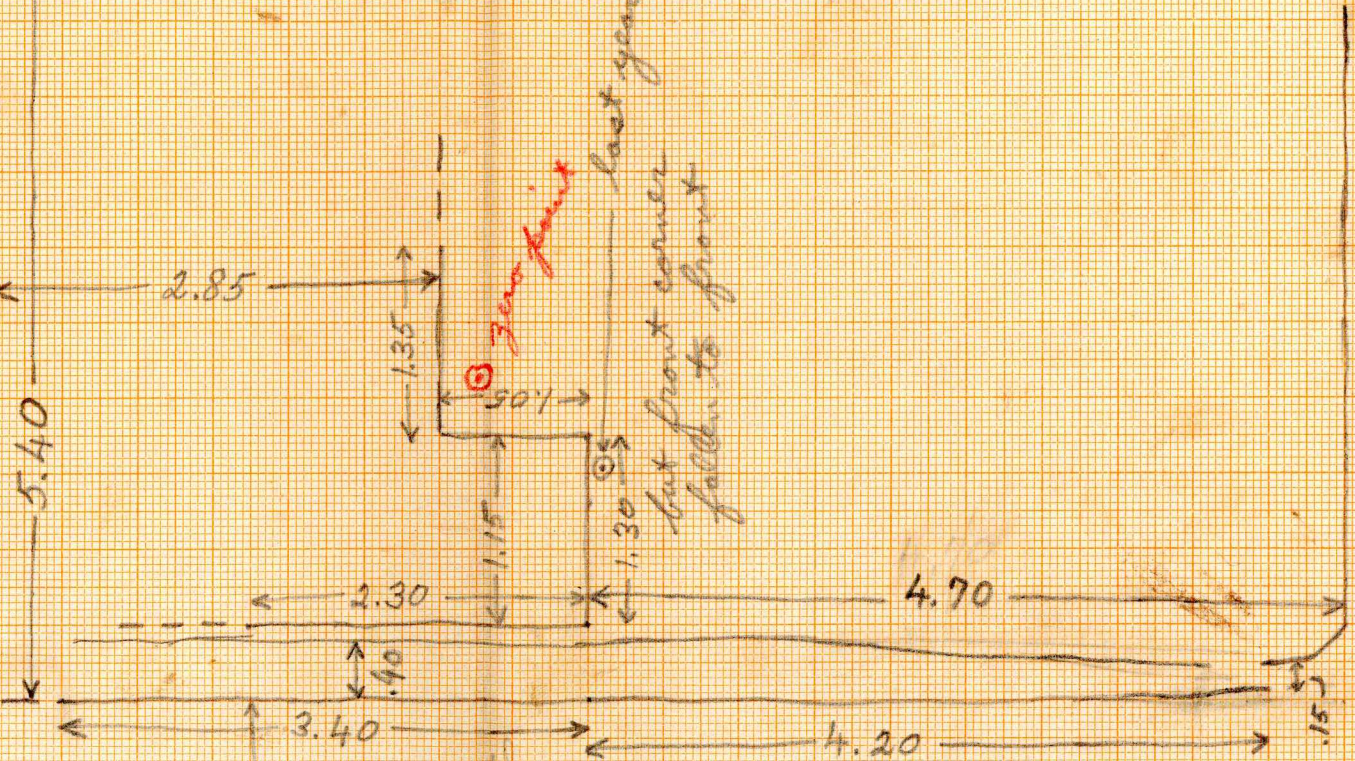

no corner found

nt walls or terraces found at rear of building.

rounded corner in fair position one set of stone set diagonally

on this side plinth wall displaced + at corner is falling down + to side. upper part of wall has probably slid down in front of lower part causing break.

KEUFFEL & ESSER CO., N. Y. NO. 369-141
Millimeters

End In Length
1.05 (width)
1.50 (end doorway)
1.05
3.60

section
A-B

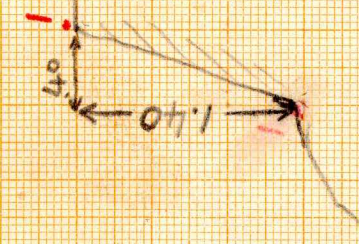

A

1936
CRESSON

at 1st front corner of room
height above floor plates = 1.18

- 1. 2.11
- 2. 2.12
- 3. 2.22
- 4. 2.33
- 5. 2.21
- 6. 3.02

last floor
top floor
in drawing = 1.42

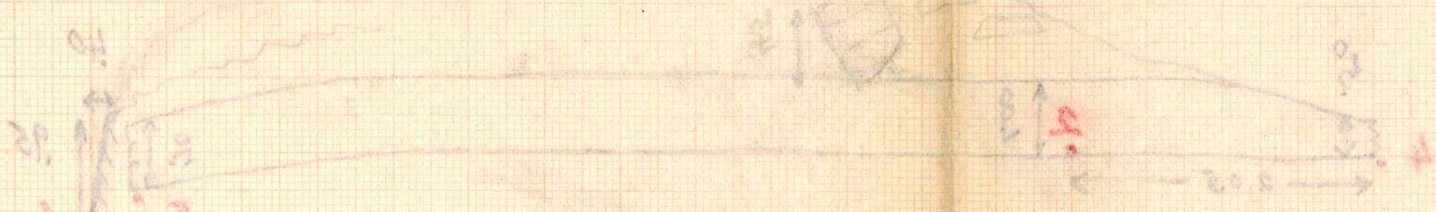

on this side of wall
wall displaced
at corner is
falling down
to the side.
upper part of wall has
fallen over in
front of lower part
causing break.

face of part - top is covered with
hand
smooth in above in
front of part - hand

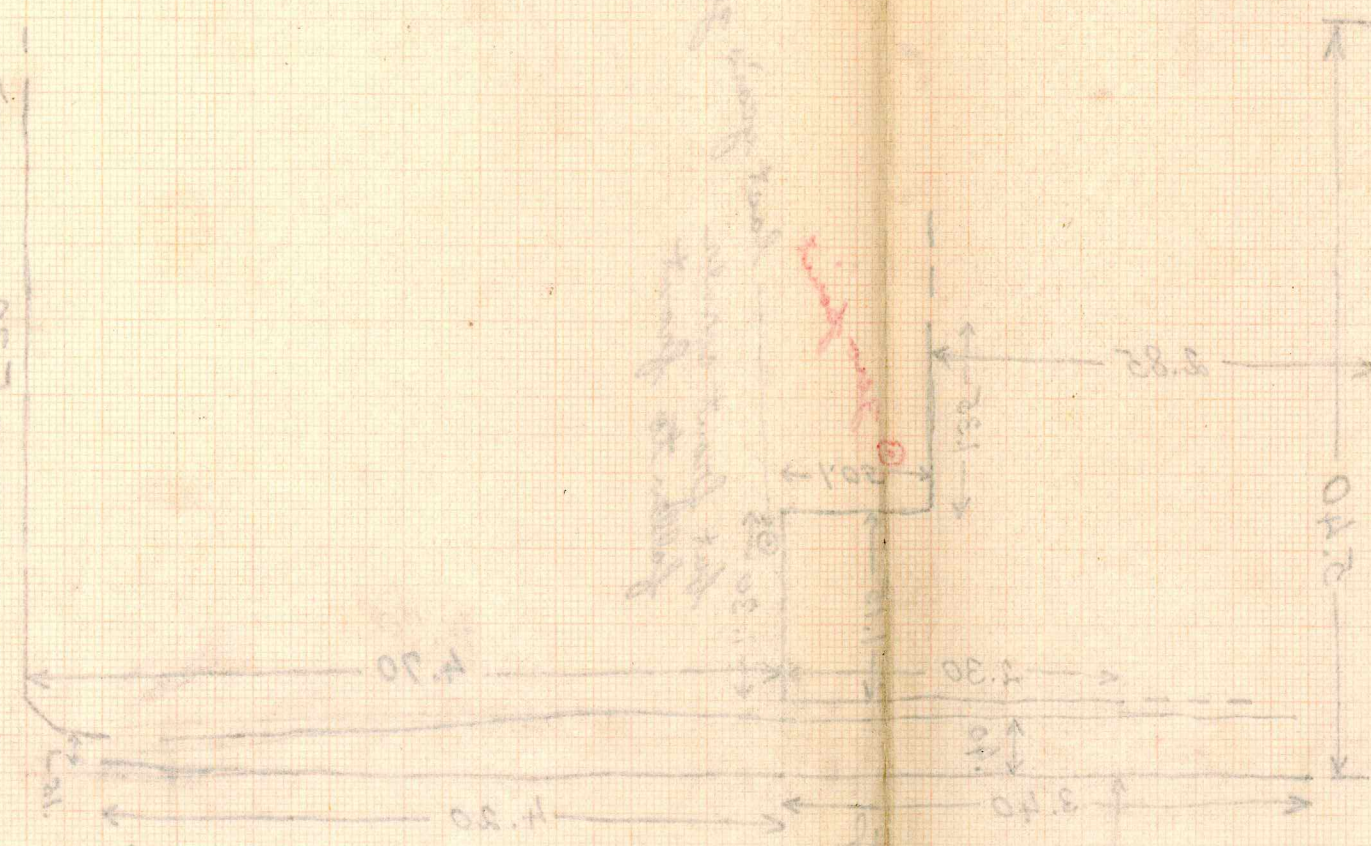

plus some
from
Ct

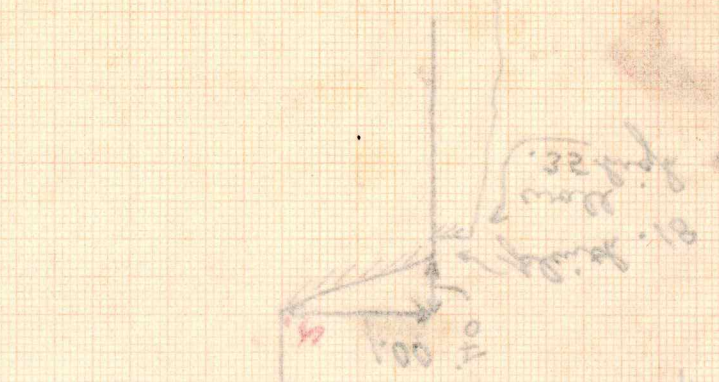

2-1-1

3.00
1.00
1.00
1.00
1.00
1.00

PIEDRAS NEGRAS 5/18 1936 STR. R-10

OP. No. MUSEUM CAT. 1936

SCALE SEE PHOTO Nos. F. C. Jr
36-3

REMARKS

May have layer of gravel above floor - should investigate for possible beam + mortar roof. Gravel may be floor itself.

Gravel is floor itself - good floor surface was found at rt. front corner of room, with plaster, then small stones, then embotido. Gravel in center of room is below this floor surface.

Section is 2.20
left of right center
i.e. above center.

5.97
2.20
4.77
5.97
3.67
1.33

R-10 R-10
1935
5/16/35 F.C. Jr
354
NB- Section
Letters refer to
1933 & 35 plan

① ② ③ ④ ⑤ ⑥ ⑦ ⑧ ⑨

5.97 from front of front wall
A. B

$h_i = .68$ above floor

A
Horizontal

- 1 .00
- 2 .58
- 3 2.32
- 4 3.67
- 5 5.00
- 6 6.25
- 7 7.35
- 8 7.95
- 9 9.25

B

$h_i = .68$ above floor

- 1 1.97
- 2 1.51
- 3 1.06
- 4 .79
- 5 .63
- 6 .37
- 7 .54
- 8 .71
- 9 1.49

$h_i = .35$
A 1.45
B 2.60

rough terrace wall
falling
to refer.

1.45
35
1.10
2.60
35
2.25
37
15

149
65
81

C
Terrace wall
rough terrace cut
in floor
not falling

$h_i = .35$
A .76
B 2.35
A. 5.23 (from
B. 5.92 (from
ground)

1.97
65
1.29 = height
of tower?

D
 $R = 1.06$ above
floor
1 1.87
2 1.39
3 .99
4 .72
5 .51
6 .66
7 1.72

1.06 = h_i

Horizontal
1 .06
2 .55
3 1.17
4 2.95
5 5.85
6 7.60
7 8.80

R-10
5/16/35

R-10 R-10
 1935
 5/16/35 F.C. Jr
 354
 NB- Section
 Letters refer to
 1933 & S plan

Section is 2.20
 left of right angle
 i.e. approx center

5.97
 2.20
 1.33
 4.82

5.97 from front of front wall
 A. 13

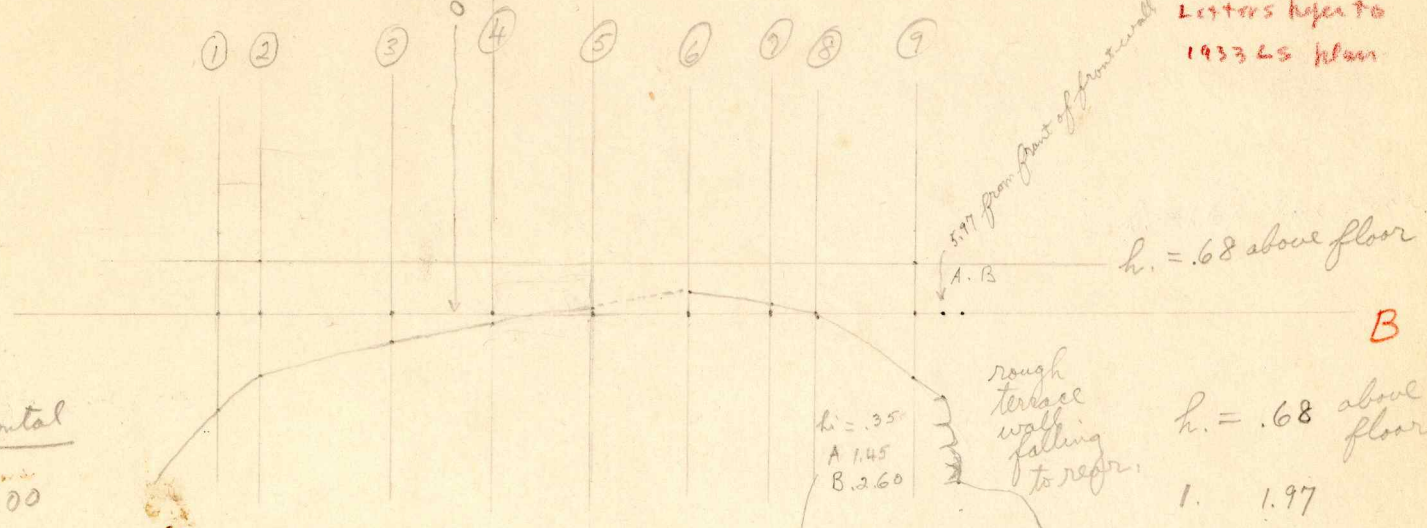

A
 Horizontal

- 1 .00
- 2 .58
- 3 2.32
- 4 3.67
- 5 5.00
- 6 6.25
- 7 7.35
- 8 7.95
- 9 9.25

B
 h. = .68 above floor

- 1 1.97
- 2 1.51
- 3 1.06
- 4 .79
- 5 .63
- 6 .37
- 7 .54
- 8 .71
- 9 1.49

C
 Terrace wall
 rough terrace last
 in section
 not falling

1.45
 .35
 1.10

2.60
 .35
 2.25

5 - .35

1.49
 .65
 .84

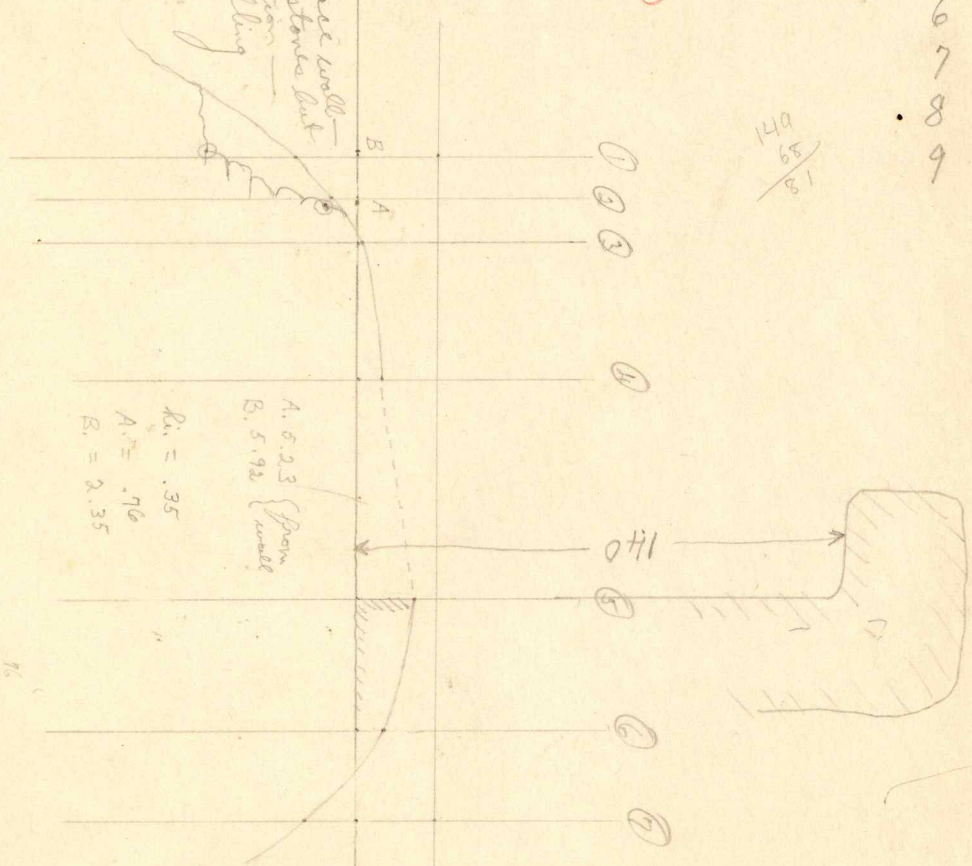

A. 5.23 (from
 B. 5.92 (from
 h_i = .35
 A = .76
 B = 2.35

1.97
 .55
 1.29 check
 of the 6.07

D
 R = 1.06 above
 floor

- 1 1.87
- 2 1.39
- 3 .99
- 4 .72
- 5 .51
- 6 .66
- 7 1.72

R-10
 5/16/35

Horizontal

- 1 .06
- 2 .55
- 3 1.17
- 4 2.95
- 5 5.85
- 6 7.60
- 7 8.80

1.06 = h_i

R-10
1935
F.C. 5r
35-2

① ② ③ ④ ⑤ ⑥ ⑦ ⑧ ⑨

terrace wall terrace house wall house wall

falling to rear

$k = 1.12$

H

$k = 1.12$ above floor

- 1 2.45
- 2 2.21
- 3 1.76
- 4 1.30
- 5 .41
- 6 .14
- 7 .75
- 8 1.72
- 9 2.27

G
Horizontal

- 1 .00
- 2 .75
- 3 1.07
- 4 2.80
- 5 3.68
- 6 5.10
- 7 6.55
- 8 7.95
- 9 8.90

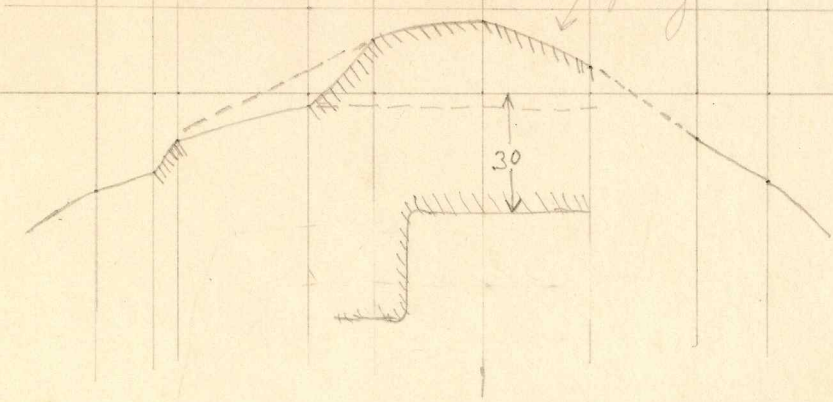

E

① ② ③ ④ ⑤ ⑥ ⑦ ⑧ ⑨ ⑩

hi. is bottom of wall on right side of front doorway

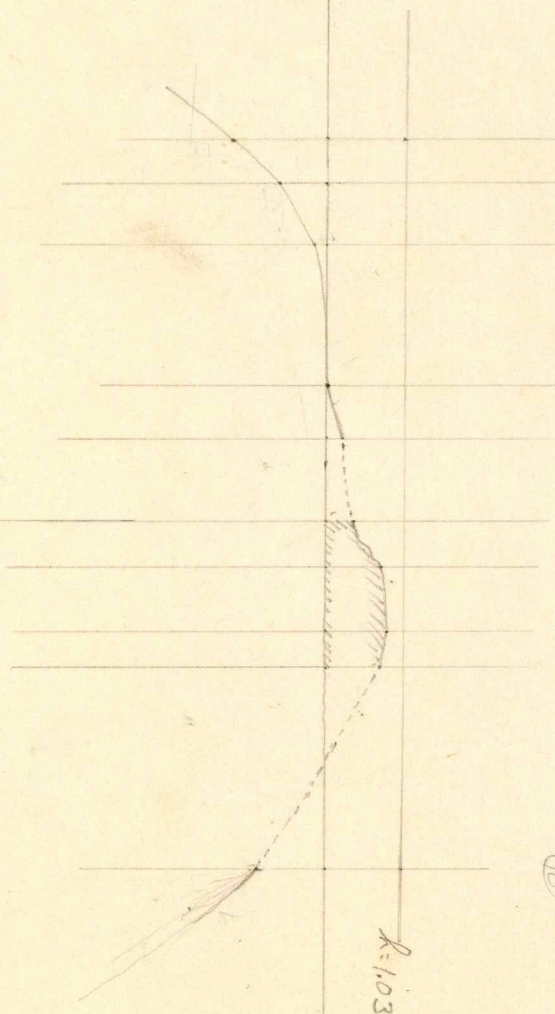
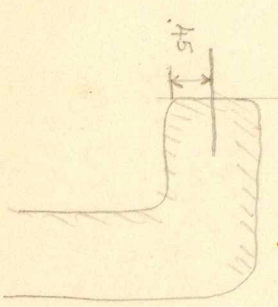

$k = 1.03$

- $k = 1.03$
- 1 2.27
 - 2 1.65
 - 3 1.21
 - 4 1.00
 - 5 .82
 - 6 .66
 - 7 .28
 - 8 .20
 - 9 .32
 - 10 1.91

- 1 .00
- 2 .60
- 3 1.40
- 4 3.25
- 5 3.95
- 6 5.05
- 7 5.67
- 8 6.50
- 9 7.00
- 10 9.65

Horizontal

R-10
5/16/35

F

R-10 - Section

R-10

1933

LSJF

330 4

660 800

130 1.00

33-2

.02 = 1.00

SEE photo (wood block)

Section A-B
(elevation of
inside of
end wall)

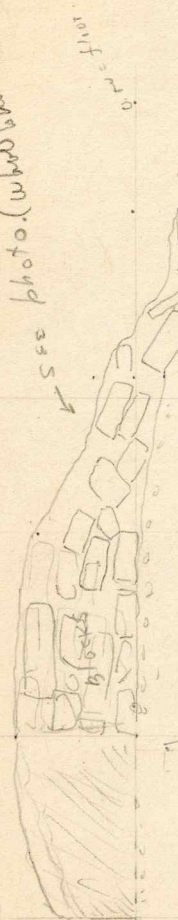

horizontal
position
around filler
blocks as
indicated here.

may be terrace
stone in position
next to end
stone

Red = Sections of
other parts,
same direction.

Section C-D

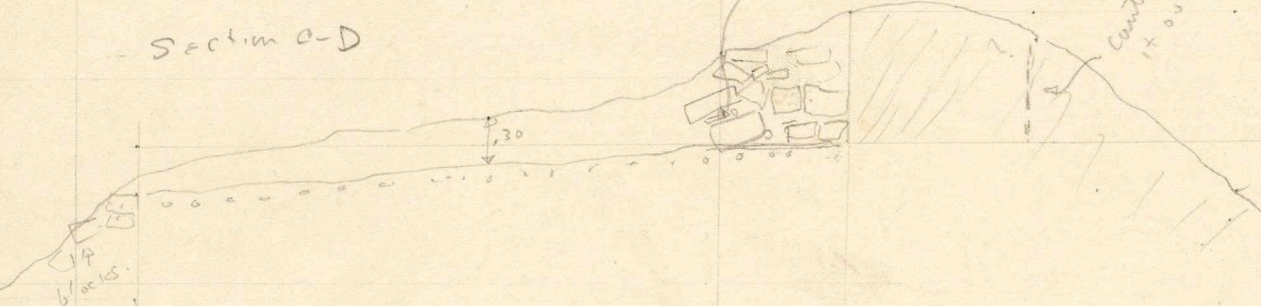

could make
it out.

000 = floor

470 (1.00)
940
330
660
130

1.20 = 20

2.50 = 1.20

470 30
940 80

R-10
Trial -
reducing no of
cut sets for
top 7 rows

