

Tables of Contents of Piedras Negras Note Books  
of Satterthwaite, as of August, 1933.

No. 1

Str. J-2 -Op. W-2  
Str. J-3 -Op. W-4  
Str. J-4 -Op. W-16  
Str. J-5 -Op. W-17

No. 2

Str. J-6 -W-12  
Str. J-7 -Op. W-12  
Str. J-8  
Str. J-9  
Str. J-11  
Str. J-12 -Op. W-8  
Str. J-13  
Str. J-17  
Str. J-18 -Op. W-13  
Str. J-20  
Str. J-21 -Op. W-14  
Str. J-22  
Str. J-23 -Op. W-6\*

Str. K-5 -Op. W-5\*  
Str. K-6 -Op. W-7

Str. O-4 -Op. S-9  
Str. O-14  
Str. O-18

Op. W-1 (plaza trench)  
Op. S-15 (Burial #10)  
Op. N-1

No. 3

Str. R-1 -Op. S-17  
Str. R-3 -Op. S-2  
Str. R-4 -Op. S-5  
Str. R-5 -Op. S-16  
Str. R-7  
Str. R-9  
Str. R-10  
Str. RR-11 -Op. S-1  
Str. R-16 -Op. S-18

Str. S-2 -Op. SE-9  
Str. S-4

Str. U-3

Str. V-1 -Op. SE-1

No. C-1

Map  
Comparative Lists &c.  
Programs & Recommendations  
Photograph Catalogues  
South Gr'p -Miscel. Data  
West Gr'p - " "  
Recognizance data, P.N. & elsewhere  
Morley Readings.  
Numerologies  
Specific data readings  
Miscel. data re monuments, lint ls, &c.  
Do. re other worked stones.  
Do. re Jades.  
Archeological areas  
Maya Burials - notes on  
Calendar - notes on  
Pottery classifications  
Pottery notes at P.N. - specific  
Identifications of objects.

Tables of Contents of Piedras Negras Note Books  
of Satterthwaite, as of August, 1933.

No. 1

Str. J-2 -Op. W-2  
Str. J-3 -Op. W-4  
Str. J-4 -Op. W-16  
Str. J-5 -Op. W-17

No. 2

Str. J-6 -W-12  
Str. J-7 -Op. W-12  
Str. J-8  
Str. J-9  
Str. J-11  
Str. J-12 -Op. W-8  
Str. J-13  
Str. J-17  
Str. J-18 -Op. W-13  
Str. J-20  
Str. J-21 -Op. W-14  
Str. J-22  
Str. J-23 -Op. W-6\*  
Str. J-24

Str. K-5 -Op. W-5\*  
Str. K-6 -Op. W-7

No. 3

Str. O-4 -Op. S-9  
Str. O-14  
Str. O-18

Op. W-1 (plaza trench)  
Op. S-15 (Burial #10)

~~No. 4~~

Str. R-1 -Op. S-17  
Str. R-3 -Op. S-2  
Str. R-4 -Op. S-5  
Str. R-5 -Op. S-16  
Str. R-7  
Str. R-9  
Str. R-10  
Str. RR-11 -Op. S-1  
Str. R-16 -Op. S-18

Str. S-2 -Op. SE-9  
Str. S-4

Str. U-3

Str. V-1 -Op. SE-1

No. G-1

Map  
Comparative Lists &c.  
Programs & Recommendations  
Photograph Catalogues  
South Gr'p - Misc. Data  
West Gr'p - " "  
Recognizance data, P.N. & elsewhere  
Morley Readings  
Numerologies  
Specific data readings  
Misc. data re monuments, lintels, &c.  
Do. re other worked stones.  
Do. re Jades.  
Archeological areas  
Maya Burials - notes on  
Calendar - notes on  
Pottery classifications  
Pottery notes at P.N. - specific  
Identifications of objects.

Contents of Note Book No.1 (Aug. 1933)

Str. J-2        -Op.W-2  
Str. J-3        -Op.W-4  
Str. J-4        -Op.W-16  
Str. J-5        -Op.W-17

No.2 cotains J-6 to O-18 plus Op. W11 (Plaza trench) and  
Op. S-15 (Burial #5)

No.3 contains R-1 to V-1

No. G-1 contains map, lists, Misc1. data - see contents.

No. G-2 contains Misc1 data, work sheets, &c. & 1931 and  
1932 general notes (apart from drawings).

1931 General Notes.

pp 1s to 3s (rewritten from small book)  
1L to 15L (loose leaf/ book)  
1 to 57 (duplicating note book.)

Supp 5 for these  
Early Str Nos.

Contents of Notes L.S.JR. : P.N., 1931

Plaza Trench - Op. W-1-0 Pp. 1L to 8L inc.: Sketch Map #1, placed with them.

Structure 1, <sup>(Str. I-2)</sup> Str. 2, Court 1 <sup>(5-6)</sup> - 9L to 16L; 2-4; 32, 53

Room A &c. 9L -.11L  
D 11L; 13L  
C 12L &c.

Structure 3, 4, 5, 6; --- 4-6; 8, 33-35; 39

Central Temple: <sup>J-23?</sup> - --- 30-31; 36. 44

Acropolis, North side --- 6, 35 <sup>(b35 under Str I-24)</sup>

Stela 9 Pyra. <sup>(Str I-3)</sup> ---- 35-48; 52; (blades-54-57)

Ball Court ---- 42; 48; 52

SE Groups ---- 6-12; 14-17; 18 (Bur.#2) - 27; 27(Bur.#3) - 30; 32; 51, 52

Lintels, in gen'l ---- 49

Recognizance ----- 4; 6; 7; 13; 14; 15; / <sup>1s-2s;</sup> ; ~~18-28; 215s; 216s; 217-218s;~~

Miscle. diging &c. <sup>20s;</sup> 4s; 5s

Contents of Drawings.

Structure 43 <sup>(Stela 9 Pyramid)</sup> <sup>(Str I-3)</sup> --- --- --- --- 1 - 26\*

Central Temple <sup>(Acropolis)</sup> <sup>J-23?</sup> --- --- --- --- -27 - 36 <sup>33</sup>

Structure 1 --- --- --- --- --- 37 - 42

Acropolis in general --- --- --- --- --- 43 - 50; 34-36

Ball Court, S. Group --- --- --- --- --- 51 - 59\*\*

S.E. Section (S.E.-1 only) --- --- --- --- --- 60 - 83

Vault section --- --- --- --- --- - 84

Lintels (see 24 - 26 for Lintel 5) --- --- --- --- 85 - 90

Recognizance maps --- --- --- --- --- 91 - 97

V. Group Plaza trench - see notes, 1L - 8L.

~~Sketch Map Sheets~~

\* Large grey note book.  
\*\* Old thinner black note book.

Feb. 24 - cont'd. :

Knife work in well east of camp (near garden):

-perfectly plain floor or other level, top @ 1.30 below flat surface of "plaza", ~~xxxx~~, about .05 thick, consisting of small broken pieces of limestone, pot sherds, occasional charcoal (very scarce & fine bits only), and considerable number of small pieces of red poorly baked clay, usually more or less formless & very soft: one cylindrical piece; a couple with impression of stick.

-above this level isolated sherds taken from side walls.

-sherds from "floor"- imbedded in it or smack on it & properly part of it, included painted ware (black, red, yellow); some smoked ware, both heavy & thin

Feb. 23 (note book lost): Dug small test pit (with J.A.M.), about .40 deep, down slope from between Structure XXVIII & Stela 40:

-sherds recovered in variety & numbers, with large chunks of limestone, as if from structures

-Noted several low mounds S.W. of XXVIII in area left blank by Ricketson, on more or less flat area about 4.00 below Plaza (W.Group) above.

-Figure will have to dump at either end of XXVIII.

-Failed to find suitable dump on lower level for E. Group.

N.B. Notes on sherds from well in Camp plaza, small note book, pp. 6 - 14. Mason studied these independently.

Mar. 1 : Men cleared on acropolis - completed low court and Nly court with buildings & top pyramid.

-found several good rooms for sections - when clearing done should be noted on plan.

-explored river side of acropolis & plaza side note cleared, from top to about 3/4 way down - many small vertical breaks with level spaces in front - quarries? - go down W. pyramid or W from wly court on Acropolis.

-no passage around west side of acropolis unless very low down.

-nearly all structures on acrop. are double lines of rooms.

-level rigged up.

-in W. court, acrop., visible a section of circular stone, perhaps natural, near center of court floor - investigate.

Mar. 2: South Group:

<sup>XXIV</sup>

XII (?) - cylindrical stone as from ~~xxx~~ column in path - more on top, in line - columns? Pyramid on right, 4.00 high, more or less, N. of XI.

Deep ravine runs back of VII & IX

VIII has temple mound on top, probably - much plainer than W. Group

Ravine should be ~~cleared~~ investigated - swell prospect when cleared

IX Probably Do. rear of both drop to ravine behind.

III Spolied small lintel on front side?

- flat stones on front side & top
- apparently a few in position on top; squared stones -
- almost certainly a temple.

IV Squared stones on side, mound on top

- two large oblong stones on E. face (1 the stela?) - no stela on top.
- temple
- stairway at front.

V -Structure doubtful - lots of stone fairly regular top, but large ~~trees~~ distort.

VI -Without question a temple on top, probably stairway on front.

XVIII - largest in group, probably

- undoubted temple on top, small trees only.
- stones in semi-position.

XXI - 3 cylindrical column stones together on top, one at side, 2 other doubtful ones on top.

Rah trail from steps of W. group plaza N. 80 E. about 1/2 way to east group (mound) & drop behind. Continuing same course as well as possible struck east group a little W. of stelae - this is about the course on Ricketson's map. For connecting 2 groups this trail will be O.K. - clearing below will make point on mound visible ~~and~~ I think; only other way is traverse of several courses. The old path is the best way to walk, but should cut left sooner.

-men cleared W. court and thence down, nearly finishing between pyramids. Raining from 11 A.M. Can't find note books. Cold.

- Mar. 3: 5 men cleared in plaza, E. Group, a bit also on pyramidal face.
- explored region toward building
  - platforms against hill, to W. of it & probably on to main structure.
  - explored temple - central room complete, apparently half filled with debris and no apparent source.
  - top of door visible at S.
  - above, remains of hollow superstructure vaulted.
  - should excavate to S. of this structure & enter through door.

In A.M. made rough survey notes for lower central court of W. group.

- ascended around N.E. corner of Nly pyramid, W. group - extends slightly beyond terrace.
- descended N. of this ~~Pyramid, from court,~~ Pyramid, from court, - found a small plaza some distance down with mound, toward trail in from road.

- Mar. 4: Men on structure, slow, clearing.
- explored summit behind and on both sides main structure - natural outcrops on both sides and very good sources for stone at and below summit.
  - possible to deliver all stone on down grade.
  - located XXV
  - ran base-line for locating stelae; worked with men. told Cole to jack his men up
  - started catalogue, Misc. group.
  - specimens from river.

- Mar. 5 A.M., 2 hours clearing E. group then started trench in W. group plaza. For notes on W. group see L.S. note book.
- M.C.S. on sherds, catalogue; L.S. Do. in evening.

- Mar. ? Left Pyramid main W. Group - cut stone on slope leads to remains of wall near top - and see back side also - this form, probably:



- Mar. 9 Sherds at surface of ravine to and from camp- rodent mounds.

- Mar. 10 4 or 5 foot hole (animal) in top of W. Plaza top acropolis (Court 111) shows nothing but loose stone to visible limit.

- April 11 - list of equipment, P. 23

Mar 5 25  
W. Group - Plaza Trench. Sketch Map #1

12

1 Sq = 1 meter

↑ North for references  
in notes only

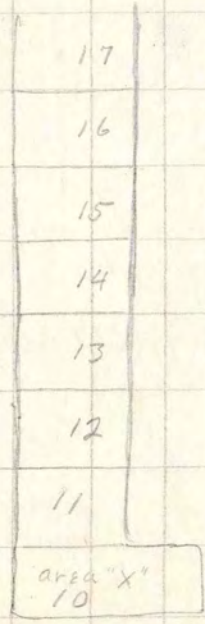

Mar 6

Levels - w. Group. - Top of first floor at nearest corner of lowest (4th from top) step, - see marks (+) on the steps - equals 100.00 M.

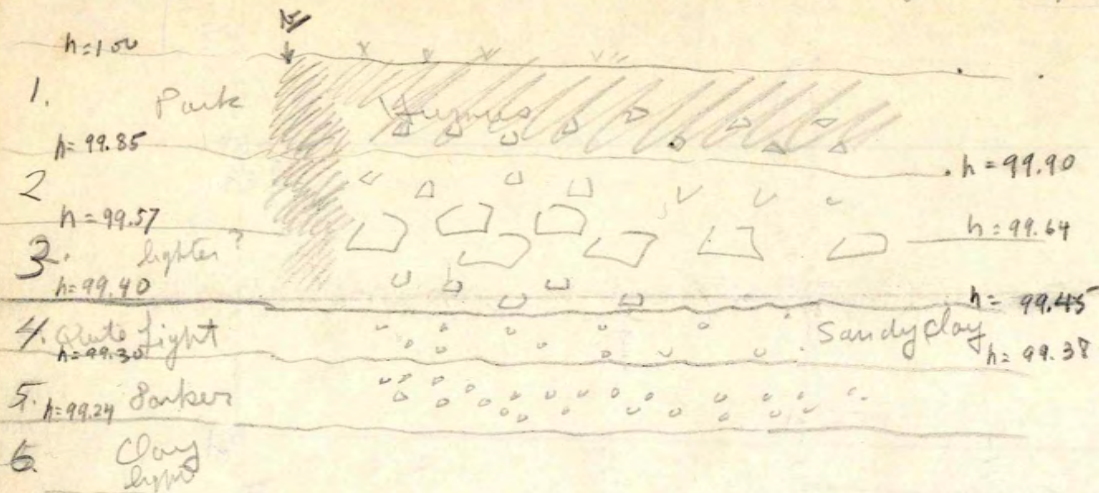

SHAW-WALKER ARCHITECTS  
 1015 1/2 AVENUE  
 WASHINGTON, D.C.  
 ARCHITECTS

h=45

85	1.05	1215	85
95	45	46	45
43	60	76.0	36
			81



Mens - W. Group

Startad kändis Plaza:

Time 0.28  
13.15

stap

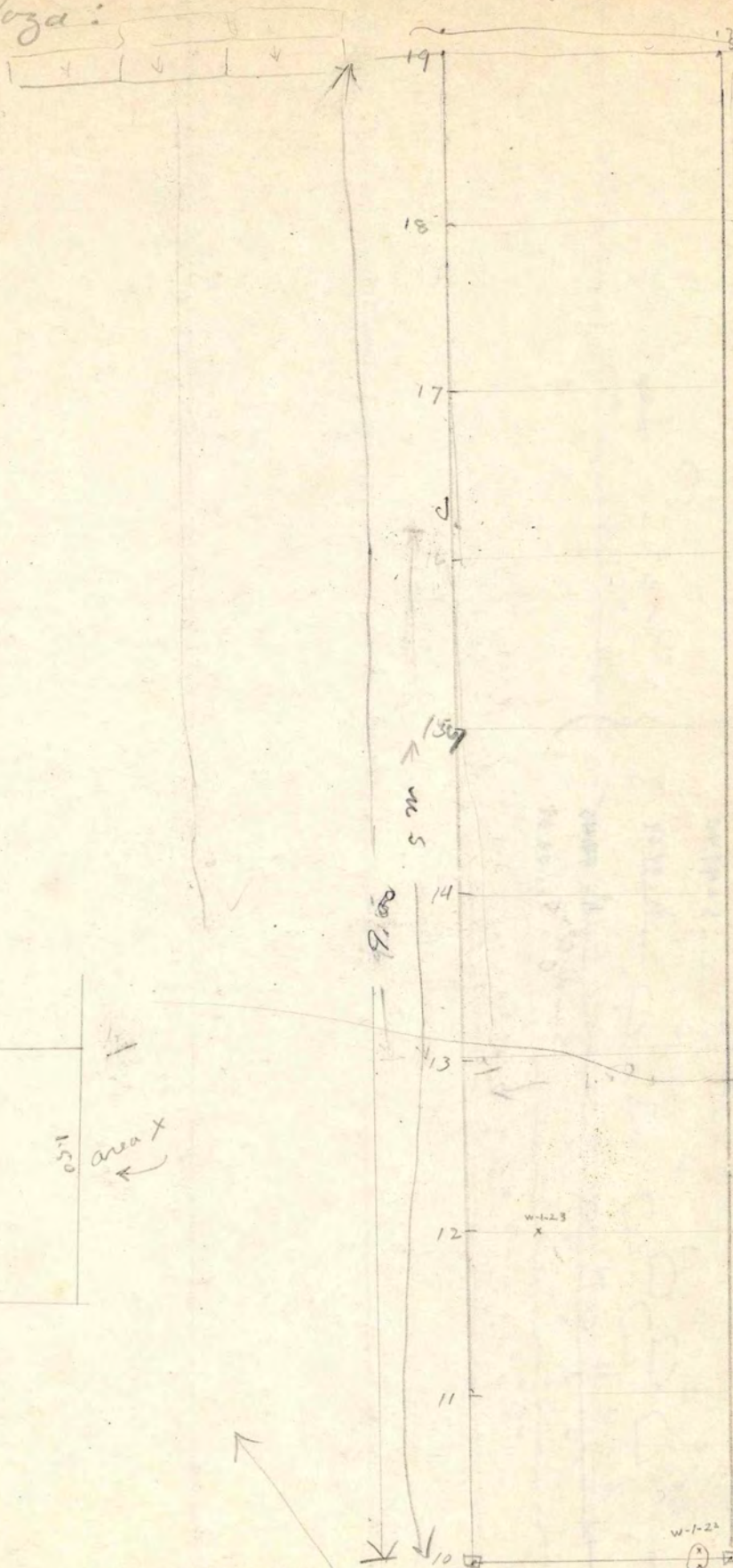

altan

LINTON SATTERTHWAITE  
 COUNSELLOR-AT-LAW  
 1012-15 AMERICAN MECHANIC BLDG.  
 137 EAST STATE STREET  
 TRENTON, N. J.

w-1-22  
 stone,  
 $h = 101.32$   
 $- 1.32$



near  
w. group

Large pieces of shells, bones, figurines, a little charcoal.

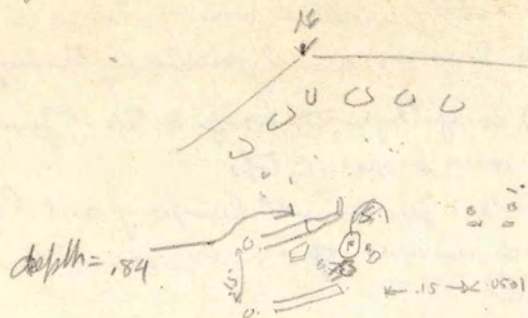

Large stones at top (15' floor)  
- but contains close mixture of  
limonite all the way.

No evidence of intrusion of an  
animal - the bones are tilted up  
this way - some shreds (15' + area)  
shreds, stones, figurines covered  
about the bones.

# W-1-2<sup>2</sup> - Level 6, her hole extends lower (3/8/31)

Bones  
charcoal  
figs  
shards

1. - a small fragment of long bone, up split off - charcoal next it (points)  
a rib runs from this direction in behind position of (15' tax + figurines)

Both upper & lower pots are yellow past, heavy, but a bit different  
a fragmentary long bone lies between them, with small stones - could have  
been an original inclusion  
- also a vertebrae a little to the right - the rib lay along it this

Mar 6. to left Painted black-on-orange immediately  
below.

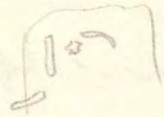

The shard above is a large rim piece  
Another vertebrae inside in the lower shard, to left.

- Another piece of bone 2 or 3 M. up the trench.

Mar 7 Stopped digging trench because of bats, bones &c below 4th level.

Men making track (started yesterday) in terrace slope.

- from terrace, figurines, headless, sherds, but few.

Men also moving dirt, clearing around base of steps &c.

" " clearing bush on terrace - and ascending through stair way?

I cleared area x (2sq ft.) carefully with knife to top of first floor:

- No sherds in humus probe at top

- About 30 sherds, a few small lumps of red clay among the small stones - in an area of 2.50 x 1.5. 00 no large sherd, mostly very small.

- all sherds heavy, coarse ware, opp. undecorated.

- The above sherds were probably refuse in the first floor rather than on it - occurred among the stones:

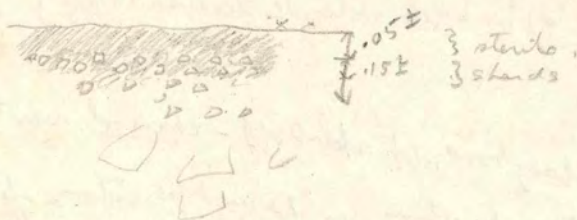

MCS & l - cleared an irregular patch of Level 4 (Sand) in

12<sup>th</sup> x 13<sup>th</sup> m squares, about 2 sq. m.

The sand lies directly on large stones

5 sherds and 3 or 4 small pieces red clay, one burned, nothing else.

The sand is presumably a covering for floor on the rocks - absence of much small stone.

Found on E side, a deposit of the red stuff (remaining in the section) colored the ~~upper~~ upper chamber level (3) different from its other parts in section.

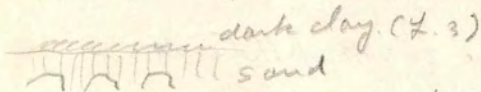

limestone rocks (pretty big)

Enclosure  
Heaps

Levels - Ploga 7 north - Mar. 8, (Sunday). - See Mar 11

at head of Trench (#10 - see sketch p. 1). This holds for W side to #16, at least down to level 5 - the other side not so clear. I think level 4 continues this far, but a little lower - #3 interpreted in #11, 12 etc. by a thick deposit of "red stuff" (clay of gins? - red hot shreds etc.)

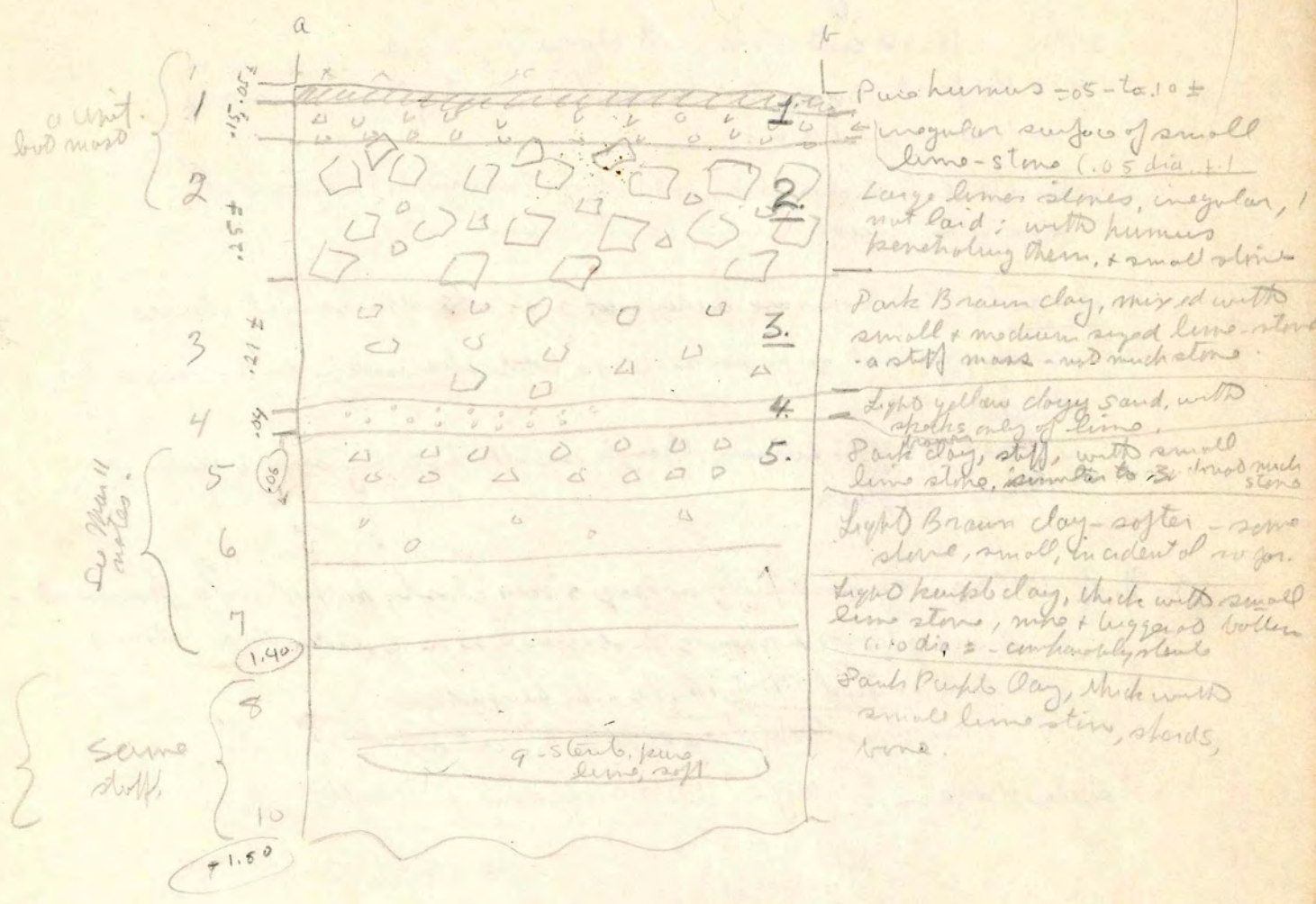

at unit level most

See Mar 11 notes

same stuff

Mar. 15.

05  
15  
25  
21  
---  
66  
04  
---  
70

sherds are rare in level 1.  
in level 4.

I think also in 3 + 5.

In six, everywhere as far, (Square 11, 12, 13) level six ~~got~~ yields about 100 of  
large sherds, and some - am taking down this level carefully  
- rain to-day.

2 Men on terrace cut 3 hrs, rest clearing of rubbish

- To camp at 9:30 + got some action on Saturday - back for same  
purpose now (3.15)

The terrace cut shows old wall back of (? stairway) plainly + it  
may be in second terrace level now.

Level 6 notes - the bones are under + ~~at~~ over sherds - several sherds  
show charcoal on inner side + a little charcoal in dust - no ash, no fire here.

Bones may be human, though small - but they seem to lie as if  
buried in flesh

\* N. of 12<sup>th</sup> Sq. - #4 lies directly on large stones closely packed, as a pavement -  
group of bones + sherds best cleared is in 6 under these stones  
which extend N. to 16., perhaps beyond.

This must be cleared up on the sections.

Rained again to-day - little more done in trench.

Level 6 - group of sheds + Bones, Squares 12 + 13

Level six is not homogeneous - pretty brown clay more or less fine, but runs into a deposit of reddish (yellowish) soil + "gravel" (not water worn, of course). The whole of this group (but not to the south) lay under large stones closely packed and ~~of~~ over level seven - purplish clay + stone, ± stents.

lin 6

The sheds lie in level 6 or directly on level seven, which dips from the west to the east, and toward the S, quite a bit. Charcoal in some quantity, no ash.

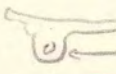
Pots:  complete with 2 disks - directly on 7.

 ← heavy, soft yellow., "Plate".

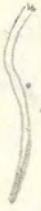
 ← medium wheat, black & white milled, outside stacked

Level 7 - the "kumb" "

oil - in Level 6.

- 1 - Bone - small (long) bone, couple 6, .125 long.
- 3 - P0, .15 long - .07 higher
- 2 - broken (in digging?) long bone, .10 remains;
- 4 - leaf, perfect stony preservation - intact, on men of sheds, .002 (another small one in locardus between them)

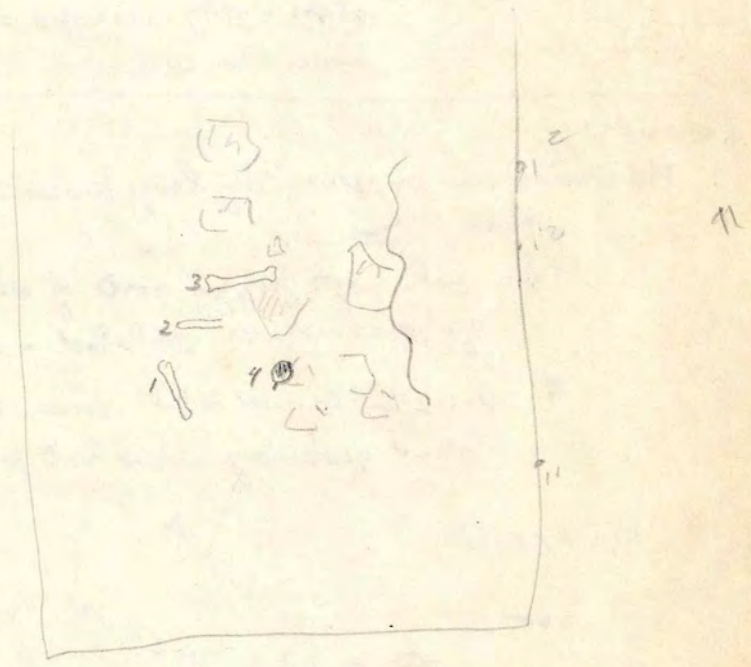

(Monday): Level 5, purplish clay + stone, passes into a layer of flat large stones in Square 12 - which seems to descend to the ~~W~~ + S, Level 7 corresponding; L 6 lies between them - is the stee on the W side, stones being about level 5 + W in 12 - is absent in W in Sq 11 - level continues on E in 11. On the E side is a pretty clear brown clay - in W - yellowish "gravel" the dep of sheds so in continuous through both. In the most part toward S on the bottom (L 7) runs

Notes on fallen stones:

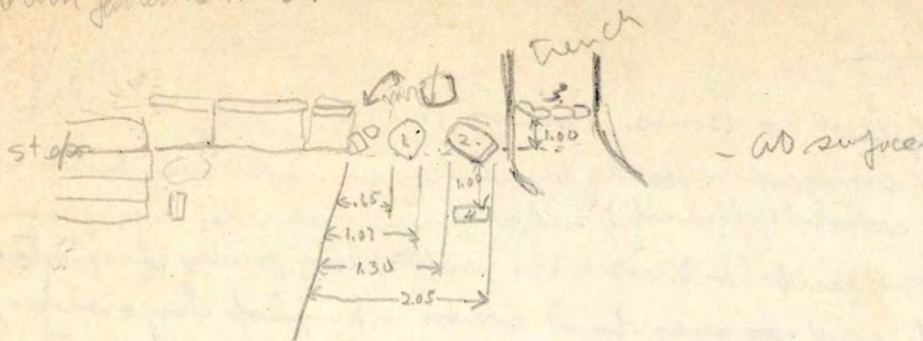

1. irregular tubular 4.4 x .47 x .26 thick - rt. near corner low, 25° ±

2. - tubular roughly oblong -



1.1 thick. top near side low, 25° ± to above level.

Buld .10 to .15 above floor level:

3. - stones in position apparently, little lower than 1 + 2 - resting on floor

Small stones on top: → floor - floor seems to rise toward trench.

4. - Tubular cut obliquely, .28 x .63 included in earth (floor?) on side - 1 with steps - only in surface earth - fallen, & similar to one near the steps.

(over)

The sherds are predominantly large pieces (.10-.15+) - often one above the other

Charcoal - soft fuzzy sort of stuff with association with sherds or bones - never isolated - often right on a sherd.

# W-1-27 - Carved tube was about center of trench, 2 in., - parts found yesterday in box but probably lost - sherds all about

For example:



# W-1-28



# W-1-28

Mar 10.

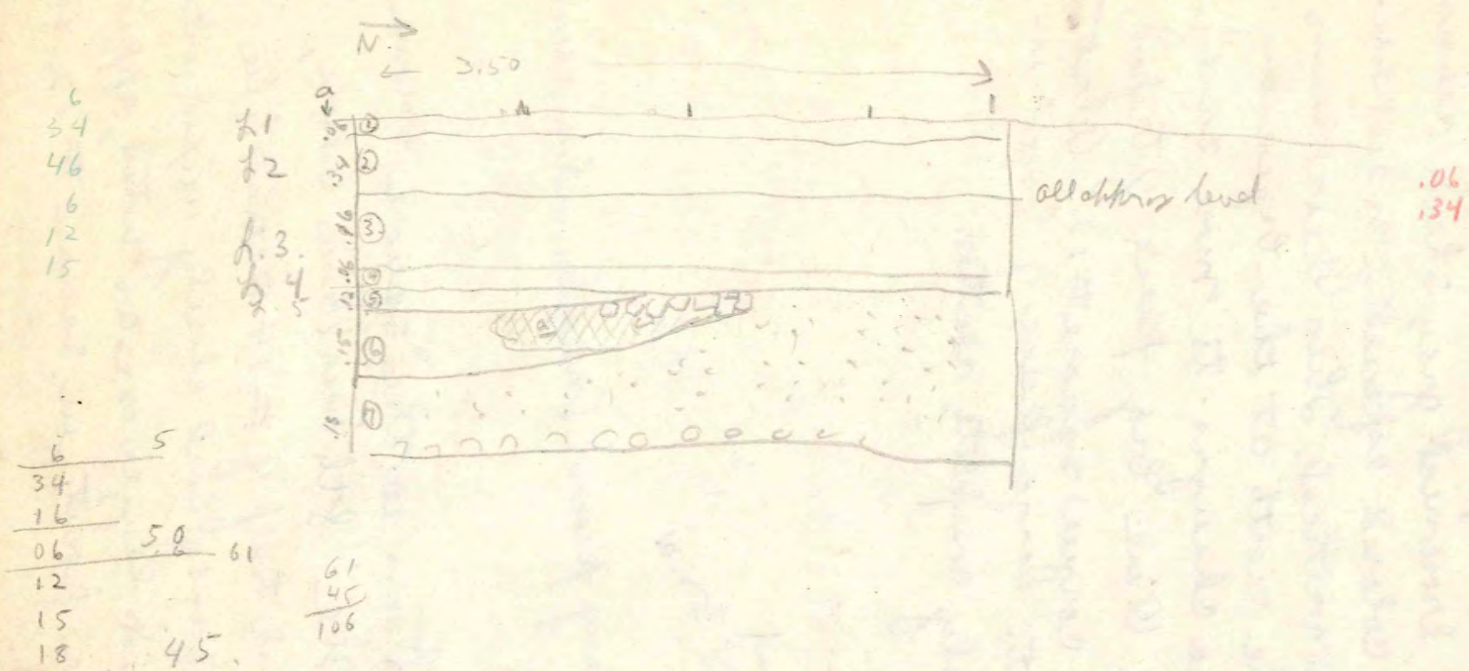

2. yellow "gravel" - which descends E + perhaps S. as does top of 7 + bottom of 6. (the other side of trench looked like this yielded lots of shreds + bones, a red deposit - to me correlated later unit with the brown clay of 6.

NB Levels 5 + 7 directly under 4, @ either end of sample section  
6 is merely a lens as is probably 5.

- Shreds
1. produces shreds, all coarse (?) - collection made from area X, etc.
  2. - " - the same actual level - nearly all on top in 1.
  - 3 - " Scattered shreds only, much broken, no large pieces - some thin ones, some hatched - coll Area X.
  - 4 - " Prod practically sterile - hard to follow an level - small collection from Area X - don't count in its accuracy.
  - 5 - ?
  - 6 - Rich in large shreds, mostly broken, charcoal, bones, canned tubes?, fine ware hatched, hatched & collection from trench below in 11 + 12 squares
  - 7 - Prod practically sterile - collection from Sgs. 12 + 13

LINTON SATTERTHWAITE  
COUNSELLOR-AT-LAW  
1012-15 AMERICAN MECHANIC BLDG.  
137 EAST STATE STREET  
TRENTON, N. J.

Thursday March 12, 1931

Level #8. West of Excavating for samples in Squares #11 and #12. Considerable number of scattered sherds, but not packed together as in Level #6. Little charcoal, this is scattered. No very large sherds. One tiny piece of bone. Occasional large limestone. Considerable variety of sherds, heavy and medium thickness. No fine painted ware, except. One painted sherd, probably tripod. Large stones, closely packed on East side, square #12. Few more painted sherds. A dull brownish gray sherd seems to predominate, with some colored especially on east side. Sherds rest at random, often vertical. This level seems to be of less depth toward the north at the beginning of square #13 where texture changes to more sandy and lighter colored material. One big piece of tripod bowl, orange painted, S.W. corner square #12. Also large stones at this point. Large piece of bowl in S.W. corner, square #12, nearly complete section.

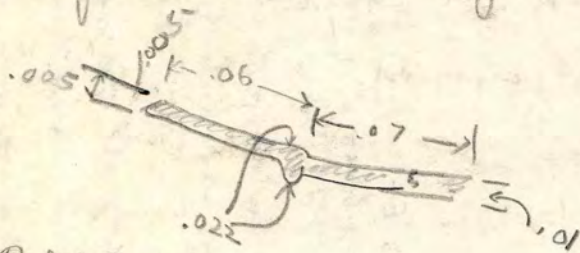

Red paste, soft many pieces (numbers and no paint)  
no leg showing.

Big stones in Square #11, stones in this square become a floor, closely packed. The 8th level as a whole, in square #11, #12, #13 and half of #14 seems to be on a lighter colored more sandy soil closely mixed with small pieces of limestone and larger ones as noted, apparently another floor level. At one point in square #12 fuzzy

Charcoal rected on this floor. There are more and larger stones and more and larger sherds in Square # 11, than in the others. The large stones in Square # 11 are within the purple clay of Level # 8. The bottom of Level # 8 seems to be about level and to rest on closely packed small stones. There are sherds among the large stones in Square # 11.

Level # 7 peters out to nothing on east side of trench. Level # 6 consisting of lighter, softer yellow clay somewhat sandy descending on that side to meet level # 8.

Large stones, closely packed in Squares # 14, # 15, seem to rise higher and be a continuation of a layer of stones which underlay level # 5, Squares # 12, # 13, but to be absent in # 11. This will be clearer when sections are complete.

Square # 11, # 9th Level is soft chalky mass, with very small stones, flints floor, resting on large stones diameters  $2.5 \pm$ ; stones rest on dark brown soil, rather soft and crumbly slightly lighter, in color, than level # 8. One stone  $3.5$  diameter. These levels seem to be level. Some sherds, but few, collection to be made from other square. Stones, not only rest on the darker earth, but are set in it. Level # 9 touching either stones or earth. Sherds in level # 8 often rested directly on level # 9. Level # 9 is very clearly an ancient floor with a fairly even texture of small stones and lime. Under the stones of the 10th Level charcoal, sherds and one piece of poor quality chert appear in the midst of dark earth and other stones. Level # 9, cream colored and can be cut easily with a knife, few stones but not rotten. The top of Level # 9 dips slightly to east in Square # 12. Stones of some size in bottom of level # 8 rest on it, especially on

and see later

east side. The bottom .10 or .15 of level #8, especially in  
Square #12, closely packed with small hard limestone inter-  
mixed with dark purple clay. Very few sherds in this part  
of level #8. Sample section of level #9, Square #12 and  
half of square #13 yield no sherds. In level #10 ...  
about 1.75 below surface, middle of trench beginning  
of Square #11 (right on line) small long <sup>(W-1-31)</sup> thin embossed reddish  
brown earth and lime, large limestone above, sherd  
immediately at one side, sherd very poor quality.  
Bone broken by pick. One end of bone perfectly preserved,  
very soft. Slight traces of charcoal under same. Two  
large sherds, same level immediately to south, one  
bright orange painted.

Friday March 13, 1931

A great many sherds (level #10) in Square #11. Some in  
Square #12. Practically none in Square #13.  
About the beginning of Square #16 on West side  
of trench level #4 (sand) peters out and is  
replaced by a reddish area colored by red sherds  
and forming masses of red clay, in many cases  
burned black on one side. This red layer seems to  
run on some distance, perhaps under the terrace.  
It does not appear on East side of trench. The  
color is due to clay and not the sherds. At this  
point the red layer lies on level #7  
which from Square #14 on has a peculiar small  
blue stone near the top. Sample taken from  
Square #18 is no. W-1-32.  
Center of West group Plaza trench, center of square #14

Pyramid.

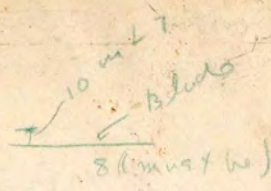
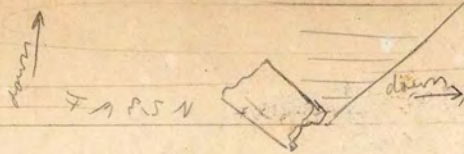

(Pl = clay  
of Rich Mts,  
in head-  
removes)

3/13/31 Continued

Shoulder blade rests squarely on top of level # covered by level # - Length .17cm (thin end rotted away). .30 to the east and .16 higher small long bone in level # of one end broken or cut off originally. Length .14. Slight evidence of charcoal and few small shells in evidence. No. W-1-33

Reached bottom this morning limestone bedrock at 1.80. Level #10 rests on this with an irregular bottom following the original stone.

In square #17 large limestone rocks .50 dia +/- removed top, about .80 below surface. Depth about .30. Bluish stone fragments at bottom.

In the first part of square #17 in center of trench in depth about 1.00 from surface, closely packed mass of large shells, bone, tooth etc under rock floor and under "red" area to be investigated later. (No. W-1-33)  
In line with "monolithic" wall

TRACE OF 8 STAGE W. GROUP.

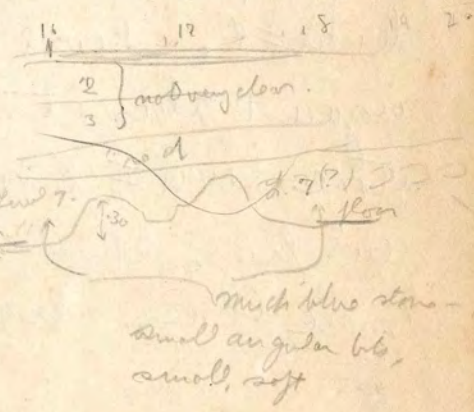

Saturday March 14 1931

W-1-35

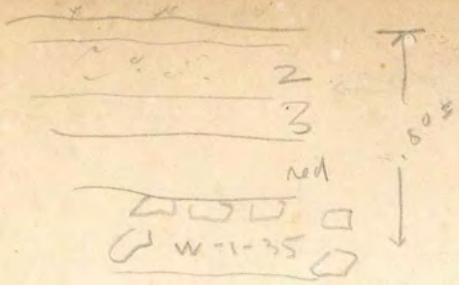

marks.

The red layer overlies, at this point, at least - stones large on top and fair size below mixed with dark brown to blackish soil, more crumbly than level # 8, for example. Shards bone, etc mixed in this dirt and small stones. Below appears to be more stones. All this is about the level of the very large stones on previous page, but the soil is different. Along on West side of trench, but there are none to center there is a piece of long bone which had been split, the first had not, quite small like a bird bone. Very rotten pot foot with discarded clapper. This deposit runs clear across the trench and is thoroughly mixed in with brown clay and limestone underlying large stones.

Large limestone fragment 1.60 dia in square 1.50 top 1.50 below surface, at and below level # 9 and projecting up into level # 8. Level # 9 peters out at this point, lying against this stone on east side of trench. Beyond this stone level # 8 seems to be on stone floor with ~~curves~~ and large shards packed in the stones. Some charcoal, more bones. Level about 1.40.

9-8

"54+1" = S111-2

Mar 14 - 5 Slopes below Rooms to be cleared.

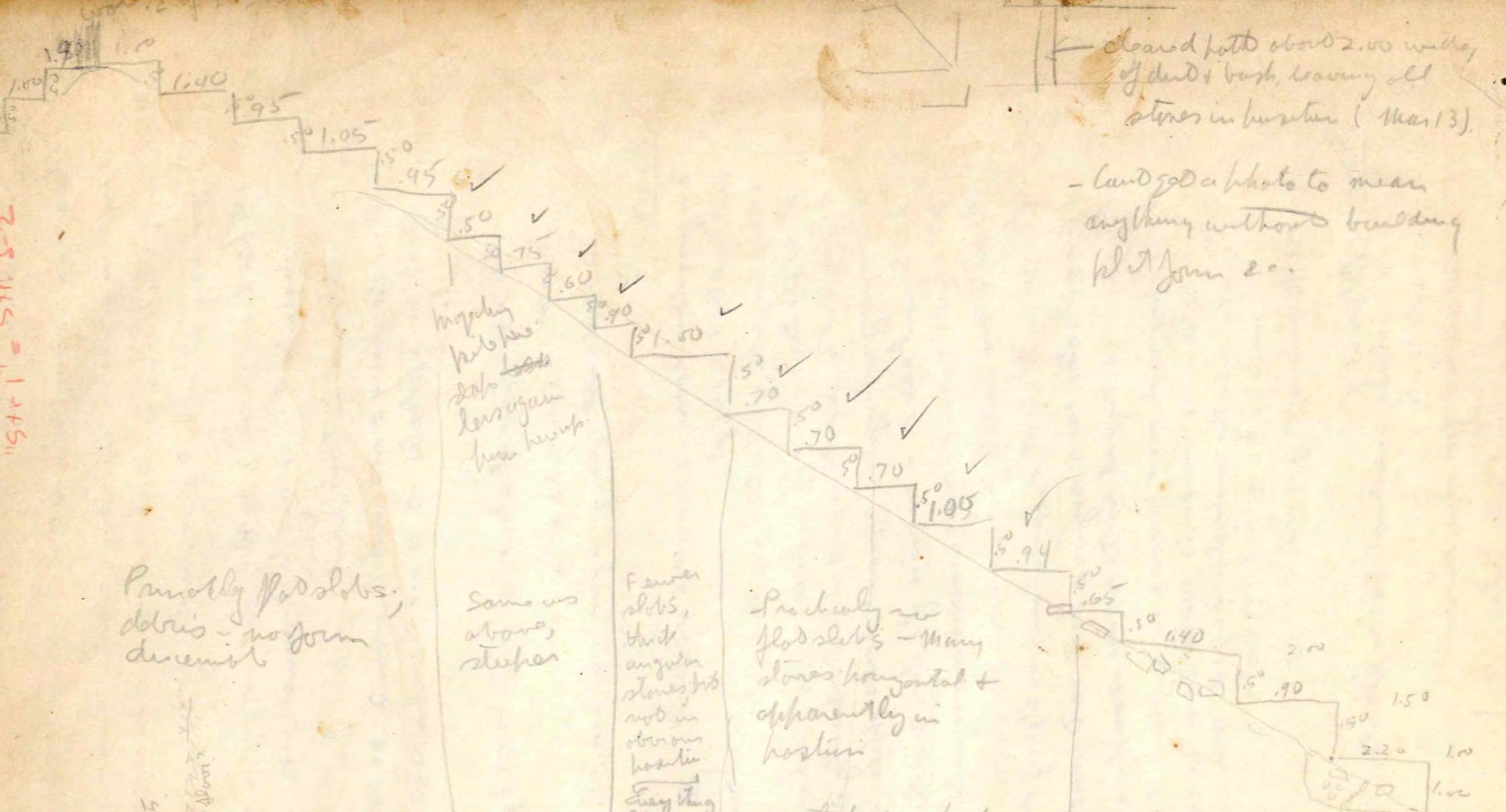

← cleared both sides about 2.00 width of dirt + bush, leaving old stones in position (Mar 13)

- land got a photo to mean anything without building plot Jan 20.

Primarily flat slabs, debris - no form discernible

Same as above, steeper

Fewer slabs, thick angular stones, not in obvious position. Everything lies flat on angle of slopes

- Presumably no flat slabs - many stones horizontal + apparently in position

steps consist of

← no change as well, steeper after this

Can't make anything out here - down .50 + get into loose stone of medium size - a jell

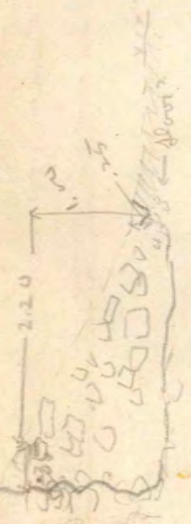

after clearing loose stones + wire det.

could make this out - dug in found base of small rubble - on large slabs in mud. ← 2.50 → 5' pretty down steps, in a run of 1.40 ±, steps red rock .50 ±, average.

Limit of moving of stones

Mar 15 - Room No W Group

Clearing room, started late yesterday.

Very thin plates on top - some strike thicker ones - plaster up to under the humus + plaster debris at the W end - also in alleged doorway at about floor level.

1 Sherd in room 3 m E. of end, .50 ± under surface - but much disturbed - colored high humus rather than plaster which has not appeared in this part.

am clearing ± on a level to about .80 below starting of vault. Much more plaster at W end than in rest of room at this level.

Large ± squared stone from which is probably doorway to next room - .66 x .33 x .10

Shards all heavy so far. so seem to be bases of plates

Mar 16

Clearing down room - 2 doorways identified and found the E end as yet

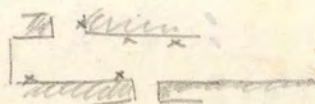

A large majority of all stones are thin slabs

- strike plaster in .50 ±, + much poorer, no dark humus in lower levels.

Slabs tend to fall at angle (& vertical especially at ~~points~~ doorways at doorway rectangular squared stones appeared.

Occasional sherds - one piece of a clay spindle (?) .027 thick

all sherds coarse + heavy. ~~except one small~~ - several "plate" bottoms

Here + there pockets of river worn pebbles.

Plaster in place at x, fairly low - no signs of designs.

1 piece plaster has a sign of a last coat much finer + whiter than base

Plaster was mixed with coarse sand + stone fragments. -

some much more coarse + in evidence than other pieces.

Believe the coarser is mortar from the ceiling hearth.

Can study the construction in next room where mud is fallen + much held overhead by roots.

all specimens so far are W-2-1

Mar 17 - Floor at Y

- Few stones, considerable broken plaster (coarse) on floor.

- 2 floors at Y, (two layers)

Established doorways, one end (?)

Floor is plaster.

cleared shavings of fallen timber -

cleared around a bit - 12 men in A.M. - rained in A.M.



march 18, 1930

Clearing with nine men. At X are  
undefined layers of gray-colored plaster  
like material. At Y a puzzling  
mass of plaster, apparently covered with  
stone. Seems to rise from a line slightly  
E of doorway and in the center of the  
room toward the east. About 30 width  
so far about 40 in height. Stones lifted  
from top leave their impressions behind.  
Step down to plaza uncovered at Z.

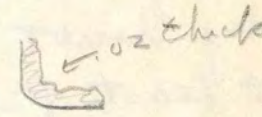
at a - remnants of plaster corner, nicely rounded. 

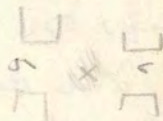
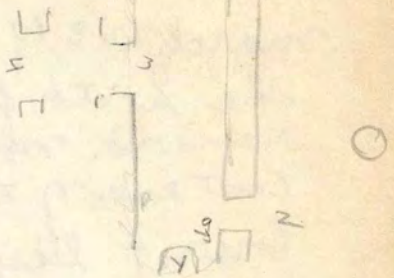

Mar 19 - with 8 men

cleared Room A to X above (X was only a mass of yellow plaster)

Broke through floor at W end - see sketch

Clearing a little with 2 extra men (2 men) at E end, but they went back to  
Masons.

Clearing at X with the 2 extra men. - through doors 5 & 6, turning out to left.

cleared doors No 1 + 2, a bit down + into plaza.

- bed rock reported opp door 2 - have checked

cleared through door 4

Made plan + sections Room A. with Tube only

Mar 20

Working toward Room A from X (no above) with 2 men.

2 Men. clearing below door 4 looking for stairway down.

4 Men clearing a wider space to E of both the above from S. - see sketch. (over)

LINTON SATTERTHWAITE  
 COUNSELLOR-AT-LAW  
 1012-15 AMERICAN MECHANIC BLDG.  
 137 EAST STATE STREET  
 TRENTON, N. J.

March 23 1931

The South facade of Structure I: Proof that workmen removed most of the first clear column at the East end of this facade: There remains most of the lowest layer of stone, per sketch. Plaster floor perfectly plain on west side of these columns turns up on the stones and is visible 55" above the floor. The same thing is perfectly clear at the back, further this section of floor shows without any doubt that the floor tips to the front, at least from the back of the columns.

Structure I

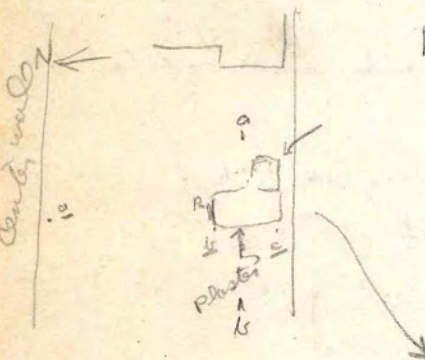

high below instrument:

- a .58
- b .62
- c .74

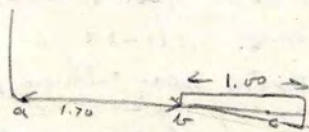

a + b diff. .04 - surface is this uneven - in 1.70  
 b to c drops .12 in 1 meter; consistently

stones ← plaster - decided rise in plaster floor to meet the stone as well as plaster on the vertical side of the stone

Mar. 24<sup>th</sup>.

Working 6 Men.

Leaving room D, identified S. side of doorway through E. wall center. The South end of this room was cleared carefully yesterday and today by Luis and part by me and I'm sure satisfied that all material removed was displaced including a great deal of thin roof slabs. However many typical wall stones were encountered toward the East. Finding the S. E. corner in fact with a further portion broken upon the first or second tier of stones and displaced toward the West with a corresponding angle projecting from the West wall plus a broken East side for the East pillar of door # 9 indicates the South wall of Room D has collapsed. The general cross section through room D south of center wall is about the same as elsewhere between and over pillars. Luis considers there was a door in the South end of D. There is a sill 20 or so at the bottom which should settle the point. See sketch map # 3. also identified several pillars both on north and south side these are now complete except W. of door # 15 removed logs and cleared rubbish in court for future trench there. Started moving dirt west of door # 15 preparatory to room C. I'm trying in from both ends of staircase made measurements and caught up on sketch map # 3, redrew map # 6 finding rotten - two bolts and what has you Luis has a toothache, what the hell

Mar 26 1931

128

For March 25<sup>th</sup> see prior sheets of U.C.S.

I left about nine o'clock<sup>on 25<sup>th</sup></sup> with two boys, worked in camp a little on sherds. Now worked between door #15 and Room #C uncovered probable corners at two more pillars continuing there to-day with Gus. Belson Acaba destroyed most of front of pillar second from door #15 (West). Gus identified south side of doorway in Room D. Uncovered some of the floor, found one sherd, heavy.

This morning uncovered other side of the doorway, considerable plaster about 50 below floor in doorway. Unable to find any with design, found one piece with smooth surface, find there no pot sherds. Belson doorway was plastered but not in places reliefs.

In front of door #6 much heavy plaster about floor level close to building lines. One sherd, but none found mixed with plaster and no plaster with form kept smooth surfaces in contact with smooth stone. Smooth plaster on east vertical face of pillar facing door #17 near back.

Smooth plaster on face of doorway room D. North side.

Two sherds with traces of plaster from doorway #17.

Plaster and pot sherds of the type found to represent fallen pieces in front of door #1 also found behind door #17. Some right on the floor.

LINTON SATTERTHWAITE  
COUNSELLOR-AT-LAW  
1012-15 AMERICAN MECHANIC BLDG.  
137 EAST STATE STREET  
TRENTON, N. J.

(over)

March 27, 1931 - Friday

Cutting down on cigarettes, "New Procto." Its all hokey.  
Finished ripping up floor of Room D and carried  
north end deeper per sketch to be made. Rubble base,  
nothing else - plaster construction still to be studied, but  
much thinner at West end of Room A

Cleared this room and also East end of Room B  
for photographing, see sketches to be made ( )  
for Corner constructions both interlocking  
and not. Cleared ground for central trench through  
court, much trouble moving fire - Hawk  
started trench and strike small rubble  
immediately. Very few sherds in upper level, at  
least. Hawk encountered a quadrangular stone  
about in center of court apparently in line with  
East side of doors # 12, # 9, and # 5. Will  
locate this with wall to-morrow (tried not  
here now God damn it). The stone may  
have rolled down from above - no smack on  
top of surface apparently, but is in line with  
the building (see sketch to be made)

Built roof of log for Room C and since  
with three men has cleared west wall and is  
as far as central wall of main structure.

LINTON SATTERTHWAITE  
COUNSELLOR-AT-LAW  
1012-15 AMERICAN MECHANIC BLDG.  
137 EAST STATE STREET  
TRENTON, N. J.

(over)

The east "filler" is a south wall for the room, apparently may have been originally a filler because the west wall south of the south side of main central wall is a separate unit, probably added later. This to be worked out. Plaster on both sides of South West corner, Room C. There is little doubt that the whole interior of the structure was plastered with fine white plaster like before including three sides ~~of~~ at least of the pillars. Succeeded not to find more evidence of stucco on the South side. This may turn up down the slope if we look for it. On the North there was a level surface to hold it where it fell.

Saturday, March 28, 1931

Found by Luis (no. ) incense burner or pot  
with head in room C (position, see below)  
In dirt with some plaster, typical light soft soil  
lying on floor of structure #1, apparently no fallen  
stones, under position reported by Luis. I hope to find  
more pieces in position.

Position - Bottom, 20 above floor, center of 2 beds  
about 20 east of West wall, 95 South of  
North wall. Correction to above, report after  
clear over to West wall at this wall. (see later)

5<sup>th</sup> bed found.

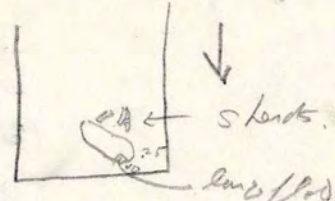

low bed stone, still higher  
on lifting stone - many small shreds under the stone, had  
against it - the stone against the bed.

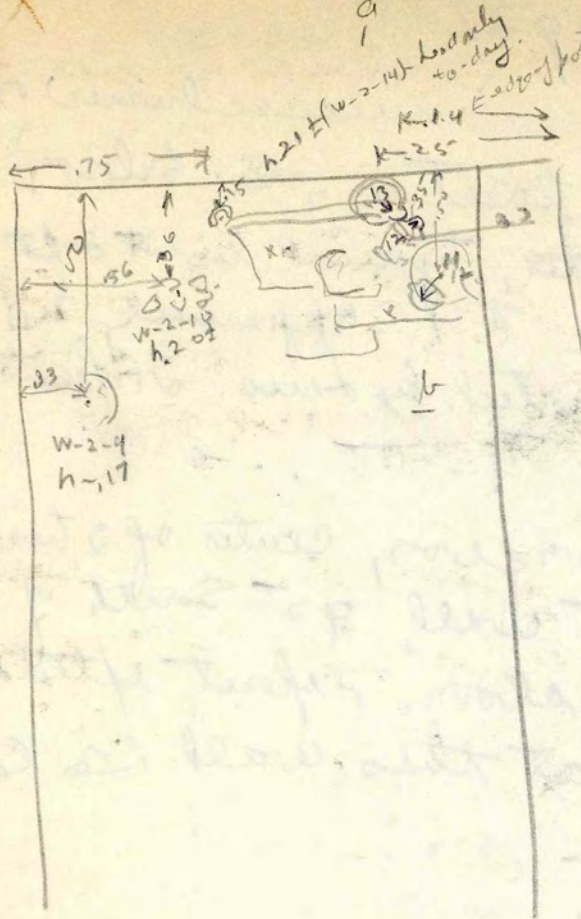

3 rows h=21 -  
height of stones, x-x  
excavated w=2-13 bottom  
edge below the stone

Sec a-b.

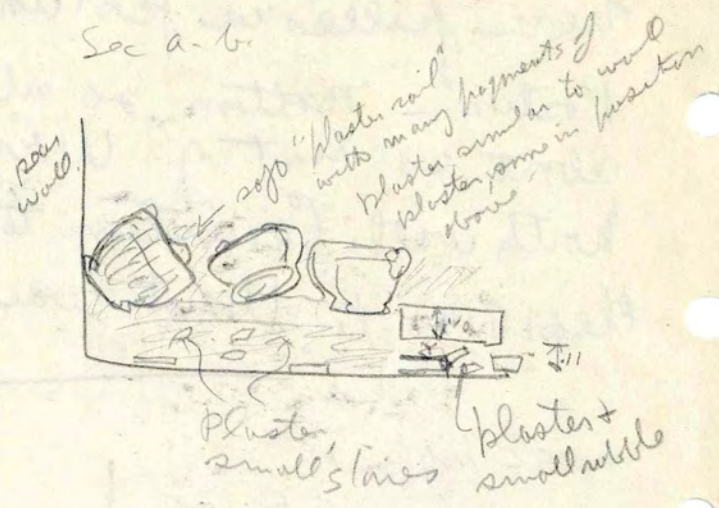

Above section by panel  
of this wall in N. of room

W-2-11 - Sizable flat stone leans against pot between it and the wall at the front, a small flat fragment lay on the dirt which seems to fill it. The pot is about .02 from stone of the East wall with plaster between and probably was in contact with it. This pot had its base .02, .03 below level of large stone in front of it

W-2-12 is about .01 from cleave tilted N.E on its face, angle about 45° about 0.5' separate the head of this from W-2-13. Plaster in evidence all around.

W-2-13 is tilted against the rear wall. Believe these pots were left here and knocked about by stones sliding down the slope of the debris. No W-2-10 was obviously squashed from stones. There is debris, stones etc under W-2-13

W-2-14 - Isolated face, Lacandon type - this may belong with W-2-10, though was farther removed from the debris. - No signs of the pot.

B: Provided by little book,  
then by 15 loose-leaf sheets  
numbered 12 to 152.

- 1-168

Monday, March 30, 1931

Working with six men, operation W-2. Stopped work on trench in Court #1 for restructions of J.A.M. With two men clearing a sample of main stairway, Plaza to Structure #1 opposite door #13 and pillar to East of it. Two more men clearing sample section up stairway at North of Court #1 opposite door #6 and pillar to West of it. This position selected to cover the stairway and a little to the East of its apparent side. Luis and one man finishing clearing of Room C and following plaster floor to edge of structure for a section between pillars, which has heretofore been difficult to establish.

Worked two men the first hour completing clearing of stairway opposite door #15. Recovered piece of stucco ornament at base of this dig about 4.00 and 2.00 below edge of structure #1 (W-2-). apparently possibly an ear ornament. This is the first undoubted stucco ornament on the South side of structure #1

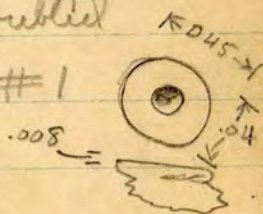

P.M. Working with five men - one ill. apparently nothing under floor of Room C, but the floor is soft and easy to break through and in Room A only a metre away or Room D the floor was extremely hard below the plaster. See sketch to low made for dimensions and composition. Also five or six feet sherd in the floor in small area.

It seems apparent that all the pillars on the South side and probably the north side rest on a floor or platform which projects about .10 beyond. Opposite door #16 this drops about .30 to a plaster floor entirely outside the building - to be investigated further. On the South side judging by this, and the level of stairs so far identified below door #15 there was probably a plaster covered passageway or landing about 1.50 to 2.00 wide running along the outside of the structure and about .30 below its floor level at the outside.

(L20P  
door #13)

This P.M. Luis with one man carried court trench up to door #5, and found a straight drop of .30 to a stone step or possibly stone border at plaza floor level. Found pieces of plain plaster on this step. To-day we finished clearing main plaza - Structure 1 stairway above mentioned without moving any stones. Believe staircase hypothesis is inevitable though not certain. I have cleared path up stairway and found floor of structure #2 above, but am leaving rubble over upper part of stairway as protection. M.C.S. and I ran horizontal lines in plaza trench in preparation for drawing.

Mar. 31

6 Men. - working in pairs. Carried section of stairway, Plaza to Structure I, W. group, successfully to plaza floor by spreading out at base, to E. First time able to do this, and it is very clearly a stairway there. Trying to ~~be~~ connect this section with structure - different.

Have established however:

Room 15 encloses a set-back step:

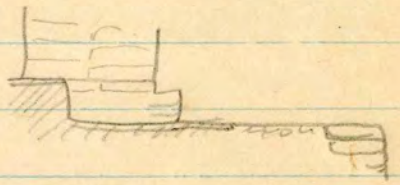

Good Plaster floor at bottom of steps runs around corner to E - but can't carry it far out to south. This level drops apparently to another very broad step or platform - edge not established as yet.

Carried work at N of Court, up - nearly cleared to floor, back to wall of structure #2 - carried this to west at higher level looking for set-back (niche) for other visible side - the niche is narrow and not reached yet; but the <sup>back</sup> wall to left of my trench (and not in it, shows a curious regular & level top, with more details of the ceiling fallen away above it - and on it - must figure this out.

Carried Court trench up to Structure I.

Widened dig around Room I - the inclined plaster-covered step continues indefinitely. Lost some time trying to get out large mass of sherd & stucco immediately to W of doorway, corresponding to the other side. - few knobs the only result.

Working in P.M. on Middle stairs N of Court, as well as higher up. (Shower to-day).

13. Joked at Chif's lunch - not in N enough to 5 feet - 9-1-8-0 - other's small physics - doorway to balcony

April 1 <sup>6 Men</sup> Morley's party here - ~~trying~~ says glyphs on new lintel beautiful. The initial series much earlier than style of carving - should be other lintels carrying date to contemporaneous one.

Trying to connect stairway to Plaza with St. I - third attempt failed.

Finished stairway at N. of Court - not so perfect - cleared E end of niche in back wall of Structure II - looking for roof (platform) level above, and the Court level below that.

No lunch again - Head ache - was the hell.

Apr. 2 Started clearing driveway, corresponding structure in Court 2; also at N side of court. Started sinking pit in Court 3 next to semi-circular stone, center of court.

Took Ruppert to Sunfield rock. Found 2 other fragments of base of Stel 43, identified by Morley - helped him set it up. Got all dates of stelae & alters from Morley.

Morley's party: Mrs. M.; her father; Ruppert, charge of excavation at Chichen; John Bowles, architect at Chichen; Fr. Rife, good & J. of Chicago, but going to St. Fe.

Apr. 3 - Good Fri - no work for men. Explored to east of human city + S. Many mounds behind S. Group & to S, E of trail - all low & peculiar confusion - somewhat similar to those at E end of Campanileto Plaza, but none so high, no courts.

One looks like construction (wall & cop stones) of center, (animal hole), though very broad and flat.

- House platforms?
- Burial vaults?

- P. M. in work room with M. C. L.

Bun  
(V-1)

Apr. 4<sup>th</sup>

Tried to get instructions - Chief assumed I would go ahead on aropolis to get not only a section but plan - surprised it couldn't be done in a month, or a season - O.K. idea of digging out corners of main structures only - but section first.

Finished doorway, back to wall, structure 3, A.M. - See Sketch Map #  
Continuing doorway in Str. 5  
Starting trench in str. 5, which may be imaginary.

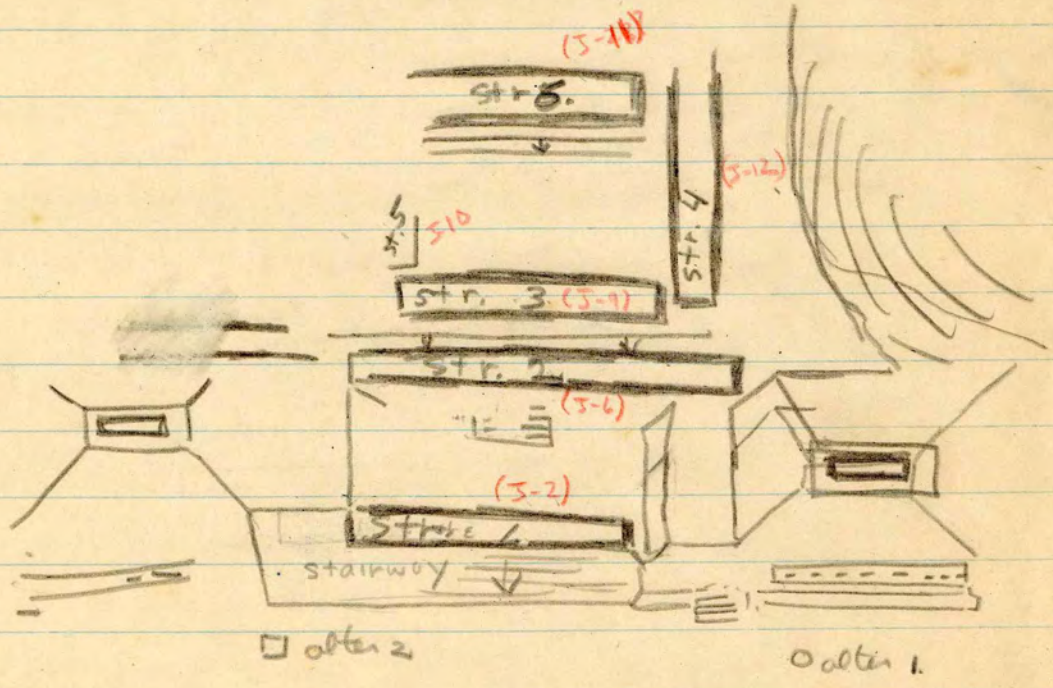

April 7

Men, 3 gangs 2 each, working under Peggy, Cow 2, W. Group, benches in structures 5, 6, + inside corner of 3+4. (See page ahead).

Yesterday:

*Men* Shamed chief alleged grave would, S.E. of Big tree + S. group - no man along - he dug awhile - pulled out part of jaw, human - decided I should work it carefully, but without touching from outside and without a man.

*Peggy*

I explored while they were digging - straight back and up the hill from this site - more terracing + mounds - a long steep slope - then a large mound on terrace (quite high up), one side really a quadrangular pyramid - which goes down on the rt side (facing hill) by steps in good condition. Mound about size of a acropolis courts.

~~Today~~ On way home in P.M. explored back of acropolis further:

2 false pyramids along ravine which separates them from the good "stair way" toward the river. - they rise one behind the other from the platform at base (follow old trail to ruins, where it rises on the terrace a little).  - with shaded top - which business much lower than "blazin" at head of "stair way".

*Site 5-21*

Today



Started alone on "grave": A.M. uncovered rest of mound - pretty heavy *v-1 channel* cap stones - mound fallen. Ruffed a little, obs. clearing fallen debris (from my uncovering mound - and picked another piece of jaw (left side) with molar, pre-molar + 2 incisors - 4 teeth - about middle, ~~at~~ 50 from S. end.

April 7 cont'd

P.M. Came to vault by going over hill ± behind Sta. 42 - hill of a high flat-topped long hill. - False pyramid descending to trail on other side - structures on both sides trail, especially left, all the way down to S. group.

Recog

Believe something like this.

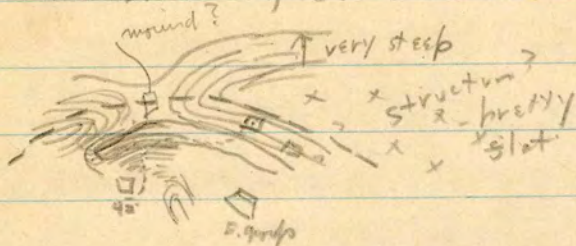

Vault (opposite) - Ringing - could find the chips bones in situ - buried thus a m.

f.r. protection. There are small tubular stones at angle on either side in the purple dirt. At N. end - more stones at about .90 to 1.00 depth - at .95 bird bones - spread out flat. - few cms. from N wall. also

x long, slender, thin, black bowl. Stones more frequent, larger, and softer to the general level. Another bird long bone 10' lower, human sternum - also, right against middle of N. wall, broken bone, presumably human sternum. Pretty close mixture of earth + stones at 1.00

(still the N. 3rd of vault)

Thick flat stone 30 x 20 in center, 135 from N. wall, above flat, with long tubular on edge, in curtain, slanting up + S to E. wall - every appearance of having fallen. Under the flat stone - skull fragment + long bone

April 8 with men on Couv 2 till 9.00 - took till 10 to go to grave, via S. group + transverse valley. Believe false pyramids on N side of latter.

April 8 - cont'd

-8-

Carrying down S. end & middle of vault. - Much more of the purple soil, especially against S. end wall - it is always granular, and the color is a coating on the stiff dark brown "greasy" soil. - worms? <sup>+ pushed</sup>

Two finger bones and rear of left lower jaw knifed out somewhere between S end & .50 north of it; level about .95 down.

Soil very tough & almost impossible to dig out in clods.

The larger finger bone undoubtedly from center, .50 N of S end.

Two obsidian chips, tiny pieces of bone in the greasy soil, very hard.

Very closely packed with small irregular stones at 1.00 down, S end.

(corresponding to N. end). Blue soil very noticeable at S.E. corner

It is always soft & crumbly,

Bottom drops under the purple at S.E. corner; (same W of skull at N.

I wonder when it will fall - seems to be hollow under north.

Bone, cut end (small long-bone at with shear among the stones.

Two bone near center - always fragmentary - about 1.00 level and between two "ceiling" stones on E side thus:

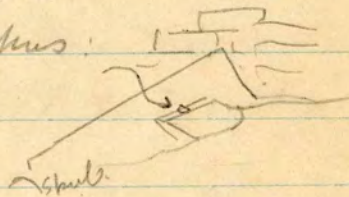

P.M. - Invented stone count 3, W. group, S.E. corner.

Str 3-12

= St. 4 on Count 2, in 1931

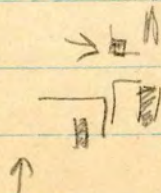

In case, unfragmented, very crude, re-worked for use here.

April 1

- 9 -

On Count 2 to start men; on east group temple ad chieft regresso - then to vault grave, <sup>grave!</sup> about 8:30.

Finger or toe (possibly hind?) from 2-90, 1.40 S + 20 W. <sup>absolutely isolated.</sup> in hard-packed "greasy soil".  
(- using N end of E side as bases for co-ordinates.)

Thin fragments of bone at -13t, 1.40 S, 35 W, among stones & loose soil.

Piece of a rib (.037 long) in loose dirt from the S. end, about same level.

Any kind of shovel work is ~~sure~~ sure to turn out one or two bones - they are isolated and scattered all over.

.50 S, .10 W, about same level as skull (close knige + earth) - D 

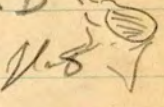
An increase in number + size of stones, especially small  ones, is noticeable at between 1.00 + -1.10 or so, from S to head ad N, (the rest not so low).

Part of Pelvis + ad femur apparently in position. Piece of broad bone knifed out somewhere between pelvis & head - also small pieces of rib in this region.

Piece of rib at 1.40 S, .05 W. same level as pelvis + just about opposite it. Also smaller pieces nearby.

Finger bone (E) at S.65, W.02

Shard piece of rib (.03 or .05) right against W. wall, 1.30 S, h - 1.10

Small bone  (F) smack against W. wall, 1.80 S, h - 1.10

Finger bone (?) (G), h - 1.10, in little angle ad S.W. corner, S of S wall, soft dirt here.

Foot bone (?) (H) broken + buried out by knige - about 1.70 S, 35 N, h 1.15 ±  
Can't find the rest.

I - Bone head? - cut both ends - in loose dirt, 1.75 S, .10 W, h 1.10

brushing loose dirt out.  
This must be app. position!

at 1.10 ±, and is fairly stiff all over vault - which is wedged at S.

J - also cut both ends - turns up same position & conditions as I.

K - Finger toe bone - ~~not~~ against N wall, center, h = 1.10

L - "(?) - loose earth close to N end.

Pie of rib - NW corner, knifed out. Another.

Another "finger toe" bone, in position .02 S, .48 W, pointing down

✓ M Pie of cut or broken rib ( ) .20 S, .60 W, h = 1.14. This is typical of many pieces of cut, occurring all over, ±.

Another, same level, against W wall, .15 S. Many were against the W. wall.

Still another longer piece in this corner, being by its position.

Cleared main bones by 5.20 - a reburial almost certainly.

April 10, 1931 - Friday

Soil, small stones, broken pieces of skull lie in West part of skull as in a cup. Under portions of skull, broken upper jaw and apparently a large piece of the cranium also, lie immediately to the east. Head probably lay up side down the palate, with two teeth at the east of the mass being up side down. Head has broken badly crushed.

N - Finger bone? projecting from under pelvis few cms. east of femurs. Pelvis like everything else rests directly on stone. Badly crushed originally and impossible to get out whole! Lower femur was articulated with it. No signs of the other

half beneath it. Skull likewise rests on closely packed stones of some size. It is evident that the stones that cover and enclose the skeleton did not fall from the roof after the burial. Very difficult digging in stiff dirt and stones, some of them as much as 20 across. Fragments of rib and small vertebrae knifed out next to wall a little S. E. of skull and .10 below it.

O - end of wrist bone & fresh break

Skull found removed. Right orbit practically gone. Left practically complete but badly damaged in getting out. Many face bones already broken, record. Possibly a reconstruction can be made. Forehead much flattened, super orbital ridges absent, head long and narrow. Distance from occiput to front on median line opposite orbits .15, rough measurement, and occiput not complete.

After removal of skull and <sup>in</sup> clearing to greater depth north of it three vertebrae appeared at slight angle but more or less level about .04 to .05 apart. In other words their sides and not their faces are aimed at each other.

P - 2. Right in N. W corner with fragment of rib (is second cervical vertebrae.)

D - Four finger or toe bones etc. probably a vertebrae from 1.30 South immediately next to

West Wall H = -1.15<sup>-</sup>. Packed in among stones and pretty stiff dirt, no signs of animals here.

R - very tiny finger and toe bones 1.30 South 75<sup>-E</sup>  
Height - 1.15<sup>-</sup>

S Small finger bones 1.15<sup>-</sup> South, very close to W Wall, ~~red~~ <sup>red</sup> feet sturdy near by. ~~found~~ <sup>found</sup> ~~marked~~ <sup>marked</sup> S

T-1 & T-2 - foot bones & piece of skull (?) - extreme SW corner, h - 1.10<sup>-</sup>  
about .10 from each wall (not considering "niche" - 7

Thick with close-set but irregularly shaped & placed stones all over bottom under skeleton - nothing under - 1.15<sup>-</sup>.

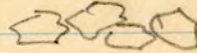
Base of grave of larger rough stones, close set  diam. .20 to .30 with occasional foot shed & several pieces of "tenga cotto" - red burned clay, amorphous with possible exception of U

Below, "noted"?

V - Bone - possibly from within "flour" - close to N wall about centre.

Dirt tended to be softer near edges, especially W side: the "purple" was always pebbly & soft and was undoubtedly due to worms. Dirt was stiff & hard in general, however, clear to & around the stones which covered and underlay the skeleton. Those underneath were certainly larger - stones progressively larger from top to bottom.

Potsheds were sporadic & certainly fortuitous.

April 18, 1931 W - medium sized vertebrae, two rib fragments well within "niche": found in final clearing. Vertebrae is actually South of main South all.

April 11 Rain

(Barral #1)  
= vault #1

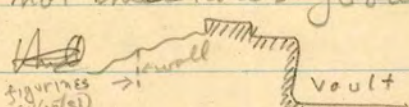
Boys clearing line of sight to and on vault structure, S.E. section, also cleared surface to N of vault + started in on side to N. This result: therefore not three rows of vaults as I thought. I cleared line of sight up the ~~hill~~  hill N. 25° E + encountered the mound above - explored to W of mound - peculiar roundish mounds a little higher, N.W. - ascended hill + behind mound, led on by fat sheds etc. - more mounds, irregular, higher up - with large stones in evidence - we should be turned over on a chance. Ascended the mountain top still above - high boulders - peculiar surface - possibly slabs removed from here?

13c.

11/19

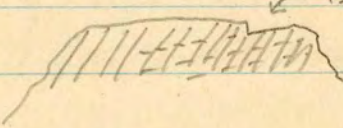
dips in  - several boulders in limestone stratum, which - could these occur by natural | 8 way? erosion?

Ascended as nearly N 65° W as I could - mounds at bottom - a narrow valley bottom, mid level - running into Transigeo trail very close, at point opp. pass to E. group at Chink - to Chichen Tees played here - to be checked up. Ascended trail a good distance to the big Carba tree. I had without doubt been on the high hill to the ~~top~~ <sup>E</sup> of trail with such steep sides, which closes in to form the saddle ~~around~~ <sup>formed</sup> by the trail. The vault structure is therefore part of a mass of mounds surrounded by this hill on the E + ~~the S.~~ the main ruins on the W, the saddle at the N - widening out into the transigeo valley (~~prolonged~~ <sup>projected</sup> further E than Males shows) at the S. The transigeo valley bounded by another hill, with mounds clear to it + beyond in the trail pass. Sketch to be made P.M. Cleared bones (after hours)

\* road follow, but given the ascent.  
 xx - A suspicious, possible round mound on way up, quite close.

April 12 Sunday.

Explored Campamento valley, NE of trail - paced & at look bearings, made sketch map, including former observations, but they are not to scale. General lay-out must be something like this:

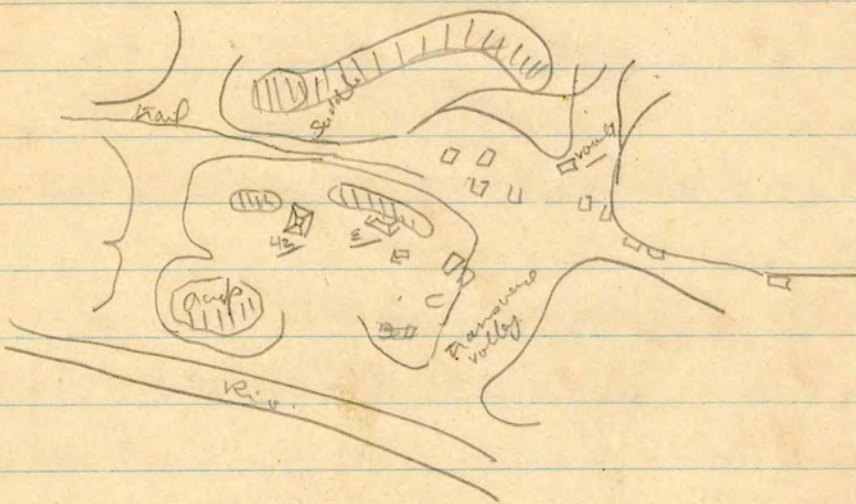

P.M. Took Mrs Wynn over acropolis. Worked up notes, made sketch maps etc.

April 13

Six men at Varet: wall to N, probably with steps

Many sheds, 2 archaic figurines (#) from the rubble - close to wall 1.00 or 2 or W of varet project 4.

Digging to W of varet - through small rubble to very large stones - could make out anything as yet - occasional sherds.

Plaster floor, h = -1.00 ± - Poor quality gray plaster.

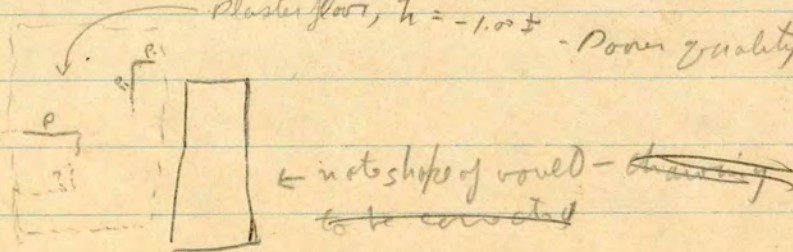

Painted lottery from all barteris.

Explored about N 65° E from vaued - coming out by a left turn of about 50 m. at big tree on platform E side of trail, opp. side of 3 S group pyramids. - + pushed up against hill hereabouts. Many, some very high platforms rising in succession vs the hill along most of this line. - one very long one, ending at above termination (but in from trail) is very suspicious - possibly a colonnade - almost certainly a structure:

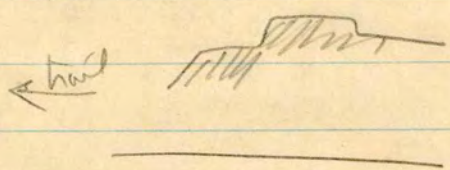

April 14

Continuation of work N + S of vaued, also clearing.

See sketch map #9 for this

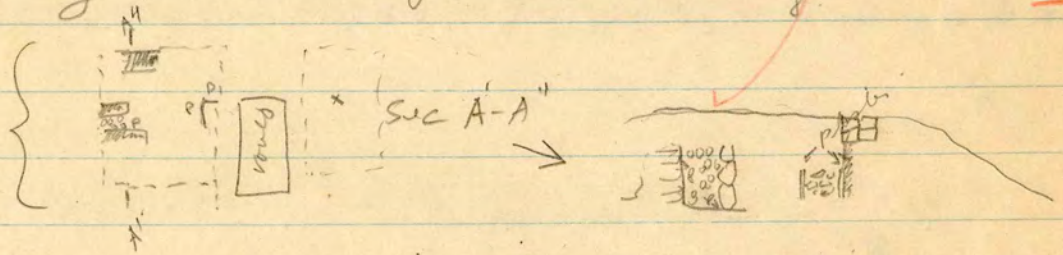

x = small piece of bone @ -70 ± V-marked -1

Two more small fragments of bone in excavation of burial # no 1 about 80 below surface

A pretty clear piece of burned clay with groove from the floor E of burial #1 - wooden roof - plan at 50 cm is dark - bluish black, had no charcoal.

Wednesday April 15, 1931

Section of vault No. 1. North end: - stones (rubble) continue down to about -1.45 where they give way to soft brown soil. To be investigated further.

Having a hell of a time certainly no more vaults are to be expected. Everything is very difficult to follow. There seems to be an old perhaps original construction with a floor at -1.15. This occurs on both sides of the vault and probably north of it. There is evidence of secondary construction on this other than the vault which seems to go through it, and that the whole was filled up <sup>not</sup> with rubble <sup>the result</sup> but with a compact mass of stone, earth and many pot sherds. Low walls were there constructed on this, possibly they were fairly high to account for rubble to north of structure. <sup>had most</sup> of this is a step ~~rock~~ and there is no mass of basalt over the head(s) of the structure. Certainly could have been high. Seem to have stone foundation walls about .30 high, no more, placed on top of the older structures filled up. A bit hollow to E of vault confirms this - though to W one of the peculiar "bumps" on the surface, 2.50 + "W" of grave. One human tooth (molar?) from this to-day, about 4:20

(over)

April 16

Small bottle, flat

SE-1-10

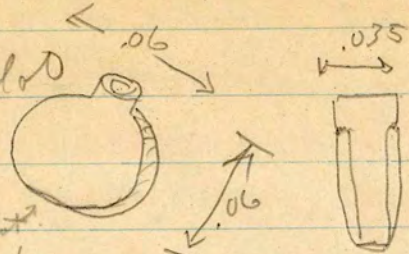

- about -.45, in fill  
 3.00 N of w wall of vessel, 1.50 S of  
 N. wall, old, main structure.

Contains something - some fragments?

Broken obsidian flake being - same general area.

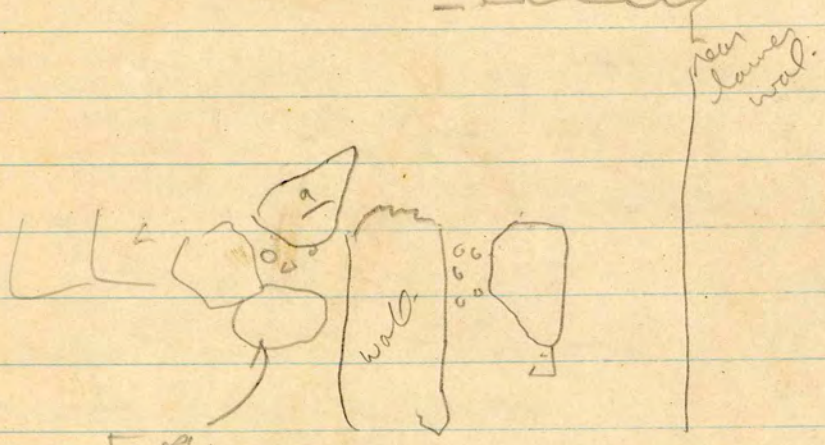

Phase 2

flat stones roughly level about -.70-

removed a - other below included this way.

More below - a bit hollow between

Underlain by low soft dirt in a slight depth. below the long tables lie regularly placed E & W - though not squared stones - they have been leveled in the dirt - leaving a center.

- Hand in soft dirt under stones - clearing all around.

- Undoubted piece of burned red clay which rested on sticks from near NE corner of vessel, about - 1.50 cutting E & N from vessel - smooth on one side, with shank.



ch is of sticks .015 x .02

Similar piece from Room A, dia. .025, smooth back, one striations

But no charcoal - these must be basins from burned houses elsewhere - or perhaps never burned - quite soft. - No pollen here, too rare.

— <sup>SE-1-11</sup>  
 Archaic type figurine - above stones of grave #2 (loose back work)

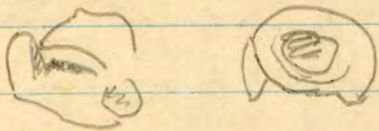

Digging in from S toward grave #1 - pointed shed near surface. (not yellow & red negative was however - black (or brown) on red on yellow slip - dull pink past)



dia - .007

## Burial #2

Burial 2

Lies under pile of slabs set crosswise across skeleton (presumably) several deep at center only one large slab at South end apparently chipped. Roughly semicircular - see sketch map #9. The other slabs are irregular. Thicknesses varying from .07 to .12. A new floor is observable at edge of cut 1.00 West of West side of southerly slab. Height -.26 of the hard so far uncovered soil - 1.07  
 Top of South slab is 1.90 South of Plaster Wall running East and West. Between the stones and the skeleton was very soft brown earth, which did not occur either

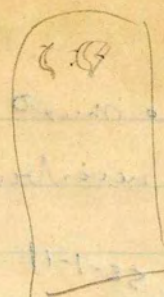
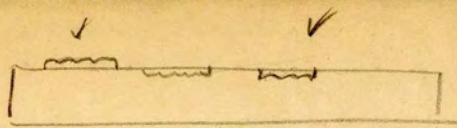

Handwritten notes, possibly describing the diagrams, including the word 'Figure # 2'.

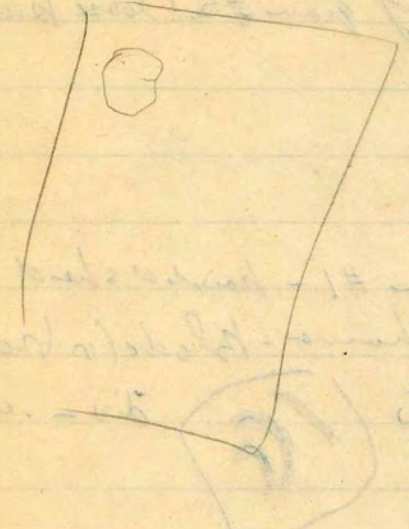

Handwritten notes below the diagrams, including the number '8' and some descriptive text.

Figure # 2

Main body of handwritten text, likely a detailed description or report related to the diagrams above.

to the east or west. at this level on the east were large stones perhaps part of a wall. On the West mixture of small stones and dark purplish earth. check (fill). Best to check on the remaining good stone but probably the grave was like this - look and "N":

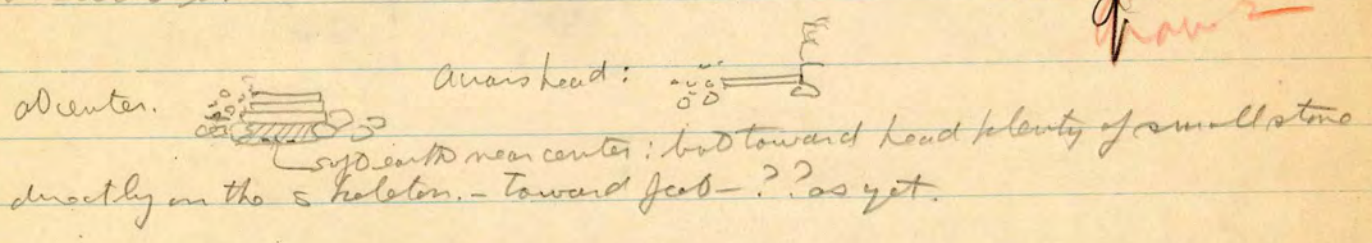

See Sherd Map #9 & notes: ~~the~~ The grave heads against E + wall (odd base/plaster) - to E + W of it - Perhaps they broke this for the hood of grave. The Plaster immediately to W of grave was on the inside of a stone pulled out by Lewis - + plaster remaining all over is rough + broken. check this up.

Bones are as soft as dirt - which is in places harder. Am trying to ambaid in position.

Making cut opp. vault #1 from S. - cleared stair way also, and way clear.

Sending vault #1 + Room A down - "A" underlain by botido. Painted shreds from deep under vault, with plenty of clay, also in S.W. corner soft light yellow soil.

April 17

Red, black & yellow slip sherd from cut through stairs to S - not more than .50 under - glyphs?



III = red  
white = yellow slips.

Red

126  
flm

Humb  
Partly  
1-1-1950  
Solved

Following new floor @ -26 - cutting into small mound, center about L-4 (5th Prof #9). Had center about ±.50

Slopes down to N, to W, to S, but with a spur running toward R-S.

S. d. slope to E to about K-11. <sup>or a cairn,</sup> <sup>with slightly</sup> <sup>poorly</sup> <sup>preserved</sup> As per ruin & rocks & lumps, <sup>rest quite small (.10s).</sup> plaster - a few rocks large (.50), there is a slight rise (stones) in the center running W from this mound, level lower.

Bottom of this mound lies on about .10 of road light soil (topped

plaster-dirt - which lies on the floor, much destroyed. |

Floor = 

page 2

Burial #2

Nearly under the shoulder end of the left humerus, slightly west and a few cms lower is a big molar tooth pointing downwards at an angle of 45° or steeper than bone behind and above it. One root of the tooth sticks up in the air. Curious area of bone to the n.w. see sketch below

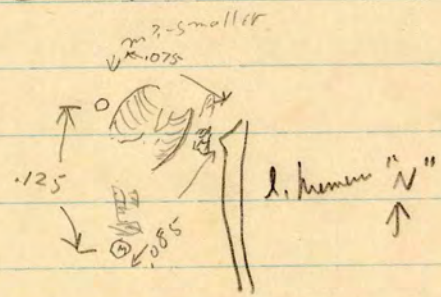

Beads are all in the region south of head bone, but never in juxtaposition of the concave bones between the left shoulder and the head are the palate I cannot connect

Apr 2

teeth with it.

Broken obsidian flake knife in loose dirt from the burial. On removing the southern stone I found the line of small stones still remaining on West side of skeleton continued to a greater height and form a little wall supporting the slab. The tops of the stones are perfectly level. They form roughly an oval end. They are not quite continuous, part of the slab being supported by tough dirt and planks. A spider had his home in the "S.W." corner which is hollow and full of leaves. Two roots of the tree run into this part under the slab. Another large root ran N.E. over the right hand and two fragments of femur nearby and under the left elbow.

Stones over the bones at feet as well as head

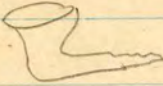
 ← ornament - 1.355 x .05 W next to long bone. (between tibia or fibula)

Low bone up side down

Be small spindle shell +  - cross section of spindle shell (.0607 dia) - over 20 ft base

Continuing clearing under South Slab - bones here in very bad condition, very fragmentary. There was undoubtedly here a sledge run ramp uneven and now broken plaster floor on which the bones lie directly. Bones continue to very end of vault.

most southerly piece is not a toe-bone but a very thin sliver less than a millimeter in thickness of a bone of some size.

Tooth with green stone inlay 1.37 S to E between center and East long bone.

The supposed plaster floor in spots is hollow.

The body was either articulated or laid out in semblance, on its back. The head is badly crushed and is impossible to remove the jaw intact and the teeth are curiously spread about.

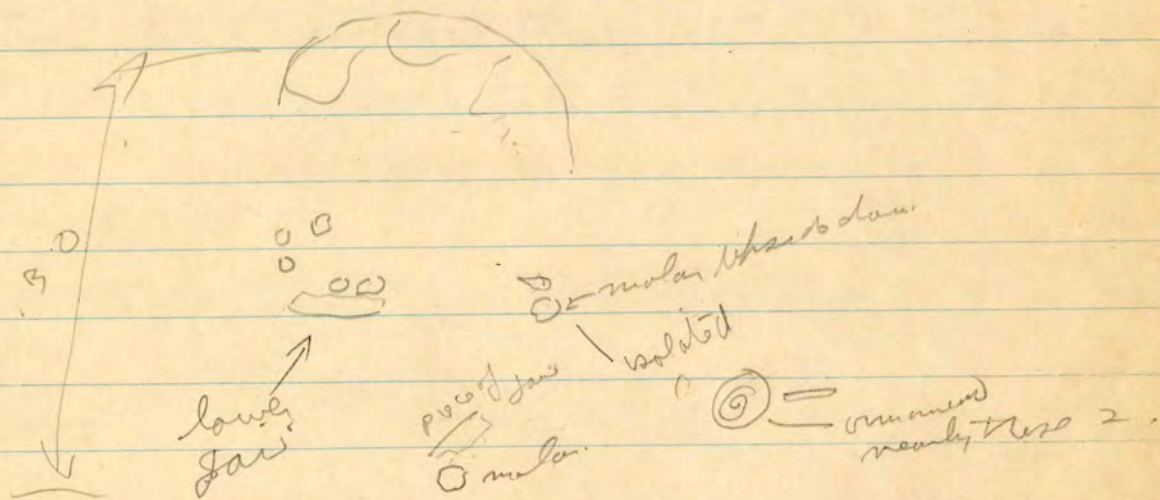

The lower jaw rests horizontal with Chen due "West" <sup>South</sup> Green beads close together directly under center of jaw, also several shell beads, same position. If more show up it was a necklace.

Impossible to take out jaw which I am cutting up. Beads are running consistently along the South side of lower jaw, both shell and green. Head rests

on white plaster. Two green stone beads side by side. Second "foot shaped" ornament just east of .25 South and .10 East, just behind jaw bone kept to beads.

Depth of gravel floor below <sup>bottom of</sup> southerly slab is about .18. Floor is about same level at the head and sags slightly in the middle

17 green stone (poor quality) beads, varying sizes. holes: 

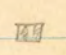
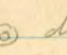
15 shell beads, tubular:   dulled much straighter, very small, to average size of green ones.

2 earplugs (?)  - one at head other <sup>between</sup> ~~shins~~ shins  
- 1 has traces of red-paint?  
- mud of waxy?

sketches

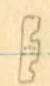
1 circular disk (bead?)   - shell, reddish

1 cross section of a spiral shell, proper this  - (natural shell)

1 tooth (incisor?) with circular green stone inlay. } corresponding.  
1 " " " " black (glossy) inlay. } no incisors? 

↳ pupates or hemolites?

April 18 - Saturday

Abandon (black but quite clean) flake from upper floor level.

Following walls on this: - sinking bench N of Burial #1; canyon that S of it down nearly.

The grave has a floor of fragile white plaster resting on small stones and brown dirt. Plaster is often hollow like tortilla. This plaster



4/18/31 cont'd.

lowest wall - Test Pit S of Room A. (16-0, S.M. 49)

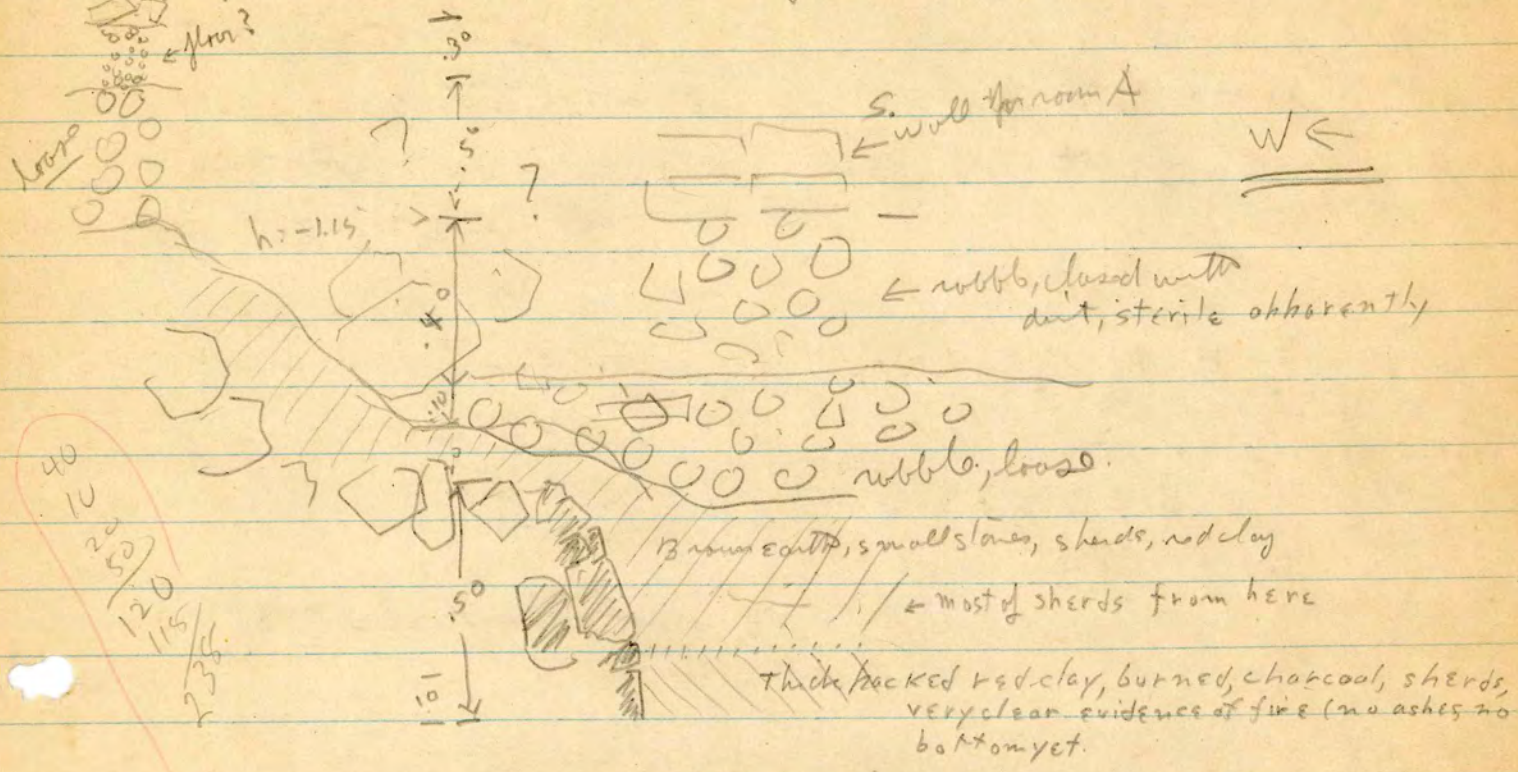

4/19/31 Room B and #2

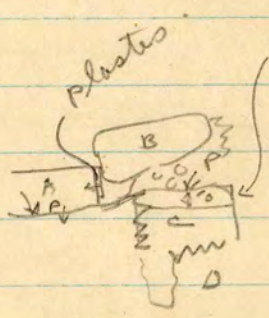

A was later than B = remnants of plaster between them (thick, bluish inside) facing toward A. A rest on plaster floor  
 B better than C = built against the plaster of C, which clings to it  
 were it was pulled out for grave  
 grave is later than all three because head occupies space in C, with some plaster from C still remaining on A  
 The floor is to meet both C + A-B line wall + is contemporary with them.  
 ∴ burial is later than this floor - + all this construction

coming down inside (S)

Below "C" is remnant of a rubble filled double wall about .85 thickness remaining to W. end of tough stone in area D - + Section to W looks like it



Monday April 20. 1931

Trying to follow top structure ~~to~~ W of main dig:

"slow"

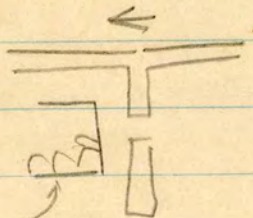

Slots here only - road is full of rubble & humus - debris was a platform. Much disturbed by 2 large trees.

F.P.

Figurines from well in or on heavy N. wall. - Moya head, hollow fragments, & capped figure (torso) - a beauty.

Trying to catch lowest wall from S - much difficulty. A slow day.

Made contour sections of natural surface.

Level main road is -2.46

Level Bottom of N. wall is -2.03 "

∴ Whole structure is artificial, including the large-stone complex, which must be a structure.

A. Blinné wall descends below this level\* - Fupv approaches from N through rubble between it and N wall.

\* 4/24/31 is probably a latter one built on lower one of more massive construction.

April 21

Page 3

Burial #3. "N"

"T" shape

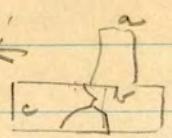

See sketch this date - One large roughly square (corner broken) slab over north end. This had fallen south, + W, due probably to sinking of N half of west wall (of small rough stones, similar to #2). As a result, both pieces lay directly on bones, a few fragments ad leaning to them when lifted, many being in full view when they were lifted. Some stones, + soft earth over bones to E - similar to #2. ∴ probably these had fallen + washed in from side walls in each case.

The large slab probably re-used, as could fit the missing piece, + s.w. corner is made a right angle while the N ones are.

Long bones ad a (not uncovered as yet, but came ad to from the E) lower jaw ad to, skull + probably upper jaw ad c. Two or one individual?

The large slab extends under the center upper structure wall to the middle, and the inside of the N end of grave "wall" .32 under it. The big slab (if whole grave was covered with rubble and ad top small floor rubble. Also the E-W arm of the T (slab + bones) extends about .30 under the N-S upper structure wall. ∴ very probable that grave ante-dates these structures.

Took photos of grave with wall over slab + after removing wall.

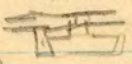
The ~~E-W~~ arm of upper wall  was built against the <sup>N.S</sup> E-W, which is undisturbed by its removal.

*Black clay*  
 Carried N + S trenches through black clay with charcoal, sherds, to natural red. The black clay (examined only in S trench so far) is very tough + pure, contained few bone fragments well preserved. to be studied & drawn.

Started S E 2 - up hill. - large table, fallen, many sherds near surface, no handled as yet.

Figurine head with head chert, arms, obsidian, bones (animal?) well preserved, bird figurine:

*Hand 2*  
*on wall*  
 II Dig under Burial #2 - plaster on stones + earth, ~~earth~~ stones larger below, resting on "red floor" (-1.15 ±) which runs under wall to N apparently.

Sank pit in passage N of latter, opp grave - obvious floor (small rubble, ~~plaster~~ ~~each~~ lime coated) as observed before at about -.90.

This goes down to pure rubble, with no apparent sign of the -1.15 floor - to be investigated further.

From S. trench, low (had above black clay) - fragments of gray plaster, cherts, with red paint on one surface.

Floor of upper structure slopes a bit to west, from C ± - but this may be elusive - plaster does not show in this part.

Bails are worse again.

(mru)

Burial #3

Wednesday April 22, 1931

Burial #3

The East skeleton (S.E.-1-30) being covered by slabs, a little fallen, is in a much better state of preservation than the West skeleton (S.E.-1-31) except the cranium which is completely gone and which extends to the west chamber of the grave. Skull probably destroyed all the feet - at least one tooth and fragment of lower jaw rest on the lower jaw. Back bone is apparently complete and in position. Skeleton obviously that of a child. It lies flat on its back and bones are jammed right against the sides of the grave which is very narrow. See sketch and photographs to be made. Obviously an articulated burial. Bones fragile but fairly hard. Nothing but dirt and an occasional small stone on the bones.

Saturday April 25, 1931

East Pits:

East Pit Plan

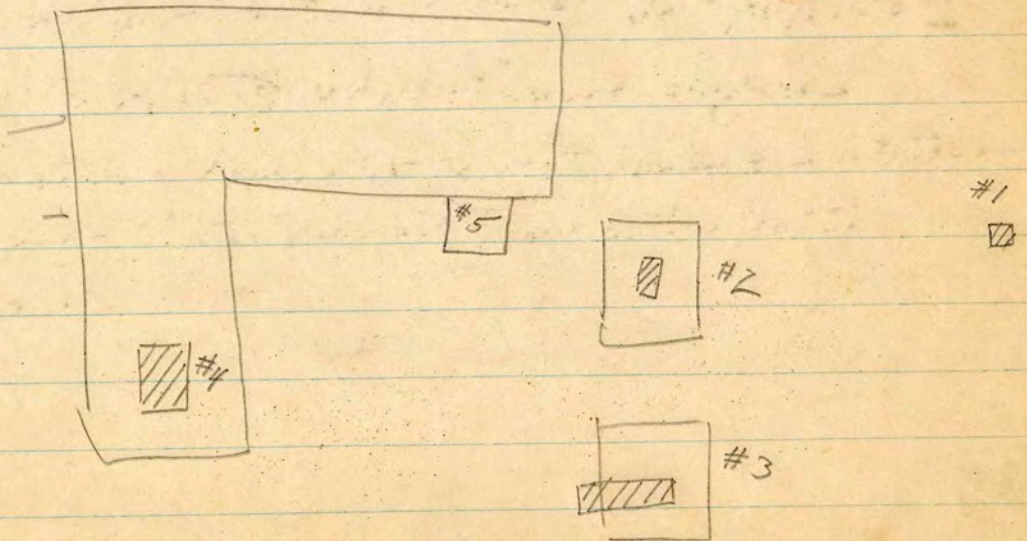

Child's body is jammed tightly against each side of the grave. Side stones rough and irregular, one layer resting on soft dirt. Both femurs articulated with pelvis. Right finger bones actually under side stones. Bones complete, but very soft (it rained two days on these skeletons) Ends of long bones separate at a touch. Body rests on floor of small stone, ribs are in natural position, body was undoubtedly buried in the flesh. Body was laid flat on its back arms extended to the sides. The wrists as found under the edges of the pelvis, only a few finger bones remained.

The West Skeleton (adult) very badly decomposed. Probably buried in the flesh, but fragments much disturbed, she sketches there is a general impression that skeleton lay on its side facing west, but this is by no means certain. The skeleton lay on a floor of rough small stones.

I've polished ~~red~~ sherd faceted red HHT on yellow slip found right with tons. Design band.

No objects with either burial except adult had one hand tooth with green-stone insert.

4/26/31 Sunday - all day making sections from notes & sketches - still to be completed.

4/27/31 On Acropolis: 3 men clearing back of acropolis for survey. 2 on Temple 6 (most time spent felling 2 trees in front of SW driveway.

2 men finishing test cut Street #4. Take photos.

Made sketch + study of construction of Str. #3 (see drawing for notes.)

April 28 Feeling lousy.

whole gang (7) on central acropolis temple (began late yesterday

P.M. clearing from both sides - believe no lintels.

Probable Plan:



Much delayed by trees on both sides.

yesterday worked like hell; Made sketch & study of stone in Street 5 cut. - P.M. to SE group. Took levels, made rest of cross-section.

After dinner developed - all overexposed except when I used Weyer's justaphot.

Apr 30 Feeling lousy - bark. W end up late in a.m. - 7 men on central

acropolis temple - Photographed "N. side", sketched stucco.

There is some bending of the corner at NW.

A slab roughly squared, evidently used in the building, shows a rude engraving of an animal. Must be 20 dimensions of lot. ~~Slab~~ spend P.M. in camp, printing.

Have cleared most of N side, about  $\frac{1}{2}$  of rough - Believe no lintels. Chief does see any point in excavating temple itself as too narrow for an altar. Had intended clearing this small structure completely. Will penetrate door ways to inner passage at least.

Apr 30 cont'd

Re SE-1. Painted sherd collections: from above Room A floor, show many more, but:

The level below ("washover oldest structure") has painted sherds duplicating the techniques above, apparently - including block outlines.

However, from below there are no instances of actual human or other figures identifiable - and no engraved sherds, of which there are several beautiful types from above. Not forgetting however that Louis excavated Room A + Tierce below - and a much larger area at that.

I am quite sure no painted or engraved sherds came from the upper structure: but practically none were found.

My the fine ware from this site certainly is not duplicated in more than a tiny fraction, if at all, in the west group excavations. Also I think (to be checked up) not duplicated in SE 3 or SE 4 tests.

There is some evidence of bonding corners in W2, Shurt 1, but not nearly so much, and especially, the walls there are not made of slabs below the arch.

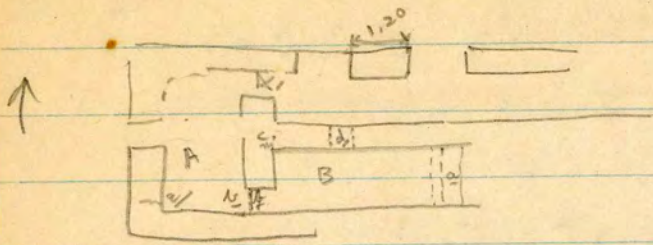

Room B is formed by walling off a larger passage at  $\alpha$ , with arch for effect. - plaster runs right by this wall. The doorway to A was also later walled off by the thin & poorly constructed wall at  $\beta$ . <sup>Pl. runs through also.</sup> The structure of this doorway:

The transverse arch is carried across the doorway by plain roughly work of lintel stones - one is at least  $1.10 \times$  only  $.08 \times$ ? + further in shingles over another, lower.

See E & W:

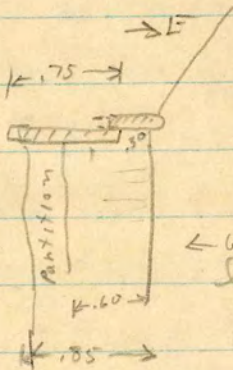

Plaster from there is not another piece of the lower one broken: at least of 20, it was plastered over as shown.

← Well bonded - But sometimes by use of a large stone - i.e. long both way. However,

too much  $\square$  for chance. - dis excellent shape

The mortar & plaster in this structure extremely well preserved, even on inner exposed surfaces.

The Ely lintel stone above extends far into the wall at V: it is broken as is the other, but says only slightly.

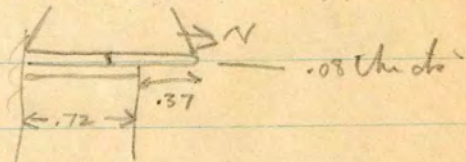

The arch at this end unaffected by the doorway:

There is a little half-hearted bonding at

$\alpha$ , but the 2 walls are parting. nothing like the corners



- i.e. - <sup>voued</sup> arch with 3 slopes

Booms

Passway through center wall at d. - lintel on offsets, thus:

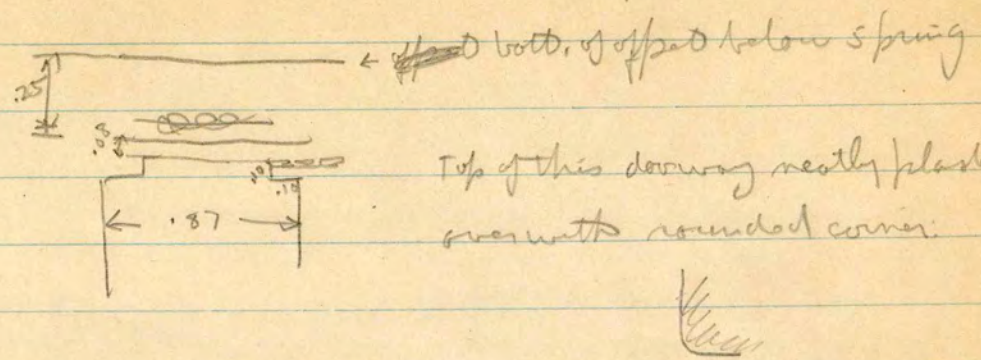

13 The secondary partition wall a is made of small pieces of slabs, in marked distinction to the heavier or lateral wall at its sides. Even so, the slabs in the transverse wall proper are smaller than those in the central longitudinal wall. - may lengthwise be: .35 : .45 - & many of the larger ones in central wall.

14 2 the 2 walls are sufficiently rounded so that the end wall, in setting, has slop stones attached to the central.

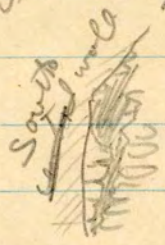

Remains of N half of arch <sup>only up to doorway from W,</sup> + large slabs projecting from S but still in position, indicate a lintel here. (cornice?)

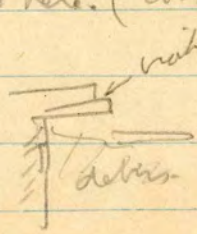

5/31

Yesterday, 2 men below on plaza on "N" side of acropolis. This is about the same height as mound #2, but unexcavated with id-separation of <sup>very</sup> steep natural hill. There might have been a wall & path?

Str  
1-24  
1/1

Men clearing for a surface section of long structure which borders the "E" side of this plaza. Apparently remnants of a low plaster floor, about 30-40 high-rough, walls @ SE similar to top structure section, though hardly so good.

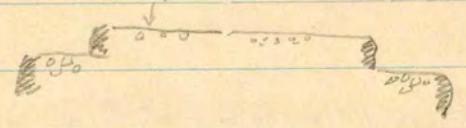

Rest of men on Acropolis central temple. Took chief over the N side & top. He agreed might be stelae or tenaco (or fallen from it) in part of false pyramid "E" of ravine bordering the main line of debris from the summit. This a.m. ok's clearing a little.

This  
piped  
me  
LS

523 Asked if I shouldn't clear the central (S side) part of the central temple he thought a long while and said no, because it is too narrow for an altar.

Started men clearing "W" temple pyramid.

Today:

Continuing section on N. plaza, nearly done (8.30) - clearing above pyramid; quite a system of walls, perhaps a stairway, on the "W" side of the pyramid. Balls me up for throwing dirt.

S

Engraved stone from Central temple. (Sketch) - from laws in the  
 ruin at "NE" corner. dimensions:

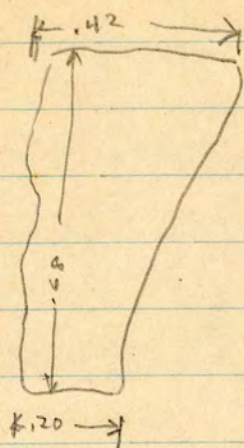

- Roughly shaped.

Made Plan & elevations

9/4/31. Stela 40 groups.

(S.W. Clearing terrace. Yesterday located Stela 9 basin position).  
 Wall of curb in front - Louis misunderstood this morning, removed  
 "W." side of curb, apparently. Went down & removed incense  
 burner with cover at pond base of stela. - his report is clear  
 however: was tilted only slightly forward. appeared, clear of dirt,  
 when he removed a large irregular stone. - Tilted ~~confirmed~~ contents  
 (turned capitol) confirms him in this. Stela leans forward very slightly,  
 incense was held against its "S" face, bound in middle, resting on a  
 stone & plaster "floor" apparently, with large loose fill above it.

See sketch:

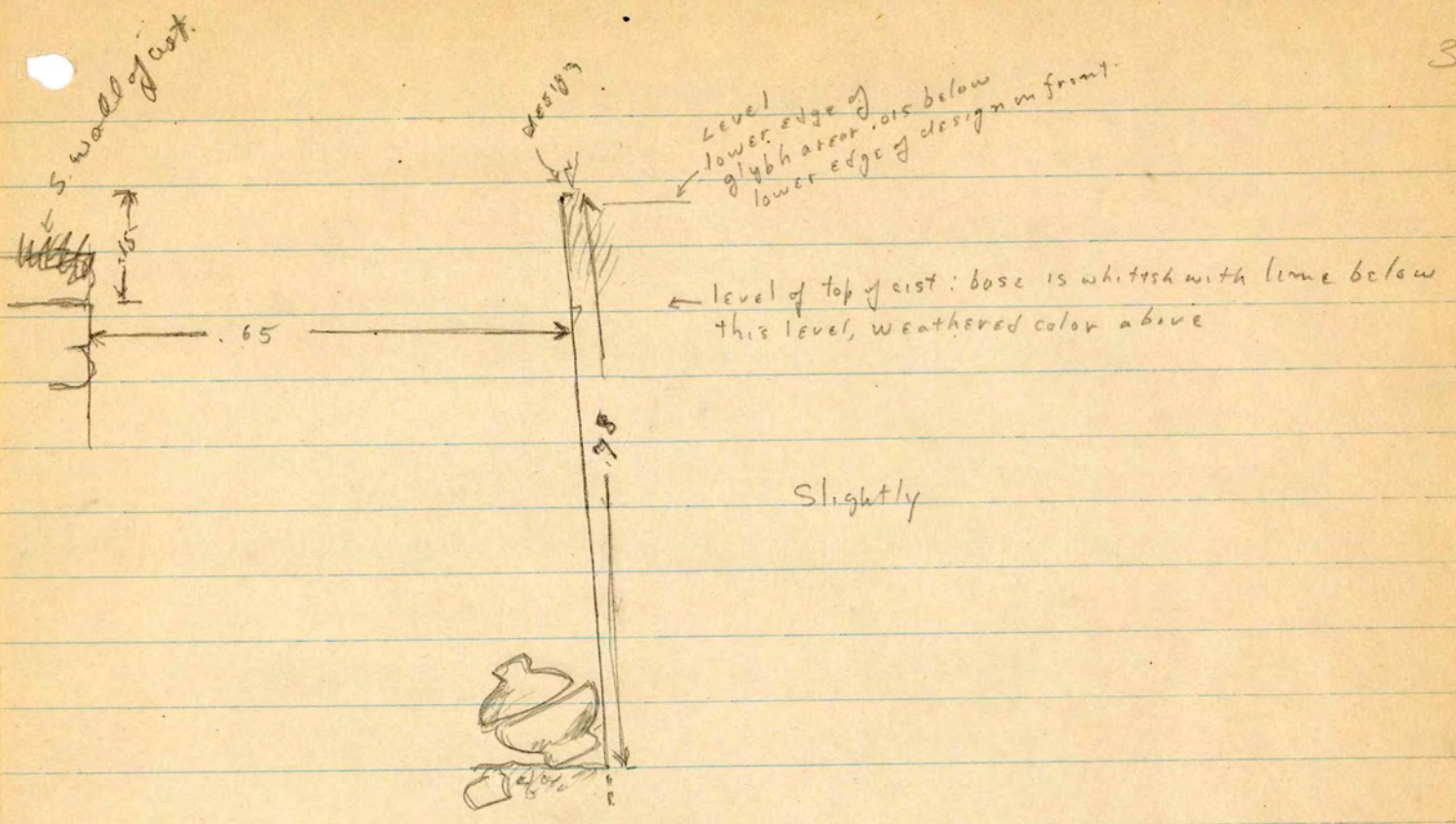

Slightly convex sides, flat back & front:

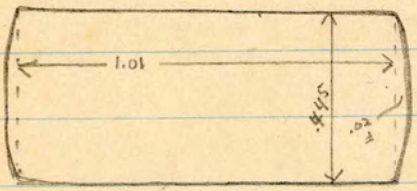

Section - front of Stela 9. → "N"

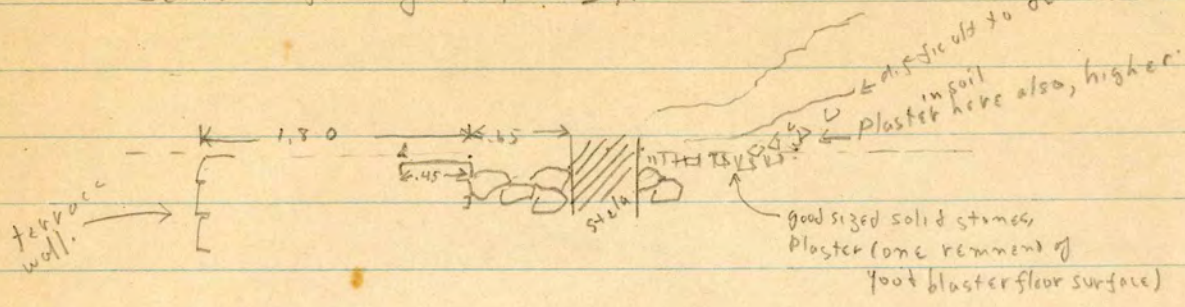

From the plaster & stone - presumably floor) about 1.00 behind stela, a large double pointed chipped blade, and "lodd" handle - animal head?   
 also base of long (skin?) bone.   
 n. - about alleged floor level (based on terrace edge & lower limit of inscription on stela.   
 4000 p. 47   
 Masum says broken here (?)

From higher (.20 ±) + .50 back of these, another similar blade.   
 From about same distance back, but 3.50 meters "E" of E edge of stela, another (broken half) of chipped knife, larger.

A few large coarse sherds in leamery surface of terrace - on with plaster ~~adhering~~ adhering to it.

Wyer starting colour down front, & to locate walls, possibly a stairway leading to nothing much, on river side.

Wyer shotted Maller's level: on surface. Removed 3 pries found to bottom - figure handling stuff - all shot. Probably rd hand (Facing temple - below E end of <sup>lower</sup> ~~higher~~ plainly projecting corner of wall. Left stoke but can locate position anyway. Had rope to look more with men below.

Final Note:

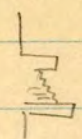

See sketches for this type of cornice: also identified on Structure 3 in two places; on the "E" wall of "E" studios of Court #3 ("Upper") near junction with shukun below Central temple; a bit ruined but probable on Structure 1, lower court; and on side of Temple's rooms nearest Stela 9, + also around corner ad front - the only remnants of cornices I recall.

|| - Check to see if it can be seen on standing wall "N" side Campamento Playa.

9/5/31

Stela 9: - Tool marks on back: In used marks .01 to .02 deep, more or less as indicated. And in shaded area, a section like this

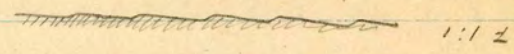
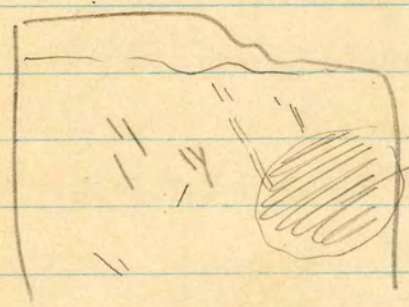

(.001 to .002 ??)

Small piece of stucco 12.50 M "W" of "E" edge stela 9, close to base of pyramid, in plastering wash above terrace floor level - with traces of red paint

Obs:

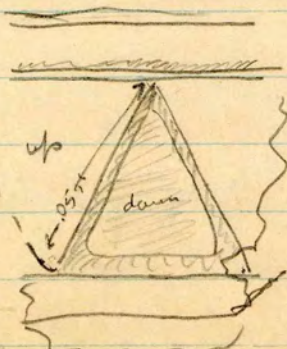
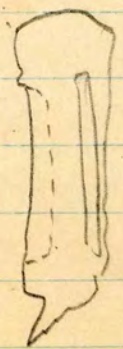

See map for location

Stela 9. There is a large quadrada thus:

Stela 04 = 1.00

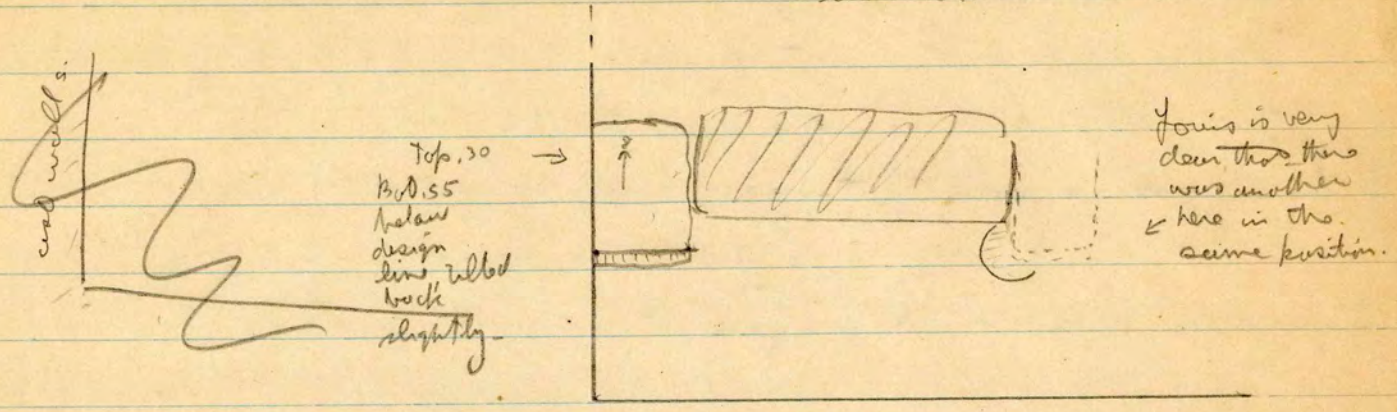

rests on ± irregular stones.

The "loose" fill behind the stela, at top, is cemented to-gather like iron.

This was not so in part says Louis.

Can't find a rear wall from the inside - but is a line of stones in the curved position using .10-.15 above this tough layer of back identifiable from above. and tough layer continues at top level of this "wall" toward the stela.

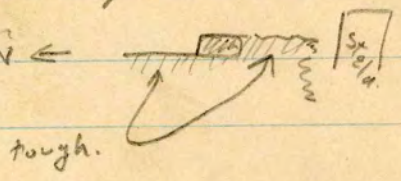

4/6/31. Clearing terrace & looking for Stela 9 wall. Drew sketch 5; look photos.

Removed Stoa chum - rested on small stones & soil which made up the floor of the east, see photo .10 ± under.

W-11-10-0 Broken Plate - terrace, 7.00 "E" of Stela 9, 1. M. from apparent edge of pyramid in soft dark earth, stones &c - above any real floor.

another: 1 M. further "E" (.50 near terrace wall (i.e. about 2.00 in

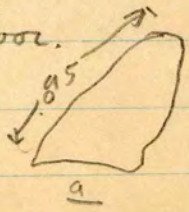
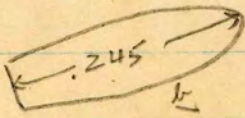

135  
590

Blade "e" -

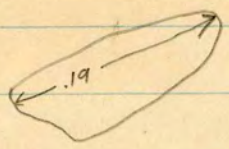

8.00 "E" of Stela 9, 2.50 in from terrace wall

Blade "p"

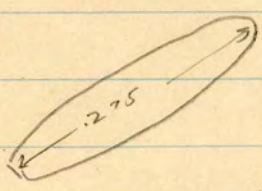

7.00 "E" - 2.50 " " " "

These are in soft <sup>dank,</sup> soil, broken stones, ~~is~~ paving floor. Nothing else around (same for others). "e" I dug out myself.

5/7/31

Blade "e"

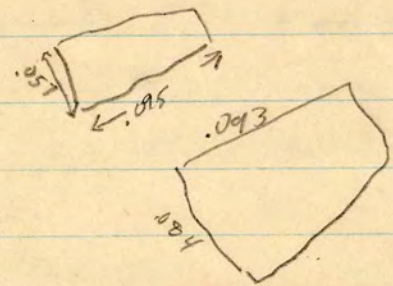

8 m E of Stela, 3.00 N of fence wall.

"g"

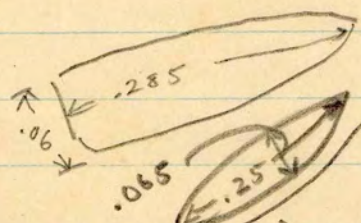

9 m E of Stela, 3.00 N of "

.90 "E" of Stela, 1.10 behind.

Blade "h"



2.40 E of Stela 9, 1.30 behind.

Blade i

"Cover" "#"

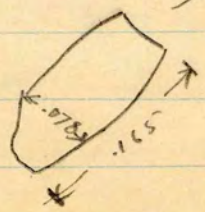
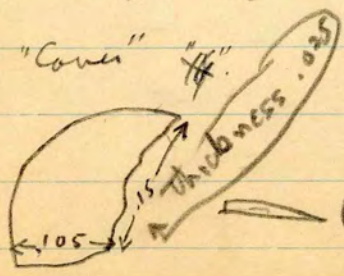

(discard doubtful)

Common Cornices at Yachilan

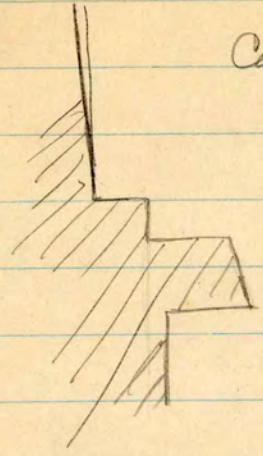

One:

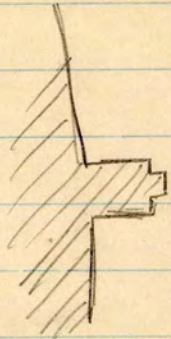

Str. 41

One:

larger usually than ours



Str. 1

One:



Str. 21

+ See Sketch Book

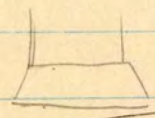

Spent good part of am. with Ruppert, on Acropolis + Ball Court (S) - found missing base msk. in line, in floor - not a perfect circle, a bit broken. Undoubtedly had been sculptured as the had that as append.

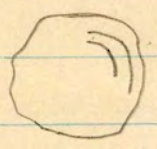

Could find asd for 40, but find an old terrace wall inside the other - must make a plan, Weyer never will.

Located asd for 11. - seems to have no rear wall.

More blades as noted above.

Small Lacandonia <sup>in center</sup> <sup>w-4-12</sup> fragments, exposed at surface (but under the ~~sett~~ roots near S of 11 cut).

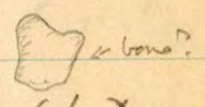

Can't find the face. Too hot. - so: \_\_\_\_\_

difficult under the tree to

make absolutely sure - not with more lines

terrace (made the same colored line)

going back around stairway of pyramid ("E" side).

Worked stone fragment about 2.50 E of the stairway, d. 0.00 to 2.00 in from front of stairway; Sec's.

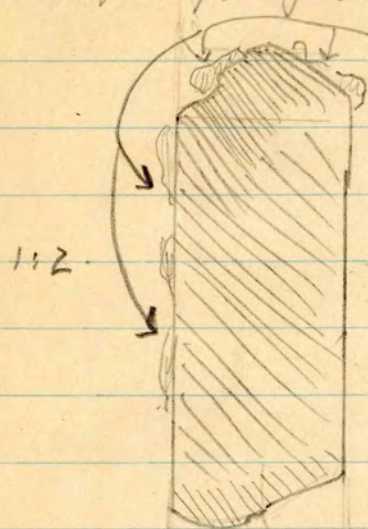

Plaster remains on parts of this.

Lime stone.  
(W-4-11)

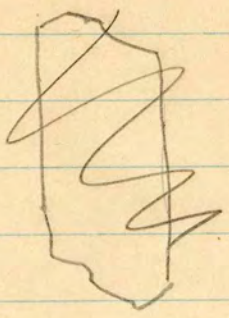

See Holmes or Gamm.

8/31 Followed up old terrace wall to #9 and; believe it was broken off by the later. Only place I'm dig, where should have picked it up is in front of the "platform" (see map) to the "W" - it isn't there. Possibly another circumstance pointing to this as the source of No. 40.

I should have felled big chicken tree am searching between platform + terrace wall.

I have located #10 + 11 walls - but not complete enclosures, as yet at least. Still clearing 2 of main pyramid stairway.

Started Plan.

P.M. Photographed Sela 9 base, old terrace wall

found stairs - very good

Chipped blade - .50 in long of lanceol. stop, on floor, 2.00 E of Sela 9.

-has flaked back:

(W-4-10- $\frac{1}{2}$ )

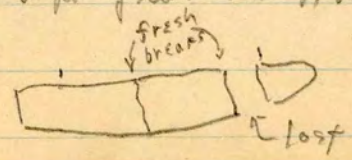

Between marks:



Note on Central Acrop. Temple:

Two slabs from lawn in the "NE" corner debris (ruined) - probably noted before:

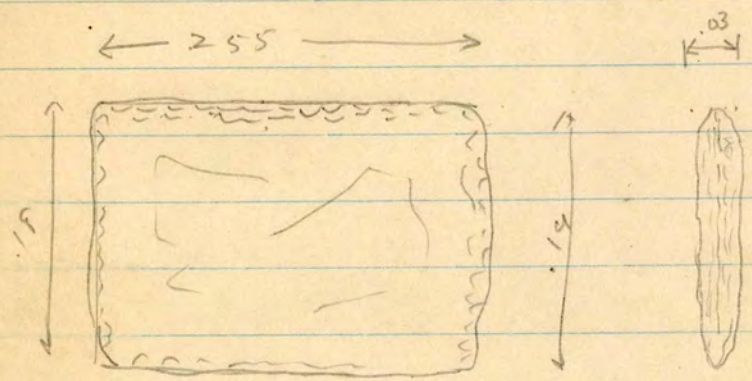

Another, worked around the edges the same + entirely similar, dimensions: (Limestone, both.)

5/9/31

Broken Blade Fragment:

W-4-10-K

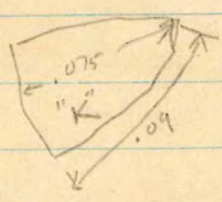

±.10 head of lowest step, - 5.00 "E" of Stela 9 - on or above floor.

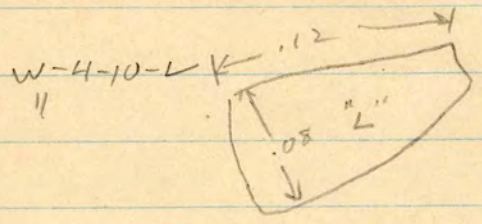

±.10 head of step, 7.00 "E" of Stela 9. at least .20 above floor.

There is no question but that blades occur above the floor, in the wash, as which near floor level is a mixture of small broken stones, light grey sand (much plaster in it). The knives probably came down from above in the wash.

Pattery face fragment - mouth, part of chin + nose - red clay - very fine: from above floor, near "E" wall of stairs 1.00 to 2.00 "N" of stair front.

W-4-13

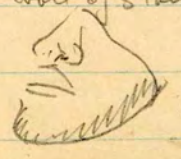

5/11/31

W-4-14 - Painted, 1 glyph-engraved sherd - from brown soil under terrace floor at back corner of 'E' side wall of stairway (see sketch to be made)

W-4-15 - Misch. sherds from clearing stela terrace - none under covering stela - finished to-day: <sup>run contour</sup> main line to top of pyramid -

# Ho Temple probably lines up with base of stairway - ~~Several~~ fine fell short down from edge of projecting terrace, 2.00 "W" of probable seq. of temple.

Dug at <sup>E</sup> corner of stairway (back) - photo - sketch to be made

Made drawings of lower steps - cutting in floor apparently under stairway.

Cutting in at <sup>W</sup> side of stairway.

Yesterday printed for boys: developed 24 films - went around with chief photo graphing.

5/14/31 - Been working on stela of Pyramid - notes on sketches of which there are plenty. Also made sketches.

Am ready to clear above <sup>4<sup>th</sup></sup> 3<sup>rd</sup> terrace to-day, except at E where am digging out main terrace further east. The plaster drops in depth as you go W from stairway wall.

Also digging in top. Looks a bit like 1 door. Structure seems extremely filled with embossed - not a slab yet - walls terribly shot inside. Near section bolted right to top

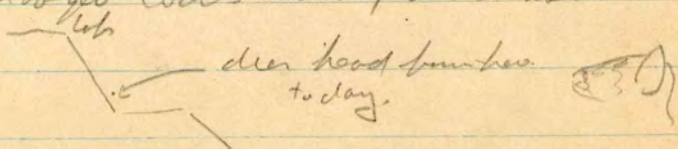

5/10/31 - cont'd.

Broken piece of top of incense burner  
in debris above plaster wash,  
main tenaco. Also piece of  
Piece of flat bottom bowl, plain.

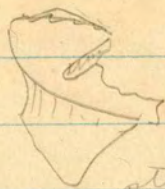

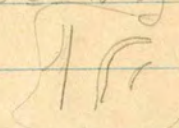
same type as stela 9, found  
2.00 ± "W" of wide stairway,  
stucco.  - very likely glyptic.

Figurine - at edge of 3rd tenaco, 1.00' W of stairway.  
- no features, head has filed to its left

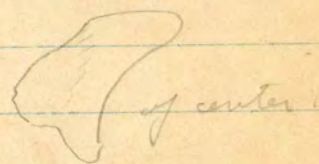

5/14/31

fill for stairs?

From around here, knife point  
1:1

4.45 Tenaco

6.5.

L. under .065  
W or base .05 ~  
Thick " .016  
Partly white, no glaze  
fairly well flaked

5/24/31

The wall at 12.43 (base) is much shad, rises to the center (far and followed, from the E) to  
1.85 + more - was vertical, no doors, 2 or 3 lights, resembles to 5th. 1. Group. at center leans  
slightly in, but fall out everywhere else. Certainly a good + small stone floor in front of  
it

5/23/31. W. 4 temple.

Stucco on west side, about 12.43 level, bed way over (10.00 to 12.00 from line) in debris - mostly under large tree. Everything much jumbled here, no floor established so far out. The stucco shows use of sticks (2 or 3 dia +) & small flat old fragments, but not sherds. However, only 4 or 4 pieces recovered.

Figurine head on the 19.65 platform in part of upper structure, what ever it is, very flat head.

Long narrow face,  
"nose clean to forehead."

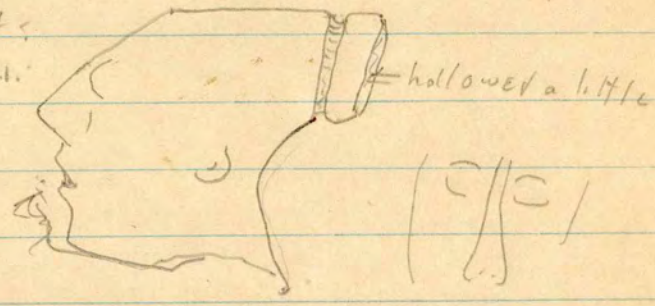

Figurine, complete from debris about 18. level, E. side, about 2.00 behind 19.65 wall + 1 or 2 m. E of side wall of upper structure, extend 4

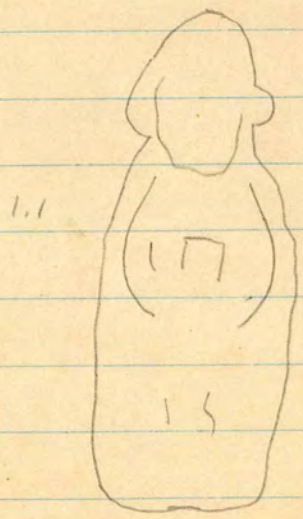

holds something

(See another of these, p. 38)

Stucco plaster sticking to small slab fragments on the 19.65 platform, part also a couple of heavy shreds suitable for <sup>stucco</sup> plaster tempering, but no plaster on them. Also one brick of the old "burned clay".

Another piece of stucco about 16.85 level, above the other - and here appear to be steps - if they extended toward the center they are level

- On piece of stucco with 5 level.

5/25/31 (Monday)

Furnishing up Pyramid - Staking ball count.

1 low piece of stucco ornament from E Side in debris about 19.00.

(A few only) pieces of red clay (red orange, blackish sands, one showing mark of small hole found at level, digging in on 19.65 level, about 3.00 in. ||

Also few plaster-coated sherds, one sherd negative hand red on yellow slip.

" Broken hollow figures, very curious.

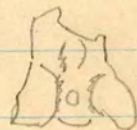

could be a bowl (turn upside down).

5/26/31

Furnishing up S Side of Pyro. - working on ball count.

On E side of Pyram, going up down, cannot find a wall - have dug in for into fill. This side, especially high, seems to have fallen completely, leaving no stair way to protect it.

The back is in better shape - section to be continued.

When the pyramid joins with structure backing the low platform of Court 1 (N. of NE corner of Pyramid), there is a beautiful example of open cornice, but the upper member is badly displaced. to be photographed.

The west side of Pyram, beyond my section, slopes down a supposed large stairway to a jumping off place.

a long triangular platform, at least 10.00 } its base was to south  
or a little S. This was to have been mapped by Weyer & he started it

The stairs have a dead end toward it, but well behind it. There was probably a

platform which at the E side, below my section somewhere, which has fallen the

in the form of a stairway.

## Dr. Mason's Notes on Structure 13 (Stela 9 Pyramid)

- 23d: Men clearing slope of terrace between Steae 40 & 9; started work in center.
- Steps are similar to the upper stairs of great stairway, but without terrace or large blocks at base. Stones much disrupted, doubtless originally covered with stucco.
- Width of last ~~uncovered~~ step near middle of terrace: average .30, average rise .23; grade about ~~35~~ 35 per cent.
- So much destroyed that everything is uncertain. Apparently pyramid in three terrace.
- Upper terrace is widest and on it stood Steae 9, 10, 11. Retaining wall high, at least 220 cm to level of upper terrace from probable level of middle terrace..
- Middle terrace was apparently about same width, 2.20, but top of middle retaining wall destroyed.
- Upper wall has slight batter, but practically perpendicular & rather well made with blocks with straight faces. Apparently continues behind staircase which was built against it. Two sides of staircase difficult to find as slope of same grade and height all over. But apparently edge of staircase is at about 18 M. from apparent east end of terrace and pyramid face.
- On W. side of staircase upper retaining wall continues for about 12 M. from apparent ~~east~~ end of staircase, this side of staircase being even more difficult to determine, but end of wall evident where it ends in natural hill.
- Width of staircase about 8 M., but undetermined.
- Terraces to east side not cleared, but from top of upper retaining wall to top of middle id., horizontal distance is about 4 M. as against 2.2 M to west. This may be accounted for by batter of unexcavated and broken walls. Neither upper nor middle retaining walls excavated here, but lower terrace seems to be about 2M. wide, possibly 2M. above level of Plaza.
- On the east east side the structure is a little
- Retaining wall of middle terrace very poorly made of rocks without flat faces. Apparently about 2 M. high.
- This lower terrace is uncertain and may be visionary.
- Middle retaining wall on other side, which can be followed across steps (?) for some distance, does not seem continuous with this. Also no edge of stairs found.
- No lower retaining wall found here, and lower wall of terrace to west uncertain. fill
- Yet rubble floor seems to be reached at about 1 M. above level of plaza. Nothing certain here except upper retaining wall.
- Left this for further work.

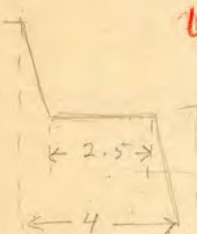



5/2/31

Bull head - S. front.

to which center, "w" from center base.

S. head wheel, middle of platform - a broad s. head -

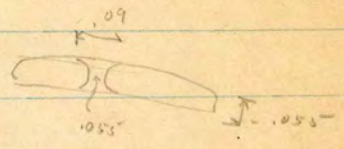
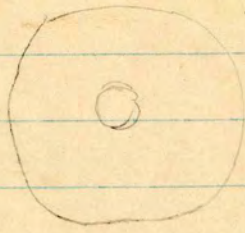

of helix was an engraved slot on

E. side - only was anything like it's any here - to chain.

Punch & any was barely

Mamma - @ Bolson

Men - Jotunbi

✓ 4 Picks.

1 adze.

✓ 1 Barata (

1 box with contents

✓ 1 Shovel - long (hook).

✓ 1 " short

✓ 1 curved :

afternoon - to camp Bolson

on hill

- Joba.

3 Picks - a bolas.

1 Pick

Female

3 Shovels, short.

1 Shovel, short

- Hatchet  
knives etc.

2 Axes.

1 Shovel long -

Louis B. Santamaria - Calle 64, No. ~~602~~ 613

Calle 64 # 613

Merida

Yuc Mex

Carmen Acoba Tenosique.

Annesetta ~~his~~ Jimenez, Tenosique

~~E. P. ...~~

Erni Quintana - no location

5/30/31 - Ball Court, 5 groups

- From digging below <sup>plaza</sup> floor, end of W stair way.



Black, mixed about .04 th.

also beautiful fluted beads.



Faustino - photographs.

Box 3

Notes on Serial # 3. - SE-1-30

E. body - child - rear (4<sup>th</sup> molar present but not excavated (one side is broken & shows the tooth (rd) - top and the tooth can be seen about .002 below the sides of jaw.

lower jaw - Left jaw has 4 molars including the latter, & two shovel-shaped incisors, canine missing;

NO fragment, small, has the 4 molars.

- 5 odd molars.
- 1 - ~~odd~~ odd shovel incisors
- 1 - filed tooth, possibly post molar.
- 1 - large shovel incisor (must be from other body).
- No teeth worn

w Body

- 6 Molars, lower - not appreciably worn.
- 1 molar, much worn or filed
- Part of lower jaw - 3 large molars excellent condition, not worn
- Fragment of skull, 4 digits base of long bone.
- 1 Filed incisor mixed tooth, possibly 1<sup>st</sup> molar.

over

♂ body - cont'd.

2 large + several small fragments of paleris.

Femoral ends broken by preservation.

21 vertebrae, ± broken.

Fragment of ribs, of radius, ulnae etc.

Note on Stela 9 cont.: the "alter" or seed has knife marks on the top

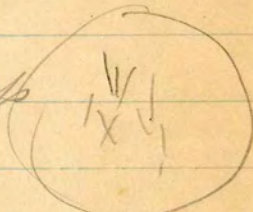

at bottom: .115      .19  
 " " " " - Diameter of alter: .225 x .21      top much sanded off  
 depth: .115      rough chipping of sides +  
    bottom - noticeably conoidal

SSE-1-10a - Burial # 2 - fragments of skull, of arm bone, 4 digits  
 + 1/2 of ornaments - see catalogue + prior notes.

6/2/31 - Burial mound, all 3 bases rested on soil & small stones. at the center, a shallow depression or hole in the soft bed rock had to be dug.



Several pieces of possibly sculptured man used stone

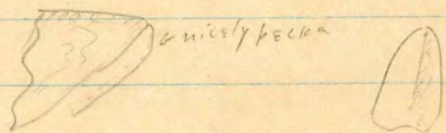

4/2/31

53

Genl. Note on Raspholis

W. Platform of court # I has a big hole at near (W) center, 2' high & deep for a tree, no signs of dirt thrown around it.

I am convinced the greater part, at least, of the slope of this terrace is a stair way, based on its appearance & occasional stones in position & large quadrilateral stones. Much more evident than opposite

3/17/31 Plate - Flints for Quotamala. Lens 1.01 from cloth  
 - E-1-6 ~~from~~ from base of pyramid (behind altar 5)

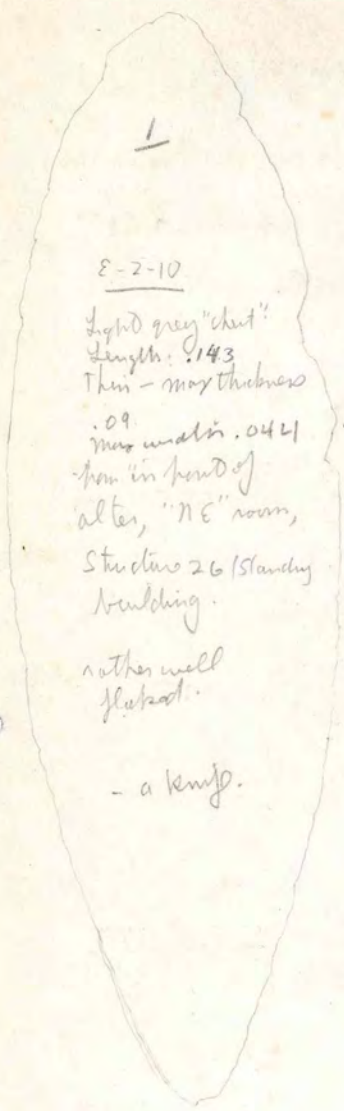
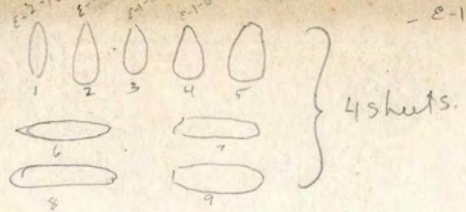

E-2-10  
 Light grey "chert"  
 Length: .143  
 Thin - max thickness  
 .09  
 max width .044  
 from "in front of"  
 altar, "NE" room,  
 Structure 26 (standing  
 building).  
 rather well  
 flaked.  
 - a knife.

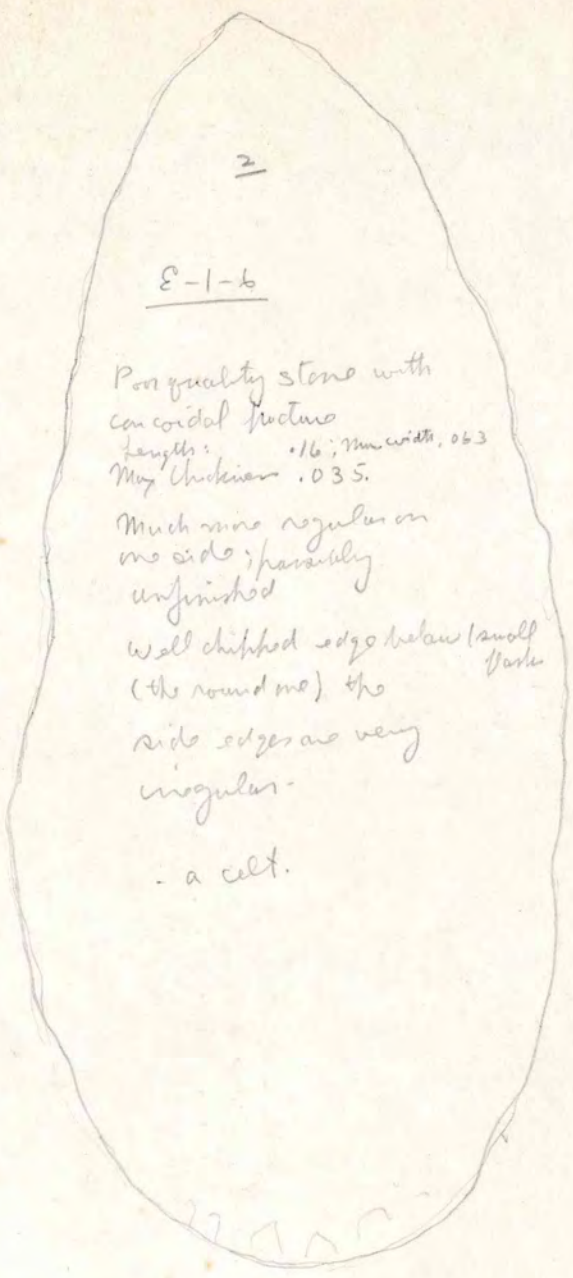

E-1-6  
 Poor quality stone with  
 conoidal fracture  
 Length: .16; max width .063  
 Max thickness .035.  
 Much more regular on  
 one side, possibly  
 unfinished  
 Well chipped edge below (small  
 notch) the  
 side edges are very  
 irregular.  
 - a celt.



E-1-6

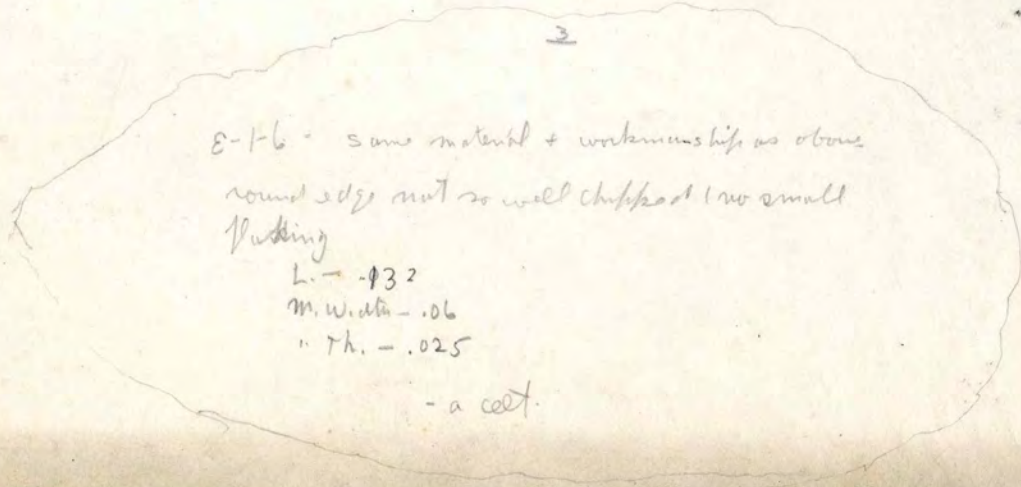

E-1-6 - same material + workmanship as above  
 round edge not so well chipped (no small  
 flaking)  
 L. - .132  
 M. width - .06  
 " Th. - .025  
 - a celt.

(cont page)

5/7/31

4

E-1-6

Poor quality  
stone, but  
better flaked than  
2+3.

Well finished edges  
below this line, poor  
above cutting mark +  
very blunt when used. - The  
line is of max. thickness.

L. .137  
W. .072  
T. .02

Very well tapered at  
cutting edge.



(E-1-6)

5

E-1-6

Smother stone,  
roughly chipped.  
knobby around  
cutting edge below is  
broken.

Side edges irregular

L. .14  
W. .062  
T. .025

Notes on the Plate: (to great credit)

W-4-100

L. .09  
W. .057  
T. .021

Makind - similar  
to 406 - has a  
truff white - has fresh  
break at top - the white  
is porous - inside is  
mottled bluish-grey,  
little red.

- ragged edge, irregular  
surface.

W-4-10-(f?)

well formed - good edges

L. .09  
W. .075  
T. .02

Very similar color to 512  
- also is a palmer - inside  
grey + pink, very soft -  
get a rough sandy  
surface on the fresh break.

Palmer - has cherty white.

(Saved a piece) -

5/17/31

6

Same material  
as 2+3. Greyish  
white, rough sandy  
surface, conoidal  
fracture.

- Well flaked +  
famed.

L 24.3

W .067

T .022

all edges very  
regular for this material.

Pound is below - shows  
thicker + blunt.

W-4-5 (30)

7.

Same material as  
3 which is hehubs,  
bright white - just  
as rough surface.

- Extremely well flaked  
all over, + very regular,  
much better than 6.

all edges regular, +  
sides remarkably  
smooth for this stuff -  
thinner flakes have been  
removed.

L. at center .075

W - .071

T. -.021

W-4-10-i

broken?  
same dirty color

5/17/31

8

Entirely similar to 7, material & workmanship

L-26 (as is)  
W. .072  
T. .021

Beautiful knife, except for the rough surface material, as

W-4-4

broken

1 x  
1 x  
1 x  
1 x  
1 x

Same as 7 & 8, but material is whiter, about same as 4.

L-168  
W. .077

T. .09

1 x  
2 x  
2 x  
2 x  
W-4-10C  
1 x  
2 x  
2 x

broken

all have same general appearance - no gloss, all rough  
8 & 9 are darker colored (more porous) probably than all others; 4, 5, 17 are lighter than 2, 3 & 6  
1 is bluish white & smoother than any of the others & distinctly of different material.

Units

28-29	Unit. 1	x 1
	Europe	x 1
	Pan. ant.	x 1
	Sem.	x 1/2

29-30	Unit 1	Blank →	x
	Europe		1 x
	Sem.		- 1 -
	Ing.		- 2 -
	Am. Ind.		- 2 -
	Pan. Soc.		1 1
	Geol.		- 3 -

Semester Hours.

1930-31.	Sem.	1 x
	Ing.	2 x
	Negro	2 x
	Pyramis	2 x
	Sem. <sup>Plaka</sup>	x
	Australia	2 x
	India	ns. x

April 12 -  
From where possible,  
Brunon in hand.

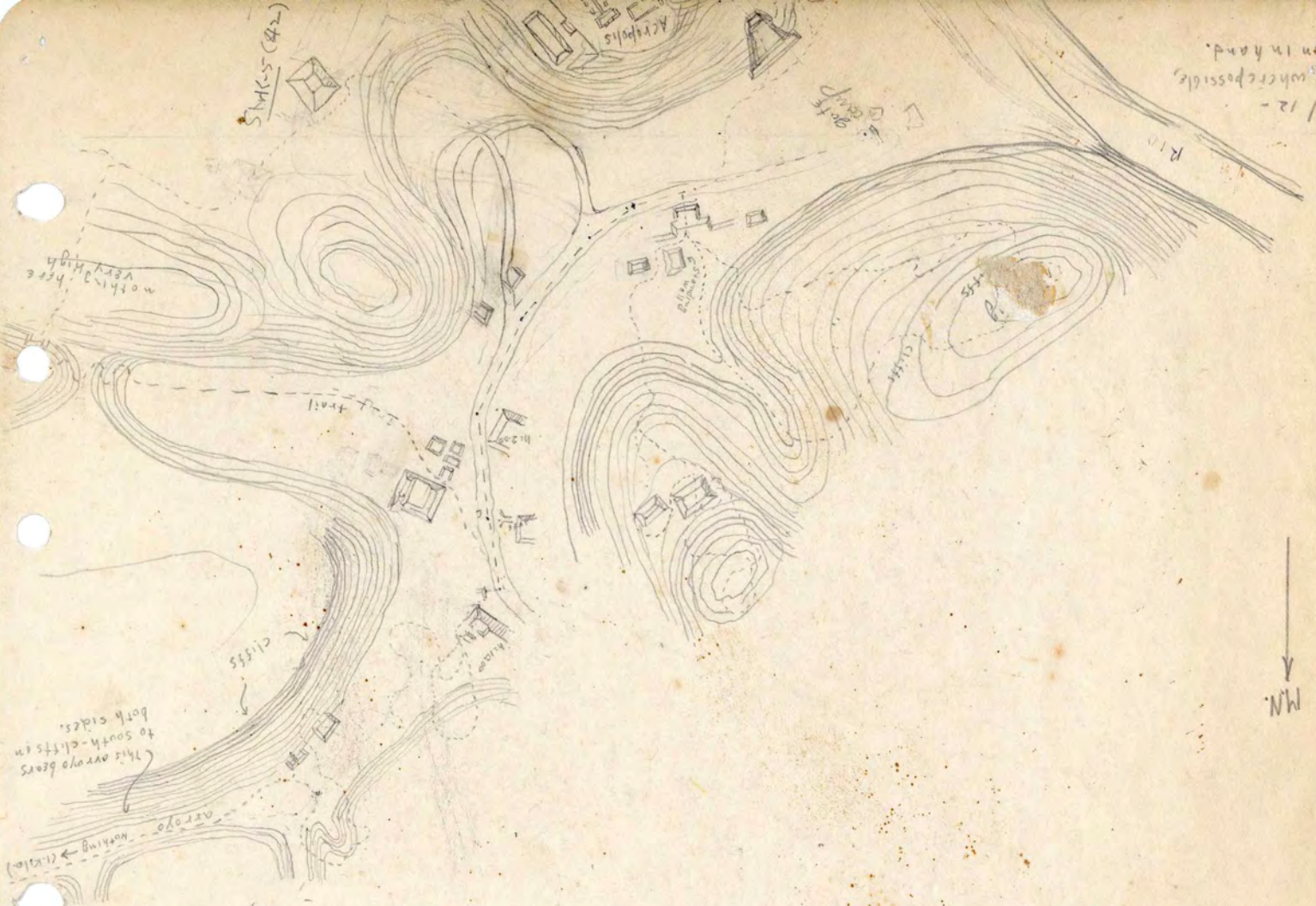

SMK-5 (42)

Map of

Campamento Valley  
both sides of trail

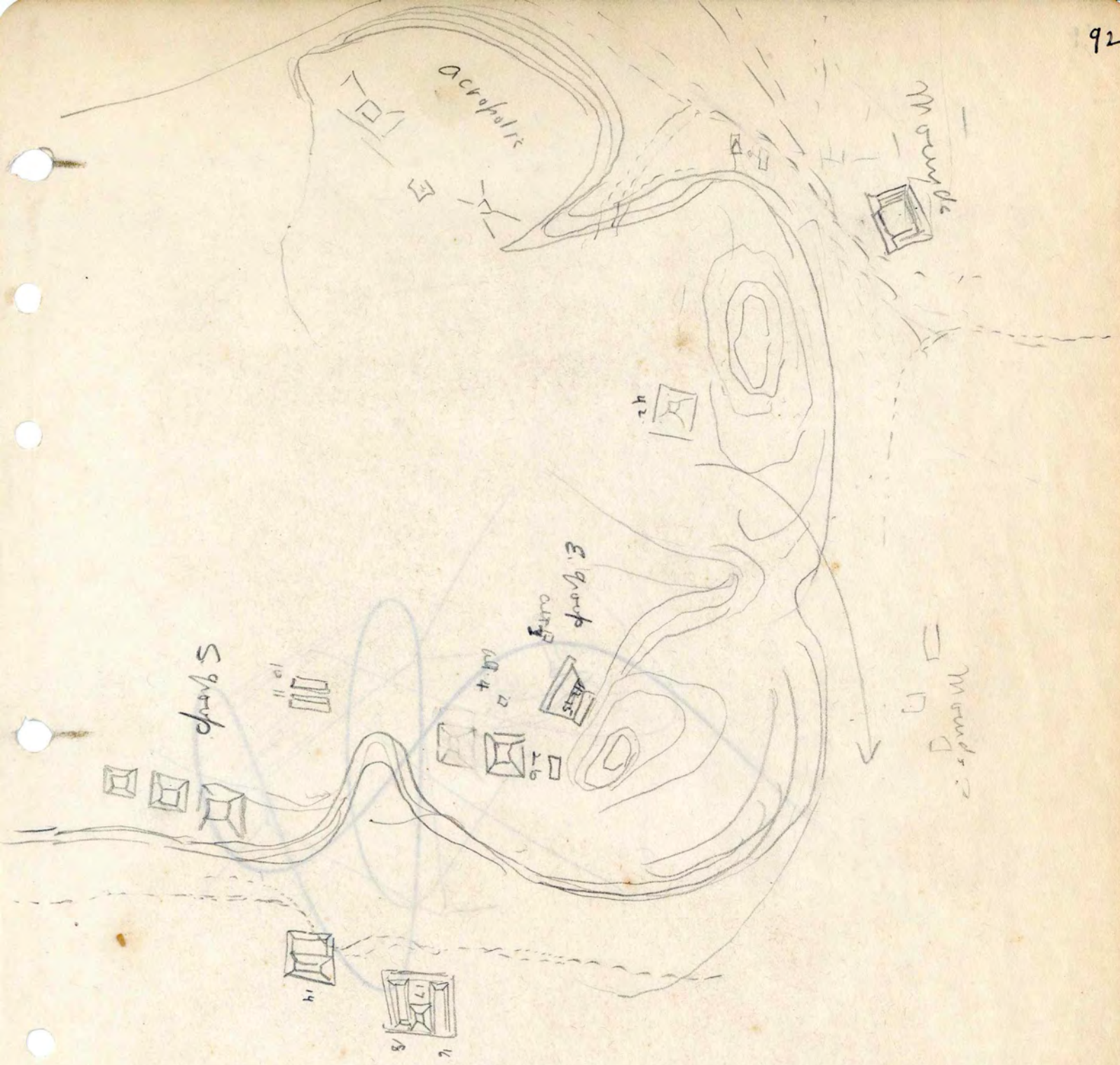

Mound 2

April 3, 4, 5, 1931

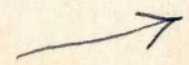

Example

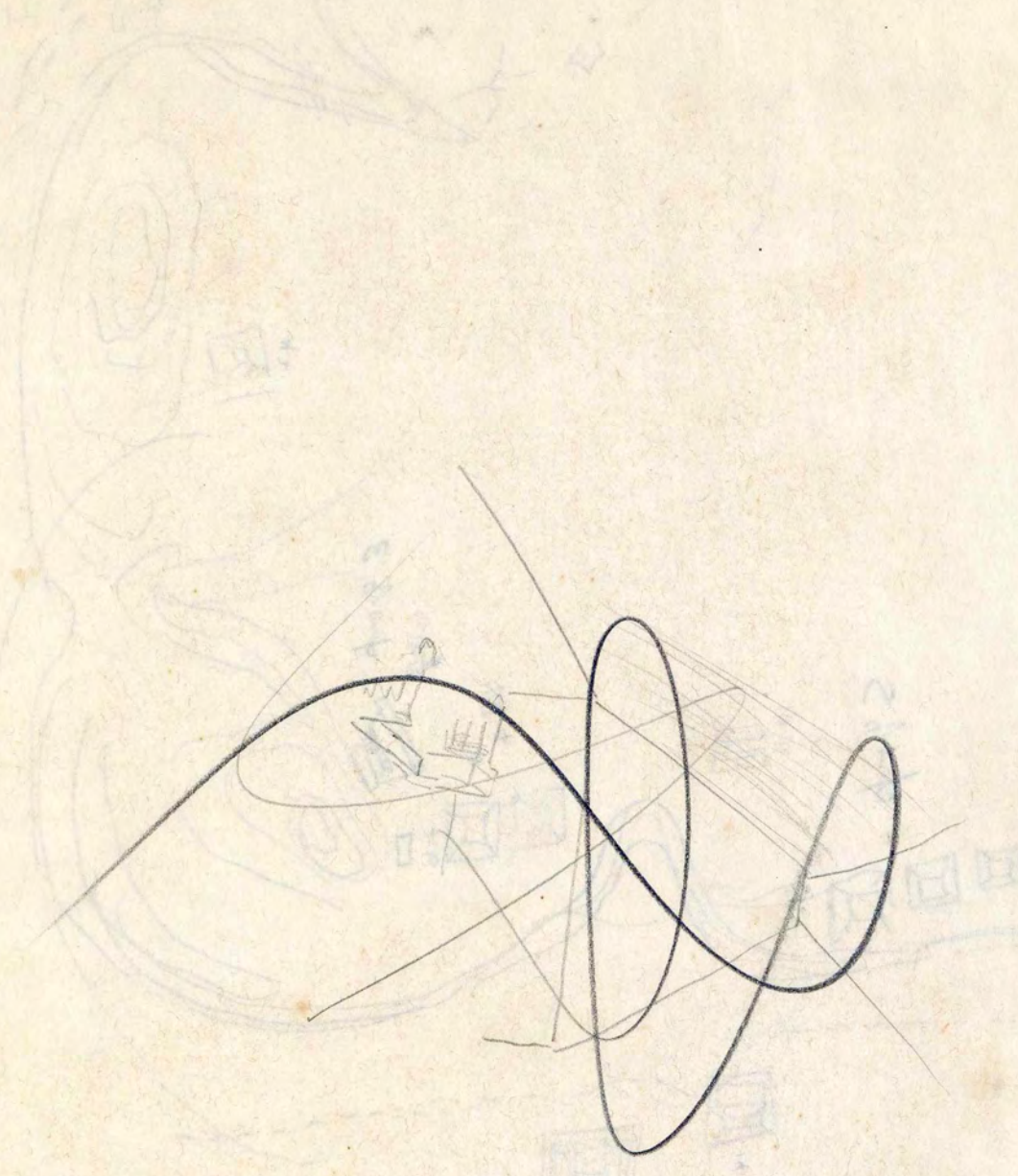

1871 3+2 1181



W. J. ...



△ Sac. Rock

R 10

Feb. 24: Explored & found N.W. group:

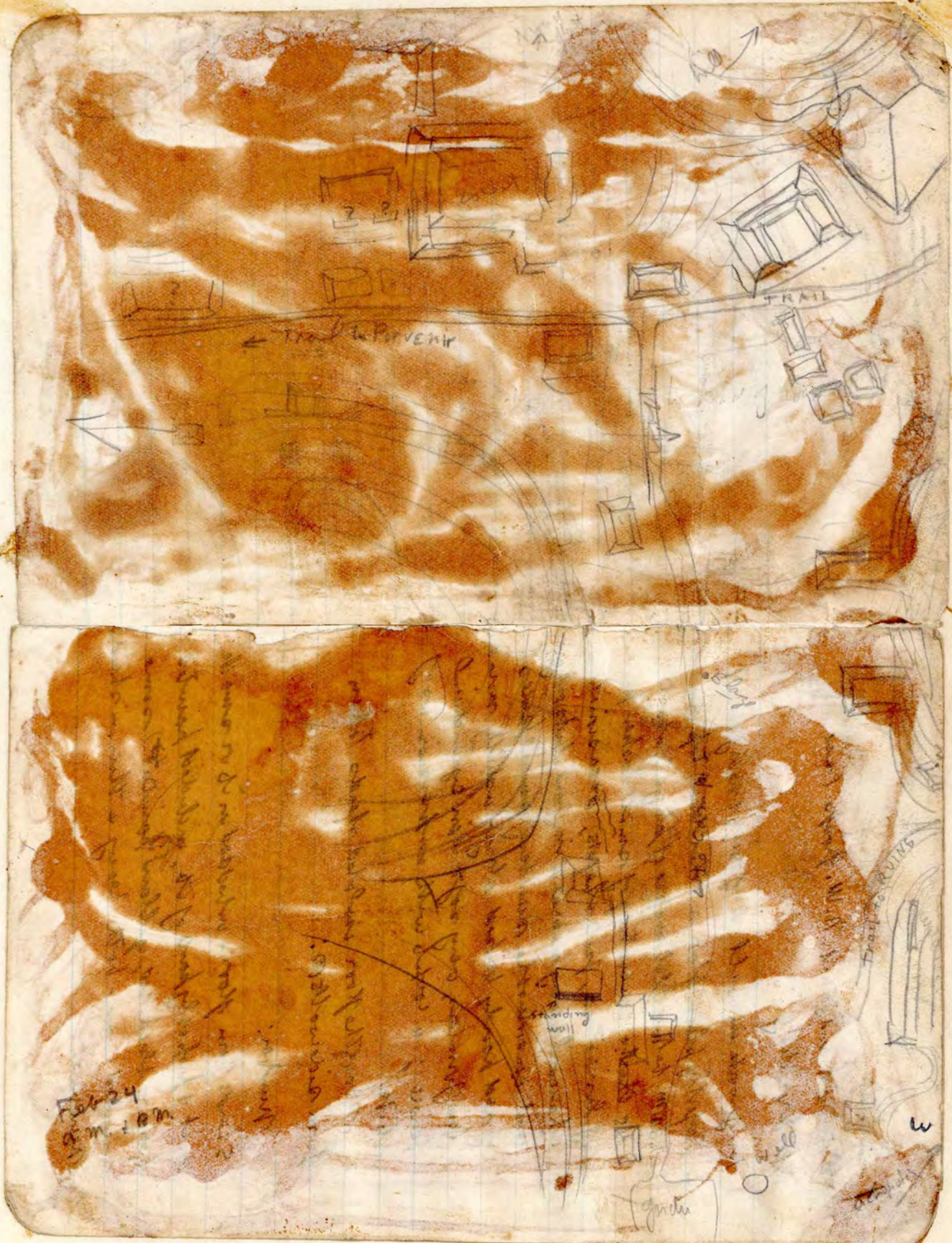

April 11 (?): S.E. Section



Camp plaza:



Feb 24

Review map

See Planing  
Mtz

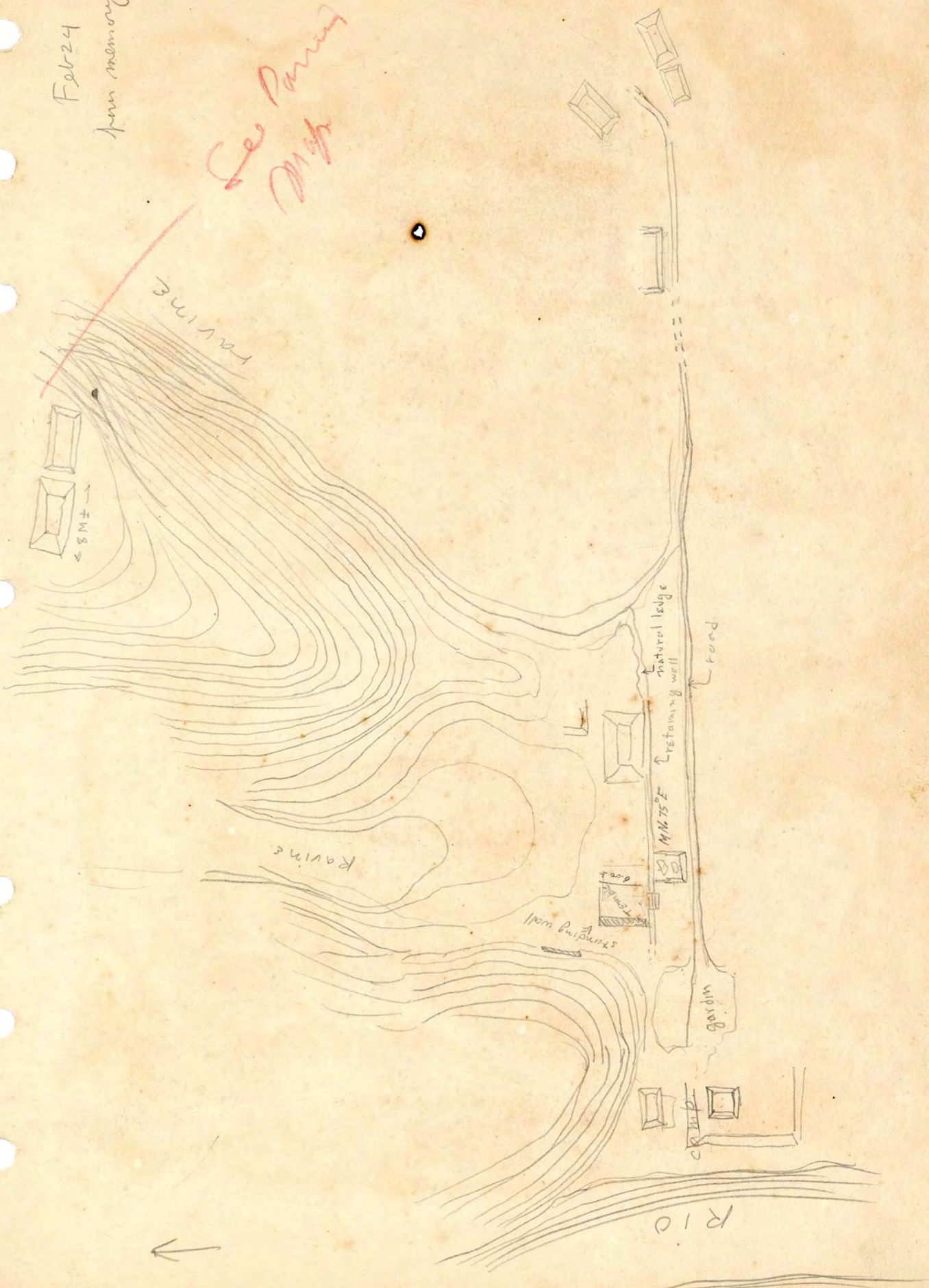

1932

General notes

pp 1 to 22

~~List of men~~ Mar 23, 1932.

Piedras Negras <sup>(3)</sup>

Arrived Friday, Mar. 1932 about 5 P.M.

Sat + Sunday making camp, inspection of ruins.

Monday Mar 21: 4 men most of day on <sup>Acropolis</sup> Central Temple (Str. LIX)

Took Fred Paris + Mary (over part) over S. group, S.E. Section, Acropolis.

Tuesday - available men clearing east group: spent most of day in camp, making camp; checking record books, conferences with chief re finances, mule hire etc.

Mules very lightly loaded both trips: Espansa says he couldn't do better because his four men are officials of the Liga + want to make more work.

Wed. Mar 23.

9 men on Str. LIX: looked at some stelae.

Stela. in E. group, # - block of 48 fair sized glyphs. ad

bottom



LIX

Fragment of stucco inside S end doorway - small bird bone, heavy thick + large pod shreds, some with stucco adhering.

Stucco decoration

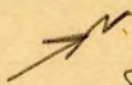
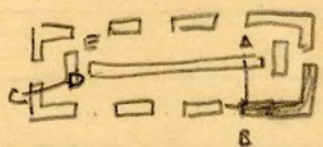

Sec AB

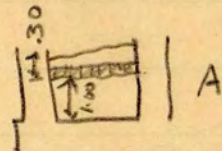

Same condition at C.F.

A very few shreds ad

Report of shreds + moulded stucco fragments - resting on stone debris, with stone debris + humus over it - about .10 to .15 thick (stucco).

over on pages

Men Mar 23

(4)

- x 1 Alfonso Morales
- x 2 Benjamin Aguirre
- x 3 Sixto Perez - looks intelligent.
- x 4 Amasetto Jiminez - medium
- x 5 <sup>arcenio</sup> Amasatio Perez - doesn't look so hot.
- x 6 Carmen Acopa - good.
- x 7 Estanislao Chavarria - looks dumb?
- x 8 Leocadio Uribe - old fellow with mustache.
- x 9 Jesus Perez Perez Gonzalez.
- x 10 Amado Aguilar - good.

Tools, Mar 23

Picks, w.w.			5
" " gold handle			1
Picks, old, w.w handles			0
" " old handles			3
Shovels - long			0
" - short			7
Hand picks			1

(the bent) (another with broken blade)  
- Mar 25 - sent 1 good & bent and both old to Mason.

Axe, hand

2 horse brushes

4 white hoods (2 new, last year)

3 bulcher knives

2 trowels

1 box (8) pins

Very few (xoss) shreds on the W gallery.

I cleared (finishing touches) in center of west gallery: no trace of an altar, fallen stones clear to floor, which is good smooth white on yellow plaster.

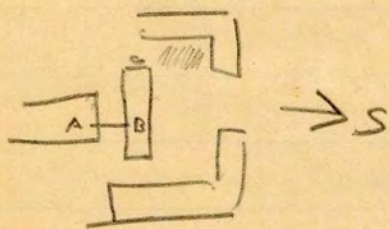

Section AB.

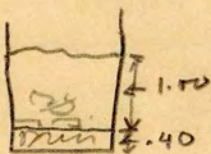

(pure deamblyzed plaster, moulded fragment, shreds. Several flat stones lie level on the stucco - no more stones below, nothing else above.

a piece of moulded stucco at c, h = about 1.25, close to the wall - plaster there in place in fragments, very soft, but no moulded stucco in place.

Shaded area - many pieces moulded stucco @ about .30 above floor.

Designs of Stucco "Balls"

"Mouldings"

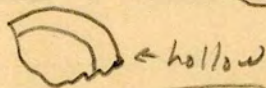
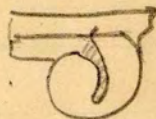
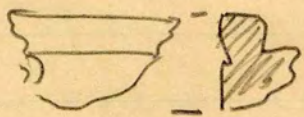

← hollow

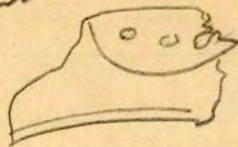

The indicated stucco in high relief - as much as .07 - probably more - similar to last years.

Mar 23 - cont'd

6  
4

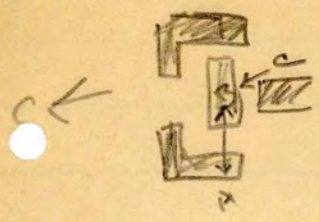

Section A-B

There is enough overhang, 3 stones deep, to prove the small doorway, front, to S end room was vaulted.

The same in front gallery behind middle doorway (i.e. "E" side).

Mar 24 - Rained all day - worked at camp, ~~principally developing~~, unpacking, on house, &c.

Mar 25 (Thursday) - Good Friday - at camp, principally on developing.

Mar. 26 7 Men. - no working at camp.  
Central Temple: Plaster in position at "c" (above) from floor to a slight offset - the later irregular. about .03. - Plaster indicates it was one.  
Lots of moulded plaster in front room, behind left (S.) door, @ .50 to .60

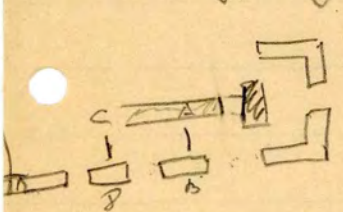

Section AB - deposits of 10 to 20 of stone & mortar - in some spots slabs practically on the floor.

Sec. C. D: inclined slabs right to floor - certainly no altar.

Inner walls more irregular - smaller stones & slabs - but still construction of quadrangular stones & slabs - See Photos. But the principal difference lies in the corners of the outside walls, where large quadrates are used: this is also true of corners of the transverse walls, the medial wall being distinctly inferior to others in size of stones, regularity of courses, & present condition.



Mar 27 - cont'd

(8)  
6

LV To herods of construction. Over the latest floor fairly thin haired

32

sheds -

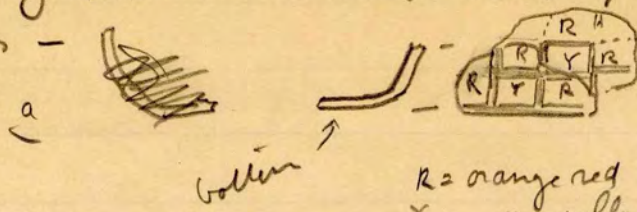

R = orange red  
 Y = " yellow } on white slip  
 L = dark brown }  
 Orange on white inside

to Rim hole

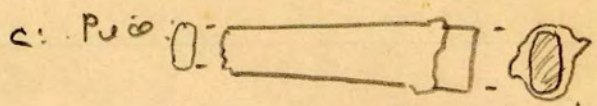
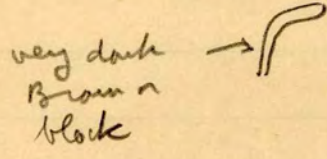

Case, coated with more paste, both fired - probably same figure.

No stucco. Plaster floors on early structures  
Section to be made.

Fragment of usual type metate, also over latest floor - might be fallen from wall.

Mar 28. <sup>915-9</sup> LVIII - North range.



Masonry - Stones set in mortar, now quite soft.

Fairly well squared blocks, with many small chink slots + very small slot chinking in rear wall.

Very general  
pretty good.

In doorway wall - nearly all stones of fair size - very few small slots except chinking slots - stones at corner selected for large size, well laid + chinked, some head bonding - including use at top of very large slots which really bond both ways.

(1.65 x .45) See 2 photos of these walls. "cylindrical" stone is merely an odd shaped stone. Note that at corner, despite bonding, some small blocks are used, i.e. the stone on level with "cylindrical" one - about .95 above floor.

Mar 28 - cont'd

9

Men to-day

- 1 most of day on LV
- 2 \* 2 hrs on LVI
- 1 clearing all day.
- 1 " 1/2 day
- 1 1/2 day on XLIV
- 2 1/2 day on LVIII &
- Balance (total of 9) on LI.

Mar 29

Level of debris in center of W room of 21 between .30 + .40. No ~~roofing~~ slabs. Note pottery later (no struck heavy shreds.).

LIV: trench from rear about 1.50 under - room hits square heavy blocks, strucco or thick plaster - probably moulded.

Small *Jucundone incensario*, face broken off + missing, on SW corner (of debris) about 1.50 above Count 2 level - found by man but position plain where he searched for it - was right on the surface. usual lips 

Men 8. : 1 on XLIV. (5-18)

Balance on LI.

LIV: a temple; rear door jam on rt. of trench from rear: had to step up trench to avoid heavy wall preserved deep relief strucco ornament, bulb up on small thin slabs of stone.

(5-12) LI. Paved pillars; W end room solid wall; to the east pieris, with 3 instances of thin secondary walls.

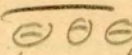
Sections + photos of W end room. or on Considerable number of hot shreds near floor at several points - mostly thinware - bunched as if pots but not enough probably to make complete pots. Pottery includes bells. . also think pieris, probably griddle.

Wooden roof practical certainty - note height of wall of end room + of debris at E end.

In camp lunch by 3. P.M. - grand economic conference.

cf. Hamm's  
diagram,  
1935

(5-4)

Mar 30. Str XLIV: North side: possibly a stairway leads up from our trail: at level of northern plagiote a broad terrace, which probably connects with the former - well preserved terrace wall behind it. On the terrace toward left (E) a much eroded stone of some size, to be noted - could be remains of built of size of Surtel 71 Pyr. (11-5). No obvious signs of stela, but this terrace corresponds to that of the upper stela on Str. ~~XXVII~~ XXVII. Pyramid terraced above this - can be worked on with clearing probably.

(5-12) (L1)

In the floor of room B, shreds of small pot or bats with bell ⊖ feet (replaced by Carman - quite certain, came out with brick - plaster floor well defined here.

Other shreds from this room over the floor.

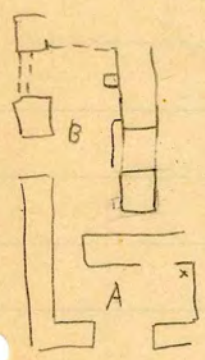

Pot in position, room A at x.

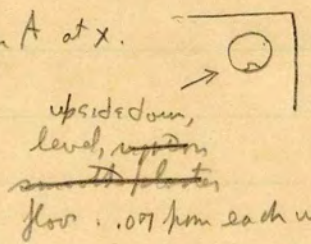

← this is in Museum

Seems to stand up as left on floor. See 1000 Mar 31 for white plaster as well plaster.

Caused a spot where white floor had been broken through: Over the bed + surrounding floor, white on brick, thick, broken bits of plaster, also under the bed, below well defined white floor level. - roots (roots?) I lifted the floor under it with the pot (had cut around it). The brick below was limestone, which is about same color as the white on brick plaster.

Mar 30 - cont'd.

This white or pink plaster occurred in diagonally opp corner, over floor - but there is no obvious deposit all over the floor.

Flank plaster

Room B - low sill or bench along part of rear wall - to be planned separately extending around E end.

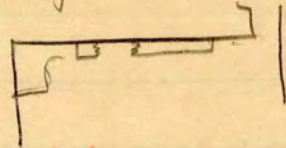

Catalogue No for <sup>(S-12)</sup> Str. L1 - ~~W-8-~~

W-8-1 - Potsherds on ~~the~~ floor. Rooms A, B, & C.

~~W-8-2~~ - " in floor, Room ~~A~~.

W-8-4 - ??

W-8-4 - <sup>hooked</sup> metal ball from.

W-8-3 - new pier on S side - 2nd or 3rd from W end room.

W-8-5 - bone - on robo floor.

W-8-6 - whole hook from Room A (end room).

Str. XLVIII the end room in all probability is a balancing beam, with secondary wall bulbous - rip out to see. & look for pier clear around:

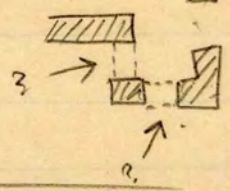

Mar 31. S Pier (Str <sup>S-12</sup> L1) opp N Pier 2 - at base of W side, plenty of fallen white or pink plaster, and one piece in position on side of pier, though small - almost certainly the walls were covered with the white - surged pink plaster. This is the high pier to be photographed.

5-0

Central XLVI - Niche, painted sculptured stone fragment

5 pieces (4 large) <sup>of stone + no. of stucco (glyphs)</sup> remained brought to camp. Another very large

piece left in place + buried. Carver + Stanislaw throughout the 4 pieces found by ~~Pavel~~ + ~~Fred~~ + ~~Pavel~~ - examined all stones thrown out and not deeply buried - these had to come out last as

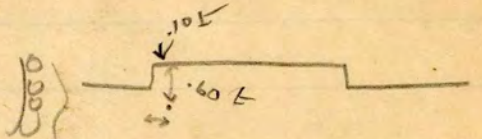

(12)  
(10)

not more than a couple of cubic meters of earth was removed from below the vault-stone level. Redhand - well preserved - probably very handsome.

Same afternoon - uncovered NW corner of a vault in terrace flanking XLIII.

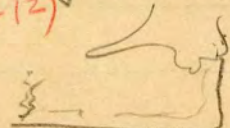
Men clearing ~~W side~~ side of XLIV about an hour, with 2 men on "altar" ~~side~~ N of LI - <sup>(3-12)</sup>  - badly destroyed by trees.

Followed low walls, apparently enclosing small stone fill, with lobs on top near pond edge - rest was badly disturbed by roots. The walls simply peter out. Will excavate center for cache <sup>2 m XLIV</sup> ~~maximally~~ - all for 15<sup>th</sup> hr.

Thereafter 3 men on XLIV; 3 on XLVII (niche) + 4 on XLIII terrace. #

The stone in XLVI is ~~so~~ smooth on a good plaster floor - these parts found in pond of ~~the~~ S end of the niche, the lower part of which is filled with a bench.

<sup>I-H</sup> Uncovering whole area in front.

XLIV has a hump of debris protruding out, corresponding to XLIII



also some indication of stairway at base of N side, ~~between~~ back of Plaza.

Just a broad terrace higher up - the stone I referred to was nothing.

April 3<sup>rd</sup> - 2 on XLIV <sup>I-H</sup> for 2 hrs, rest clearing XLIII (9 men): Most of rest of day clearing XLVI, moving dirt etc. Very careful examination of all stones by all men, - slower work - clearing left half of stairway - rain good part of day. - helped Fred build tower.

Apr 2

<sup>5-6</sup>  
XLV - 5 lobed stones, right of niche (N.). .70 x 1.00 x .12.

Rain off and on all morning.

~~XLV~~ XLVII: ~~Model~~ Modelled ~~stones~~ p. stucco - stucco - sheds in  
of debris in hand (Road 3 side) - started 2 men with trench,  
about 3 hrs to-day.

About 3 hrs. of 2 men on LIV - running trench for section here  
also (started yesterday afternoon).

9 men - rest of time on ~~XLV~~ XLVI - about ready for going after  
stones - no plan for layout - looks like stone 2 or 3 meters  
across, or 2 or more stones, painted.

Believe puzzling worked fragments which have been turning  
up are # an altar top, plain, heavily painted - likely the  
top of the bench. Can't yet account for the left part of stone  
falling face up.

Missing pier is badly fallen forward, but identified - though  
not as to position as yet - the stones ~~XLVI~~ are to right (N)  
of where they should be for correspondence with those to right.  
(30 cm ±).

Nothing turned up on steps to left of throw - was cleared  
very carefully + slowly.

Examined all stones fallen on either side of throw, by Six's to,  
believe no question whatever about anything outside the throw -  
& we combed that damn 30 cms or so immediately after the stone  
was found. We could have lost part of the "altar top" had found  
some of it - this is likely the stone which puzzled me.

April 2 - contd.

clearing a little 2 transverse wall to rd (N) of center, XLVI - believe the more central one is secondary, the other primary - much the same. Stone masonry appears different - rd almost certainly tied in, legs probably not. Left, rd top rd east is ± slab, rd rt, blocks.

Apr 4.

XLVI <sup>5-6</sup> Down clear area (see plan) level ±, about .30-.35 above floor. Will proceed on vertical faces of this.

From the lay of the stones, the rt taller fell out + part of it to S. Cleared mass of stones. Getting many very small fragments - boys very good -

- 1 Carmen Acosta, Sixto Perez + Amador Aguilar - old day here.
- 2 men on LIV + later clearing N. side of stairway below LVI + hunting rubbish + retaining wall behind W end of LVII.
- 2 men clearing section through LVII, from court B.

Apr 5 finished clearing stones - cleared whole busman under about .30 by hawsel brush + bushes - careful examination of dirt - recovered large numbers of fragments, some sculptured or painted, 2 walls on rim with small glyphs.

Between Nos 11 1/2 + 13 (See Drawing):

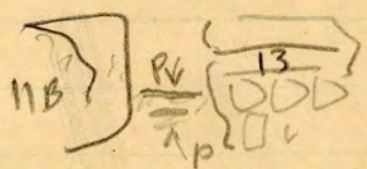

↳ No 13 is between this side - fragments, probably.

Altar - 50 S. of N edge of niche, packed earth (our pack probably) above small slots ± in position (fuller forward). Picture of this, but Sixto took several out by mistake before I took the picture.

Small quantity of fragmentary wall plaster near the wall. A very few fragments of stucco, one only moulded, near center + near wall, among the stones above alluded to - probably

thrown in mortar used in probably near support for altar top.

Took 2 pictures from tower showing all major fragments in position; ~~cleaned~~ cleaned sand of stairway - Had chief take 2 more from Tower, farther back, with wide angle lens.

2 men finished shalf of L VII section, & started clearing other side to get thickness of walls & prove presence of that side. Have yet to definitely prove pieces on S side, though little doubt.

Paid of time, one man clearing transverse walls to N of niche in XLVI <sup>36</sup> to see if they are secondary.

Paid of time Amado clearing "altars" near L1 - sheds, a veridicum possibly human - more later.

Made reasonably accurate drawing of all major fragments of stone from niche in XLVI <sup>36</sup>: got all carved stones down, and assembled. Heads missing - part of top - legs nearly complete - only part of table. - a throne with back-piece. Chief (I agree) thinks Fig 3 shows scene on this throne - at least a similar one.

NB - We took all from 30-35 above floor in front of + od sides of niche, down with hawks & knives & bushes: Only exception, space about .50 x 1.00 at south end of niche, where Camen just went through, & threw out 4 pieces of stone; one of stucco, ~~some~~ of glyphs, & part of necklace, were found in position. These 4 were found on the surface of the throw in 5 minutes. We immediately combed this throw to a depth of a foot or so, by hand: and Sir to cleared all fall-overs at the sides - spend all afternoon & next morning at it - recovering (in both places) several pieces of altar top and many small fragments probably of sculpture. I am satisfied that Camen

threw out nothing of any size which we did not recover.

~~As it is~~

We cleared the steps to S of the throw after this, all men being instructed to look for worked stones, and they did more looking than clearing - there was only a shallow deposit except over the (hood) top, terraces or steps, which were carefully cleared by Amado personally. Nothing turned up except under the walls of my throw (S to).

I am therefore certain that any missing pieces are either broken beyond recognition (there were several of these, which might be from the screen or the altar; are in the small amount of dirt still to be removed to the N of the niche; are further to the S side; or originally fell lower than the hood step below the plinth, in the center, and so are buried under my last year's throws.

all dirt is segregated: that from side of stairway is below on the plaza; all last year's is between my retaining walls: all all from floor level & above it is over the latter, walls being built up to hold it.

All the dirt from the 30-35 level is segregated on the top of this, held in by a supplementary transverse retaining wall, ready to be sifted - minus only stones which Knip men had thrown back & which were turned over by Stanislas. He watched & dirt as well and recovered several small pieces missed by the others - most of them of doubtful value - which means all dirt since we found

what we have has had a pretty good double check.  
The boys fell in with the idea beautifully, and I have a wooden  
box full of Sigorb fragments, besides about a bushel of  
small ones, many of obvious value, several with glyphs.  
~~Some~~ Combining the dirt around a Jollen monument is  
obviously thoroughly worth the trouble.

Rain at 3 - made bringing down stones a little difficult.

I have had 3 to 5 men working on ~~the~~ getting over this stone  
4 full days since the 2 boys found it.

I did not clean except superficially - only enough to debarren  
sculptured surfaces - each stone wrapped in burlap over soft  
earth as soon as cleared. You can't clean a painted or other  
stone while it is clamp without hurting them. These were  
bugged up enough as it was.

will continue to sides. + sift the lower layer of dirt.

4/16

- 7 Merrily 1 on mound behind LVII (high terrace)
- 2 fallowen N gallery of LVII
- 1 on 61 "alter"
- 3 at XLVI - <sup>3-6</sup> pushing rock cut to S.

Have covered the lower chamber from in front of niche with burlap -  
throwing other levels of new cut over this with wheel barrow  
Have many fragments this a.m.

2 or 3 stucco fragments about 2.00 S of niche, artef green, about .50 high

Bench in niche cleaned - a few small fragments, some colored, removed from top. Central portion is badly busted up - as N and apparently a step to hold table top - seen as others, but pushed down & back. on the latter, remnants of plaster - on the former, over .06 of soft earth, back in the corner, a piece of kambo stucco, badly run, but about .02 thick.

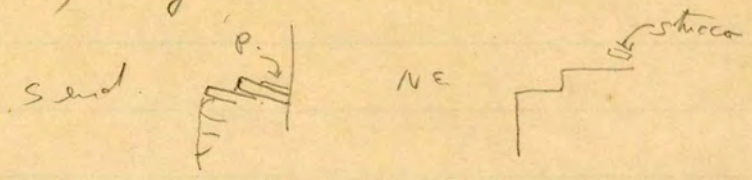

- 12<sup>new</sup> or three stucco shards
- 1 piece mid location stucco - no surface left, <sup>lead</sup> ~~quarter~~ dia. .06
- a stucco bead or ball, dia. .025
- 1 piece (and located) stucco on thin slab of stone.
- 1 small piece of another of head of an debris 1 to 2 m S. of niche.

Apr 7 10 men - 2 clearing W side Acropolis.

- hump or two on great stair way - statues?
- cleared in front of XLVI niche to 1.25 remaining broad step;
- no results.
- Found Ely side of stairway up platform & side of XLIV., started looking for correspondence on XLIII.
- Failed to find stairway from XLIV. platform, but found lowest terrace wall of pyramid - meters from XLVI. - have failed to reach this up near the front - run into pure fill.
- 2 men making out XLIX.
- Located sly hole for table leg, very clear, nly mud very plain, but men eyes softer there & slight discoloration - failed to find these holes in plaster surface, as it was all broken up near the wall, but found them in the body of floor - see drawings.

Apr 8. 3 men clearing. 1 clear out bench in XLVI<sup>36</sup> niche - nothing - see drawing for construction.

cleared what area in front, about .75 below floor, no result except 1 beaked cad - see drawings.

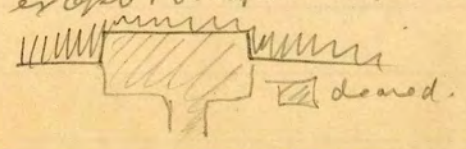

1 Man - located Ely side stair way wall, to XLIII side plot form:  
also cleared corner, at XLV. - curious come here - see drawings.

4 Men on road of XLIII.

2 men clearing in P.M.

19

over

4/3/32 (Mon) <sup>Man</sup> (acc to the men)

Sifting earth from pond of micks (2 men)

Trenching platform terrace side of XLIV - find lame platform, wall toward court, terrace(?) - floor to wall lame level. (2 men)

Carrying XLVI <sup>36</sup> to S. (2 men)

going down with separate hole in W-17.

- found shell, jade, bone etc. - ~~more~~ re-buried.

Pruning at night.

4/ /32 (Tue.) - Finished sifting, XLVI - starting to make the draw. (2 men)  
Carrying trench into platform of XLIV to meet E1 trench, but at court 2 level. (2 men).

Carrying XLVI <sup>36</sup> to S. (2 men)

" down XLIII <sup>33</sup> platform, 2nd "pit" (3 men).

Making drawings, cleaning walls etc. - re drawing.

Have located the 3rd corner of vault - possibly a doorway to the E near this corner - further digging to S. to all for angle of rest.

I have been besides pits here, several pieces of undoubled burned clay from sticks walls & door - impressions perfectly plain.

The spring of arch on the E side is .17 lower than that on N+W sides: proved by stones in position at N corners.

4/6/32

Since the above, the fire! Have been keeping mat sheets in the loose-leaf book - and two few notes in general.

Took XLVI thru room to S end + ~~left~~ <sup>36</sup> about a week ago nearly done: Carried down vault and cleared skeletons, personally with a little assistance from chief: He cleared bones W of SK. B of some to N. I have been delayed here past few days by rain (about 4 days, showers - 1st rain since they first quit.

Took out mirror & bowl to-day - large photos this a.m. by chief.

Wound up several odd jobs on Acrop:

Outside section of ~~XLIV~~ L1 <sup>5-12</sup>

Poorways (& wall) on XLIV <sup>5-4</sup>

Cleaning Plaza trench further in.

" Section from W on L11; including <sup>to</sup> end wall & doorway (!) - to <sup>end w</sup>

" Platform str. <sup>to draw</sup> of the altars.

" Much clearing - started for rochen only, L111 - very curious - see notes <sup>smooth</sup>

Started Ball Court <sup>A-11</sup> 4/31 - men with machetes Sunday - = 6 days

20 for: with 8 men 1st 2 days - full crew since.

Home spent a little time with Fred Parris

a little observing Amram on Str. IV.

The fire cut out about 4 working days, which I spent clearing in the vault of XLIII (Op W-17). It jolted everything out of whack, but we are getting back into str. & c.

Work on Ball Court proceeds slowly, methodically, but well - as it should.

Clearing fields by sections; will try to keep museum in center of S field clear for photo. Clearing.

Clearing both inclined plains (X 1/2 done) X1 done to-day, with trowels, hand picks & brushes - not a slab or real stone moved - swell job - same humahul as on platform of the altar - with thought men, this is the way to understand surface ruins.

When there is danger of a wall falling, prop it up till it is drawn & photographed - hardly curvilinear buttress fell on N of X before I had it.

Plaza Trench

Ball Court

1/13/32

Ward meworke

Amador

Sixto

Luis

Benjamin

Estanislao

Paul Ward

~~Amador~~

Annunzio

Carmen

22

Arceles?

||