

Mastaba of Ist.

Owner. Sneferu-hotep and his wife
 Khennut - mut. em. - Yeaty.

Offering chamber N. end destroyed of Ist. nich
 stuccoed and painted walls.

S. niche (husband)

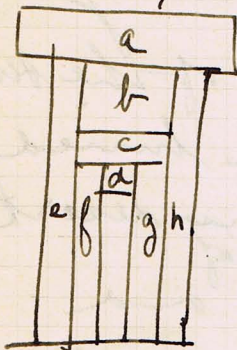

(a) = seated figure with staff and.

(b) = seated figure before table of offerings,
 over table inscribed

acquaintance Sneferu-hotep,
 speaking,

1,000 loaves
 1,000 jugs beer
 1,000 head cattle
 1,000 geese
 1,000 } kinds of cloth
 1,000 }

(c) Seated figure with staff → R

and. "Revered one, Sneferu-hotep."

(d) Round tablet with "Sneferu-hotep."

e-f. may the king give an offering, may Anubis give
 an offering (to/him) who is buried in the
 West Land, in a ^{great} ~~good~~ old age, Sneferu-hotep.

f-g. may the king give an offering, may Anubis give
 an offering, funerary offerings for him, the
 acquaintance of the king, Sneferu-hotep.

Wife's niche. (N. end.)

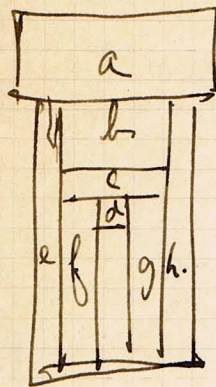

(a) missing.

(b) seated female before table of offerings. → R.

(c) seated figure → R.

"Revered one, Khemut-mat-em-Yenty!"

(d) destroyed.

e-h = ~~the~~ may the king give an offering, may
 Anubis give an offering, foremost of the temple,
 Lord of the Underworld, she who is buried
 in the cemetery of the western desert,
 priestess of Hathor, ^{priestess of} Keith and
 heh-mat, revered one, Khemut-mat-
 em-Yenty

f-g. acquaintance of the king, priestess of
 Hathor, Khemut-mat-em-Yenty.

W. wall N. niche

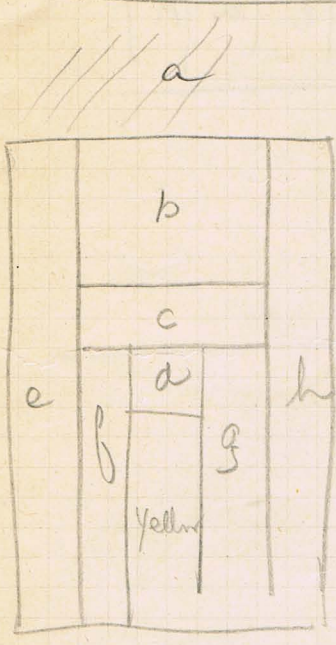

a. missing.

b) seated figure
→ R.
before table

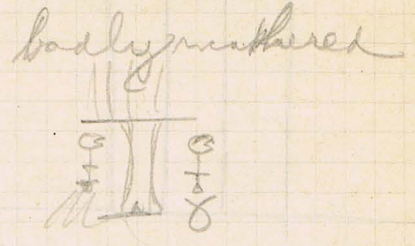

c) seated figure
female?
→ R.



d) matted (entirely lost)

+ (h)
e) double column

pieces
to
Hathor

pieces
Walt
Wep
w. out

covered
are



may the king
give an
offering, may
Anubis give
an offering

fragment
of
the temple
land of
the underworld

she who is
buried in
the great land

sanctuary
of
Walt
descent

f, g



acquaintance of the king
priestess of Hathor

Hennüt - mist - am - yenty
Khenüt
called yenty

yenty

E. mill.

a	b	c	d	e	f	g	h	finer.	i	j	k	l	m	n

(a)

(b)

standing
prime with
staff

[Faint, illegible handwritten notes on the right side of the page.]

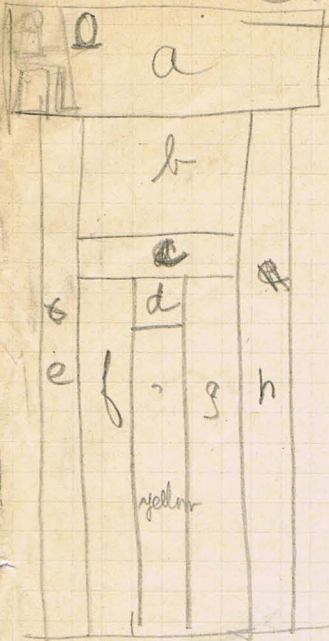

(a) seated figure → R
mit
stoffs

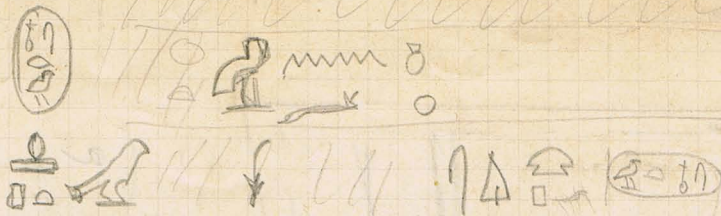

(b) seated figure → R

see highest

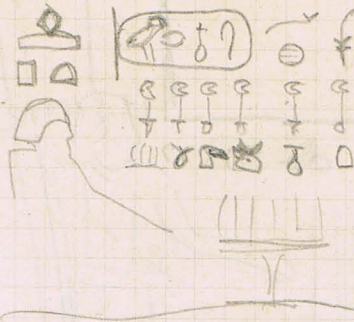

(c) seated figure with
mit stoffs → R.



(d) do
|||||

(e)



Reception
Schmies

in
the world

(in) a
good quest
abridge

(f)

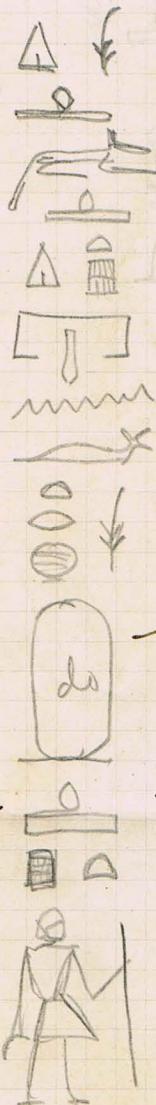

May the
king give
an offering,
may Amun give
an offering,
for Amun offering
for Amun,
the use of the king
Infernal notes

(g)



(h)

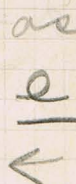

Painted chamber

small

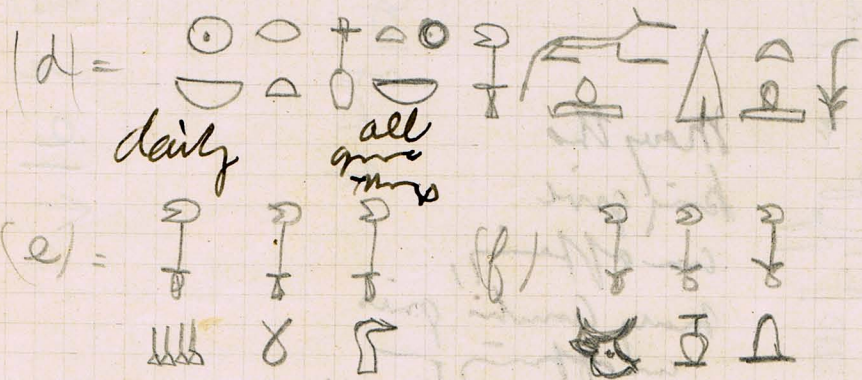
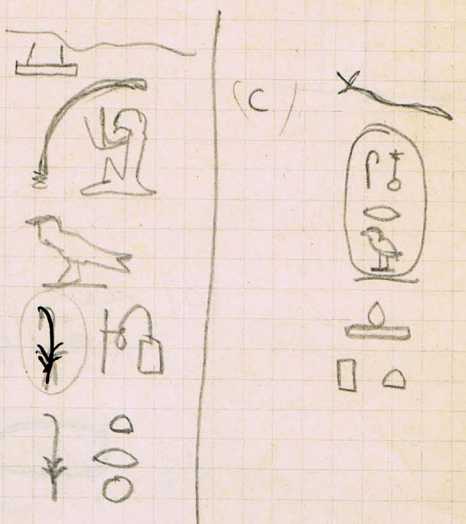
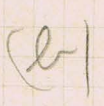
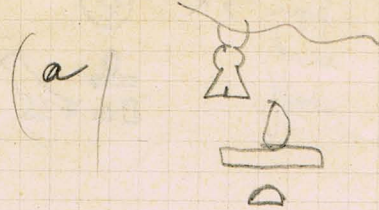
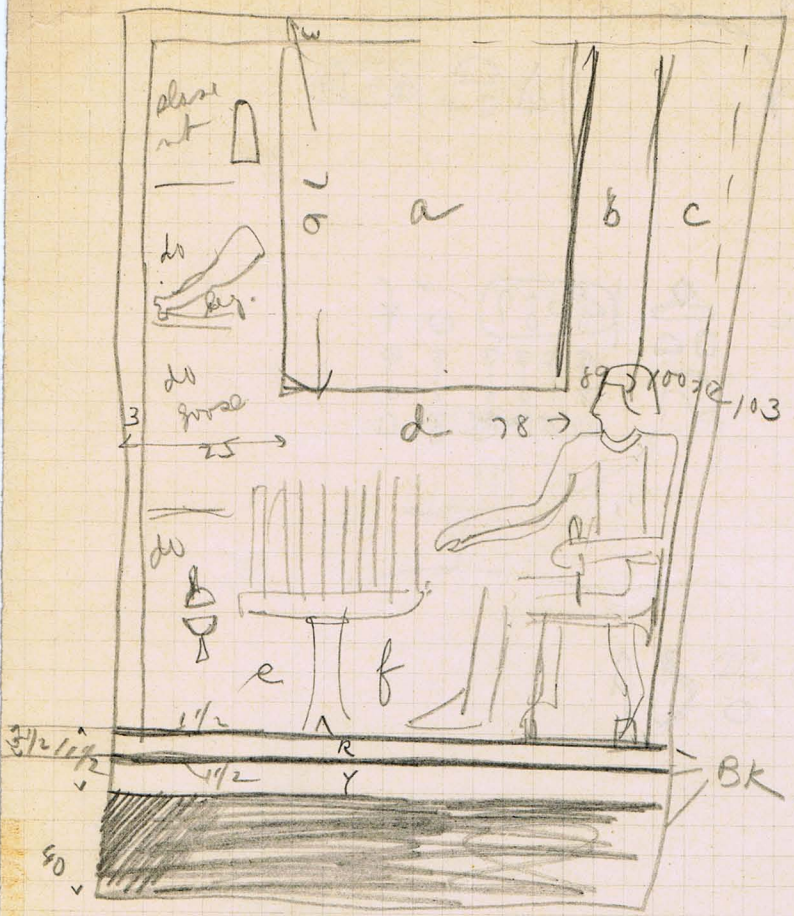

great prince, priest
scribe of the S. tens
key of things